

FOR LEASE

125 Mason Circle, Suite A

Available April 1, 2025 | Concord CA

±2,500 SF



CONTACT US

Tony Binswanger, SIOR
Bo Harkins

+1 925 296 7728 / tony.binswanger@cbre.com
+1 925 296 7727 / bo.harkins@cbre.com

CBRE

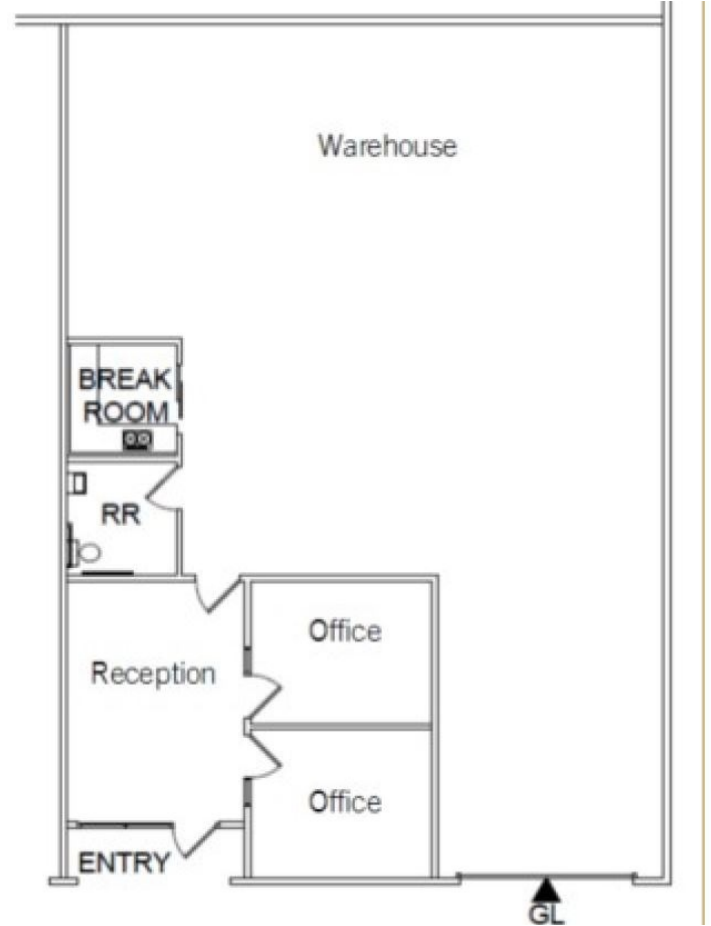
SITE PLAN**PROPERTY HIGHLIGHTS**

- » Available: April 1, 2025
- » Address: 125 Mason Circle, Suite A, Concord CA 94520
- » SF: ±2,500
- » Two (2) Private Offices
- » Reception
- » Restroom
- » Break Room
- » ±25% Office
- » One (1) 12'x12' Grade Level Door
- » ±16' Clear Height
- » Close proximity to Hwy 4 & 680
- » Call brokers for pricing

CONTACT:

Tony Binswanger, SIOR
Executive Vice President
+1 925 296 7728
tony.binswanger@cbre.com
Lic # 01861701

Bo Harkins
First Vice President
+1 925 296 7727
bo.harkins@cbre.com
Lic # 01943785