



WHERE PEOPLE & TEAMS THRIVE

Expansive Workspace Upper Kirby/Greenway

3120 Southwest Freeway, Houston, TX

Centrally located between the Galleria and Downtown, this Expansive Workspace building is located directly on 59 between Buffalo Speedway and Kirby Drive, and offers convenient parking with its own private parking garage. Featuring easy access to some of Houston's best restaurants, hotels, and retail, this six-floor Expansive location includes private offices and SmartSuites™ for larger teams.

Shared Amenities

- 2** Meeting Rooms
- 1** Event Venues
- 1** Expansive Lounge

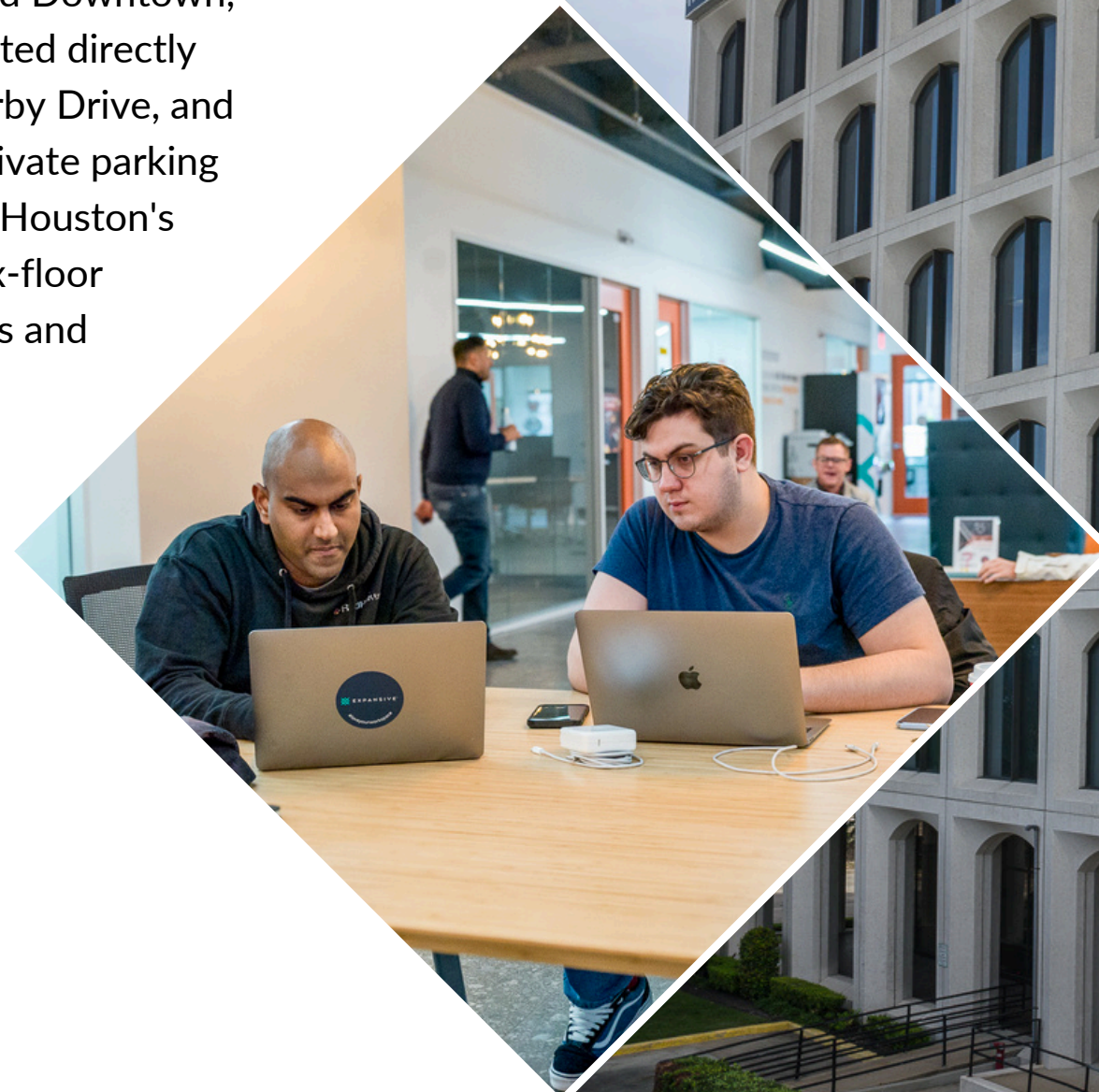

Upper Kirby/Greenway

3120 Southwest Freeway, Houston, TX

1ST FLOOR

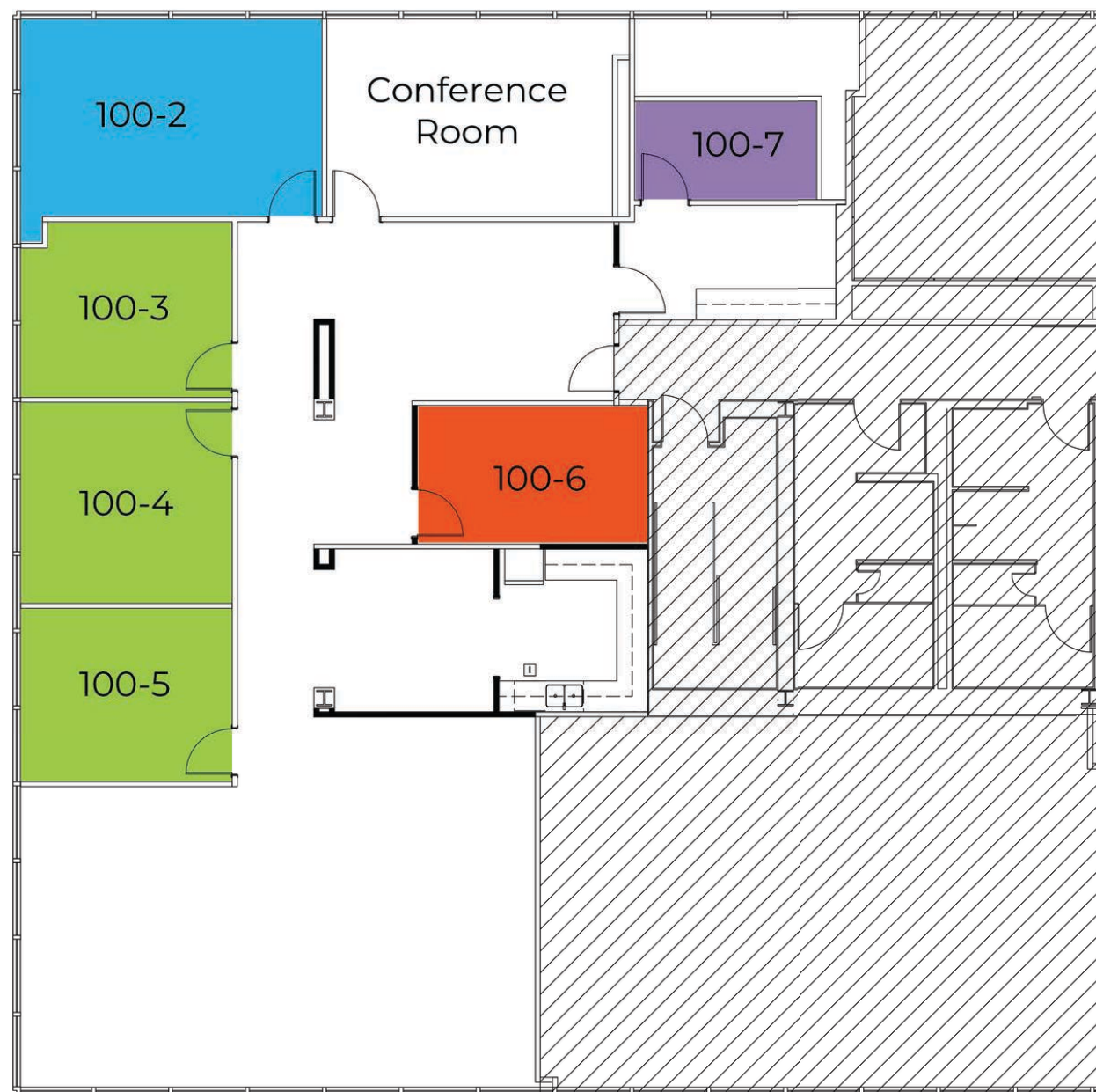

■ 1 person office ■ 1-2 person office ■ 3-4 person office
■ 5-6 person office ■ 7-8 person office



Why Expansive?

At Expansive, we own the buildings we develop and operate. This allows us to share the incomparable advantages of a fully-integrated, nationwide property owner with our clients, including our four cornerstones of workspace success:

- 1 Maximum Productivity**
To deliver on your potential
- 2 Vibrant Community**
To foster community and build relationships
- 3 Unparalleled Flexibility**
To realize your vision even as it evolves
- 4 Unwavering Stability**
To establish confidence in an uncertain world

Membership Includes:

Access to All Locations

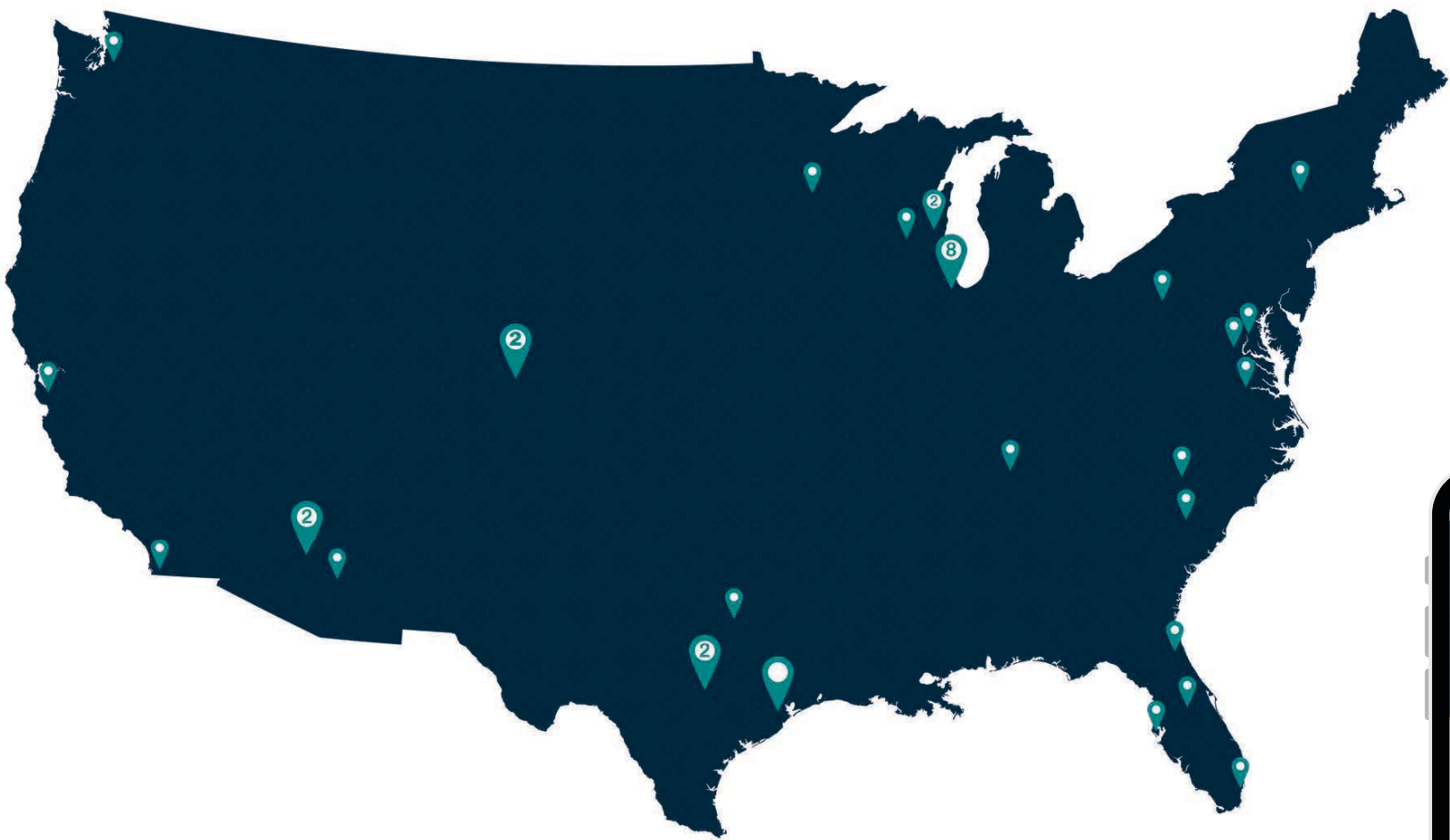

25+
Cities

3.8M
SF

40+
Locations

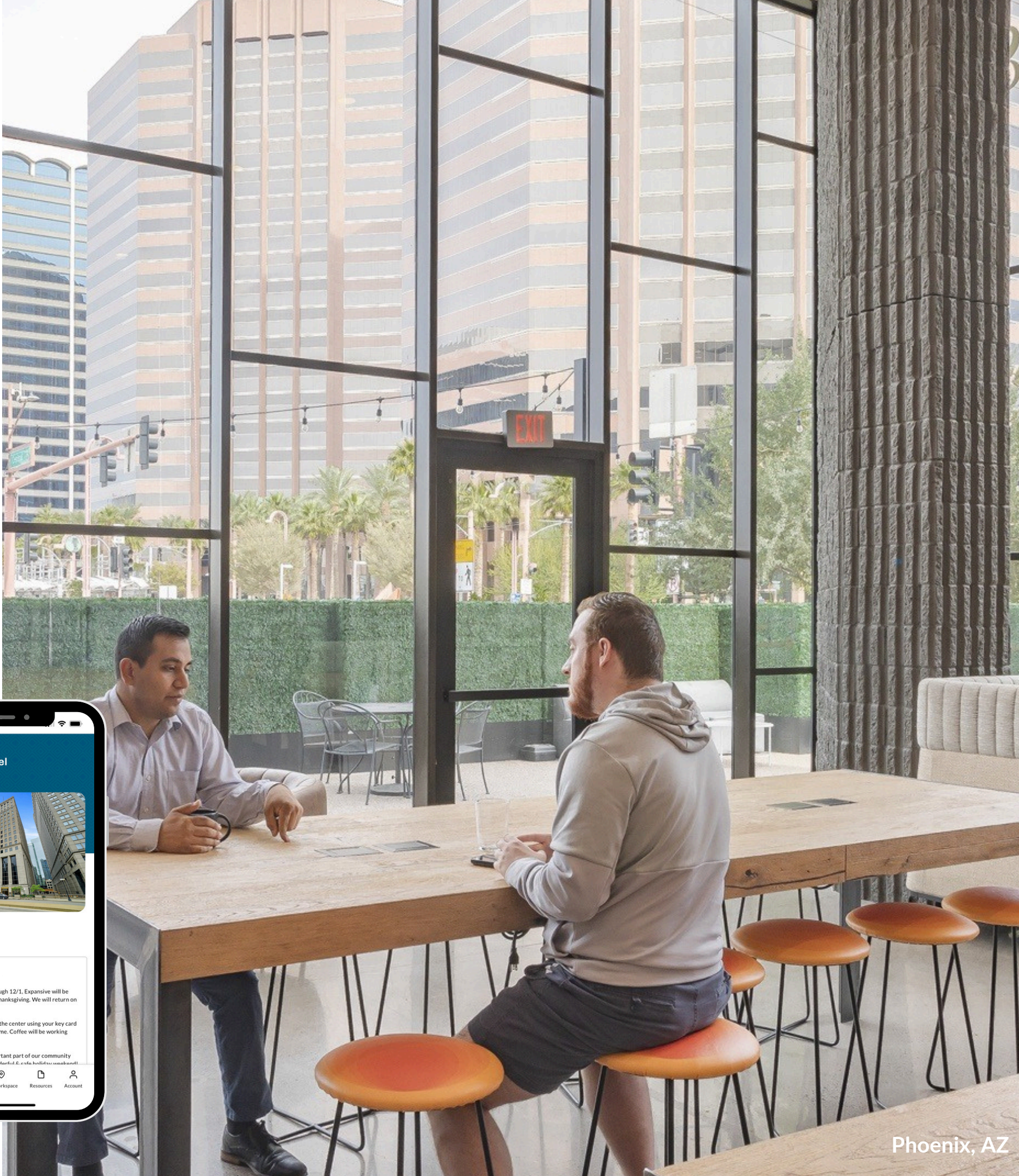
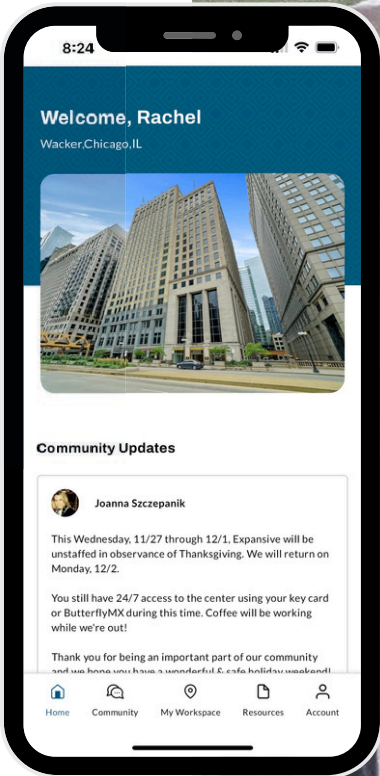

Building Amenities



FULLY
FURNISHED



DIRECT FIBER
INTERNET & WIFI



EXPANSIVE
LOUNGE



ESPRESSO
BAR



ENHANCED
CLEANING



SOCIALLY
DISTANCED
WORKSTATIONS



TOUCHLESS
FAUCETS &
RESTROOMS



UTILITIES



24/7 ACCESS



ON-SITE
MGMT



HIGH SPEED
PRINTERS



MEMBER
DIRECTORY



MOTHERS'
ROOM



COMMUNITY
APP



BIKE ROOM



NETWORK
LOUNGE ACCESS





Enterprise Clients We Serve



Workspace Options for Customized Solutions

[Learn More](#)

Dedicated Space

- Team Suites
- Private Offices
- Access Pass



Shared Space

- Dedicated Desk
- Coworking Membership



On-Demand Space

- Conference Rooms
- Day Office
- Lounge Access



Virtual Office

- Virtual Office

Expansive Team Suites Provide Room to Grow

Multi-room Team Suites for 10 to 500 people are delivered fully furnished and move-in ready. Our in-house experts can help customize to meet specific needs. Team Suites feature open floor plans with:

- Dedicated kitchen with bar top seating
- A combination of open space and private offices
- Private conference room with smart TV monitor and blue board
- Turnkey technology package with high-speed fiber internet and Alexa-enabled sound system
- Biometric private entry to your suite and keyless building entry for secure 24/7 access
- And much more

[Learn More](#)



Go Beyond Workspace



Many centers also offer additional service options for an end-to-end experience
Corporate Meeting & Event Space • Storage • Parking



What Happens Next?

We invite you to proceed in two simple steps.

1 Choose your solution

Act now to avoid disappointment. We operate on a first-come, first-served basis.

2 Easy online sign up

Once you've chosen your preference option, we'll send you a one-page agreement, which is just one click to sign.

Further questions? Please contact us if we haven't given you the right solution here. Talk to us. Other options are available.

Contact Us:

sales@expansive.com | 877.301.6217