

Village Square Office Park

Office Space for Lease



Property Address

• 13601 Office Place, Suite 201
Woodbridge, VA 22192 – Prince William County
Available July 1st, 2025

2,750 SF on Second Floor

\$16.00 NNN (\$3.70 PSF)

Building Features & Amenities:

- Window Lined Offices & Beautifully Landscaped Office Park
- Ample Parking & Abundant Free Surface Parking
- Great Proximity to Major Highways & Minor Roadways, including the Prince William Parkway and I-95
- Close to Hotels, Retailers and Excellent Local Restaurants (Carrabba's Italian Grill, McDonalds, IHOP, Five Guys, El Paso Mexican Restaurant, and much more)
- On-Site Property Management Office
- Turnkey Spaces Ready for Immediate Use
- Building Signage Available

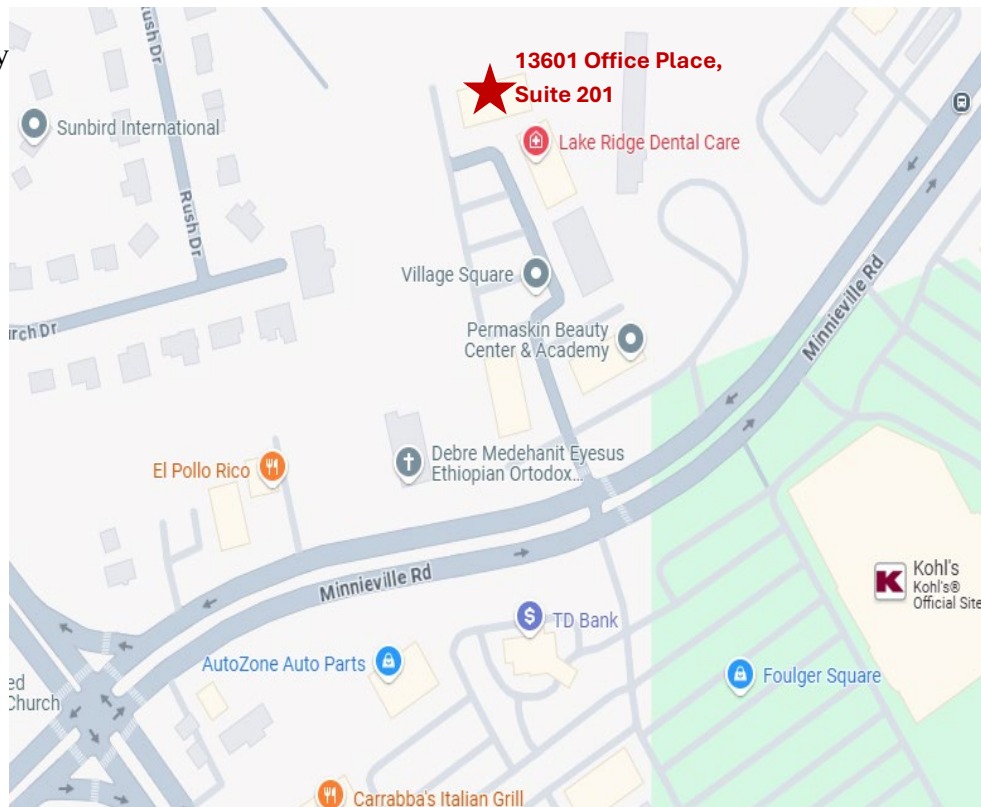

rlt

R. L. Travers & Associates, Inc.

Post Office Box 686
Springfield, Virginia 22150
P: 703.339.0100
F: 703.550.8815
www.rltinc.net

For more information, please
contact:

Guy Travers, Principal Broker
703.339.0100
gtravers@rltinc.net

Disclaimer: We have in preparing this information, used our best endeavors to ensure that the information contained herein is true and accurate, and deemed to be a reliable reflection of market values or has been secured from sources we believe to be reliable, but we make no representation, guarantee or warranties, expressed or implied, as to the accuracy of the information complete, or reliable, current or error-free and assume no responsibility for any errors or omissions contained therein. All references to age, square footage, income, and expenses are approximate. This is not a survey, any pictures, images, or drawings are only for illustrative purposes. Any party should conduct their own independent investigations and rely solely on those results. This is not intended as a listing solicitation for a property currently listed with another broker.

Floor Plan: 2,750 SF

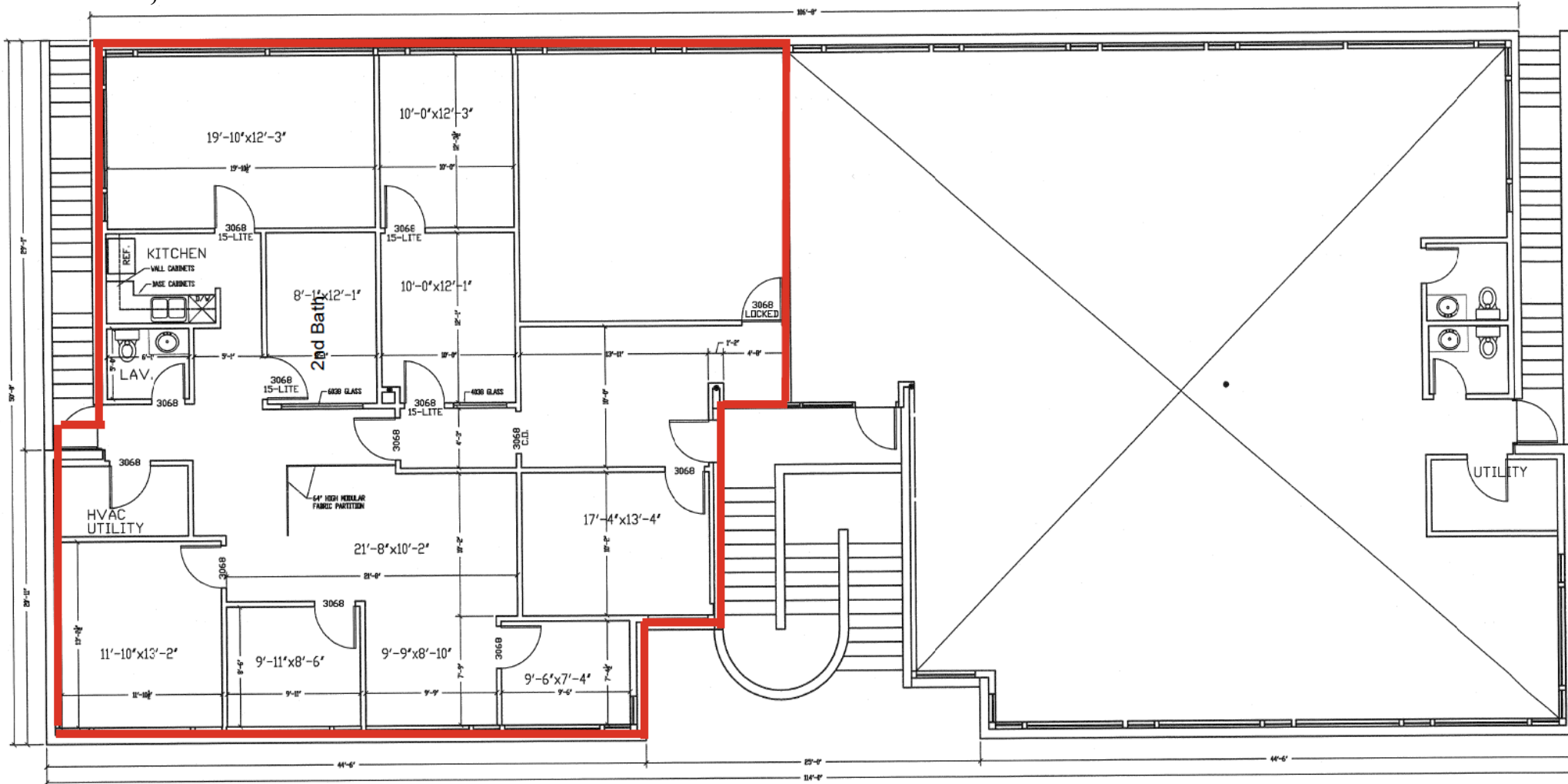

SUITE 201 A&B

SUITE 202 A&B



R. L. Travers & Associates, Inc.

Post Office Box 686
Springfield, Virginia 22150
P: 703.339.0100
F: 703.550.8815
www.rltinc.net

For more information, please
contact:

Guy Travers, Principal Broker
703.339.0100
gtravers@rltinc.net

Disclaimer: We have in preparing this information, used our best endeavors to ensure that the information contained herein is true and accurate, and deemed to be a reliable reflection of market values or has been secured from sources we believe to be reliable, but we make no representation, guarantee or warranties, expressed or implied, as to the accuracy of the information complete, or reliable, current or error-free and assume no responsibility for any errors or omissions contained therein. All references to age, square footage, income, and expenses are approximate. This is not a survey, any pictures, images, or drawings are only for illustrative purposes. Any party should conduct their own independent investigations and rely solely on those results. This is not intended as a listing solicitation for a property currently listed with another broker.

Village Square Office Park

Office Space for Lease



Property Address

• 13663 Office Place, Suite 201
Woodbridge, VA 22192 – Prince William County
Available Now

2,462 SF on Second Floor

\$16.00 NNN (\$3.70 PSF)

Building Features & Amenities:

- Window Lined Offices & Beautifully Landscaped Office Park
- Turnkey Spaces Ready for Immediate Use
- Ample Parking & Abundant Free Surface Parking
- Great Proximity to Major Highways & Minor Roadways, including the Prince William Parkway and I-95
- Close to Hotels, Retailers and Excellent Local Restaurants (Carrabba's Italian Grill, McDonalds, IHOP, Five Guys, El Paso Mexican Restaurant, and much more)
- On-Site Property Management Office
- Building Signage Available



R. L. Travers & Associates, Inc.

Post Office Box 686
Springfield, Virginia 22150
P: 703.339.0100
F: 703.550.8815
www.rltinc.net

For more information, please contact:
Guy Travers, Principal Broker
703.339.0100
gtravers@rltinc.net

Disclaimer: We have in preparing this information, used our best endeavors to ensure that the information contained herein is true and accurate, and deemed to be a reliable reflection of market values or has been secured by a third party. We make no representation, guarantee or warranties, expressed or implied, as to the accuracy of the information complete, or reliable, current or error-free and assume no responsibility for any errors or omissions contained therein. All results are approximate. This is not a survey, any pictures, images, or drawings are only for illustrative purposes. Any party should conduct their own independent investigations and rely solely on those results. *This is not intended as a listing.*

Floor Plan: 2,462 SF

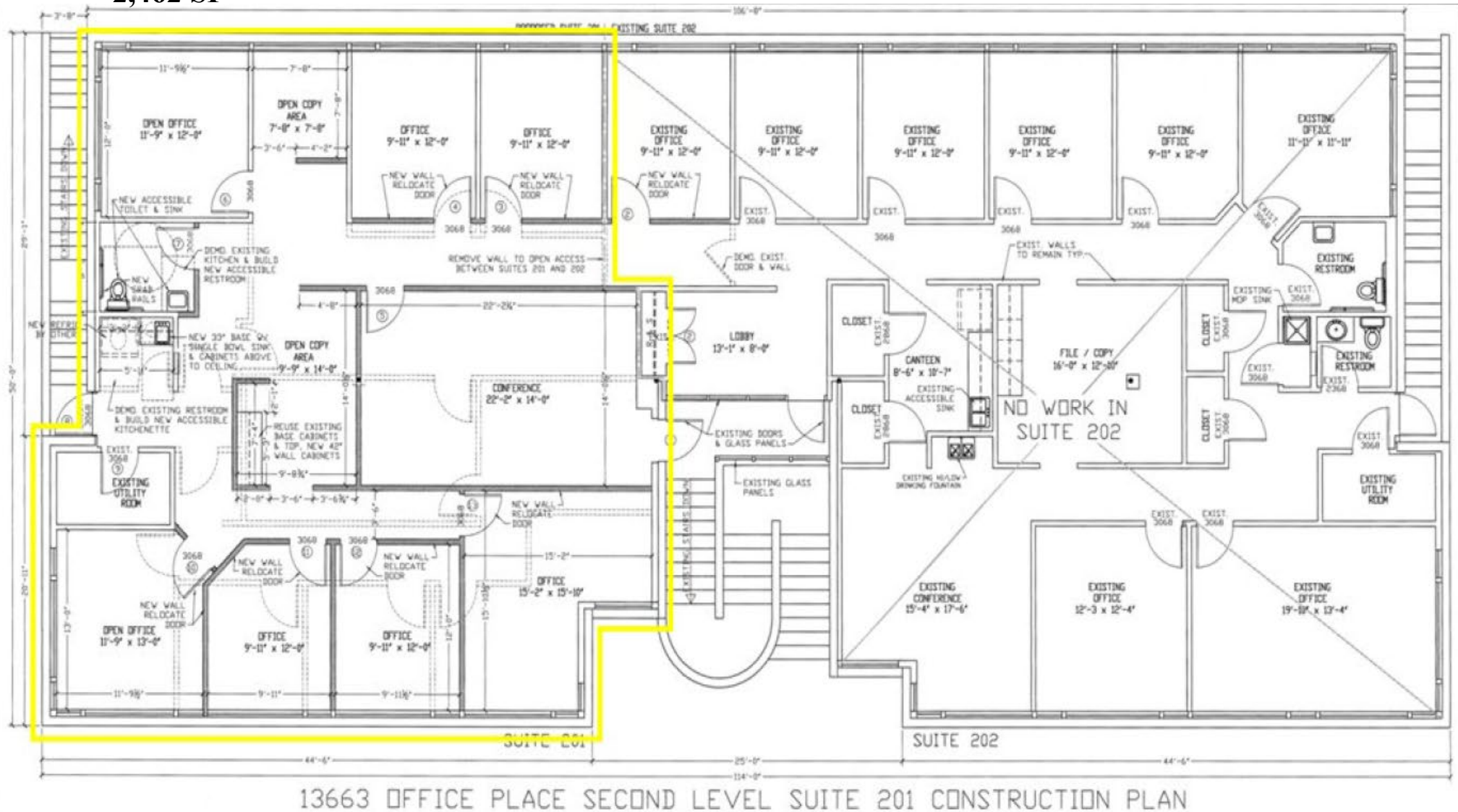

rlt

R. L. Travers & Associates, Inc.

Post Office Box 686
Springfield, Virginia 22150
P: 703.339.0100
F: 703.550.8815
www.rltinc.net

For more information, please
contact:

Guy Travers, Principal Broker
703.339.0100
gtravers@rltinc.net

Disclaimer: We have in preparing this information, used our best endeavors to ensure that the information contained herein is true and accurate, and deemed to be a reliable reflection of market values or has been secured from sources we believe to be reliable, but we make no representation, guarantee or warranties, expressed or implied, as to the accuracy of the information complete, or reliable, current or error-free and assume no responsibility for any errors or omissions contained therein. All references to age, square footage, income, and expenses are approximate. This is not a survey, any pictures, images, or drawings are only for illustrative purposes. Any party should conduct their own independent investigations and rely solely on those results. *This is not intended as a listing solicitation for a property currently listed with another broker.*

Prince William County, VA

Demographics:

Age

36.7

Median age

about 90 percent of the figure in Virginia: 39.3

a little less than the figure in United States: 39.2

Population by age category

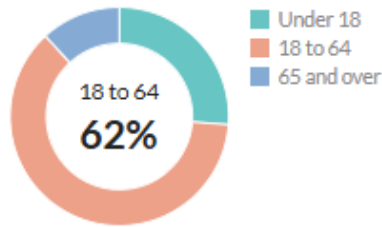

Population by age range

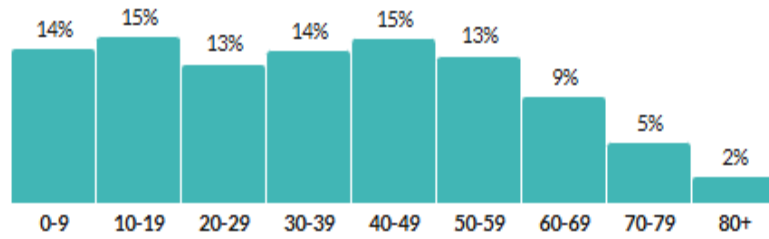

Race & Ethnicity

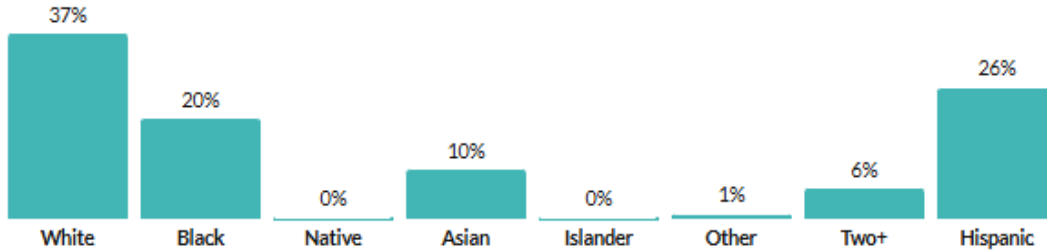

* Hispanic includes respondents of any race. Other categories are non-Hispanic.

Gender

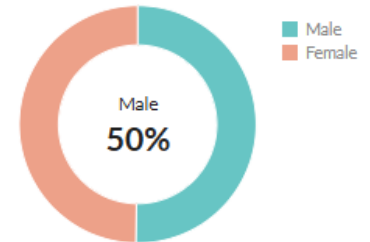

Economics:

Income

\$49,586

Per capita income

about the same as the amount in Virginia: \$48,689

about 10 percent higher than the amount in United States: \$43,313

Poverty

6.7%

Persons below poverty line

about two-thirds of the rate in Virginia: 10.2%

about half the rate in United States: 12.5%

Household income

\$131,047

Median household income

about 1.5 times the amount in Virginia: \$89,931

more than 1.5 times the amount in United States: \$77,719

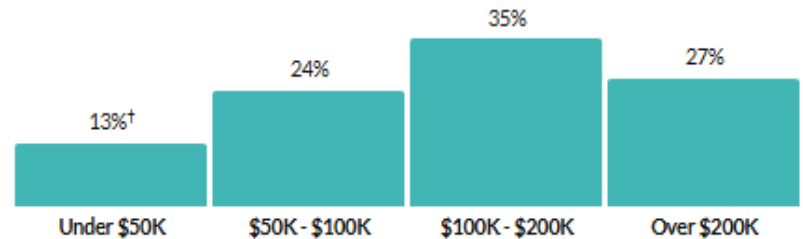

Means of transportation to work

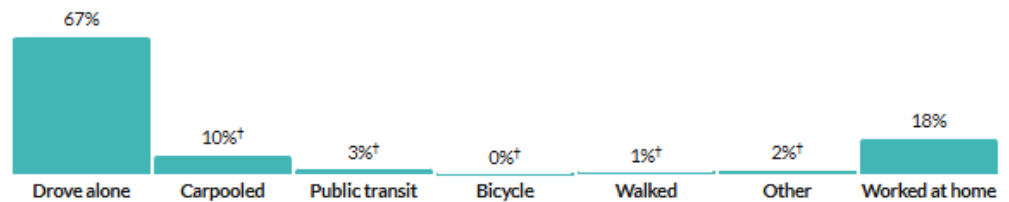

* Universe: Workers 16 years and over

*Citation: U.S. Census Bureau (2023). American Community Survey 1-year estimates. Retrieved from Census Reporter Profile page for Prince William County, VA

<<http://censusreporter.org/profiles/05000US51153-prince-william-county-va/>>

*Citation: U.S. Census Bureau (2023). American Community Survey 5-year estimates. Retrieved from Census Reporter Profile page for Prince William County, VA

<<http://censusreporter.org/profiles/05000US51153-prince-william-county-va/>>

rlt

R. L. Travers & Associates, Inc.

Post Office Box 686
Springfield, Virginia 22150
P: 703.339.0100
F: 703.550.8815
www.rltinc.net

For more information, please
contact:

Guy Travers, Principal Broker
703.339.0100
gtravers@rltinc.net

Disclaimer: We have in preparing this information, used our best endeavors to ensure that the information contained herein is true and accurate, and deemed to be a reliable reflection of market values or has been secured from sources we believe to be reliable, but we make no representation, guarantee or warranties, expressed or implied, as to the accuracy of the information complete, or reliable, current or error-free and assume no responsibility for any errors or omissions contained therein. All references to age, square footage, income, and expenses are approximate. This is not a survey, any pictures, images, or drawings are only for illustrative purposes. Any party should conduct their own independent investigations and rely solely on those results. *This is not intended as a listing solicitation for a property currently listed with another broker.*

Prince William County, VA

Housing & Families:

Units & Occupancy

163,543

Number of housing units

Virginia: 3,717,625

United States: 145,333,460

Occupied vs. Vacant

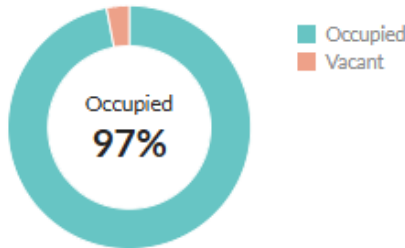

3.1

Persons per household

about 25 percent higher than the figure in Virginia: 2.5

about 25 percent higher than the figure in United States: 2.5

Social:

Educational attainment

89.6%

High school grad or higher

about the same as the rate in Virginia: 91.5%

about the same as the rate in United States: 89.8%

Language

38%

Persons with language other than English spoken at home

more than double the rate in Virginia: 17.8%

more than 1.5 times the rate in United States: 22.5%

Value of owner-occupied housing units

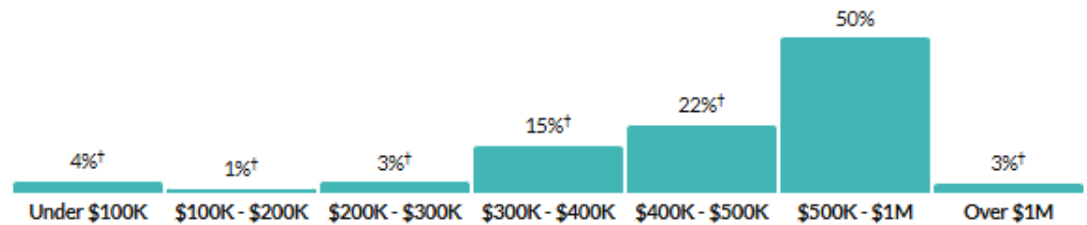

Value

\$532,600

Median value of owner-occupied housing units

about 1.4 times the amount in Virginia: \$382,900

about 1.5 times the amount in United States: \$340,200

Population by household type

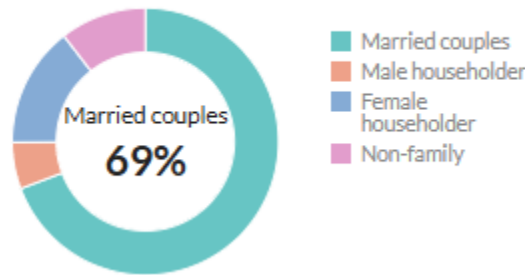

Types of structure

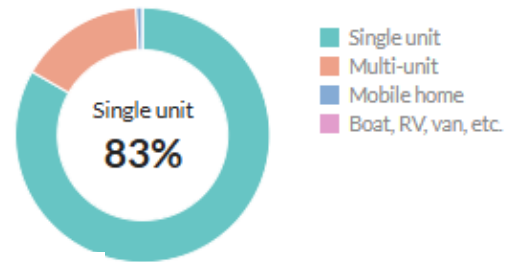

Households

158,620

Number of households

Virginia: 3,402,670

United States: 131,332,360

Population by highest level of education

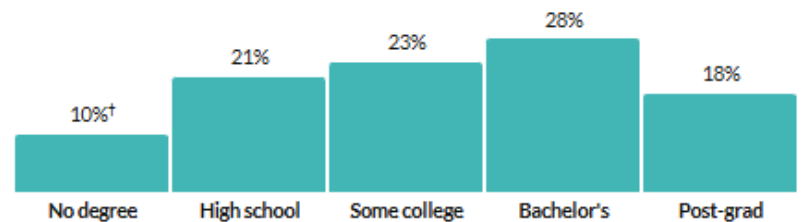

* Universe: Population 25 years and over

Language at home, adults 18+

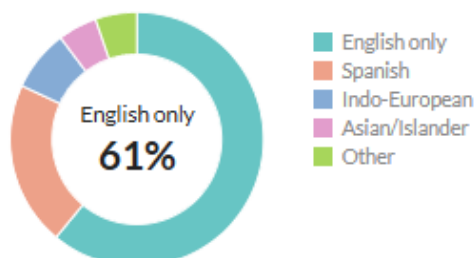

*Citation: U.S. Census Bureau (2023). American Community Survey 1-year estimates. Retrieved from Census Reporter Profile page for Prince William County, VA
<<http://censusreporter.org/profiles/05000US51153-prince-william-county-va/>>

*Citation: U.S. Census Bureau (2023). American Community Survey 5-year estimates. Retrieved from Census Reporter Profile page for Prince William County, VA
<<http://censusreporter.org/profiles/05000US51153-prince-william-county-va/>>

rlt

R. L. Travers & Associates, Inc.

Post Office Box 686
Springfield, Virginia 22150
P: 703.339.0100
F: 703.550.8815
www.rltinc.net

For more information, please
contact:

Guy Travers, Principal Broker
703.339.0100
gtravers@rltinc.net

Disclaimer: We have in preparing this information, used our best endeavors to ensure that the information contained herein is true and accurate, and deemed to be a reliable reflection of market values or has been secured from sources we believe to be reliable, but we make no representation, guarantee or warranties, expressed or implied, as to the accuracy of the information complete, or reliable, current or error-free and assume no responsibility for any errors or omissions contained therein. All references to age, square footage, income, and expenses are approximate. This is not a survey, any pictures, images, or drawings are only for illustrative purposes. Any party should conduct their own independent investigations and rely solely on those results. *This is not intended as a listing solicitation for a property currently listed with another broker.*

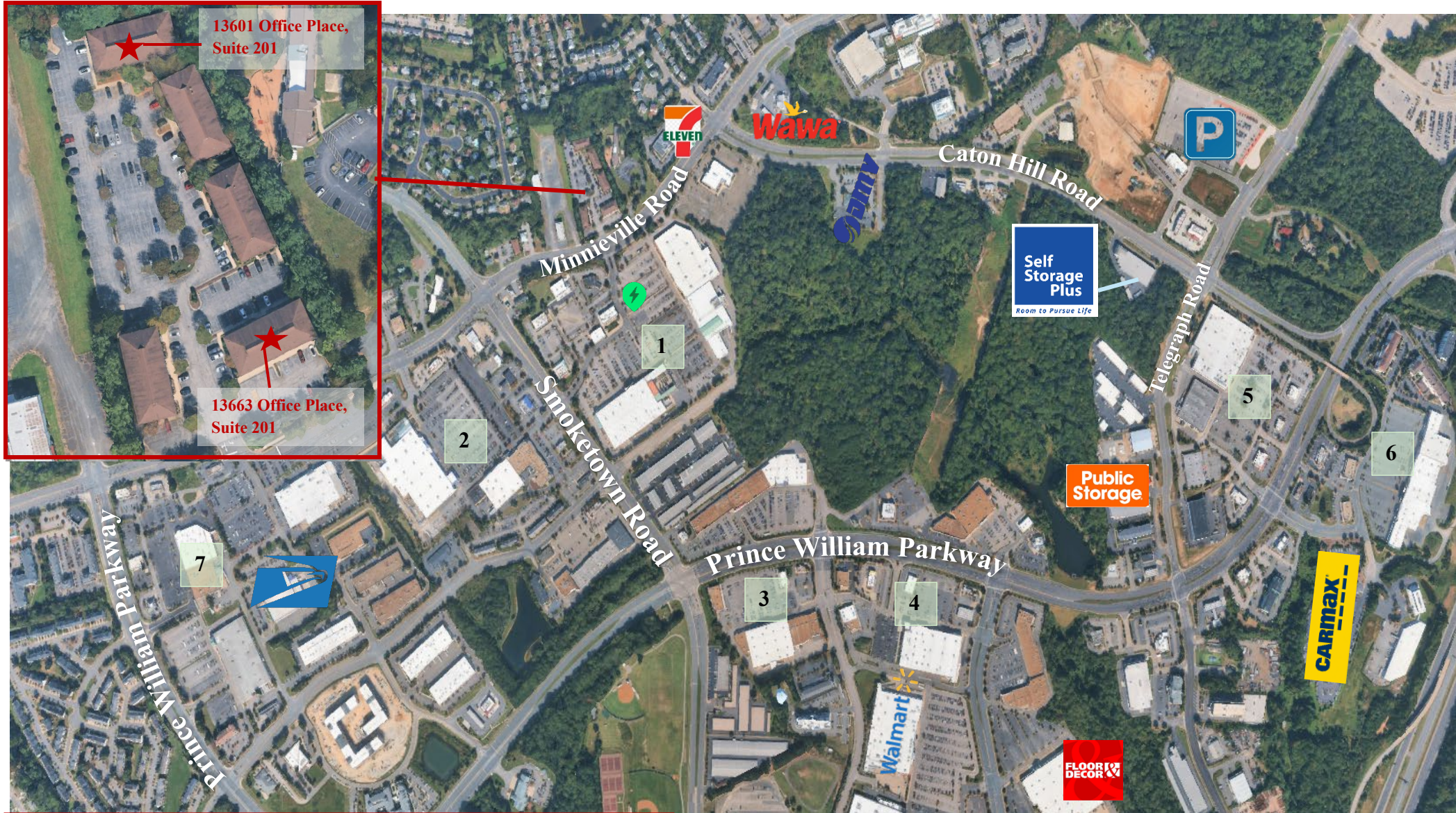

1: Centre at Rollingwood – Shopping Center (Kohls, Global Food, Home Depot, AutoZone, Hallmark Shop, TD Bank, Carrabba's Italian Grill, Charcoal Chicken, New York Pizza)

2: Smoketown Plaza (IHOP, Wingstop, Subway, Aldi, Wells Fargo Bank, Lowes, & more)

3: Smoketown Station (Hobby Lobby, Advance Auto Parts, Mission BBQ, Taco Bell, Noodles and Company & more)

4: Smoketown Station Block 2 (LA Fitness, DICK'S Sporting Goods, Verizon, Starbucks, Exxon, & McDonalds)

5: Parkway Crossing West (Target, Panera Bread, Wendy's, & Famous Dave's)

6: Parkway Crossing East (Chick-Fil-A, Starbucks, & Pizza, ColdStone Creamery, & Mobil Gas Station)

7: Noblewood Plaza (Trusit Bank, BJ's Wholesale Club, BJ's Gas Station, Shell Gas Station, DMV Iron Gym, McDonalds, Applebee's, & Arepas Capitol)



R. L. Travers & Associates, Inc.

Post Office Box 686
Springfield, Virginia 22150
P: 703.339.0100
F: 703.550.8815
www.rltinc.net

For more information, please contact:
Guy Travers, Principal Broker
703.339.0100
gtravers@rltinc.net

Disclaimer: We have in preparing this information, used our best endeavors to ensure that the information contained herein is true and accurate, and deemed to be a reliable reflection of market values or has been secured from sources we believe to be reliable, but we make no representation, guarantee or warranties, expressed or implied, as to the accuracy of the information complete, or reliable, current or error-free and assume no responsibility for any errors or omissions contained therein. All references to age, square footage, income, and expenses are approximate. This is not a survey, any pictures, images, or drawings are only for illustrative purposes. Any party should conduct their own independent investigations and rely solely on those results. *This is not intended as a listing solicitation for a property currently listed with another broker.*