

# 52,800 SF

## Industrial space for sublease



# 120 Williamette Lane

**Bowling Green, KY 42101**

**Powell Spears, SIOR**

JLL  
502.394.2509  
powell.spears@jll.com

**Matt Hartlage, SIOR**

JLL  
502.394.2517  
matt.hartlage@jll.com

### Property specifications

- 52,800 SF available
- 370 SF office area
- (1) drive-in door
- 20 trailer drops (expandable)
- 10 equipped dock doors
- Ample parking
- Fenced truck court



Although information has been obtained from sources deemed reliable, neither Owner nor JLL makes any guarantees, warranties or representations, express or implied, as to the completeness or accuracy as to the information contained herein. Any projections, opinions, assumptions or estimates used are for example only. There may be differences between projected and actual results, and those differences may be material. The Property may be withdrawn without notice. Neither Owner nor JLL accepts any liability for any loss or damage suffered by any party resulting from reliance on this information. If the recipient of this information has signed a confidentiality agreement regarding this matter, this information is subject to the terms of that agreement. ©2024. Jones Lang LaSalle IP, Inc. All rights reserved.

# 52,800 SF

## Industrial space for lease

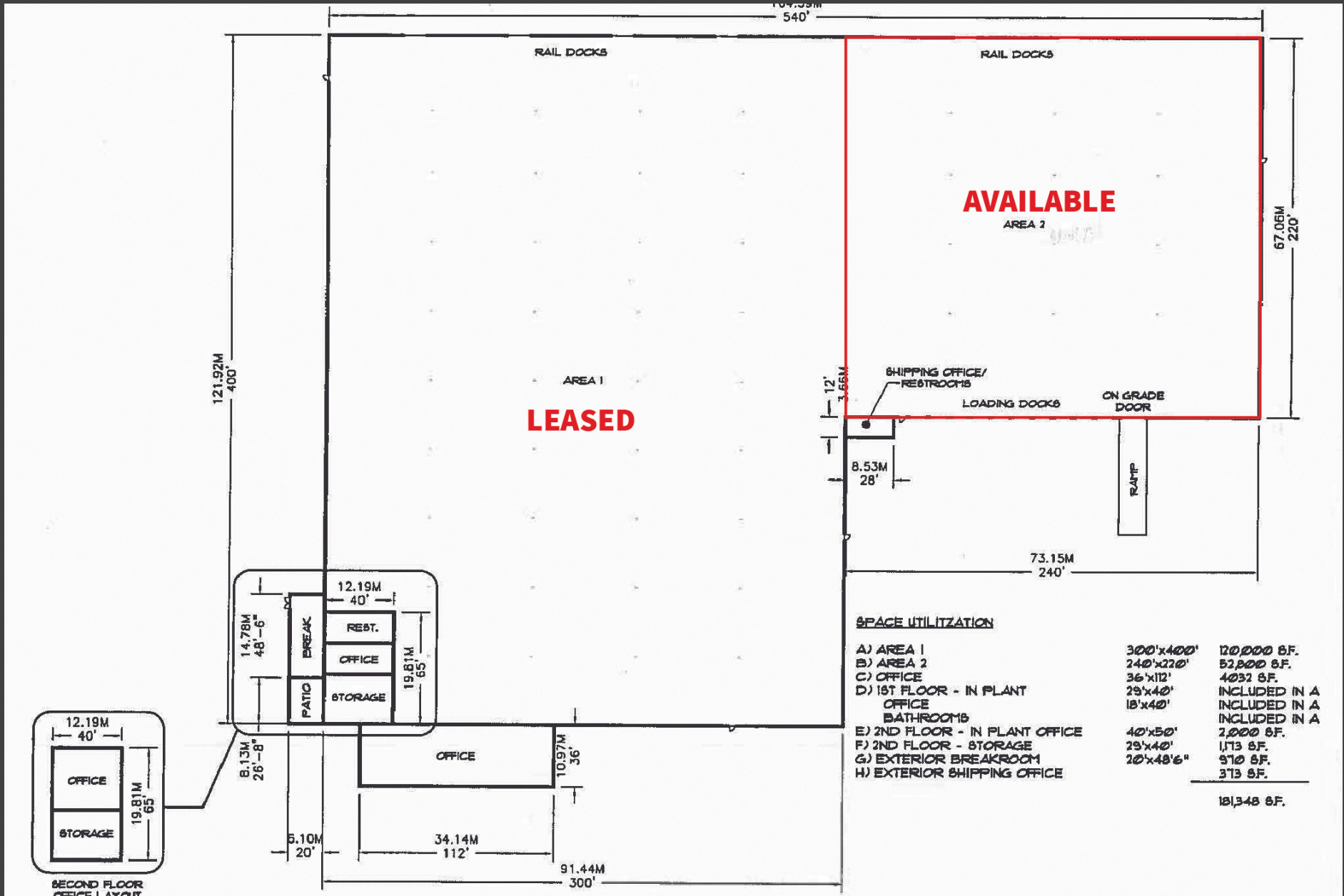

**SPACE UTILIZATION**

A) AREA 1	300'x400'	120,000 SF.
B) AREA 2	240'x220'	52,800 SF.
C) OFFICE	36'x112'	4,032 SF.
D) 1ST FLOOR - IN PLANT OFFICE BATHROOMS	29'x40' 18'x40'	INCLUDED IN A INCLUDED IN A
E) 2ND FLOOR - IN PLANT OFFICE	40'x50'	2,000 SF.
F) 2ND FLOOR - STORAGE	29'x40'	1,173 SF.
G) EXTERIOR BREAKROOM	20'x48'6"	970 SF.
H) EXTERIOR SHIPPING OFFICE		373 SF.

181,348 SF.

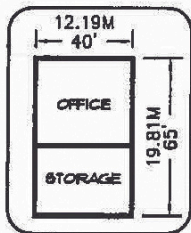

SECOND FLOOR OFFICE LAYOUT