

3200 W. Higgins Rd. Hoffman Estates, IL



Christine Simek

630.473.5070

christine@xroadsadvisors.com

Introduction

Situated in Hoffman Estates, this multi-tenant medical building is an excellent option for any medical practice eager to embark on a new venture or to grow their already successful operations. Nestled within a bustling commercial district, the location offers convenient access to major highways, public transportation and is in close proximity to Ascension Hospital making it an ideal hub for practices and employees. The building boasts modern amenities, ample parking, and customizable spaces that cater to a variety of business needs. Plus, the vibrant community of Hoffman Estates offers a wealth of networking opportunities, dining options, and recreational activities, enhancing the work-life balance for your team.

Building Features

- ***One medical office suite left!!!***
- Suite 105 is ideally located at the north end of the first floor with ideal access to and from parking lot
- ALL medical specialties under one roof, including Vascular, Pain Specialists, Lab, MRI, Physical Therapy, Podiatry and more
- Build to suit options available which include up to two private ADA compliant washrooms
- New 60 ton rooftop HVAC system recently installed
- Newly seal coated and striped parking lot
- ADA Accessible
- RBA: 21, 635 SF
- 1.89 AC
- Class B
- Built in 2000



Exterior Photos



Interior Photos



Site Plan: Existing Conditions



Potential Rendering of Medical Buildout

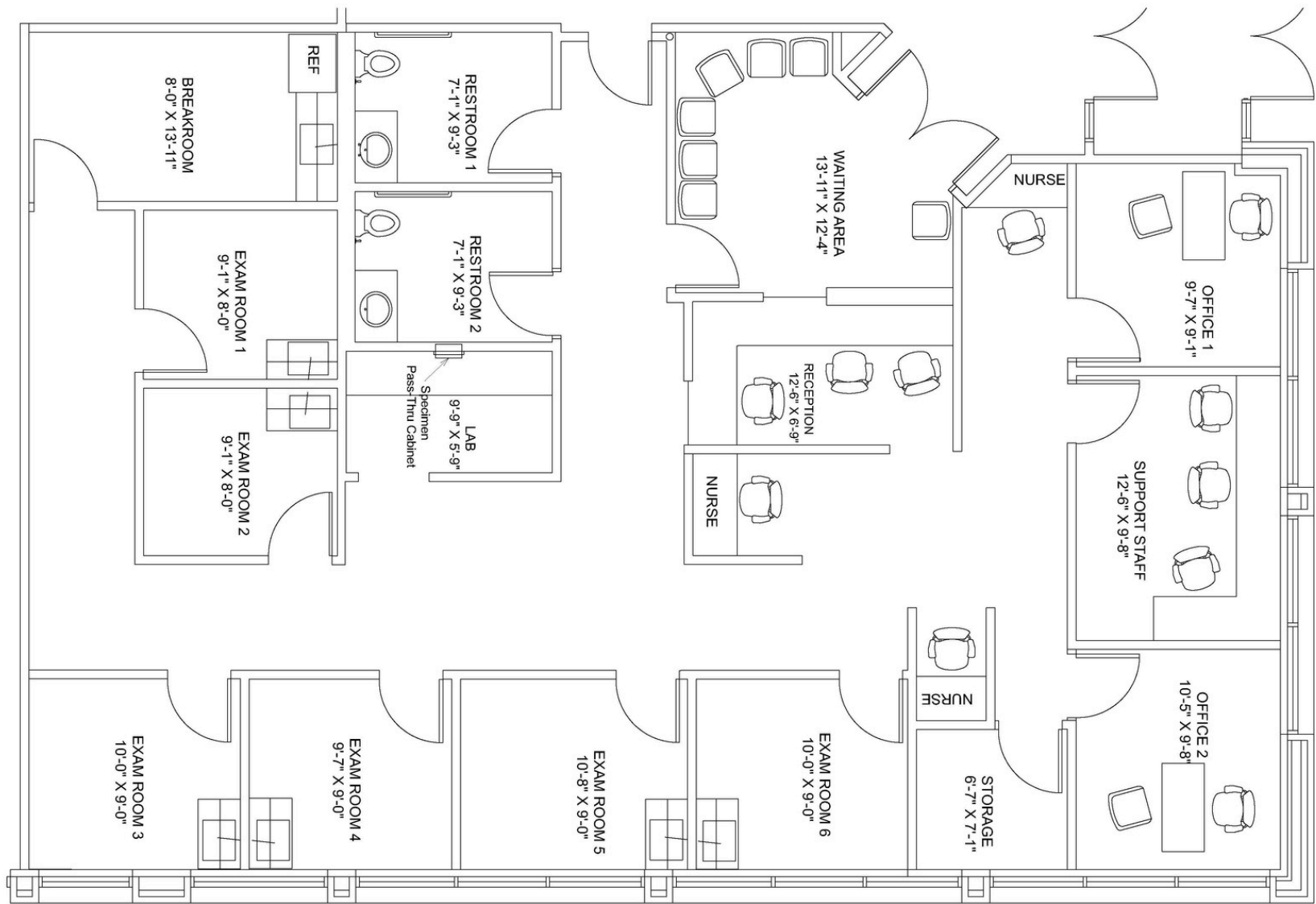

Location

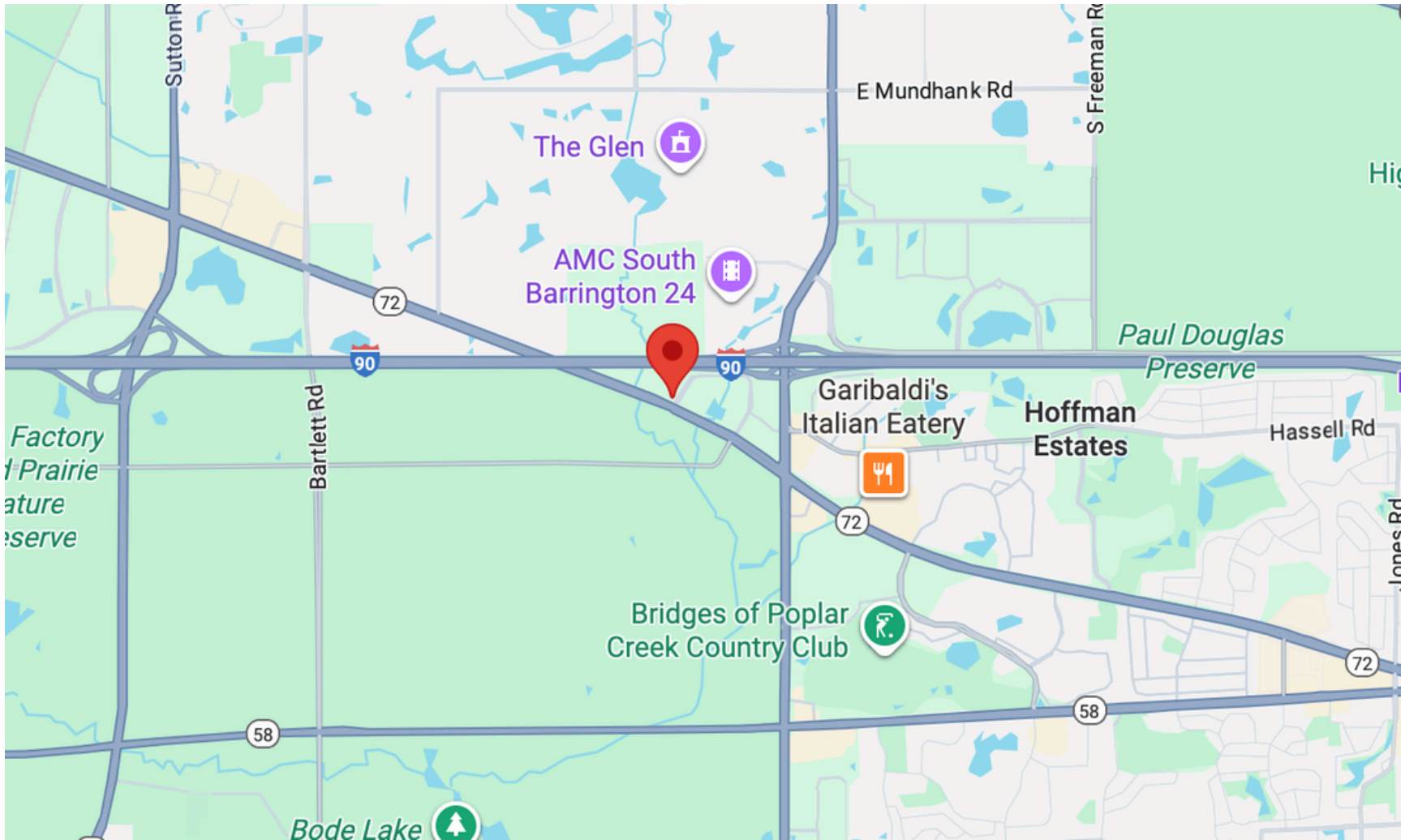

3200 W. Higgins Rd.
Hoffman Estates, IL



Christine Simek
630.473.5070

christine@xroadsadvisors.com