

Syracuse Medical Outpatient Center



Building for Sale or Lease

Prime Medical Outpatient Center

3234 Antelope Drive, Syracuse UT

Available: 4,000 - 20,000 SF total

Asking: \$30.00 NNN

- + Generous Tenant Improvement Allowance
- + Monument & Building Signage Available
- + Prime location with visibility off Antelope Drive and West Davis Corridor
- + Building completion Q4 2026
- + Ownership Opportunities Available, call Rick for more details!

Site Plan

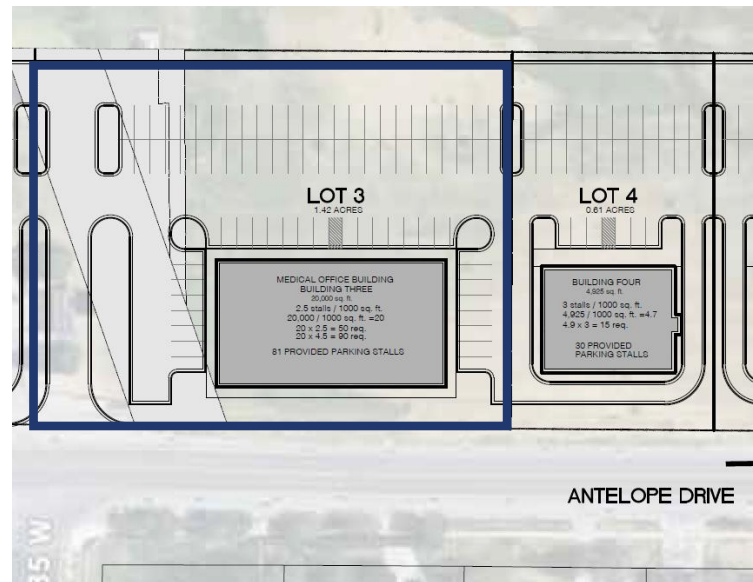

CONTACT

Rick Peterson

801 792 7425

rick@fortstreetpartners.com



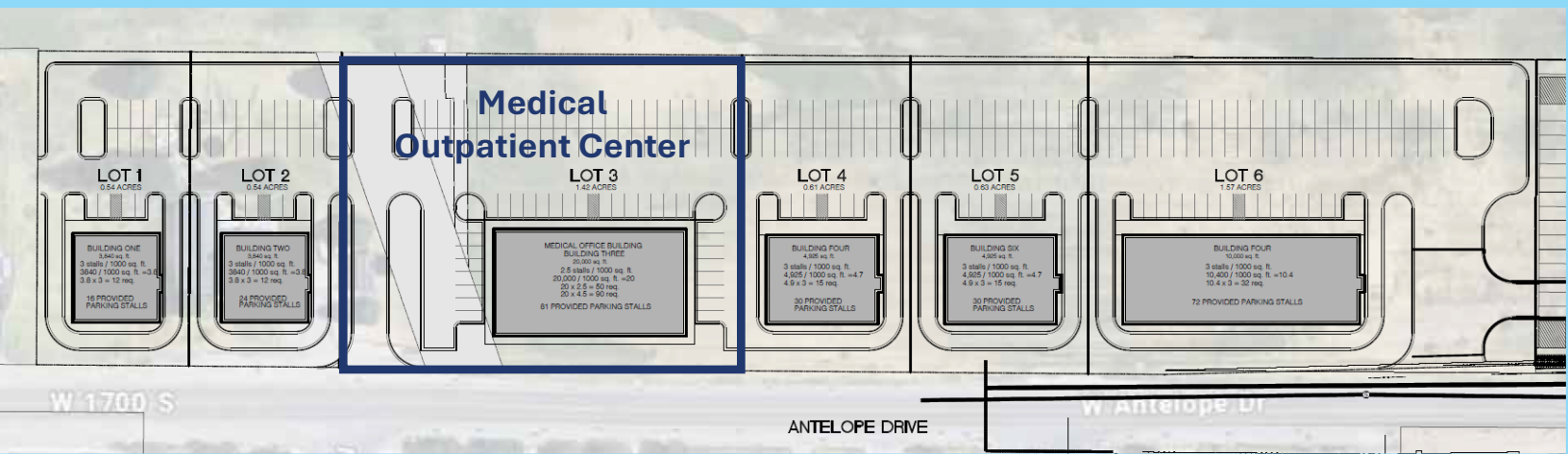

DEMOGRAPHICS

1 MILE

3 MILE

5 MILE

Population

	1 MILE	3 MILE	5 MILE
2024	16,526	78,393	154,735

Households

	1 MILE	3 MILE	5 MILE
2024	4,717	23,532	49,533

Average HH Income

	1 MILE	3 MILE	5 MILE
2025	\$135,554	\$122,264	\$112,696

CONTACT

Rick Peterson

801 792 7425

rick@fortstreetpartners.com

