



thehive

OFFICE MADE EASY

**Introducing the next phase of the Hive at 190 S LaSalle!**

We are taking the Hive concept to another floor. Delivering 1Q24, the entire 6th floor will be a brand-new collection of ready to occupy suites from 1,300 – 3,900 RSF. Add that to 190's impressive amenity package and innovative lobby, The Hive is an unbeatable value.

[Download Brochure](#)

- >> Quick, short-form license agreement
- >> Flexible lease terms
- >> Fully furnished and cabled
- >> The fastest, easiest move-in possible
- >> Flexible payment options
- >> Suites feature individual kitchenettes and conference rooms
- >> Additional exclusive meeting, lounge and bar space
- >> Individual suites with identity, ranging from 1,300 - 3,900 RSF
- >> Pricing inclusive of phone, internet, electric, security/access control

**Set pricing and commissions of \$2.00/SF per year for first three years.**

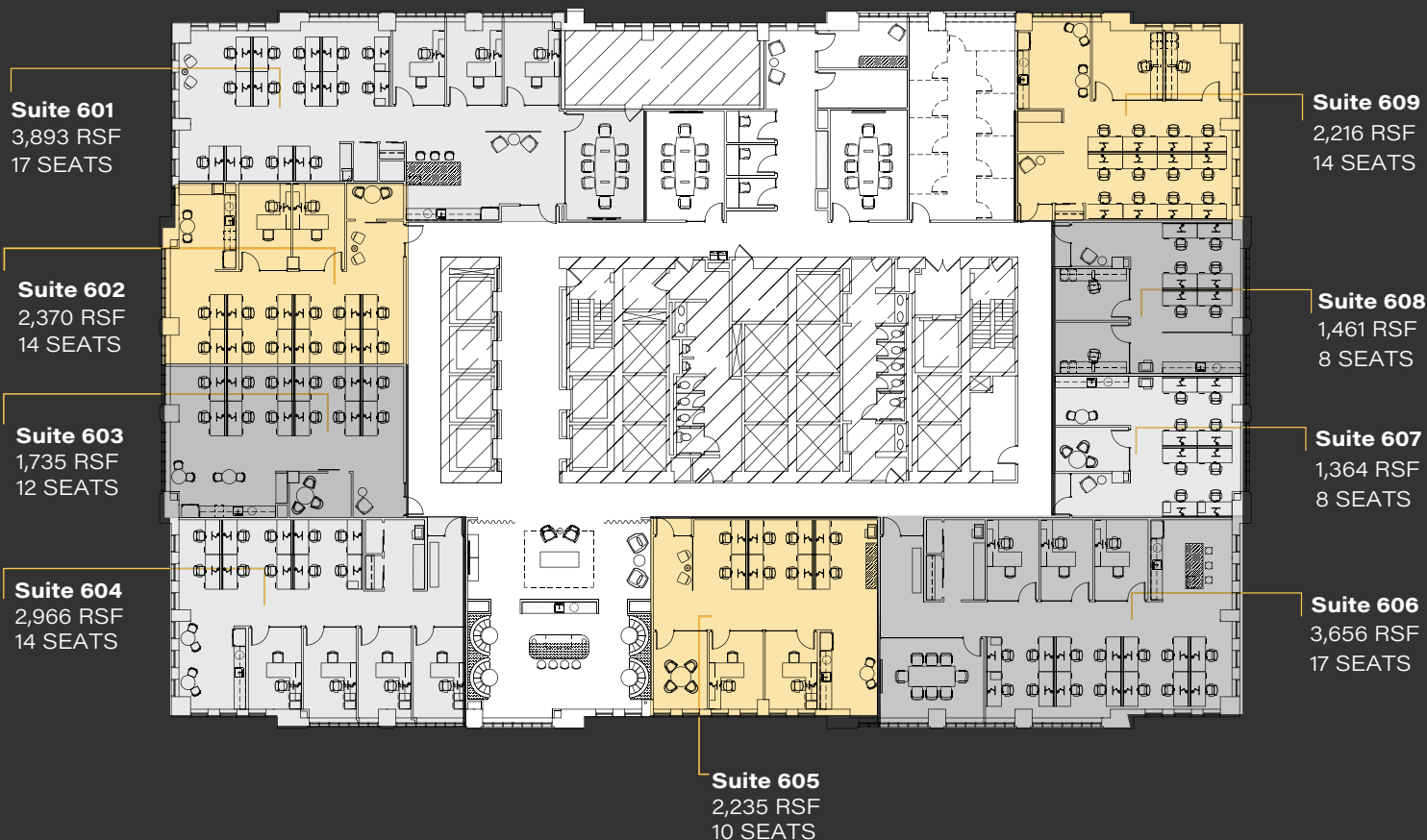

**MIKE CURRAN**  
MIKE.CURRAN@JLL.COM  
312 228 2079

**BELLE SPINELL**  
ISABELLA.SPINELL@JLL.COM  
312 245 4812

**BEACON**  
CAPITAL PARTNERS