

7,700 SQFT - 12726 CYPRESS VALLEY RD,
CYPRESS VALLEY BUSINESS PARK - BUILDING 4



DEED RESTRICTED BUSINESS PARK

- Land:** 0.5379 Acres | 23,432 sqft
- Construction:** Fully insulated Metal Buildings
Standing seam Roof
2nd floor Mezzanine
Premium interiors
- Eave Height:** 20'
- Loading:** Grade Level Loading
- Office:** 1085 SF of Office space
Well & Septic
- Utilities:** 3 Phase / 480 Volt / 200 amps
- Power:**



ECONOMIC DATA

LEASE PRICE Call for Information

ZAIN SHENWARI ZS Realty
Developer / Broker
zain@tnrg.net
D 832.479.6667

SITE MAP

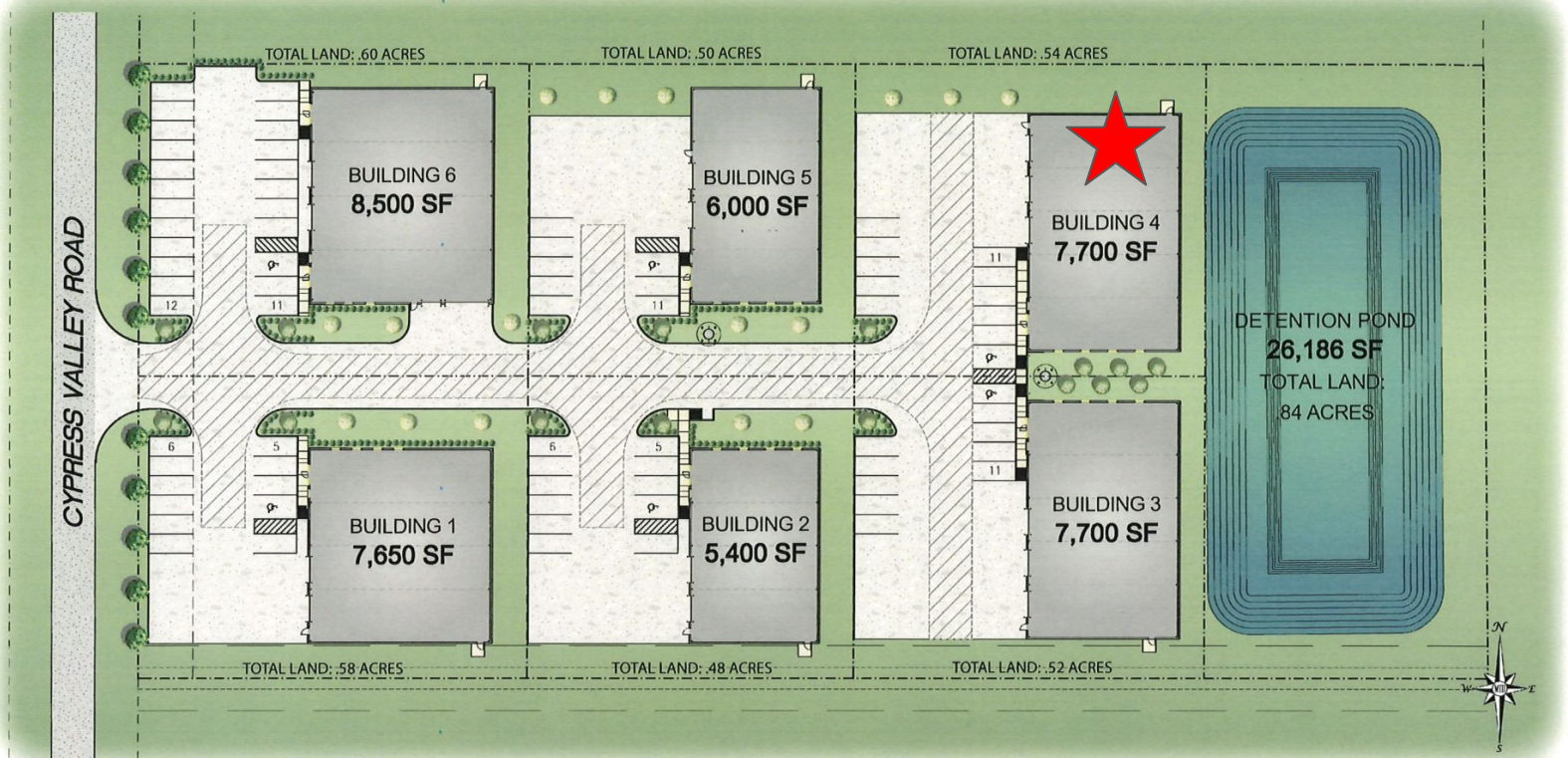

OFFICE LAYOUT

