

767 ISLINGTON ST. SECOND FLOOR 3 SUITE PROPOSAL C 5,724 SQ. FT.

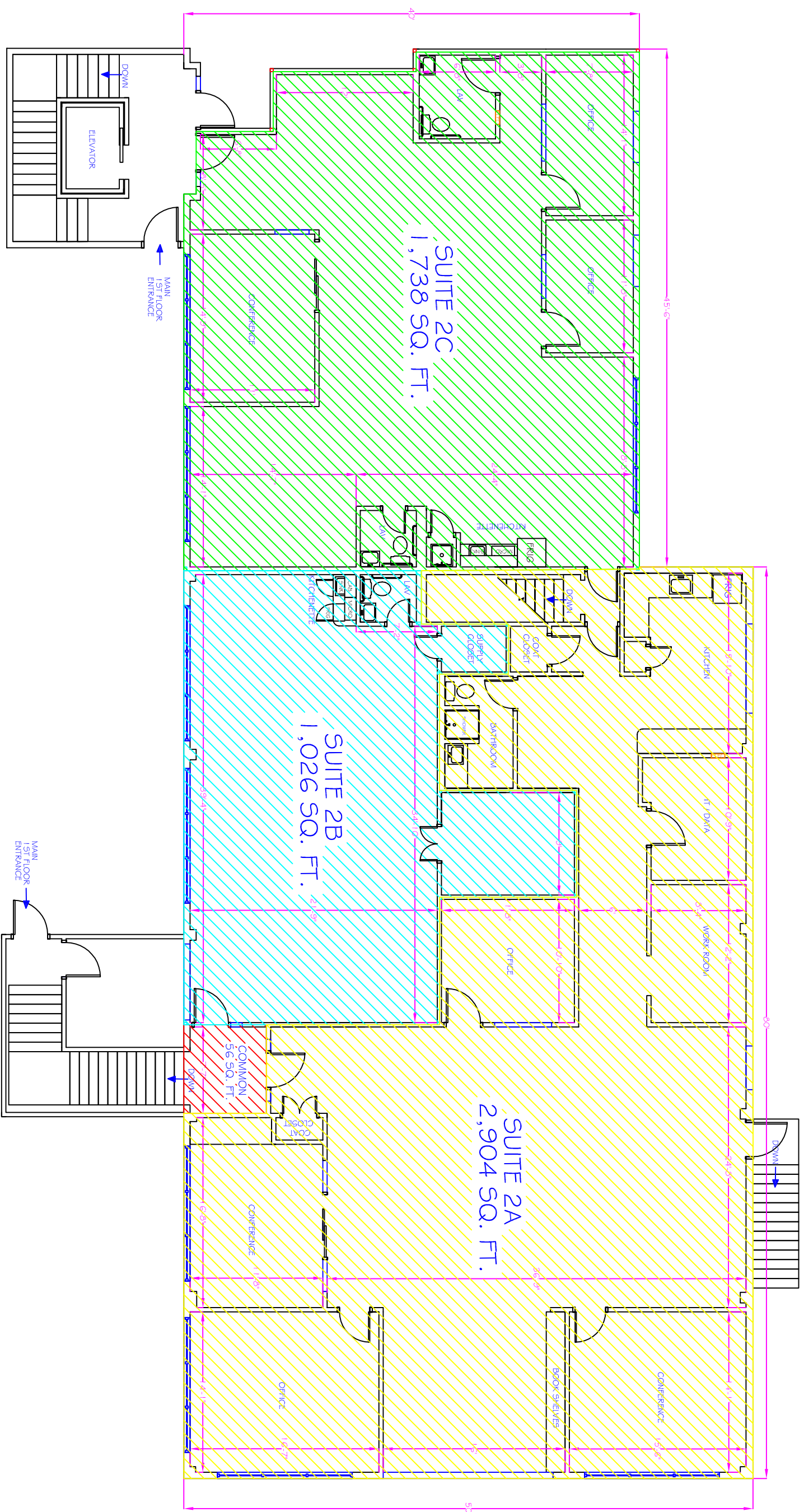

SPACE PLANNING
S U T I N S I
Assessing the use of your commercial building or residential space
SPACE PLANNING SOLUTIONS LLC.
DANVILLE, NH
Office 603 382-6483
Mobile 603 493-7142
www.spaceplanningsolutions.com

KEY:

- EXISTING WALLS
- ROOM ID & WINDOWS
- ELECTRICAL PANEL
- DIMENSIONS

No.	Revision/Issue	Date
1	EXISTING LAYOUT Drawn by: Tom Doyle	3/28/11
2	PROPOSAL A LAYOUT Drawn by: Tom Doyle	3/31/11
3	PROPOSAL B LAYOUT Drawn by: Tom Doyle	4/1/11
4	PROPOSAL C LAYOUT w/ SQUARE FOOTAGE Drawn by: Tom Doyle	4/8/11

Customer Name and Address
INSHALLAH REALTY TRUST
767 ISLINGTON ST.
PORTSMOUTH, NH, 03801
MICHAEL THIEL
PRESIDENT

Project Name and Address
HIDEAWAYS
2ND FLOOR
767 ISLINGTON ST
PORTSMOUTH, NH, 03801

Project
SUITE BREAKOUT

Date
APRIL 8, 2011

Scale
SCALED TO FIT

Sheet
7