

2800

SOUTH MAIN STREET
SANTA ANA, CA 92705



**OFFICE/FLEX CONDOMINIUM
AVAILABLE FOR SALE
±2,549 SQ. FT.**

PROPERTY FEATURES

- » ±1,772 SF of Office
- » High-rise Caliber Office Improvements
(\$110/ Sq.Ft. in Value to Reproduce)
- » 12' Ceiling Heights with Skylights
- » 777 SF of Warehouse
- » 1 GL Door
- » 200 Amps
- » CAT5 Wiring Throughout
- » Signage Identity on Main Street
- » Association dues: \$330/Mo (\$0.13/SF)

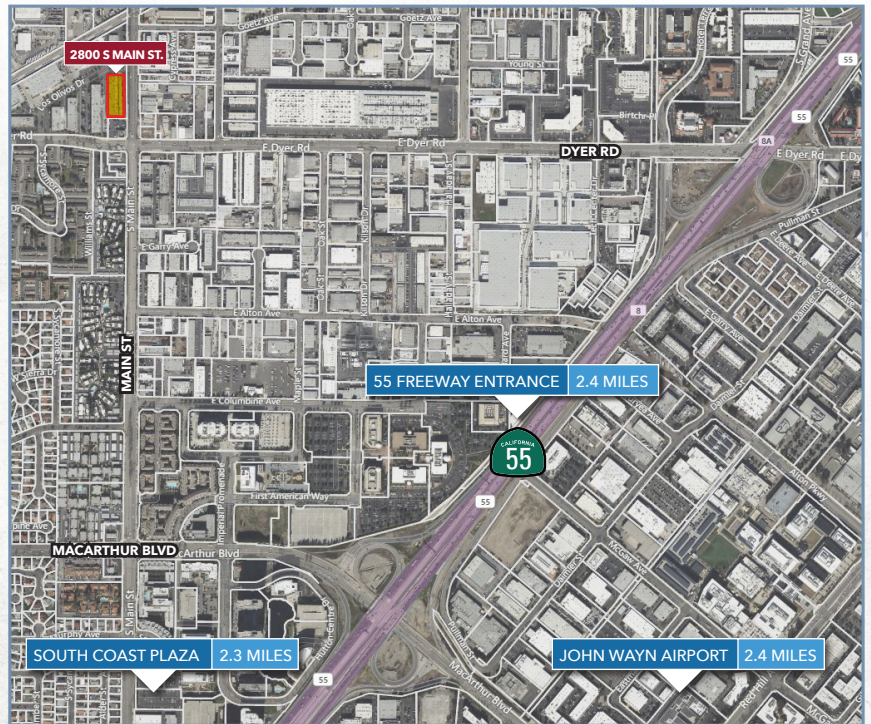

CHARLIE WINN

949.724.4763

cwinn@lee-associates.com

DRE #: 01151176

JOHN COLLINS

949.724.4757

[jcollins@lee-associates.com](mailto:john.collins@lee-associates.com)

DRE #: 01235509

GABRIELLE OWENS

949.724.4768

gowens@lee-associates.com

DRE #: 02198418



COMMERCIAL REAL ESTATE SERVICES
NEWPORT BEACH

The information contained herein has been obtained from the property owner or other third party and is provided to you without verification as to accuracy. We (Lee & Associates, its brokers, employees, agents, principals, officers, directors and affiliates) make no warranty or representation regarding the information, property, or transaction. You and your attorneys, advisors and consultants should conduct your own investigation of the property and transaction.

2800

SOUTH MAIN STREET
SANTA ANA, CA 92705

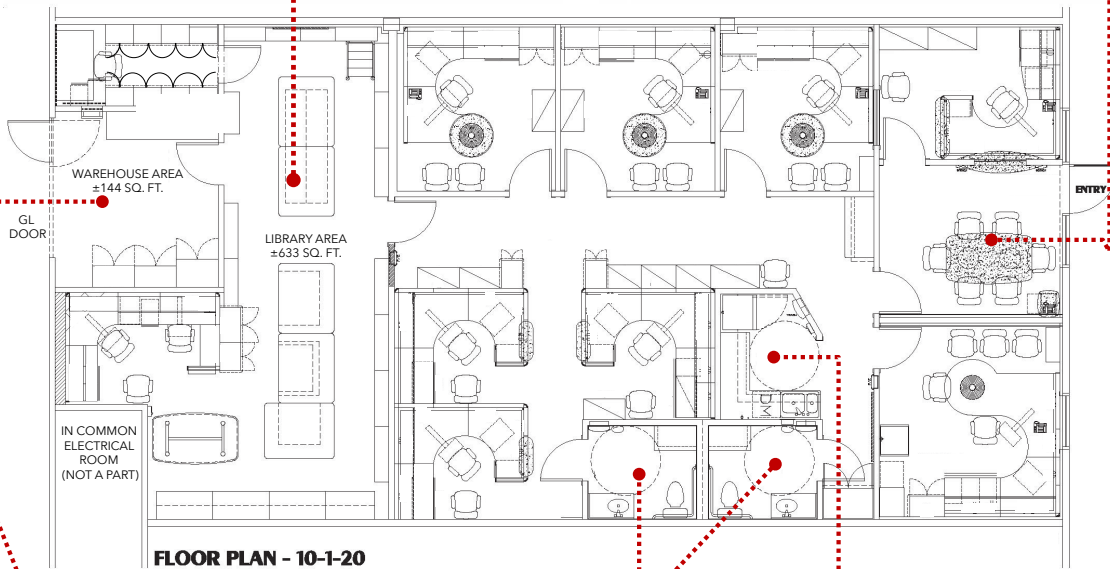

CHARLIE WINN
949.724.4763
cwinn@lee-associates.com
DRE #: 01151176

JOHN COLLINS
949.724.4757
jcollins@lee-associates.com
DRE #: 01235509

GABRIELLE OWENS
949.724.4768
gowens@lee-associates.com
DRE #: 02198418

LEE & ASSOCIATES
COMMERCIAL REAL ESTATE SERVICES
NEWPORT BEACH

The information contained herein has been obtained from the property owner or other third party and is provided to you without verification as to accuracy. We (Lee & Associates, its brokers, employees, agents, principals, officers, directors and affiliates) make no warranty or representation regarding the information, property, or transaction. You and your attorneys, advisors and consultants should conduct your own investigation of the property and transaction.