

FOR LEASE | INDUSTRIAL/WAREHOUSE

586 LEWISTON JUNCTION ROAD | AUBURN, ME



PROPERTY HIGHLIGHTS

- Access to rail spur located south of warehouse
- Ten (10) loading docks and seven (7) overhead doors
- 30± acres of Industrial Zoned land with frontage on Lewiston Junction Road and Cascades Drive
- Industrial Zoning, supporting a wide range of uses
- Offering suites from 7,000± SF to 42,624± SF

FOR LEASE | INDUSTRIAL/WAREHOUSE
586 LEWISTON JUNCTION ROAD | AUBURN, ME



OWNER	LJR Developers, LLC	CEILING HEIGHT	Warehouse 22'-30' Office/Lab 12'
BOOK/PAGE	10442/205	OUTDOOR STORAGE	Yes
BUILDING SIZE	123,359± SF	ELEVATORS	Yes, Passenger & Freight
AVAILABLE SPACES	Suite A(1): 27,072± SF (1st Fl, Warehouse) Suite C*: 8,860± SF (2nd Fl, Warehouse) Suite D(1)*: 7,000± SF (2nd Fl, Lab) Suite D(2)*: 13,421± SF (2nd Fl, Lab) Suite E*: 7,422± SF (3rd Fl, Office) *Accessed via passenger & freight elevator	LOADING DOCKS DRIVE IN DOORS	Ten (10) Docks Seven (7) Doors
LEASED SPACE	Suite A(2): 10,368± SF (1st Fl, Warehouse) Suite A(4): 5,184± SF (1st Fl, Warehouse) Suite A(3): 2,304± SF (1st Fl, Warehouse) Suite B: 31,400± SF (1st Floor Warehouse) Suite C: 5,000± SF (2nd Fl, Warehouse)	LAND AREA	30± Acres
ZONING	Industrial; Free Trade Zone	ROOF	Flat Metal
YEAR BUILT	1995 (Renovated in 2018)	POWER	7.5MW private substation Three phase 277v/480v Siemens 4160volt switchgear
STORIES	Three (3)	PARKING	60+ Spaces (Land Available for Additional Parking)
HEATING SYSTEM	Forced hot air and natural gas	LEASE PRICE	1st Floor: \$8.00/SF NNN 2nd Floor: \$5.00/SF NNN 3rd Floor: \$5.00/SF NNN
UTILITIES	Public water and sewer	NNN EXPENSES	\$3.29/SF



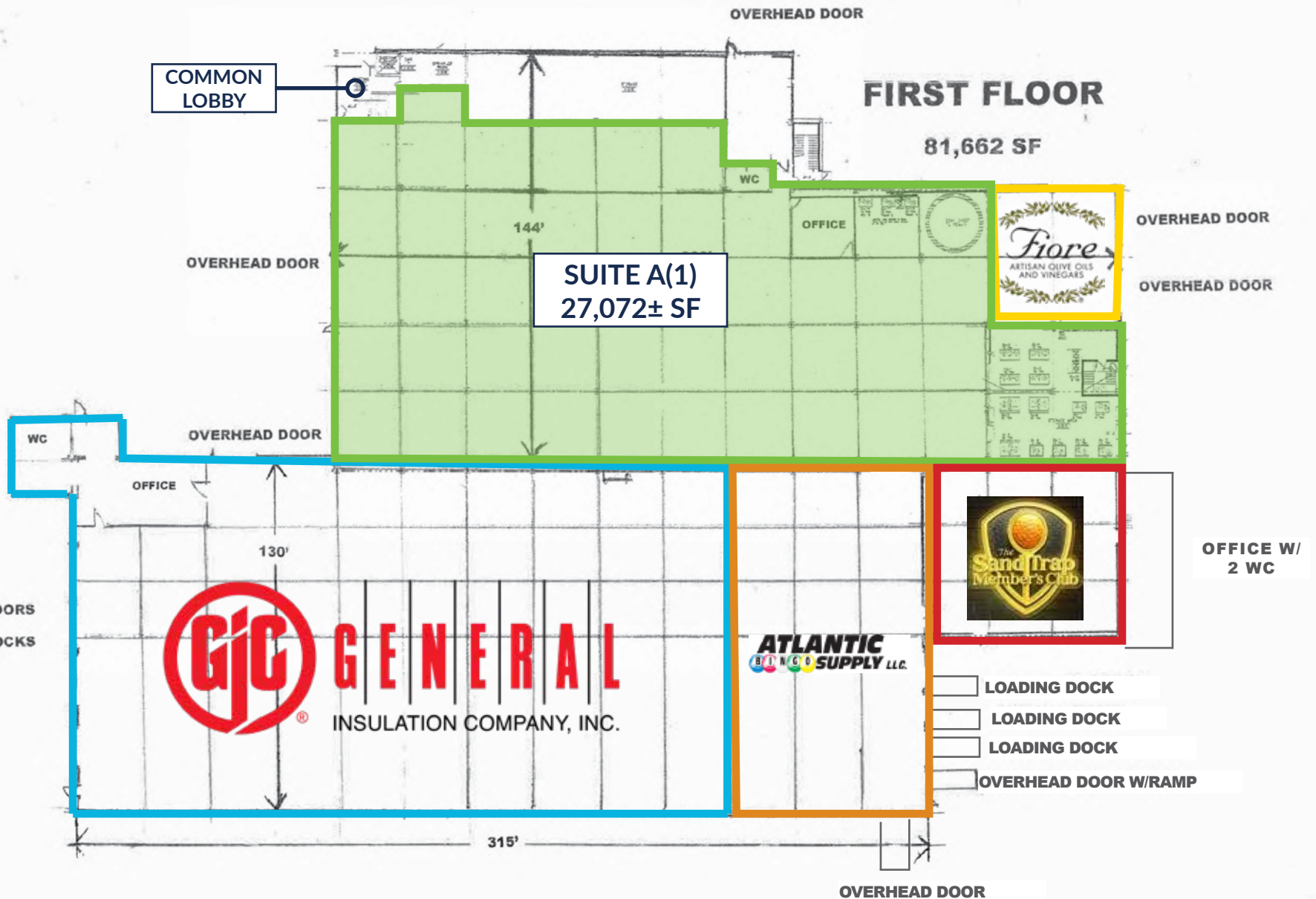

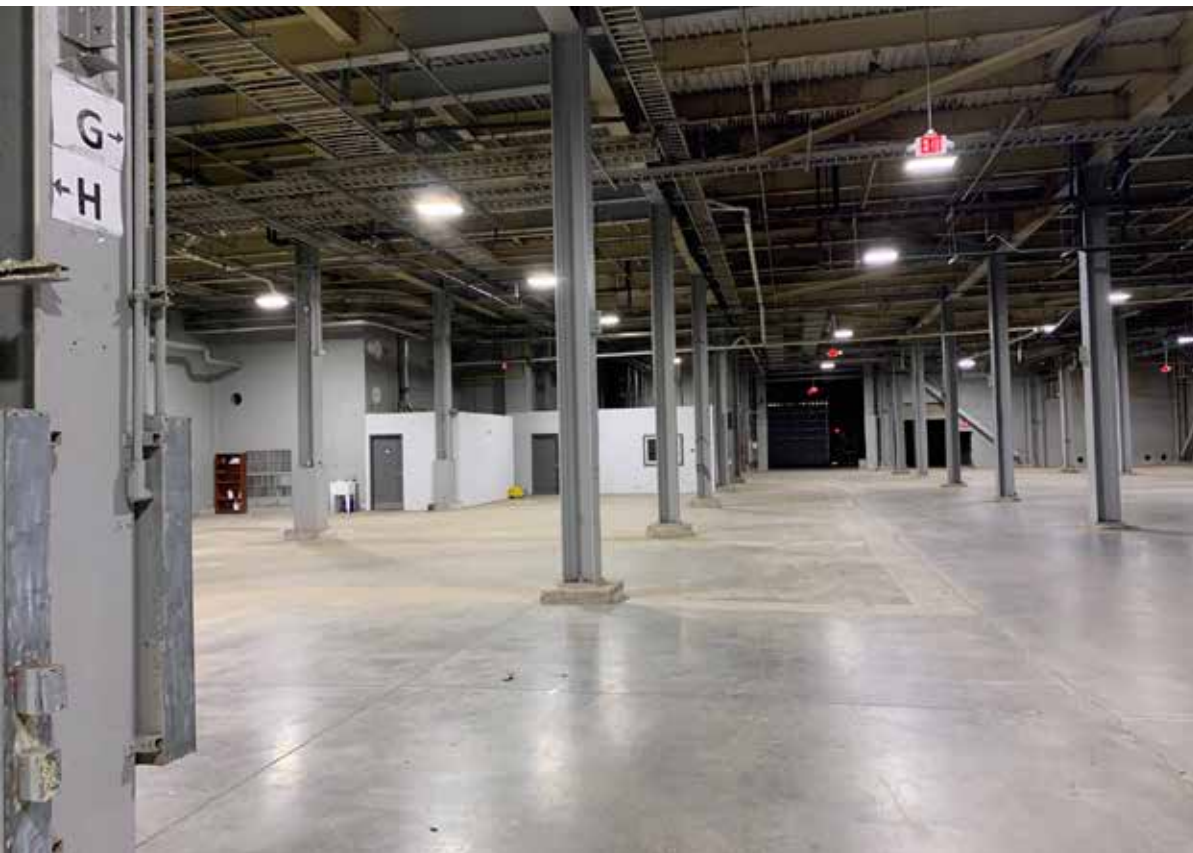



2ND & 3RD FLOOR PLANS

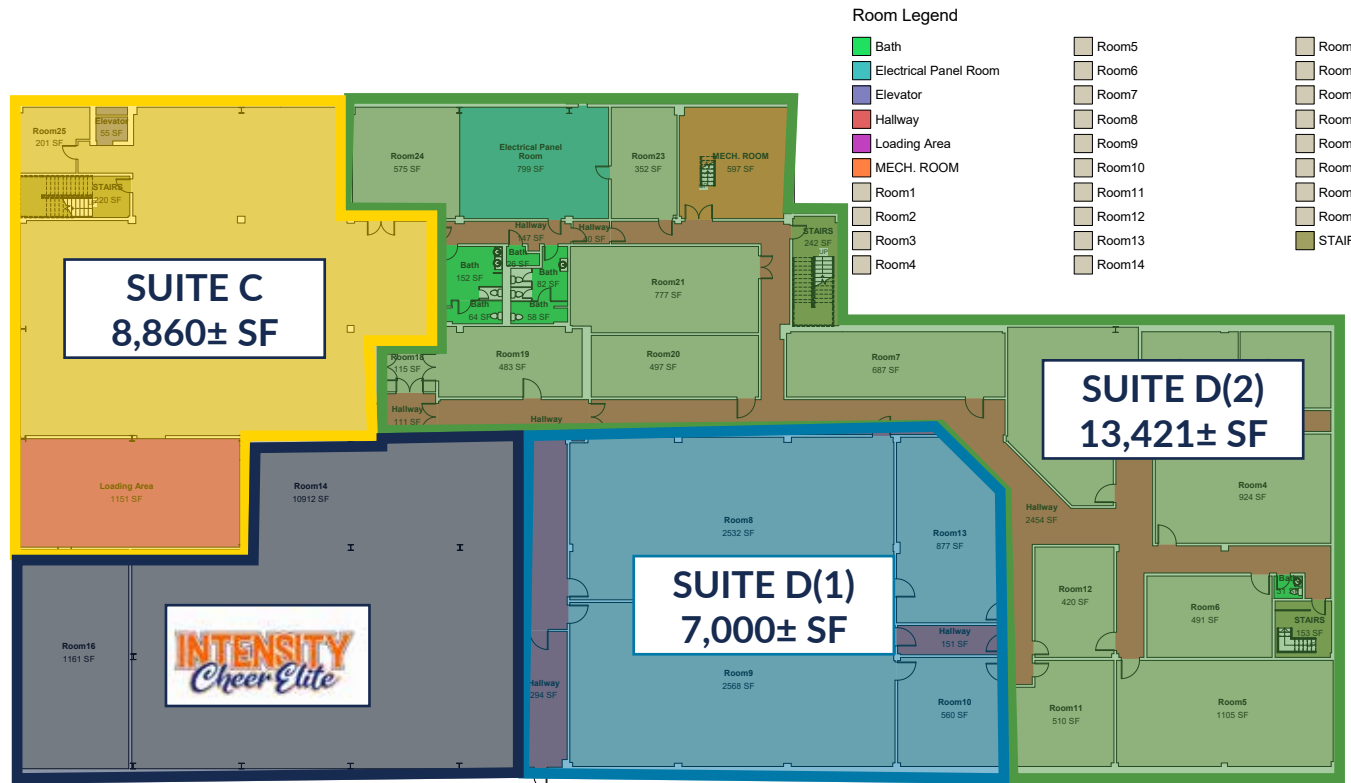

2ND FLOOR

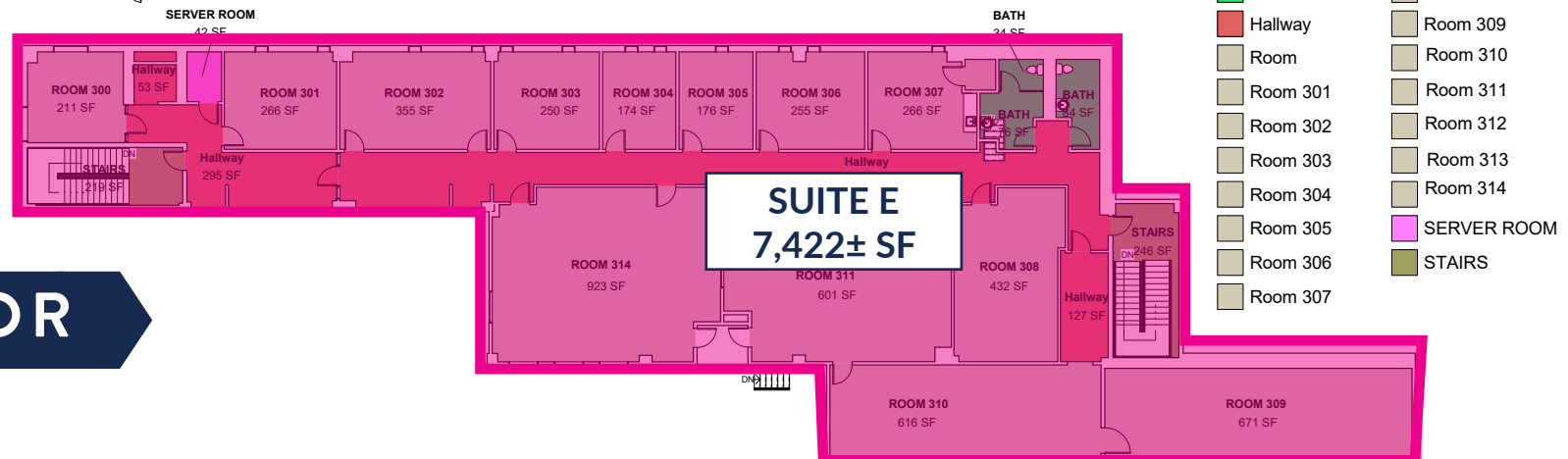

3RD FLOOR





CONTACT



CAMERON FOSTER
Broker
+1 207.553.1722 D
+1 703.717.1660 C
cfoster@boulos.com



CHRIS ROMANO
Associate
+1 207.553.1717 D
+1 207.233.1792 C
cromano@boulos.com



DREW SIGFRIDSON
Senior Partner
+1 207.553.1705 D
+1 207.831.5838 C
dsigfridson@boulos.com



©2025 The Boulos Company, Inc. All rights reserved. This information has been obtained from sources believed reliable but has not been verified for accuracy or completeness. You should conduct a careful, independent investigation of the property and verify all information. Any reliance on this information is solely at your own risk. The Boulos Company and The Boulos Company logo are service marks of The Boulos Company, Inc. All other marks displayed on this document are the property of their respective owners. Photos herein are the property of their respective owners. Use of these images without the express written consent of the owner is prohibited.