

621 INDENEER DRIVE

KERNERSVILLE, NC

for
LEASE



Positioned in the heart of the Triad, 621 Indeneer Dr offers exceptional accessibility just off Highway 66 and minutes from I-40. Located adjacent to the South Park Business Center, the property benefits from a highly visible, professional business park setting with strong connectivity throughout the region.

Type	Flex/Industrial	Parking Spaces	45	Loading Doors	1 Drive In
Building SF	25,000 Sf	Clear Height	16 Ft.	Sprinkler	Installed 1999
Site Size (Acres)	1.92 Acres	Column Spacing	25 Ft. X 50 Ft.	Lighting	Hi-Bay Lights
Office Size	5,000 Sf	Floor	6 In. Reinforced	Water/Sewer	City Of W-S
Devisable	Yes	Power	220 volts;	HVAC	Office & 10k SF
Zoning	Gi-S		3 Phase Service		Warehouse

NAI Piedmont Triad
Commercial Real Estate Services, World Wide

BEN STURGILL
BROKER
(O) 336.358.3229
(C) 336.848.3046
bsturgill@naipt.com

348 N Elm Street | Greensboro, NC 27101 | naipt.com

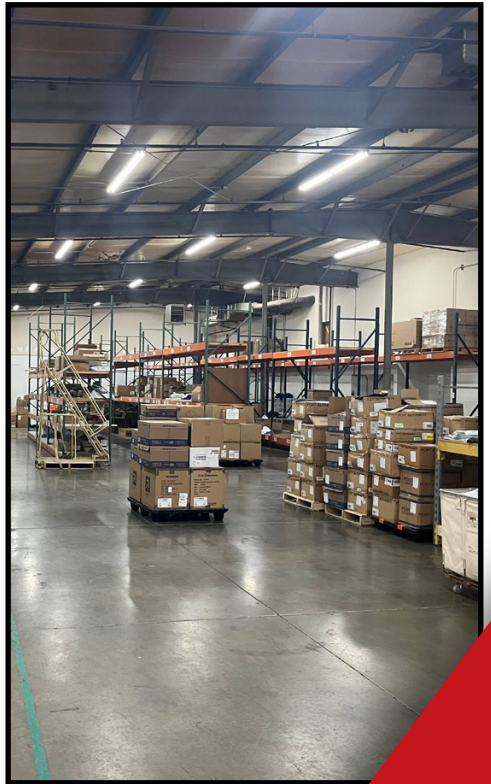
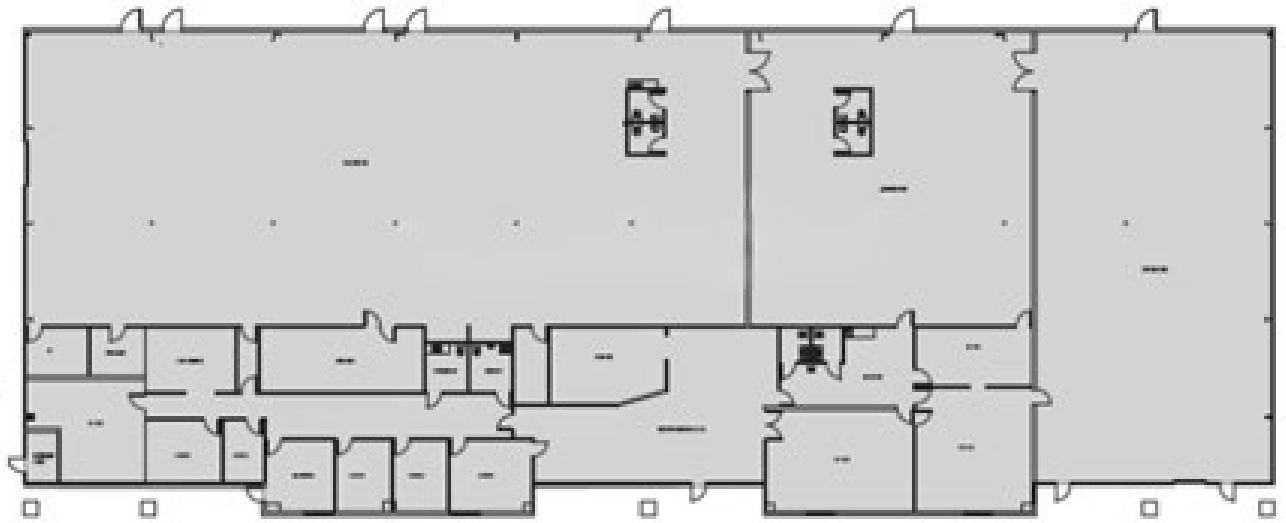

This material may contain content generated with AI assistance and publicly sourced data. NAI Piedmont Triad makes every effort to verify the information but makes no warranties or representations regarding the accuracy, completeness, or reliability of the information. Independent verification of all details is strongly encouraged. Prices, terms, and availability are subject to change without prior notice.

BEN STURGILL
BROKER
(O) 336.358.3229
(C) 336.848.3046
bsturgill@naipt.com

348 N Elm Street | Greensboro, NC 27101 | naipt.com

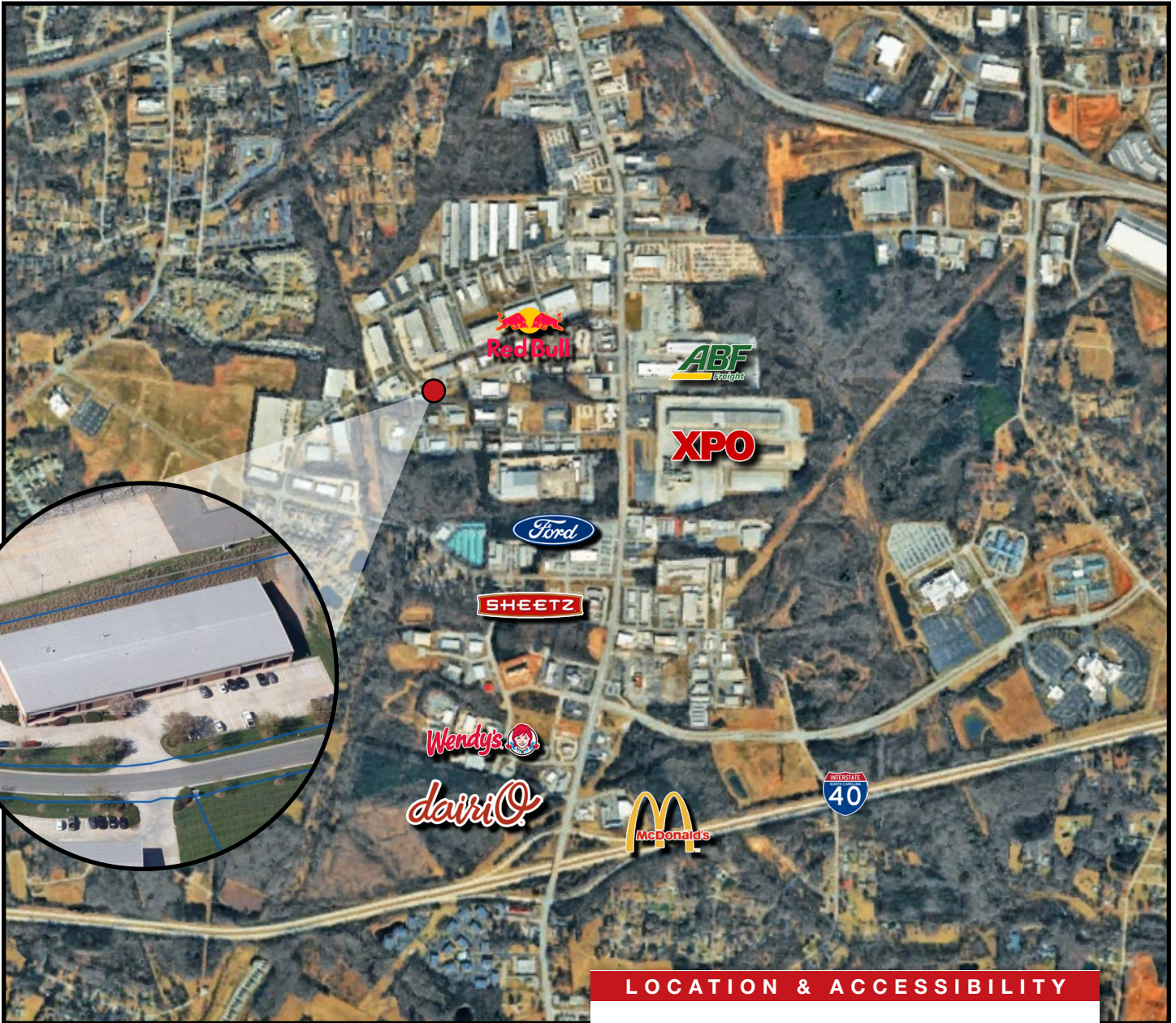

LOCATION & ACCESSIBILITY

PTI AIRPORT 12.7 MILES

 INTERSTATE 40 5.8 MILES

 INTERSTATE 85 30 MILES

This material may contain content generated with AI assistance and publicly sourced data. NAI Piedmont Triad makes every effort to verify the information but makes no warranties or representations regarding the accuracy, completeness, or reliability of the information. Independent verification of all details is strongly encouraged. Prices, terms, and availability are subject to change without prior notice.

BEN STURGILL
 BROKER
 (O) 336.358.3229
 (C) 336.848.3046
 bsturgill@naipt.com

348 N Elm Street | Greensboro, NC 27101 | naipt.com