

HOFFNER FULFILLMENT CENTER

6210 HOFFNER AVENUE, ORLANDO, FL 32822



CONVENIENT ACCESS
TO SR 528 AND MCO

23,992 SF AVAILABLE
FOR LEASE

SPACE HIGHLIGHTS

ASKING RATE
NEGOTIABLE

OPEX*
\$3.03 PSF

ELECTRICAL SPECS
3-PHASE

WAREHOUSE SF
21,209 SF

OFFICE SF
2,783 SF

ZONING
IND-1/IND-5

CLEAR HEIGHT
32'

YEAR BUILT
2019

AVAILABILITY
IMMEDIATELY

LOADING DOORS
(10) DOCK DOORS
(1) RAMP

**Denotes Estimated Operating Expenses for 2025*

CONTACT INFORMATION

TAYLOR ZAMBITO

Senior Director
+1 407 541 4409
taylor.zambito@cushwake.com

RYAN HUBBARD

Director
+1 407 541 4390
ryan.hubbard@cushwake.com



©2025 Cushman & Wakefield. All rights reserved. The information contained in this communication is strictly confidential. This information has been obtained from sources believed to be reliable but has not been verified. No warranty or representation, express or implied, is made as to the condition of the property (or properties) referenced herein or as to the accuracy or completeness of the information contained herein, and same is submitted subject to errors, omissions, change of price, rental or other conditions, withdrawal without notice, and to any special listing conditions imposed by the property owner(s). Any projections, opinions or estimates are subject to uncertainty and do not signify current or future property performance.

6210 HOFFNER AVENUE
SUITE 100

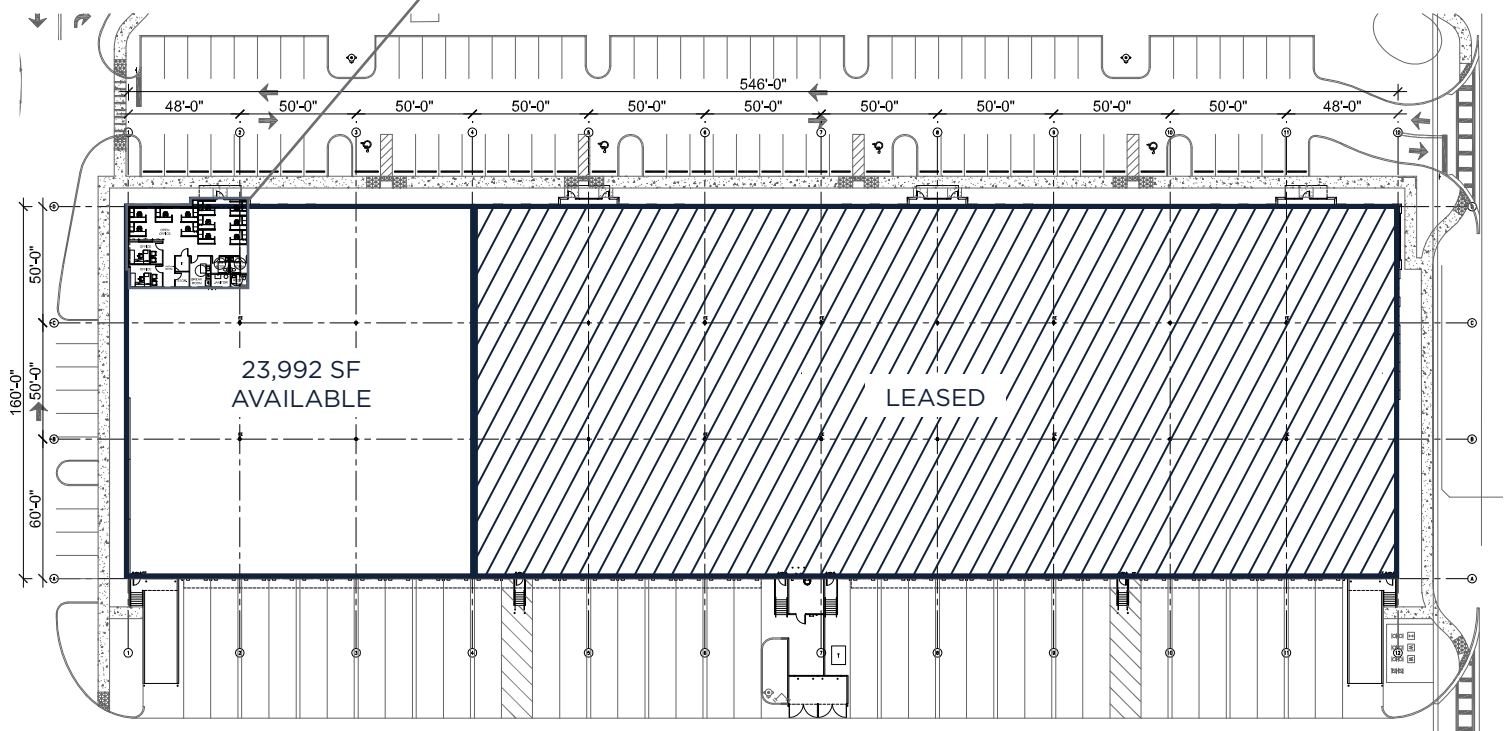
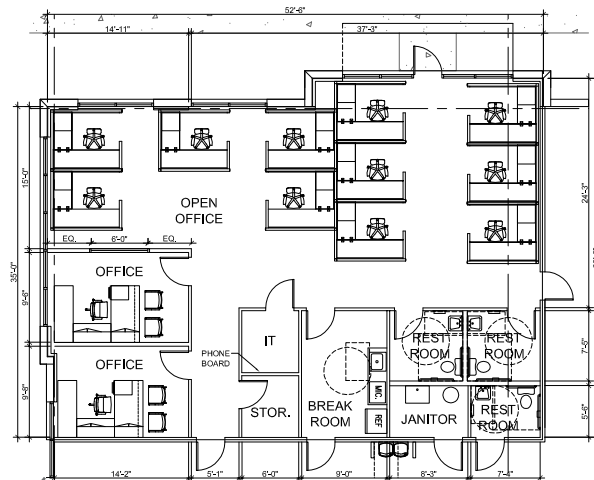

TAYLOR ZAMBITO

RYAN HUBBARD

