

Rancho Cordova, CA

# SUNRISE INDUSTRIAL PARK

3337 SUNRISE BLVD  
FOR LEASE

**For Further Information,  
Please Contact:**

**Brian English**  
benglish@centurymgmt.com

**Keith Galliano**  
kgalliano@centurymgmt.com

**1001 Enterprise Way, Suite 250  
Roseville, CA 95678  
Phone: (916) 784-3666  
Fax: (916) 784-3667**



Unit #4  
2,080 Square Feet

Features:

- Sunrise Blvd frontage
- 220 SF Office
- One roll-up door
- Ample Parking
- Central to Sacramento / Folsom
- Along Hwy-50 Corridor

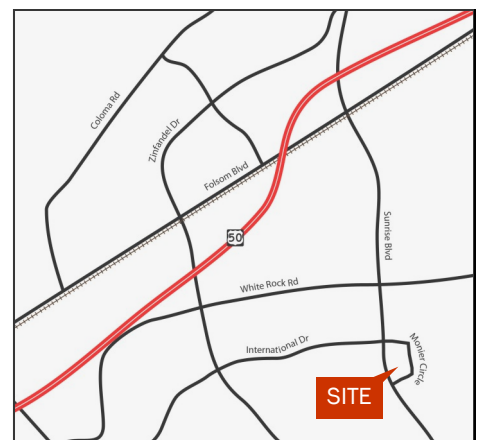

CENTURY MANAGEMENT COMPANY

The information contained herein is for general purposes only and is subject to change without notice. Nothing contained herein is intended to be a binding representation. The owner and broker make no representation as to the accuracy of the information contained herein, or as to the character, occupancy or configuration of the property described herein. It is the responsibility of the reader to independently verify all the information.

Rancho Cordova, CA

# SUNRISE INDUSTRIAL PARK

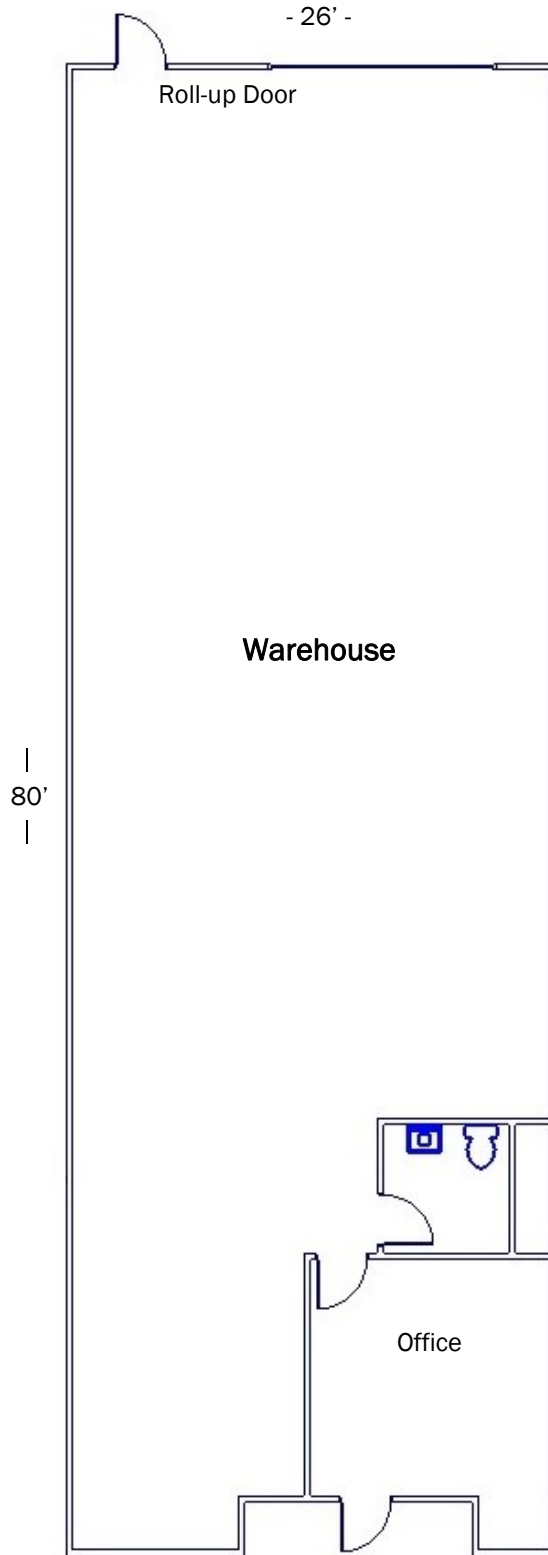

Not to Scale