

WAREHOUSE SPACE FOR LEASE

21 TURNPIKE ROAD

Southborough, Massachusetts

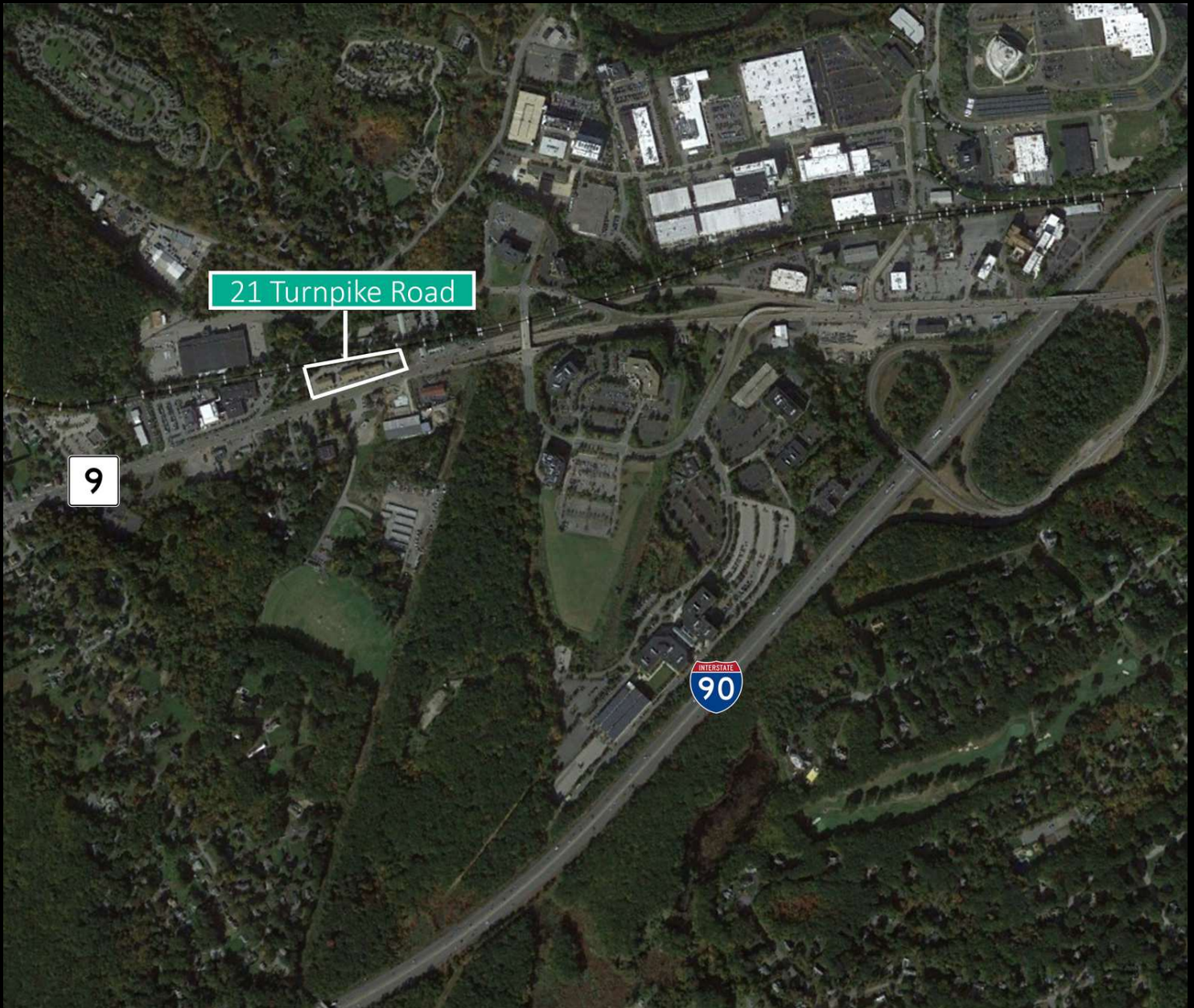

JOE LAURSEN

508.353.9275

laursen@kelleher-sadowsky.com

TODD ALEXANDER

508.981.7014

alexander@kelleher-sadowsky.com





PROPERTY DESCRIPTION

Kelleher & Sadowsky is pleased to present 21 Turnpike Road in Southborough as available for lease. This property is extremely well located along Route 9 with outstanding visibility in addition to being located 1 mile from I-90 (The Mass Pike) and 3.5 miles from I-495. There is about 4,000 SF of warehouse space remaining.

The 3,000 SF warehouse space comes with a private office and bathroom. The 4,000 SF warehouse space comes equipped with an automatic backup generator. Call us today to schedule a tour!

OFFERING SUMMARY

Property Type:	Negotiable
Available SF:	4,000 SF
Lot Size:	3,15 acres
Zoning:	BH
Lease Rate:	Negotiable

DEMOGRAPHICS	1 MILE	3 MILES	5 MILES
Total Households	635	11,554	46,288
Total Population	1,634	30,969	121,537
Average HH Income	\$208,095	\$206,790	\$163,569

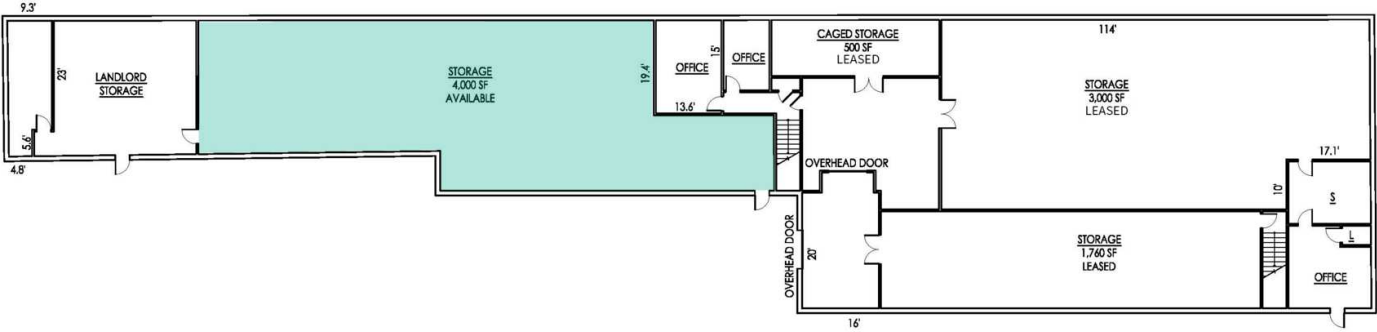

LEASE PLAN 1
SCALE: 1" = 20'-0" A-1.1

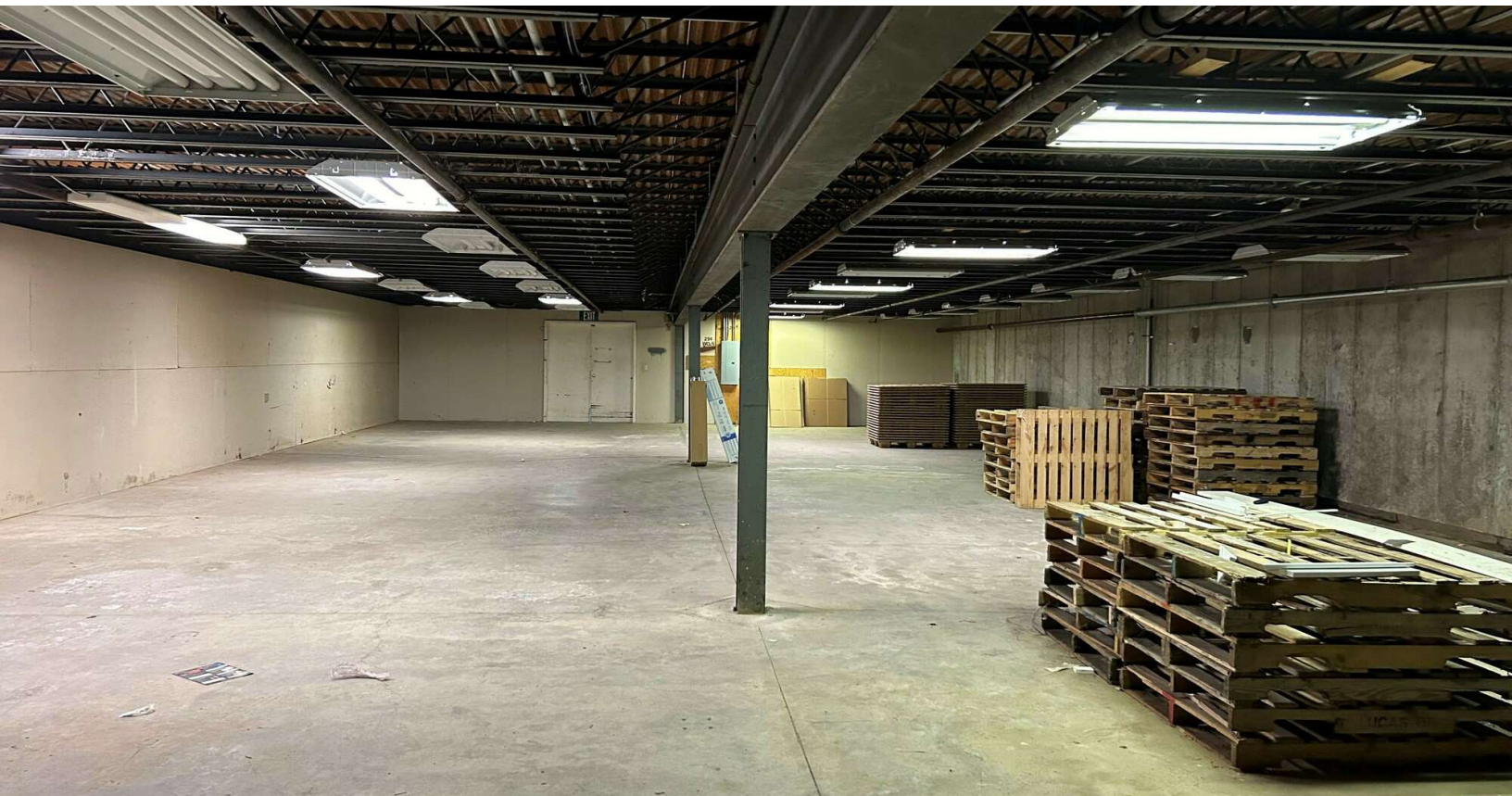

FOR LEASE • 21 TURNPIKE ROAD

Location Map

