



# DAMEN COLLECTIVE

1617 & 1613 N. DAMEN AVE

 MID-AMERICA<sup>®</sup> URBAN

 ASANA  
PARTNERS



**DAMEN COLLECTIVE**  
1617 & 1613 N. DAMEN AVE

Second generation retail and restaurant opportunities on the best block in Chicago's Bucktown neighborhood

Less than half a block from the vibrant intersection of North, Milwaukee, and Damen Avenues, plus the Damen Blue Line El stop with more than 2M riders annually

Short walking distance to The 606, Chicago's High Line Trail

Surrounded by a unique curation of international, national, and local retailers and restaurateurs

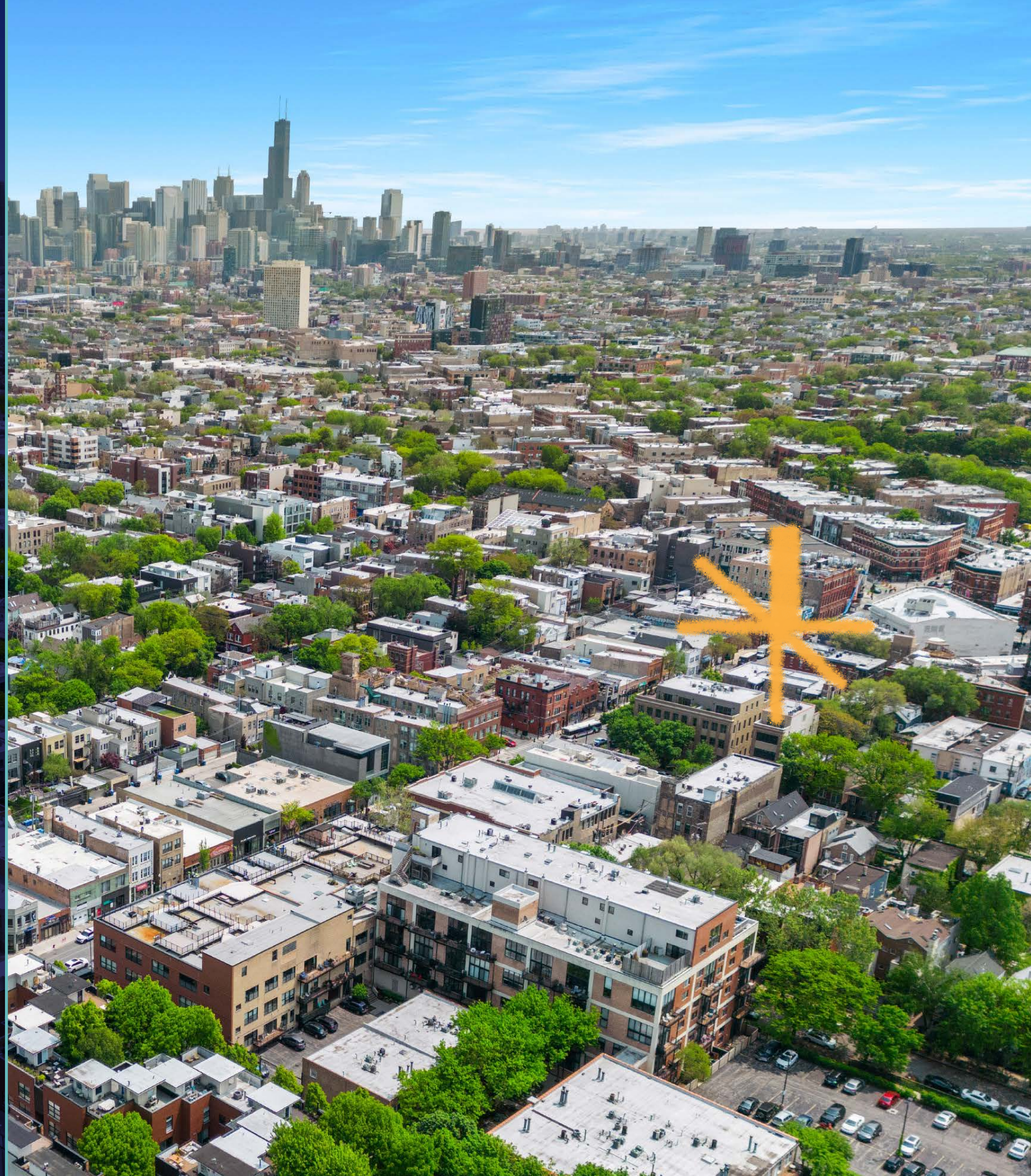



## 1617 N. DAMEN

3,209 SF with 27' of frontage

Second generation retail space but can convert to restaurant space

Fully customizable façade

Available immediately

# 1617 N. DAMEN AVENUE

AS-BUILT FLOOR PLAN

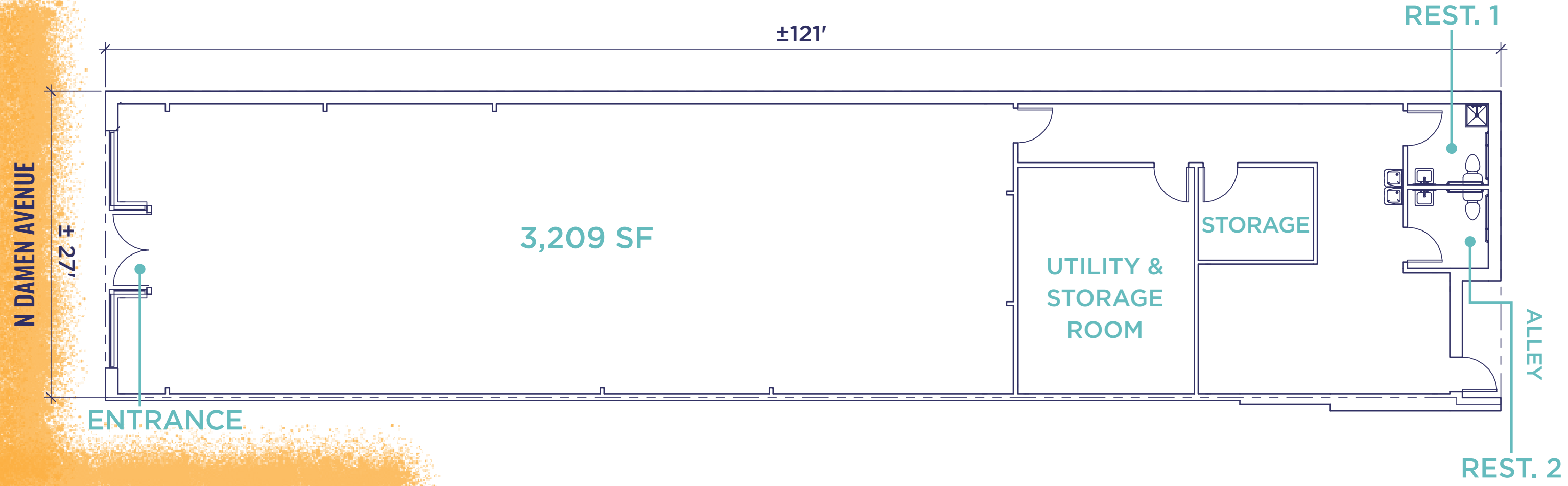

# 1613 N. DAMEN

2,211 SF with 22' of frontage

Fully built-out restaurant space, currently occupied by Enso Sushi

Black iron in place

Full bar and kitchen with 2 walk-in freezers

Operable storefront windows

Fully customizable façade

Negotiable delivery date



# 1613 N. DAMEN AVENUE

## AS-BUILT FLOOR PLAN

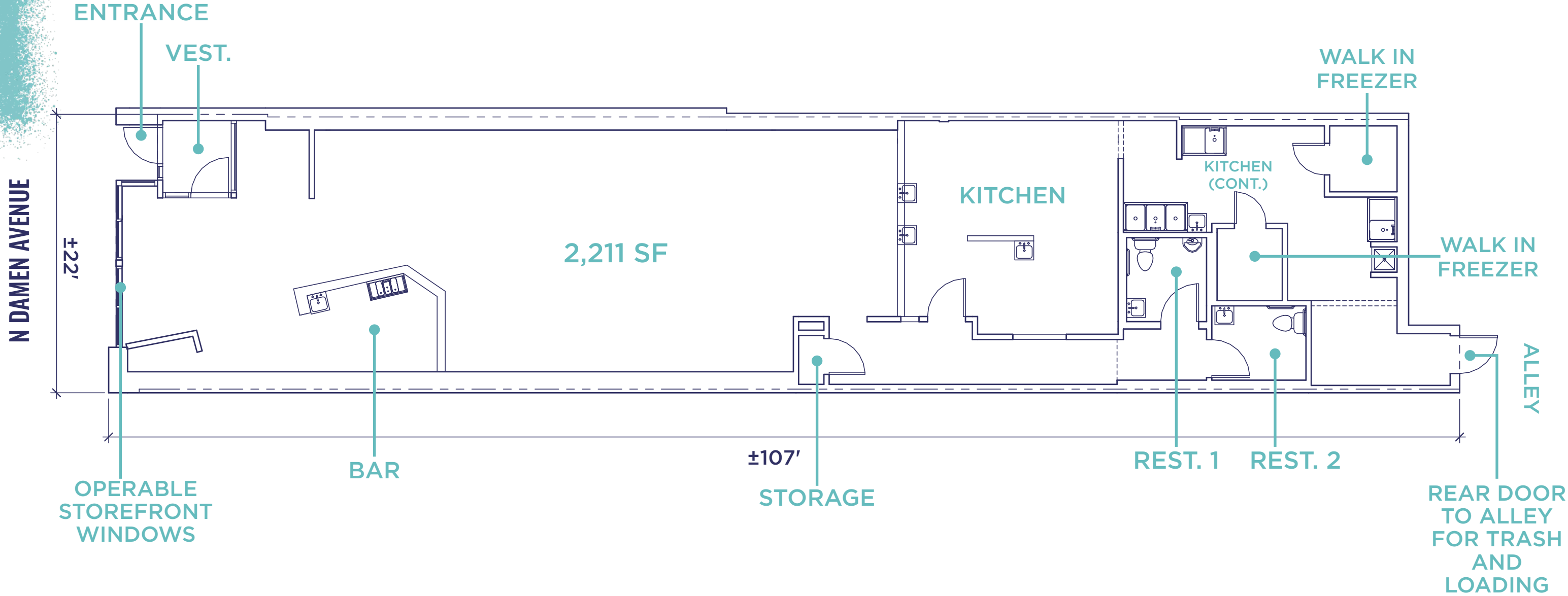

# MARKET CO-TENANCY

## APPAREL & ACCESSORIES



## BEAUTY & COSMETICS



## SERVICE



## FOOD & BEVERAGE



# DEMOGRAPHICS

## TOTAL POPULATION

.25 mile	.5 mile	1 mile
4,589	19,999	66,041

## AVERAGE HOUSEHOLD INCOME

.25 mile	.5 mile	1 mile
\$197,068	\$213,892	\$179,321

## RETAIL SPENDING

1 mile  

---

 \$478,817,213

## RESTAURANT SPENDING

1 mile  

---

 \$216,781,842

# NEIGHBORHOOD MAP

**LOGAN SQUARE**

**LAKEVIEW**

**LINCOLN PARK**

**BUCKTOWN**

**DAMEN CORRIDOR**

**OLD TOWN**

**WICKER PARK**

**GOLD COAST**

**MICHIGAN AVENUE**

**RIVER NORTH**

**STREETERVILLE**

**WEST LOOP/  
FULTON MARKET  
DISTRICT**

**LOOP**

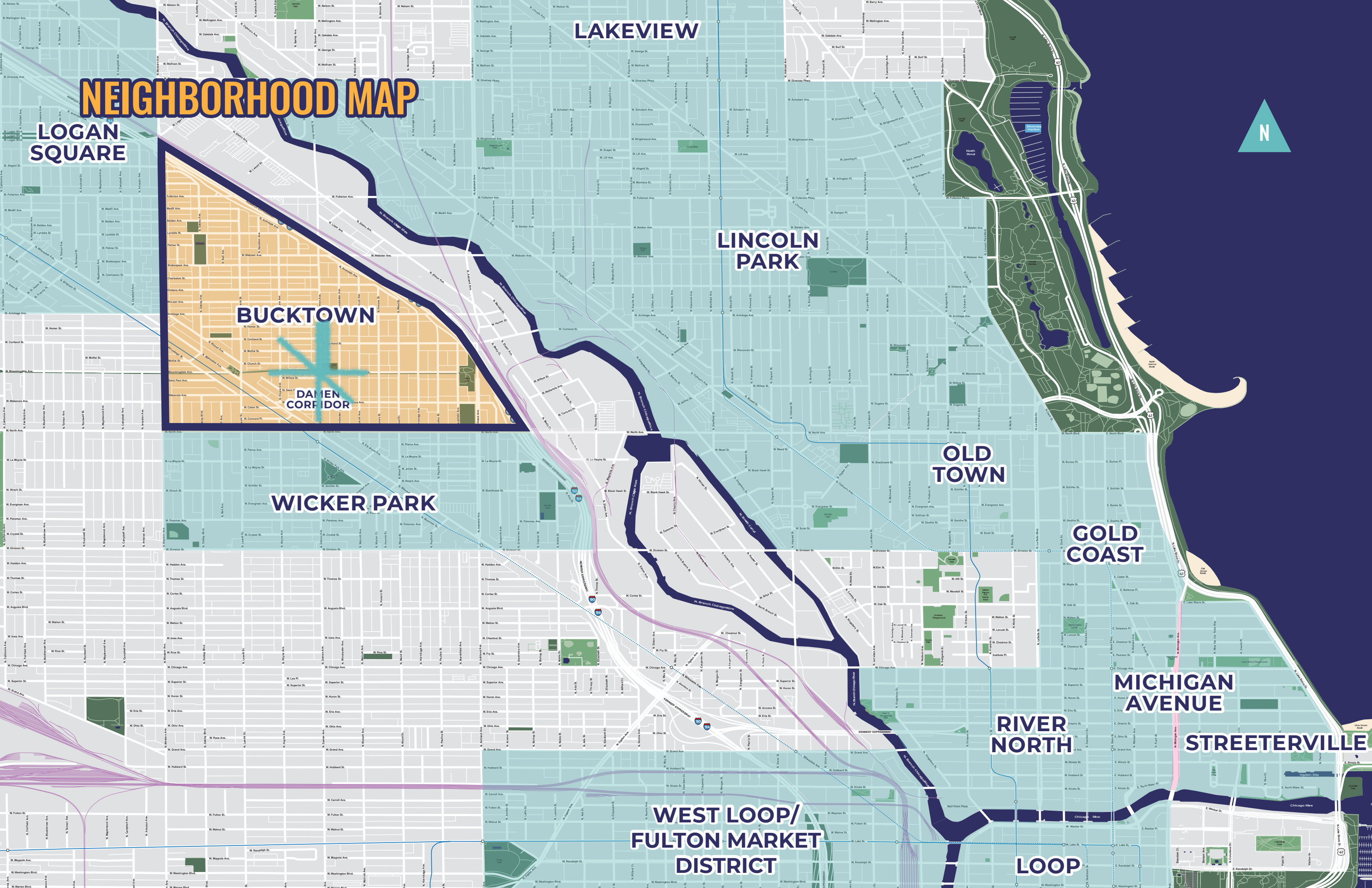



# STREET MAP



# MARKET MAP

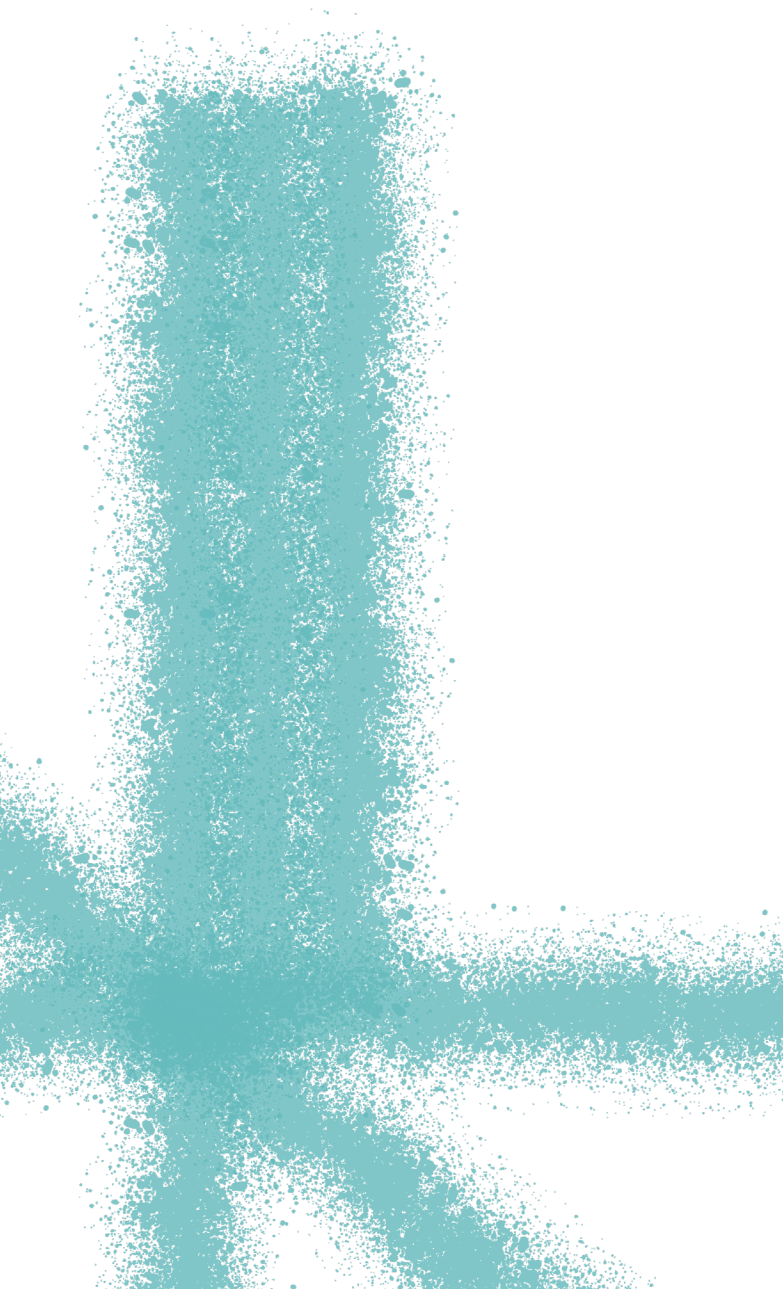



# DAMEN COLLECTIVE

1617 & 1613 N. DAMEN AVE

## LARA KEENE

Mid-America Real Estate

Principal

630.481.4038

[lkeene@midamericagr.com](mailto:lkeene@midamericagr.com)

## KELLY NICKELE

Mid-America Real Estate

Vice President

630.954.7513

[knickele@midamericagr.com](mailto:knickele@midamericagr.com)

## GREG BAYER

Mid-America Real Estate

Principal

630.954.7441

[gbayer@midamericagr.com](mailto:gbayer@midamericagr.com)



MID-AMERICA<sup>®</sup> URBAN



ASANA  
PARTNERS