



OFFICE SPACE | FOR SALE

**101 CONNER DR**

CHAPEL HILL, NC

**ATLAS STARK**



# SALE/LEASE INFORMATION

## PROPERTY OVERVIEW

ASKING PRICE	\$1,099,000
PRICE PER SF	\$241.49/SF
ADDRESS	101 Conner Dr
SUITES	201 and 202
CITY	Chapel Hill
AREA	± 4,551 SF

Now available: 101 Conner Drive, formerly home to a medical practice and a financial advisor's office . Conveniently located just 2.5 miles from the US-501 and I-40 intersection and 3 miles from UNC Hospital, the property provides excellent accessibility. The building is anchored by reputable tenants, including Allergy Partners of Chapel Hill, a dentist, and an orthodontist, and features ample on-site parking.









# FLOOR PLAN

101 Conner Dr  
SUITE 201 & 202  
4,551 SQ. FT.

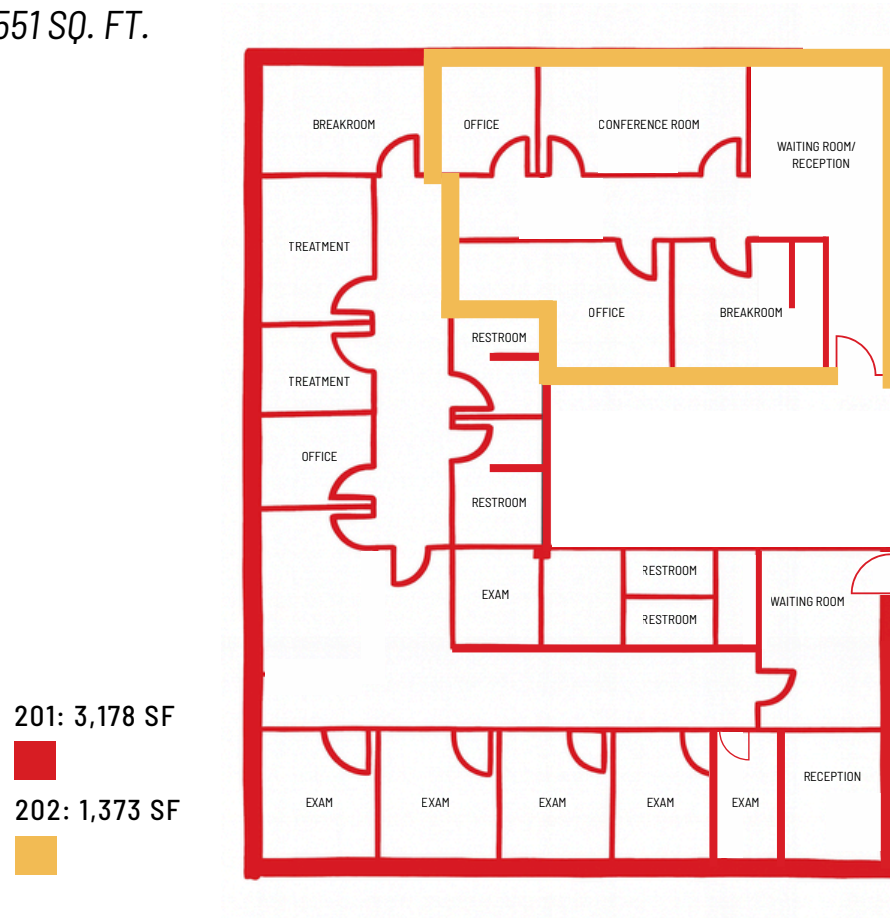

\*The space is comprised of approximately  $\frac{3}{4}$  medical office and  $\frac{1}{4}$  general office, offering flexibility for a range of users. The space offers 6 exam rooms, a lab, 4 bathrooms, a break room, and two entrances.





EST. 1980  
**BRUEGGER'S  
BAGELS**  
AUTHENTIC NEW YORK STYLE



**TRADER JOE'S**

*Wegmans*

**SITE**

VILLAGE PLAZA  
**WHOLE FOODS  
MARKET**

**petco**



**barre3**

**CAVA**



**UNIVERSITY  
PLACE  
SILVERSPOT  
CINEMA**



**HAWKERS**



THE UNIVERSITY  
of NORTH CAROLINA  
at CHAPEL HILL

**UNC  
HEALTH**



# 101 CONNER DRIVE

## CHAPEL HILL, NC 27514

### CONTACT

Tyler Christensen, Broker  
(C) 828.999.9459  
tchristensen@atlasstark.com

Trent Ragland, Broker  
(C) 919.815.8414  
tragland@atlasstark.com

ATLAS  STARK

Atlas Stark Holdings LLC | 2020 Progress Ct, Suite 130A, Raleigh, NC  
All information contained herein is from sources deemed reliable;  
however, no representation or warranty is made to the accuracy thereof.