

# FOR LEASE

Angle Road Warehouse Complex 600 North 39th Street, Fort Pierce, FL 34947

## PROPERTY FACTS

Building Area:	7,600 Sq. Ft.
No. of Units:	12 Units
Unit Range:	500 - 600 Sq. Ft.
Year Built:	1973
Construction:	Main Bldg.: Metal Other Bldg.: CBS
Roof:	Main Bldg.: Metal Other Bldg.: Shingle
Utilities:	City Water/Septic
Power:	FPL Electric
Zoning:	IL Permitted uses include: Light industrial, automotive, manufacturing, storage
Lease Type:	Modified Gross

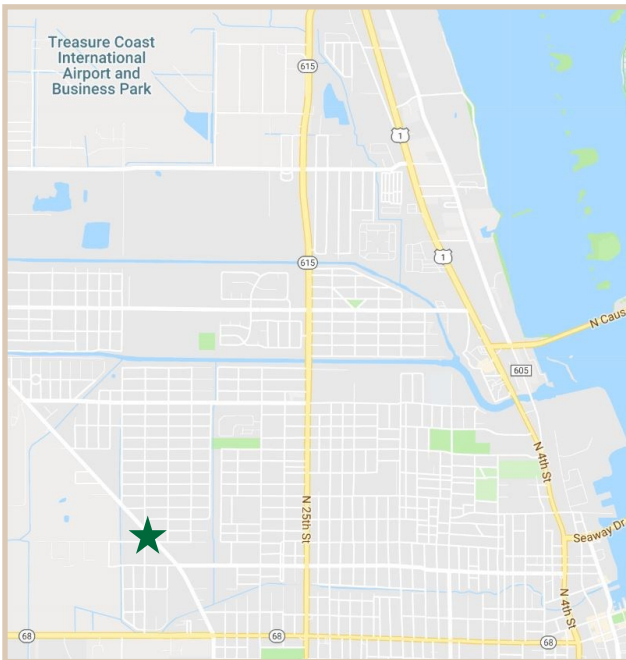

## PROPERTY HIGHLIGHTS

Price	These units are competitively priced, providing excellent value for the area.
Target Market Variability	Located in North Fort Pierce and centrally located between I-95 and US-1.
Layouts	Units utilize each square foot for the most optimal space for storage, manufacturing or automotive.
Parking & Access	Parking is optimal where you can park in front of each unit or inside each unit.
Aesthetics	Great triangle corner of 39th, Angle, and Metzger with a decent flow of traffic.



**CHARLES A. VON STEIN, INC.**  
*Commercial Property Management,  
Sales & Leasing Specialists since 1963*  
626 Old Dixie Highway SW  
Vero Beach, FL 32962  
[www.vscrc.com](http://www.vscrc.com)

**CONTACT INFO:**  
Brevard County: 321.725.1961  
Indian River County: 772.778.4885  
Fax: 772.778.4908  
Leasing: [leasing@vscrc.com](mailto:leasing@vscrc.com)

# SITE PLAN

Angle Road Warehouse Complex 600 North 39th Street, Fort Pierce, FL 34947

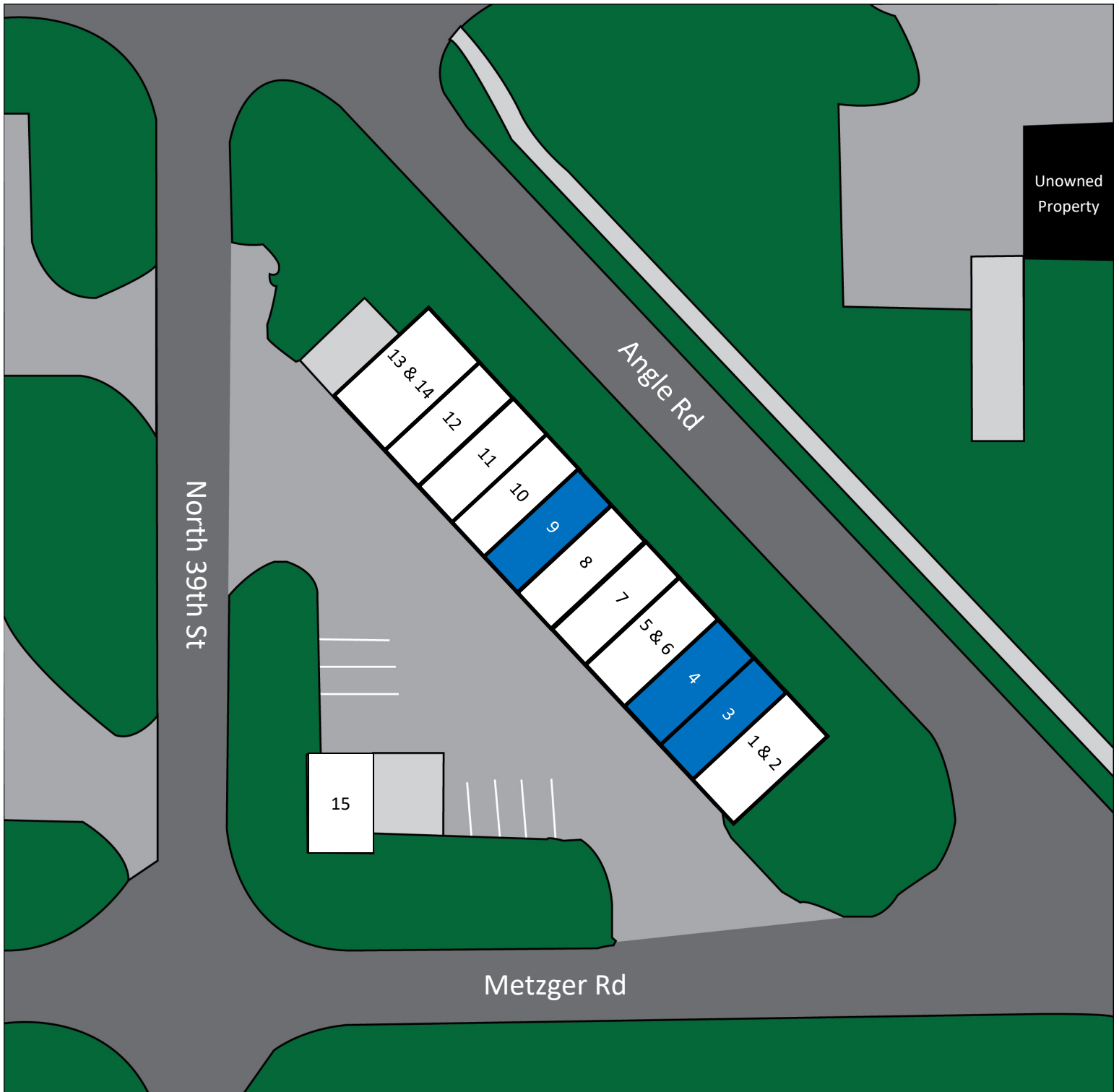

**CHARLES A. VON STEIN, INC.**  
Commercial Property Management,  
Sales & Leasing Specialists since 1963  
626 Old Dixie Highway SW  
Vero Beach, FL 32962  
[www.vscre.com](http://www.vscre.com)

**CONTACT INFO:**

Brevard County: 321.725.1961  
Indian River County: 772.778.4885  
Fax: 772.778.4908  
Leasing: [leasing@vscre.com](mailto:leasing@vscre.com)

# UNITS FOR LEASE

Angle Road Warehouse Complex 600 North 39th Street, Fort Pierce, FL 34947

UNIT	SIZE	RATE	OVERHEAD DOORS		MAX. CEILING HEIGHT	% OFFICE SPACE	% HVAC	NOTES
			DRIVE IN	DOCK HEIGHT				
3	500 SF	\$12.00 SF/YR	1	0	18	0	0	Open Warehouse Space
4	500 SF	\$12.00 SF/YR	1	0	18	0	0	Open Warehouse Space
9	500 SF	\$12.00 SF/YR	1	0	18	0	0	Open Warehouse Space



**CHARLES A. VON STEIN, INC.**  
 Commercial Property Management,  
 Sales & Leasing Specialists since 1963  
 626 Old Dixie Highway SW  
 Vero Beach, FL 32962  
 www.vscre.com

**CONTACT INFO:**  
 Brevard County: 321.725.1961  
 Indian River County: 772.778.4885  
 Fax: 772.778.4908  
 Leasing: leasing@vscre.com



**CHARLES A. VON STEIN, INC.**  
*Commercial Property Management,  
Sales & Leasing Specialists since 1963*  
626 Old Dixie Highway SW  
Vero Beach, FL 32962  
[www.vscre.com](http://www.vscre.com)

**CONTACT INFO:**

Brevard County: 321.725.1961  
Indian River County: 772.778.4885  
Fax: 772.778.4908  
Leasing: [leasing@vscre.com](mailto:leasing@vscre.com)

# LOCATION MAPS

Angle Road Warehouse Complex 600 North 39th Street, Fort Pierce, FL 34947

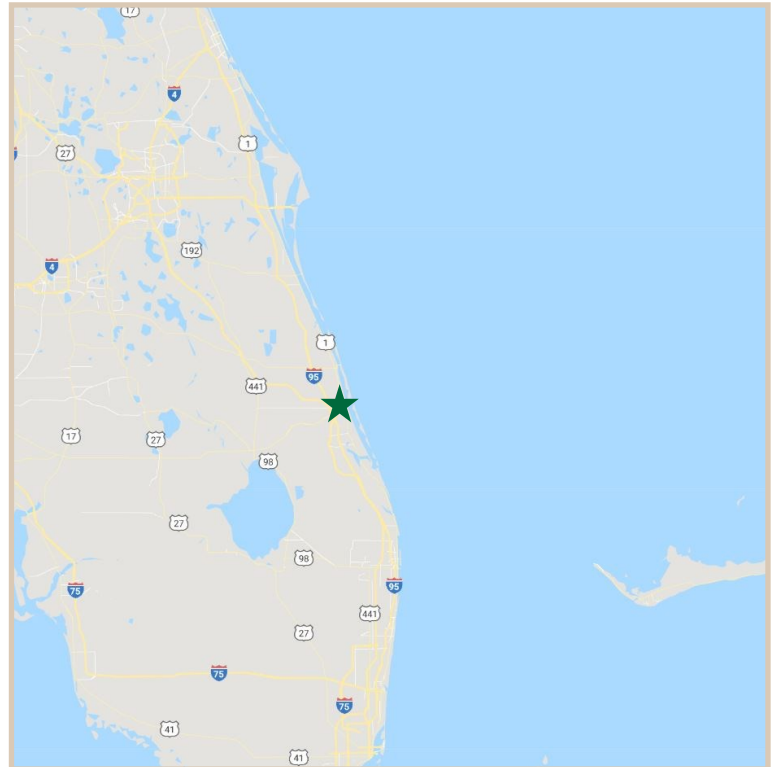
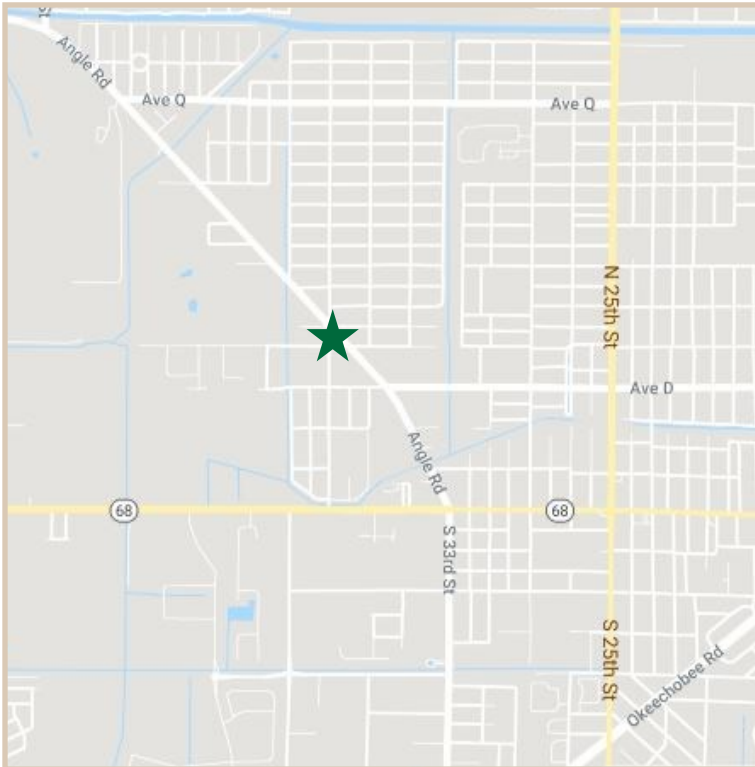
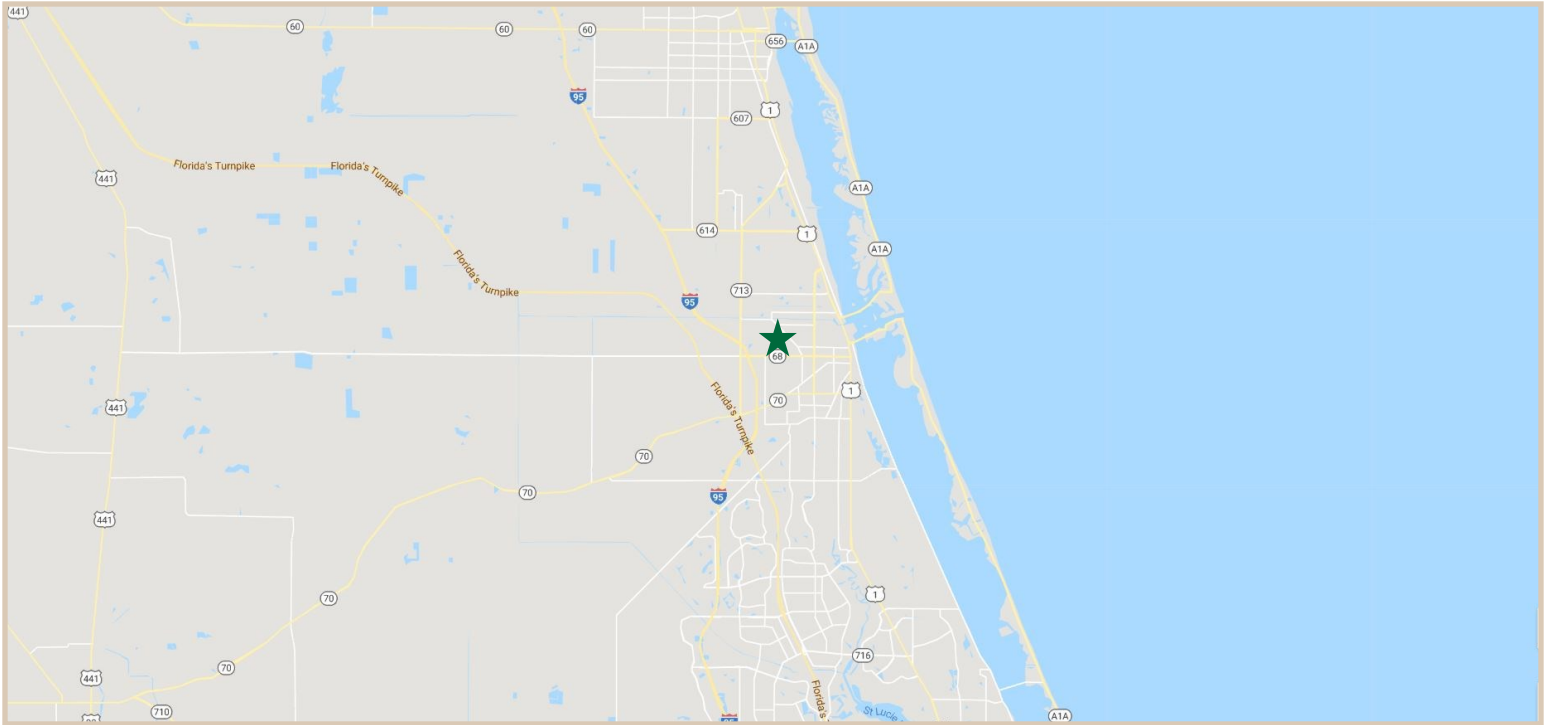

**1963**  
**CHARLES A. VON STEIN, INC.**  
*Commercial Property Management,  
Sales & Leasing Specialists since 1963*  
626 Old Dixie Highway SW  
Vero Beach, FL 32962  
[www.vscrc.com](http://www.vscrc.com)

#### CONTACT INFO:

Brevard County: 321.725.1961  
Indian River County: 772.778.4885  
Fax: 772.778.4908  
Leasing: [leasing@vscre.com](mailto:leasing@vscre.com)

# ADDITIONAL PHOTOS

Angle Road Warehouse Complex 600 North 39th Street, Fort Pierce, FL 34947



**CHARLES A. VON STEIN, INC.**  
Commercial Property Management,  
Sales & Leasing Specialists since 1963  
626 Old Dixie Highway SW  
Vero Beach, FL 32962  
[www.vscrc.com](http://www.vscrc.com)

**CONTACT INFO:**  
Brevard County: 321.725.1961  
Indian River County: 772.778.4885  
Fax: 772.778.4908  
Leasing: [leasing@vscrc.com](mailto:leasing@vscrc.com)