

**67-03 MYRTLE AVE.
GLENDALE NY 11385**



Crifasi
Real Estate Inc.
Serving our community since 1974

OFFERING SUMMARY
MIXED USE
ASKING \$1.425M

For More Information Please Contact:
JOSEPH V. CRIFASI
Licensed Real Estate Broker
Cell: 718-930-0040
Email: joe@crifasi.com

| | | |
|----------------------|-------------------|-----------------|
| 1-Commercial | | |
| 2-Residential | 3,600 | \$395.83 |
| # of Units-3 | Approx. SF | Price/SF |

All material presented herein is intended for informational purposes only and is compiled from sources deemed reliable but is subject to errors, omissions, changes in price, condition, sale or withdrawal without notice. No statement is made as to the accuracy of any description or measurements (including square footage) and should be verified by your own attorney, architect or zoning expert. If your property is currently listed with another real estate broker, please disregard this offer. It is not our intention to solicit the offerings of other real estate brokers. We cooperate with them fully. Photographs and videos may be virtually staged or digitally enhanced and may not reflect the actual condition of the property.

INCOME

| <u>UNIT</u> | <u>TYPE</u> | <u>MONTHLY RENT</u> | <u>LEASE EXPIRARY</u> |
|----------------------|------------------|---------------------|-----------------------|
| 1st Fl. | Commercial Space | \$2,500 | 12/31/28 |
| 2nd Fl. | 3 Bed/1 Bath | \$1,700 | NA |
| 3rd Fl. | 3 Bed/1 Bath | \$1,700 | NA |
| Total Monthly Income | | \$5,900 | |
| Total Annual Income | | \$70,800 | |

ANNUAL EXPENSES

| | |
|------------------------|----------|
| Taxes: | \$9,027 |
| Insurance: | \$4,300 |
| Gas/Heat: | \$3,304 |
| Water: | \$3,450 |
| Electric | NA |
| Total Annual Expenses: | \$20,081 |
| Total Annual NOI | \$50,719 |

1st Floor

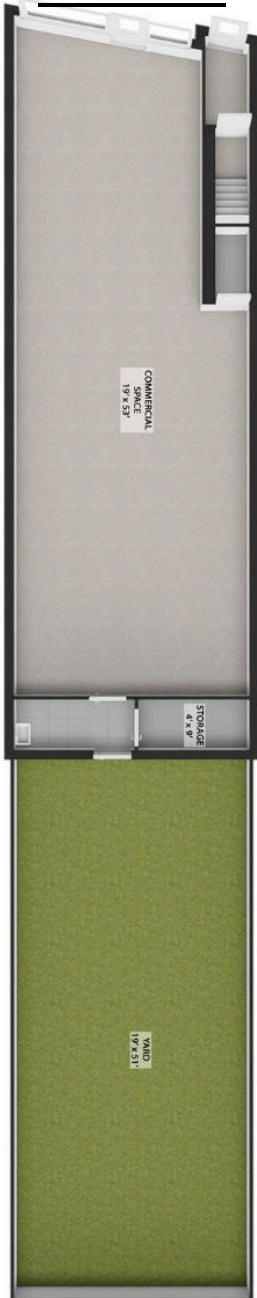

2nd Fl Apt.



3rd Fl Apt.



Basement



PROPERTY INFORMATION

FINANCIAL SUMMARY

| | |
|-----------------------------|---------------------------------------|
| Address: | 67-03 Myrtle Ave. |
| County: | Queens |
| Market: | Glendale |
| Building S/F/ Size | 3,600 sf / 20' x 60' |
| Lot S/F/ Size | 2,240 sf / 20.33' x 110.17' |
| Number of Units: | 3-- 1 Comm. & 2 Res. units |
| Number of Stories: | 3 |
| Year Built: | 1910 |
| # of Parcels: | 1 |
| Zoning Type: | R-5D, R5B, C2-3 |
| Building Class: | S2 |
| Number of Buildings: | 1 |
| Number of Vacancies | 0 |
| Construction: | Brick |
| Fuel: | Gas |
| Basement: | Full |

| | |
|------------------|--------------------|
| Price: | \$1,425,000 |
| Price PSF | \$395.83 |

DESCRIPTION

Fantastic Investment Opportunity!

This Large brick mixed-use building offers a prime commercial and residential setup.

The 1st Floor features an operating 99 cent store, providing stable rental income with a lease in place until 12/31/28. This tenant is responsible for paying the electricity costs for both their individual space and the common area usage.

The 2nd & 3rd floors each house spacious 3-bedroom apartments with identical layouts, including an EIK, DR, LR, 3 Bedrooms & one full bathroom.

Additional highlights include a full basement and private yard.

Perfect for investors or owner-occupants looking to generate rental income.