

BUILDING DIVISION

# COMPLETEFUL BUILDING FORMERLY WALMART

1229 NW Evangeline Thruway  
Lafayette, LA 70501

GENERAL NOTES

01. ALL BIDDERS SHALL VISIT THE SITE.
02. ALL CONSTRUCTION SHALL COMPLY WITH INTERNATIONAL BUILDING CODE, 2015 ED.
03. ALL CONSTRUCTION SHALL COMPLY WITH LIFE SAFETY CODE, 2015 ED.
04. THE GENERAL CONTRACTOR SHALL FURNISH ALL FEES AND PERMITS NECESSARY FOR CONSTRUCTION.
05. LAC 55:V.303.D PROVIDE LISTED PORTABLE FIRE EXTINGUISHERS IN ACCORDANCE WITH NFPA 10. (REFER TO APPENDIX E FOR DISTRIBUTION INFORMATION).  
A) NFPA 10.5.2 CLASSIFICATIONS FOR FIRES:  
CLASS A FIRES-FIRES IN ORDINARY COMBUSTIBLE MATERIALS, SUCH AS WOOD, CLOTH, PAPER, RUBBER AND MANY PLASTICS.  
CLASS B FIRES-FIRES IN FLAMMABLE LIQUIDS, COMBUSTIBLE LIQUIDS, PETROLEUM GREASES, TARS, OILS, OIL-BASED PAINTS, SOLVENTS, LACQUERS, ALCOHOLS AND FLAMMABLE GASES.  
CLASS C FIRES-FIRES THAT INVOLVE ENERGIZED ELECTRICAL EQUIPMENT.
06. NFPA 10.6.1.3.8 TOP OF FIRE EXTINGUISHER, HAVING A GROSS WEIGHT LESS THAN 40 LB, SHALL BE NOT MORE THAN 5 FEET ABOVE THE FLOOR. IF GROSS WEIGHT 40 LBS OR GREATER, 3-1/2 FEET ABOVE THE FLOOR. THE BOTTOM OF A HAND PORTABLE FIRE EXTINGUISHER SHALL NOT BE LESS THAN 4 INCHES ABOVE THE FLOOR.
07. LRS 40:1864.4 ALL WORK AND INSPECTIONS OF PORTABLE FIRE EXTINGUISHERS SHALL BE PERFORMED BY A LIFE SAFETY AND PROPERTY PROTECTION CONTRACTOR LICENSED WITH THE APPROPRIATE ENDORSEMENT BY THE OFFICE OF THE STATE FIRE MARSHAL. PORTABLE FIRE EXTINGUISHERS SHALL BE CERTIFIED ANNUALLY.  
A) FOR INSPECTION, SEE NFPA 10.7.2  
B) FOR MAINTENANCE, SEE NFPA 10.7.3  
C) FOR RECHARGING, SEE NFPA 10.7.4
08. MODIFICATIONS TO THE EXISTING SPRINKLER SYSTEM SHALL BE IN ACCORDANCE WITH NFPA 13.
09. LRS 40:1574 SUBMIT AUTOMATIC SPRINKLER SYSTEM SHOP DRAWINGS, COMPLETE APPLICATION AND FEE ON THE OFFICE OF STATE FIRE MARSHAL ONLINE PORTAL (WWW.LASFM.LOUISIANA.GOV) PRIOR TO INSTALLATION OF ANY WORK TO THIS SYSTEM.  
NOTE: SEE INTERPRETIVE MEMORANDUMS 2013-02 AND 2013-03 FOR SUBMITTAL REQUIREMENTS. SPRINKLER SHOP DRAWING SUBMITTALS ARE REQUIRED TO BE REVIEWED BY THE PROFESSIONAL OF RECORD/OWNER BEFORE BEING SUBMITTED TO THE OFFICE OF STATE FIRE MARSHAL PLAN REVIEW SECTION WHERE A PROFESSIONAL OF RECORD IS REQUIRED BY RS 37 CHAPTER 3 SECTION 155.
10. MODIFICATIONS TO THE EXISTING FIRE ALARM SYSTEM SHALL BE IN ACCORDANCE WITH NFPA 101, NFPA 72, ADA-ABA, IBC, AND LRS 40:1864.
11. LRS 40:1574 SUBMIT FIRE ALARM SYSTEM SHOP DRAWINGS WITH PLAN REVIEW APPLICATION AND FEE TO THE OFFICE OF STATE FIRE MARSHAL PRIOR TO INSTALLATION OF ANY WORK OF THIS SECTION. SUCH WORK SHALL NOT COMMENCE UNTIL SHOP DRAWINGS HAVE BEEN FOUND TO BE IN COMPLIANCE WITH APPLICABLE CODES. THE SUBMITTAL SHALL INCLUDE A COPY OF THIS LETTER AND SHALL BE IN ACCORDANCE WITH THE SUBMITTAL REQUIREMENTS OUTLINED IN THE MEMORANDUM DATED JUNE 24, 1993 WHICH WAS DISTRIBUTED FROM THE OFFICE OF STATE FIRE MARSHAL TO ALL STATE LICENSED FIRE ALARM CONTRACTORS, ARCHITECTS AND ENGINEERS. SPECIFY THE TYPE OF SIGNALING SYSTEM TO BE UTILIZED, AND IDENTIFY THE MONITORING STATION.
12. VERIFY ALL DIMENSIONS.
13. ALL NEW DOOR HARDWARE SHALL MEET A.D.A. REQUIREMENTS.
14. EXTERIOR DOORS SHALL OPEN ONTO A LANDING LEVEL WITH FINISHED FLOOR AND SHALL BE OPENABLE WITHOUT USE OF A KEY, TOOL, OR SPECIAL EFFORT OR KNOWLEDGE.
15. PROVIDE LOW LEVEL EXIT SIGNAGE.
16. THRESHOLDS SHALL BE NOT MORE THAN 1/2" HIGH AND BEVELED IF OVER 1/4".
17. PROVIDE PORTABLE FIRE EXTINGUISHERS IN ACCORDANCE WITH NFPA 10.
18. EXISTING MECHANICAL SYSTEMS TO BE UTILIZED, PROVIDE NEW RETURN AIR GRILLES AND DIFFUSERS.
19. VERIFY ALL FINISHES WITH BUILDING MANAGEMENT.

PROJECT CODE DATA

TOTAL AREA - 228,530.421 SQ. FT.  
RENOVATED AREA - 100,815.9 SQ. FT.

NUMBER OF STORIES - 1  
IBC 2015

CODE DATA  
PRIMARY OCCUPANCY CLASSIFICATION - GROUP S

NFPA 2015  
CODE DATA  
PRIMARY OCCUPANCY CLASSIFICATION - STORAGE  
FIRE PROTECTION SYSTEM - SPRINKLERED

VICINITY MAP



LEGEND

 SUBDIVIDED BUILDING AREA (100,815.9 SQ.FT.)





**DEMOLITION LEGEND**

-  DEMOLISH EXISTING
-  EXISTING TO REMAIN



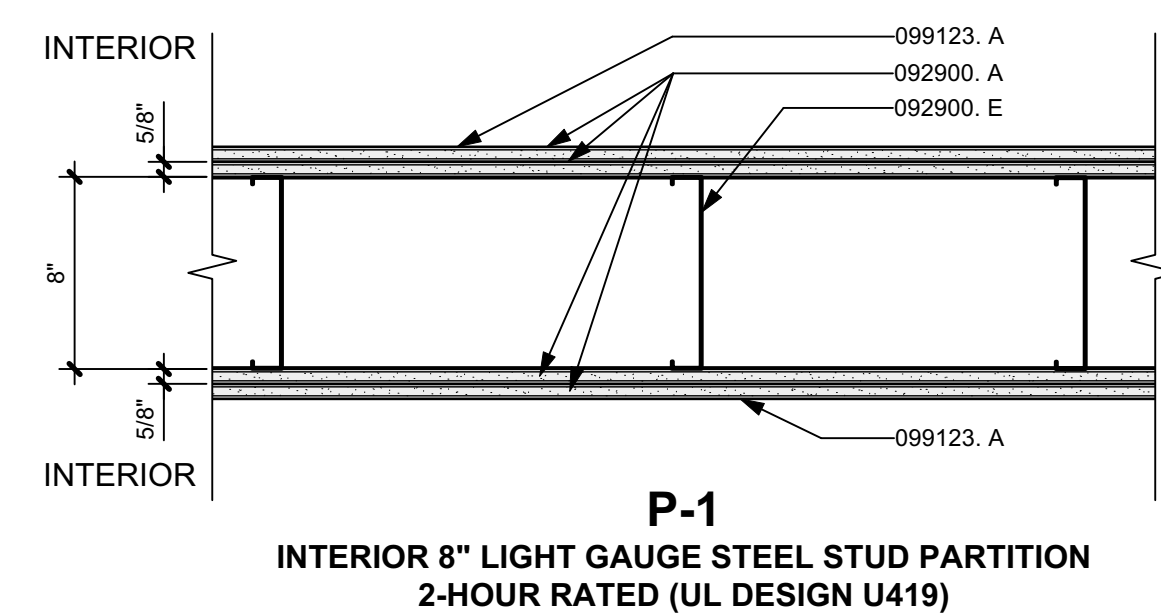
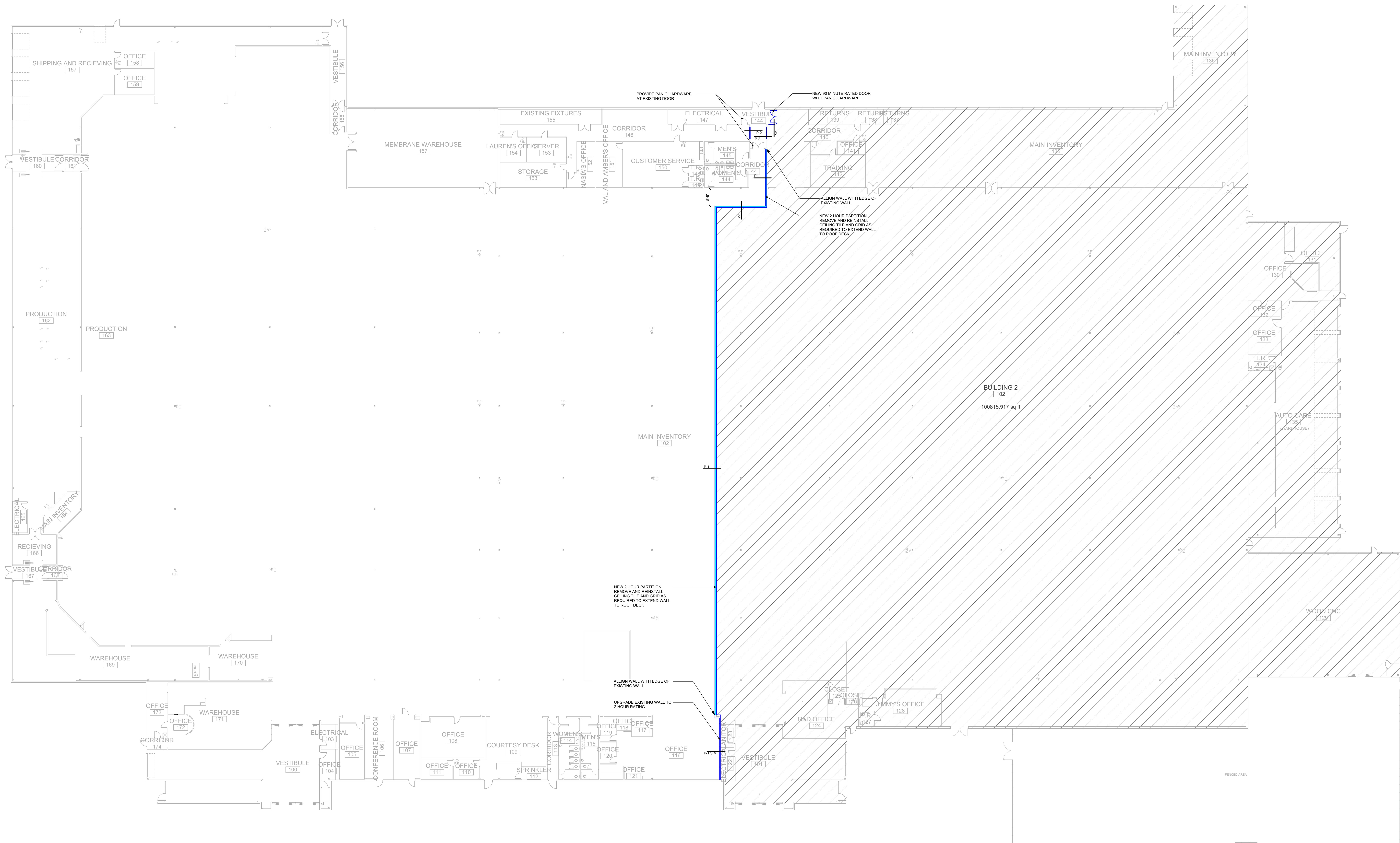

**P-TYPE KEYNOTES**  
092900. A 5/8" TYPE "X" GYPSUM BOARD  
092900. E 6" METAL STUD @ 16" O.C.  
099123. A PAINTED FINISH  
092900. D 3-5/8" METAL STUD @ 16" O.C.

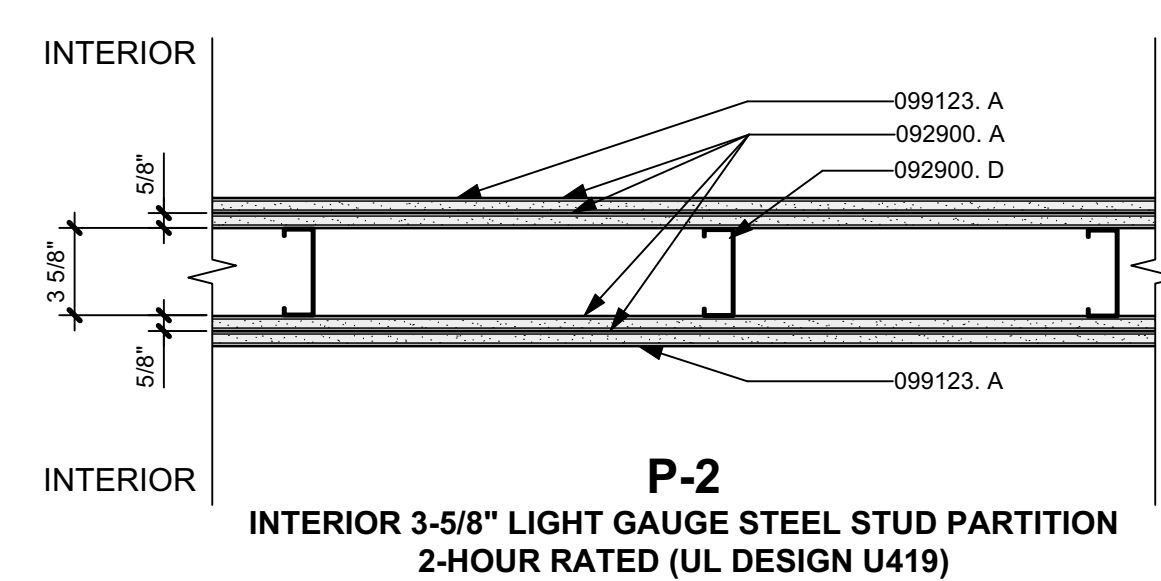

**P-TYPE DETAILS**  
SCALE: 1/12" = 1'-0"

**RENOVATION LEGEND**

- EXISTING TO REMAIN
- NEW CONSTRUCTION

SUBDIVIDED BUILDING AREA (100,815.9 SQ.FT.)