



ELDER GATE MILTON KEYNES MK9 1LR



CITY CENTRE OFFICES TO LET  
ADJACENT TO MK CENTRAL STATION

[www.elderhousemk.co.uk](http://www.elderhousemk.co.uk)

1,000 – 20,000 sq ft office space available



## DESCRIPTION

Elder House comprises three floors of office accommodation located above a number of retail units and restaurants. The building has recently undergone a full refurbishment to all common areas including the corridors, kitchens and toilet facilities. It is clad with a double glazed curtain walling system and there is allocated car parking to the rear.

[www.elderhousemk.co.uk](http://www.elderhousemk.co.uk)



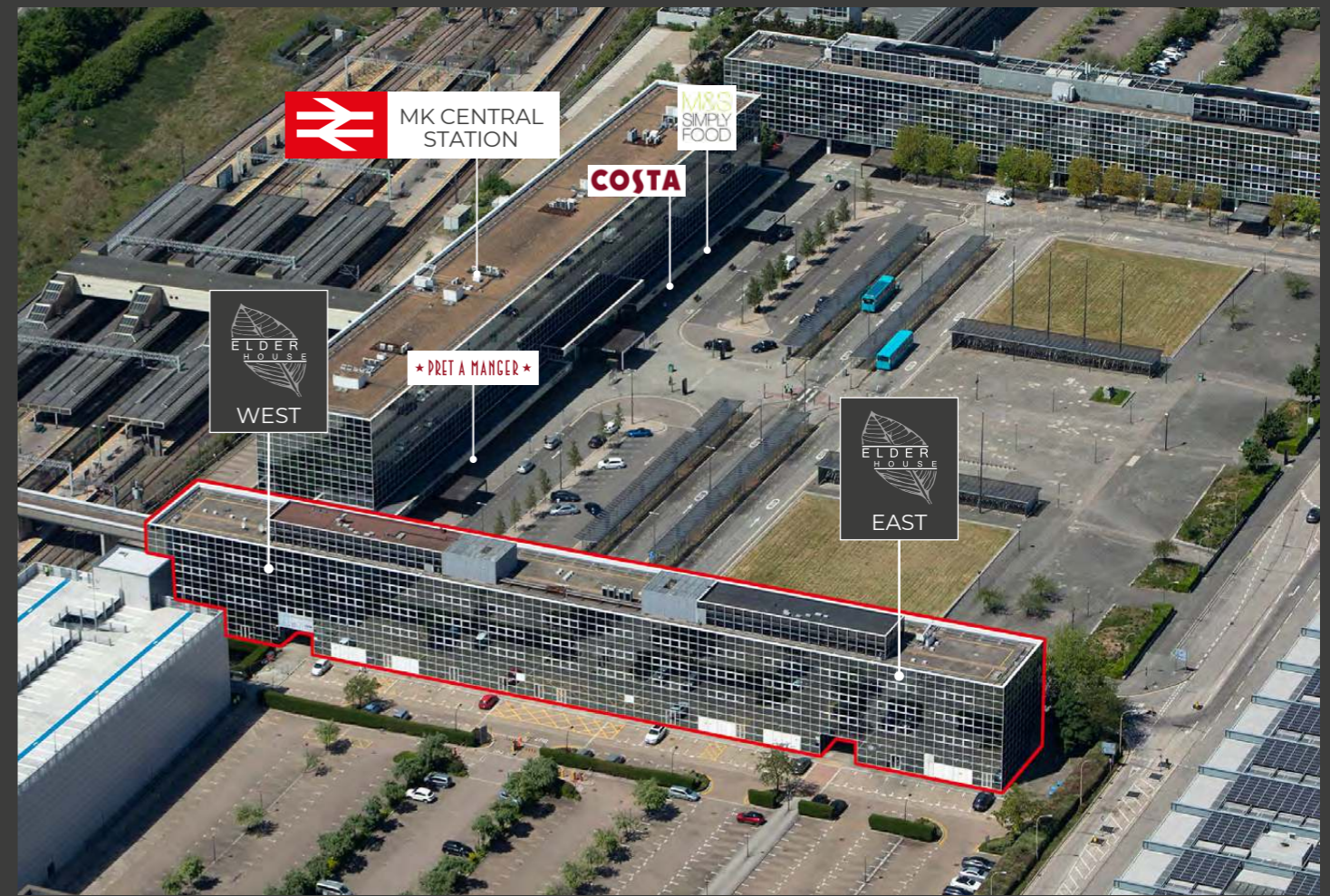
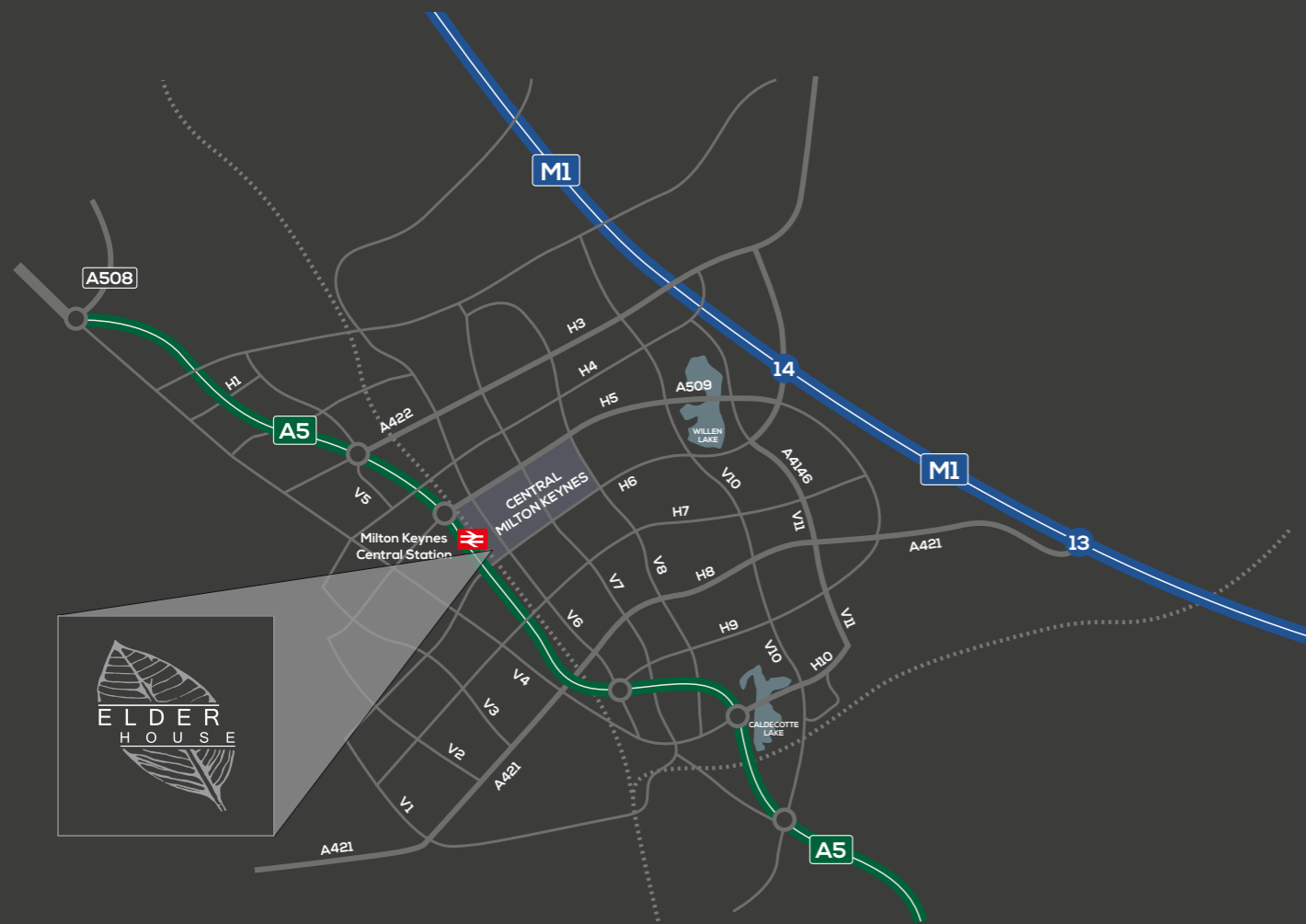

## LOCATION

Milton Keynes is strategically located in a central position to London, Birmingham, Oxford and Cambridge.

Elder House is conveniently located at the gateway to Central Milton Keynes whether arriving by rail on the West Coast Mainline, by Bus to the Central Bus Station on Elder Gate or by Road from the A5 or Grafton Gate (V6) dual carriageway.

Immediately adjacent to Elder House, Milton Keynes central train station offers regular and frequent trains to London Euston, with a fast journey time of approximately 33 minutes.

Junction 14 of the M1 Motorway is within a 5-10 minute drive.

## TRAVEL

### ON FOOT

Milton Keynes Central Station	1 min
The Hub	13 mins
The Centre:MK	20 mins

Source: Google Maps

### RAIL

Watford Junction	23 mins
London Euston	33 mins
Birmingham New Street	53 mins

Source: National Rail Enquiries

### ROAD

M1 Junction 14	4 miles
M25 Junction 21	34 miles
Central London	55 miles

Source: Google Maps

### AIRPORTS

London Luton	27 miles
London Heathrow Airport	57 miles
Birmingham International	65 miles

Source: Google Maps

33 minutes by rail to London Euston

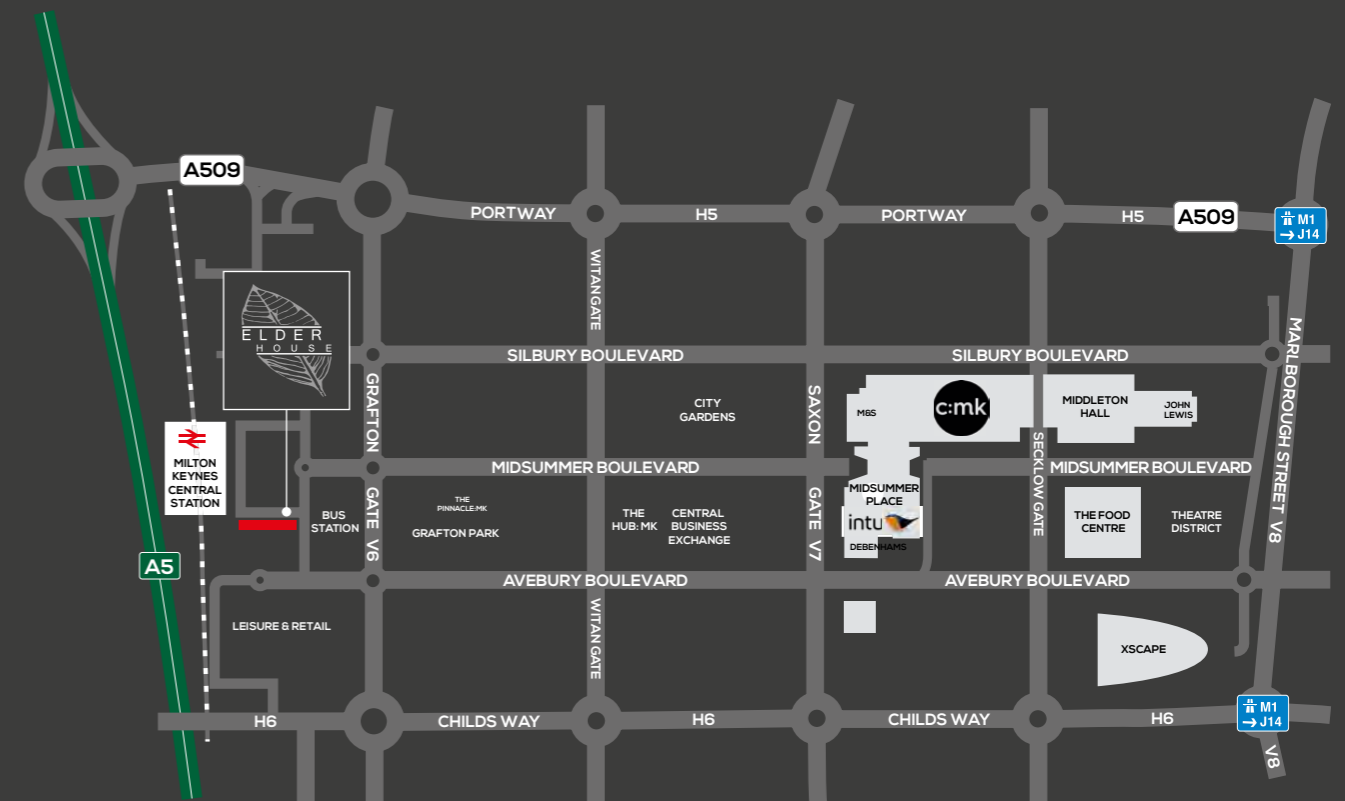



M1 J14

M1 J13

WILLEN LAKE

John Lewis

THEATRE DISTRICT

XSCAPE MILTON KEYNES

centre:mk MILTON KEYNES

intu

M&S

hub

Sainsbury's

Deloitte

Premier Inn

ELDER HOUSE

SHOOSMITHS

Morrisons

Santander

Travelodge

NetworkRail

MILTON KEYNES CENTRAL STATION

A5

PORTWAY

PORTWAY ROUNDABOUT

A5

STRATEGICALLY LOCATED:





## SPECIFICATION

- Adjacent to mainline railway station and MK bus station
- Private car parking based on 1 space per 444 sq. ft
- Adjacent to new multi storey car park housing 720 spaces
- Ground floor retail and restaurant units
- Building management team with manned reception area
- CCTV & access control 24/7
- 4 passenger lifts
- Male and female toilets on each floor along with disabled toilets located on the ground floor
- Double glazed reflective aluminium framed curtain walling to external elevations
- Comfort Cooling
- Suspended ceilings with LED lighting
- Raised floors

## ENERGY PERFORMANCE

Elder House has an energy performance rating of B.

## TERMS

Terms upon application to the joint sole agents.



## AVAILABLE SUITES

### 1st Floor East

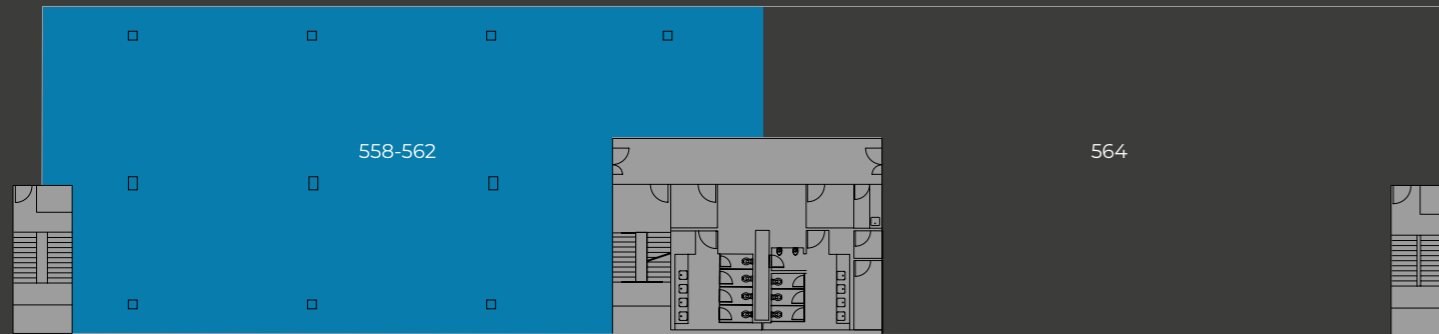

#### 558-562 Elder Gate

Net internal floor area:  
5,420 sq ft (504 sq m)

### 2nd Floor West

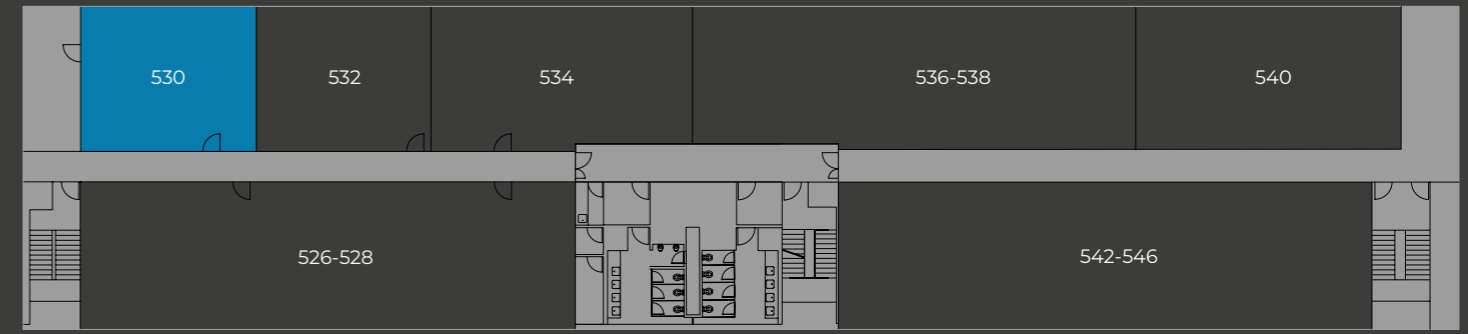

#### 530 Elder Gate

Net internal floor area:  
930 sq ft (86 sq m)

### 1st Floor West

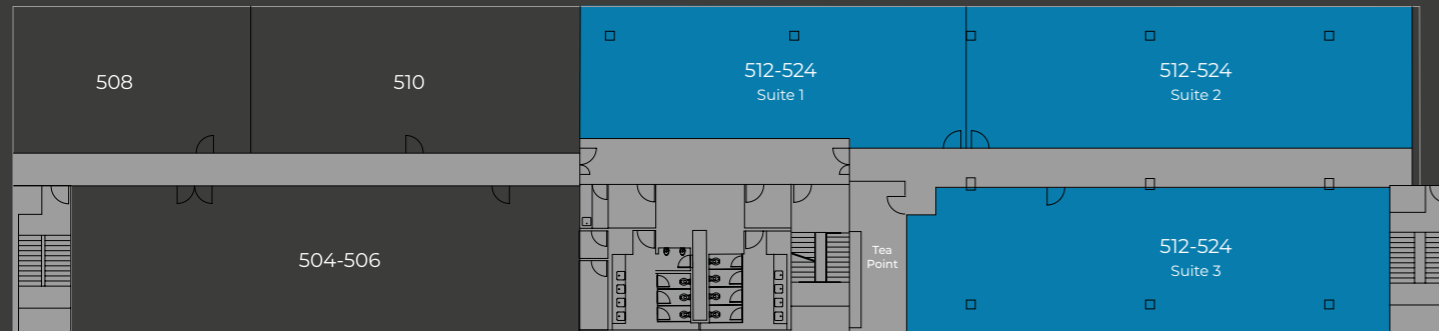

#### 512-524 Elder Gate

Net internal floor areas:

- Suite 1 765 sq ft (71 sq m)
- Suite 2 1,410 sq ft (131 sq m)
- Suite 3 1,690 sq ft (157 sq m)

### 3rd Floor West

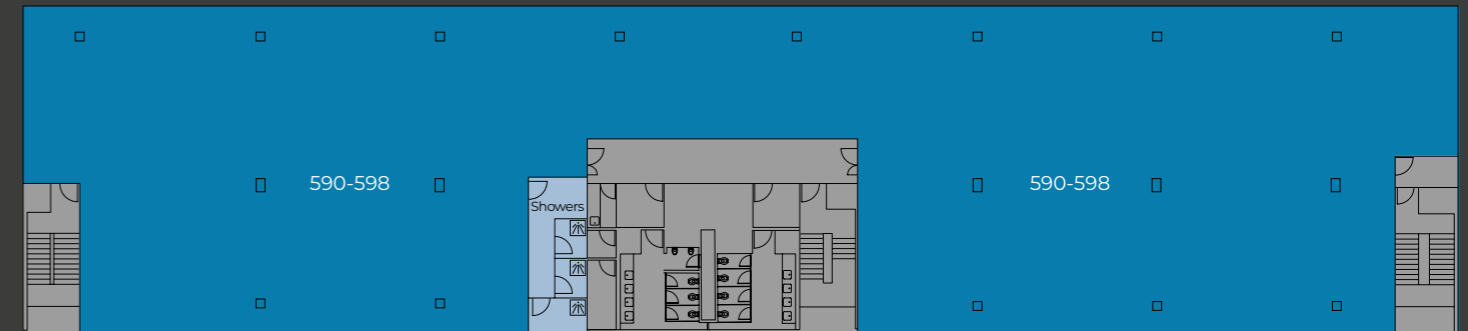

#### 590-598 Elder Gate

Net internal floor area:  
10,740 sq ft (998 sq m)



## FURTHER INFORMATION

Please view the website  
[www.elderhousemk.co.uk](http://www.elderhousemk.co.uk)  
or contact the joint sole agents:

**AVISON  
YOUNG**  
**020 7236 6363**  
[avisonyoung.co.uk](http://avisonyoung.co.uk)

 **louch  
shacklock**  
**01908 224760**  
[louchshacklock.com](http://louchshacklock.com)

ANGUS MALCOLMSON  
0207 911 2763  
[angus.malcolmson@avisonyoung.com](mailto:angus.malcolmson@avisonyoung.com)

JONATHAN WHITTLE  
01908 224 763  
[jonathan@louchshacklock.com](mailto:jonathan@louchshacklock.com)

CHRIS MCGEE  
0207 911 2197  
[chris.mcgee@avisonyoung.com](mailto:chris.mcgee@avisonyoung.com)

CHRIS MCCLURE  
01908 224 767  
[chris@louchshacklock.com](mailto:chris@louchshacklock.com)

DISCLAIMER: The Agents for themselves and for the vendors or lessors of the property whose agents they are give notice that: (i) these particulars are given without responsibility of The Agents or the Vendors or Lessors as a general outline only, for the guidance of prospective purchasers or tenants, and do not constitute the whole or any part of an offer or contract; (ii) The Agents cannot guarantee the accuracy of any description, dimension, references to condition, necessary permissions for use and occupation and other details contained herein and any prospective purchasers or tenants should not rely on them as statements or representations of fact but must satisfy themselves by inspection or otherwise as to the accuracy of each of them; (iii) no employee of The Agents has any authority to make or give any representation or enter into any contract whatsoever in relation to the property; (iv) VAT may be payable on the purchase price and / or rent, all figures are exclusive of VAT, intending purchasers or lessees must satisfy themselves as to the applicable VAT position, if necessary by taking appropriate professional advice; (v) The Agents will not be liable, in negligence or otherwise, for any loss arising from the use of these particulars. 07/20