

**PRICE**

\$24 PSF NNN

**SIZE**

2,280 Square Feet

**ZONING**

Bryn Mawr Village  
District 3



**ABOUT THE PROPERTY**

This property can be used for office or retail and is a good fit for tenants looking to become part of Bryn Mawr's thriving commercial corridor. Off-street parking is provided at the rear of the property...a huge plus!

**Highlights include....**

- **Prime Location:** Ground floor retail or office opportunity in the most sought-after stretch of the Main Line. 850 W. Lancaster places tenants squarely in the center of Bryn Mawr's walkable commercial hub.
- **Zoning:** Generous BMV3 zoning (Lower Merion Township) embraces a lengthy list of commercial uses, giving users maximum flexibility.
- **Nearby Amenities:** Suburban Square, Bryn Mawr Village, Villanova University, Bryn Mawr Train Station, I-476.

**PRESENTED BY**

James R. Wrigley  
215-519-2290 (m) | 215-855-5100 (o)  
jimw@kpgcm.com

Keith T. Metzger  
267-218-4819 (m) | 215-855-5100 ext 118 (o)  
keithm@kpgcm.com



# COMMERCIAL SPACE FOR LEASE

850 W Lancaster Ave, Bryn Mawr, PA 19010



## PRESENTED BY

James R. Wrigley  
215-519-2290 (m)  
215-855-5100 (o)  
jimw@kpgcm.com

Keith T. Metzger  
267-218-4819 (m)  
215-855-5100 ext 118 (o)  
keithm@kpgcm.com





# COMMERCIAL SPACE FOR LEASE

850 W Lancaster Ave, Bryn Mawr, PA 19010

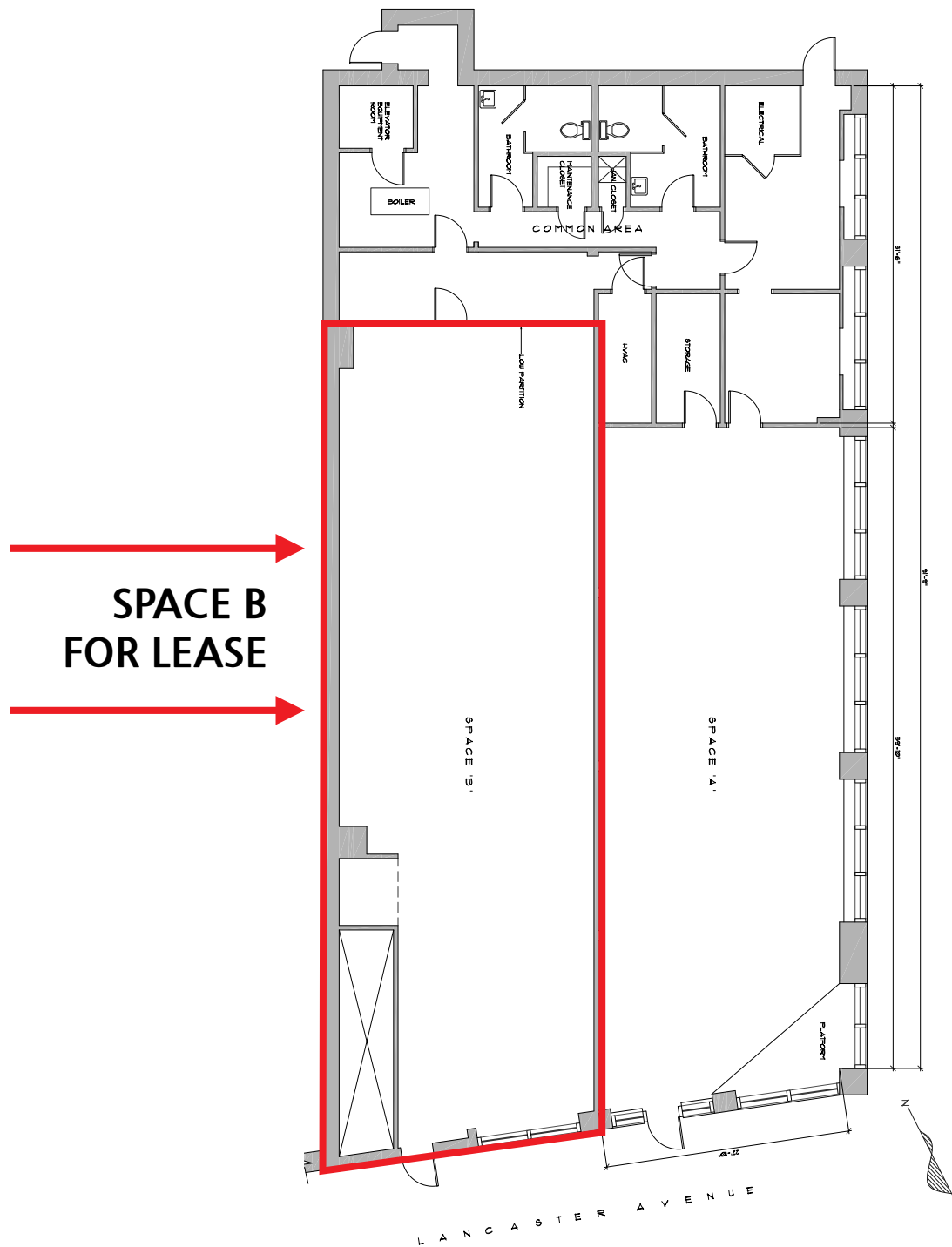

## PRESENTED BY

James R. Wrigley  
215-519-2290 (m)  
215-855-5100 (o)  
jimw@kpgcm.com

Keith T. Metzger  
267-218-4819 (m)  
215-855-5100 ext 118 (o)  
keithm@kpgcm.com

