

**BROKER
BONUS!**

\$100 New Seasons Market or Prime Tap House gift card to Broker for qualified tour!

\$3,000 Black Butte Ranch or Salishan Coastal Lodge gift card to Broker for qualified completed sublease!

cresa



Office Sublease Available

Plug & Play, FF&E included

Trellis at Amberglen – Apollo Building
9170 NE Turing Court
Hillsboro, OR 97006

Features:

- 40 acre campus with engaging outdoor spaces
- Onsite seasonal tenant events
- Onsite property management
- Adjacent amenity center ("The Mill") including fitness center, training room, cafe, food truck, outdoor barbeque and courtyard areas

Space Profile:

Premises	Suite 100	Available	Now
RSF	25,054	LED	November 30, 2026
Asking Rate	Call for pricing	Parking	4:1000, free EV charging stations

Contact:



Kelsey Machuca
503.679.2419
kmachuca@cresa.com



Blake St. Onge
971.258.4631
bstonge@cresa.com

Existing Floorplan

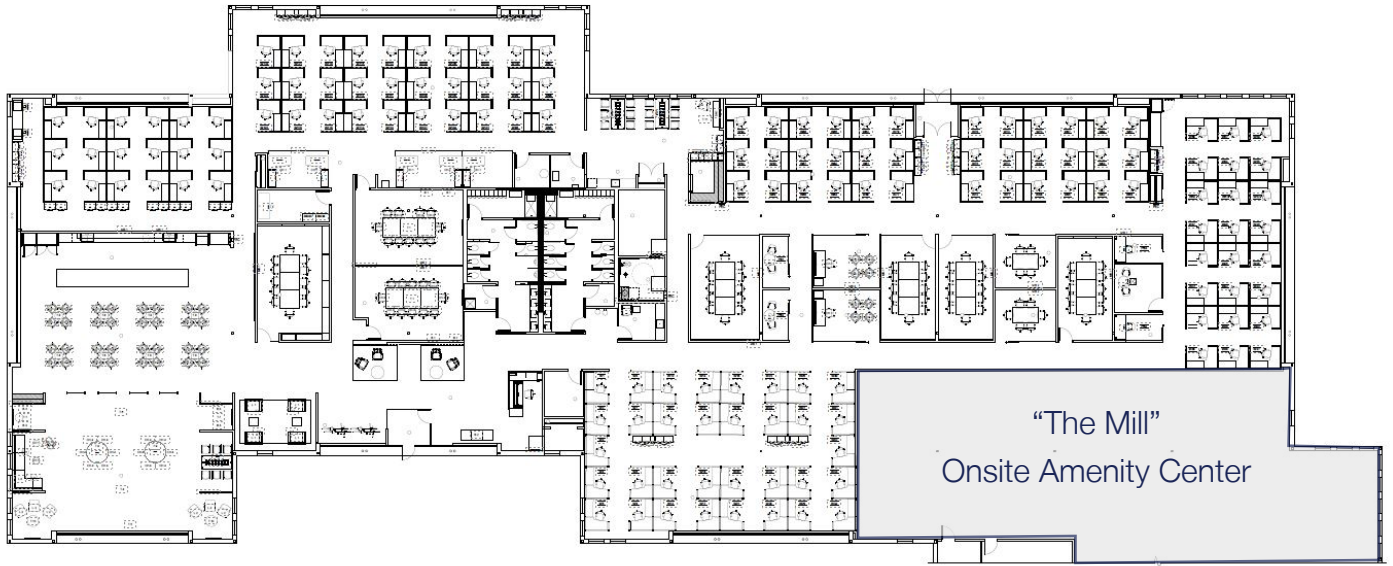

Sound Studio



Reception Area



Open Office



Meeting Pods



Office Sublease Available

9170 NE Turing Court
Hillsboro, OR 97006

Indoor Bike Storage



Conference Room*

*7 conference rooms onsite
(12 seats per table)



Lockers



Breakroom Seating



cresa

1355 NW Everett St. Suite 100 | Portland, OR 97209

cresa.com/Portland



Breakroom



Kitchenette

Office Sublease Available

**9170 NE Turing Court
Hillsboro, OR 97006**

Contact:

	<p>Kelsey Machuca 503.679.2419 kmachuca@cresa.com</p>		<p>Blake St. Onge 971.258.4631 bstonge@cresa.com</p>
--	--	--	---



Cresa © 2024. All rights reserved. The information contained in this document has been obtained from sources believed reliable. While Cresa does not doubt its accuracy, Cresa has not verified it and makes no guarantee, warranty, or representation about it. It is your responsibility to independently confirm its accuracy and completeness. Any projections, opinions, assumptions or estimates used are for example only and do not represent the current or future performance of the property. The value of this transaction to you depends on tax and other factors which should be evaluated by your tax, financial and legal advisors. You and your advisors should conduct a careful, independent investigation of the property to determine to your satisfaction the suitability of the property for your needs.