

4715 S. LAMAR, SUNSET VALLEY, TX 78745

4715 S. LAMAR

MEDICAL / OFFICE / RETAIL | LEASE



FOR INFORMATION

NICK TRIOLA

512.441.1062

NICK@KPGCOMMERCIAL.COM

4715 S. LAMAR

MEDICAL / OFFICE / RETAIL | LEASE

✓ AVAILABILITY

SUITE 100: 25,251 SF
*Divisible

💰 LEASE TERMS

RATE: \$35/SF + NNN
TI: Negotiable
TERM: 5-10 year

PROPERTY INFORMATION



★ FEATURES

LOCATION

- Located on S. Lamar Blvd with easy access to Hwy 290, IH-35, 360 and Mopac.
- 20 min. to ABIA
- 2 miles to St. David's Hospital

BUILDING

- Other Tenants: Milk + Honey, Stouthaus Coffee, Casper Fermentables, Vista Windows & Doors
- Adjacent Burger Stadium

DEMOGRAPHICS

(3-MILE, CoStar 2024)

- Population - 102,288
- Med Household Income - \$88,174
- Daytime Employees - 56,007



FOR INFORMATION

NICK TRIOLA
512.441.1062
nick@kpgcommercial.com

4715 S. LAMAR

MEDICAL / OFFICE / RETAIL | LEASE

AVAILABLE

SUITE 100: 25,251 SF

SITE PLAN

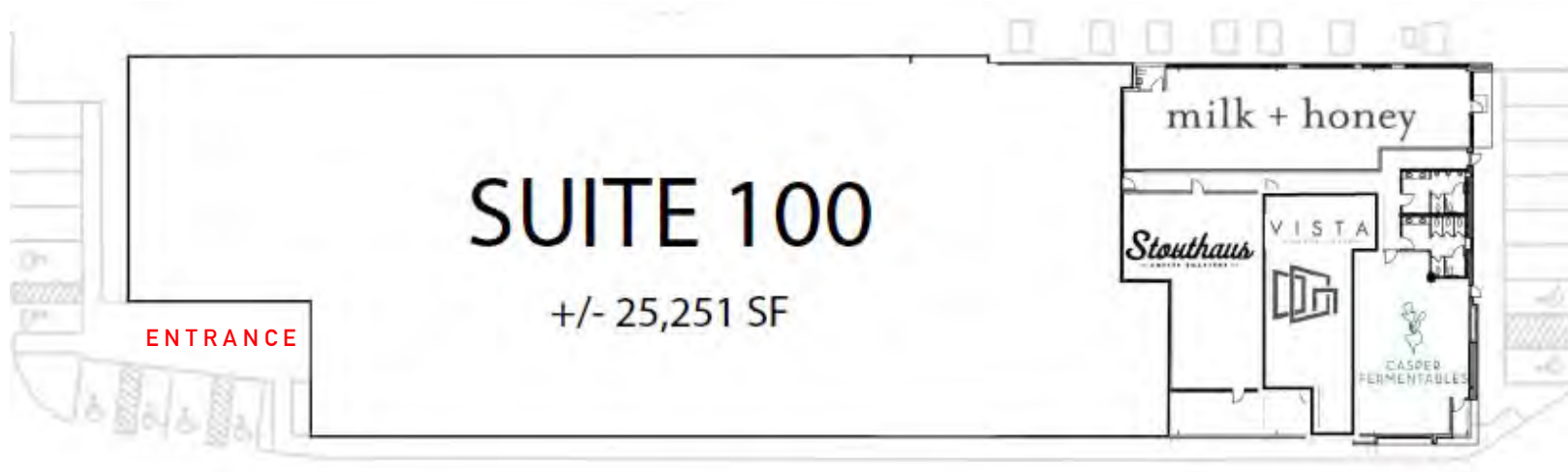

FLOOR PLAN

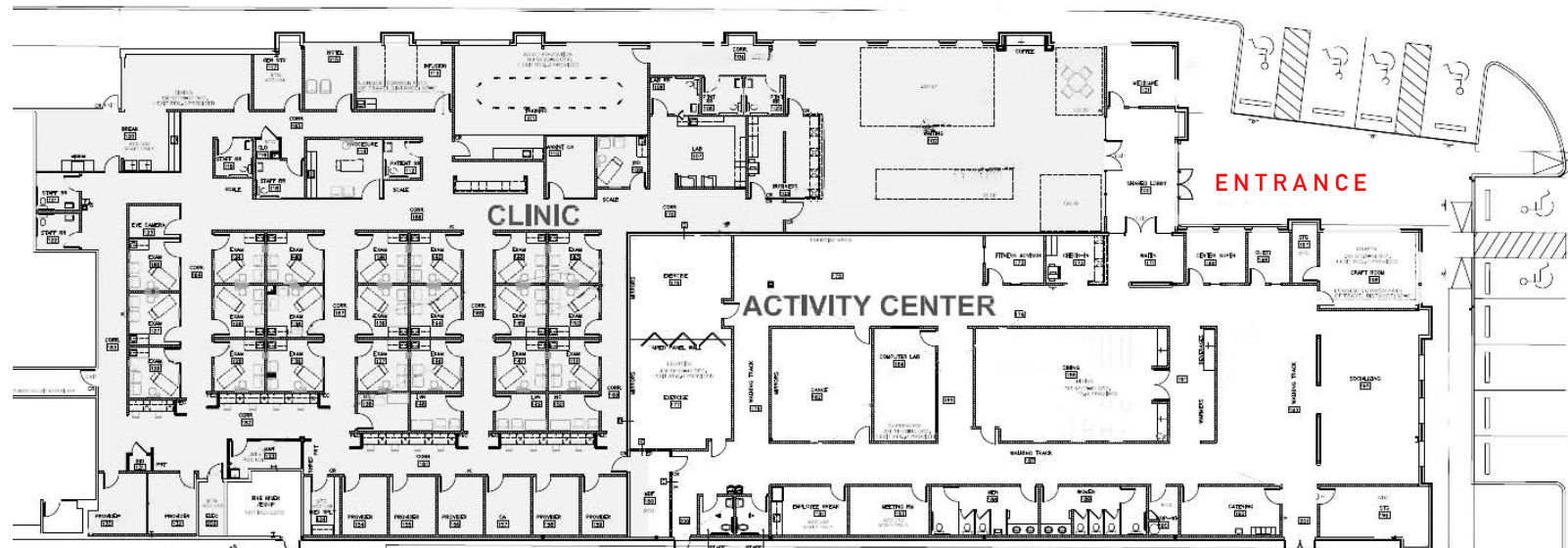

4715 S. LAMAR

MEDICAL / OFFICE / RETAIL | LEASE

AREA MAP



FOR INFORMATION

NICK TRIOLA
512.441.1062

nick@kpgcommercial.com

4715 S. LAMAR

MEDICAL / OFFICE / RETAIL | LEASE



FOR INFORMATION

NICK TRIOLA
512.441.1062

nick@kpgcommercial.com

The information contained in this offering material ("Summary") is confidential, furnished solely for the purpose of the review by a prospective interested parties of the Property and is not to be used for any other purpose or made available to any other person without the express written consent of KPG Commercial. The material is based in part upon information supplied by the owner of the Property ("Owner") and in part upon information obtained by KPG Commercial from sources it deems reliable. Summaries of any documents are not intended to be comprehensive or all inclusive but rather only outlines of some of the provisions contained herein or as to engineering or environmental matters. Prospective interested parties should make their own projections and conclusions without reliance upon the material contained herein and conduct their own independent due diligence, including engineering and environmental inspections, to determine the condition of the property and the existence of any potentially hazardous material used in the construction or maintenance of the building or located on site.