



2610, Unit B & 2660 Columbia Street Torrance, CA 90503

- Full Creative Industrial Conversion
- Like New Building Exterior and Interior
- Central Torrance Location
- ± 14,832 SF of Creative Offices
- 6 DH / 1 GL Truck Doors
- High Efficiency LED Lighting in Warehouse
- Power - 1000 Amps
- Professionally Owned & Managed by First Industrial Realty Trust

Highlights

Available Space:	73,618 SF
Building SF:	100,778 SF
Office Space:	± 14,832 SF
Clear Height:	20'
Loading Doors:	6 DH / 1 GL
Parking Ratio:	TBD
Power:	1000 Amps 277-480 Volts

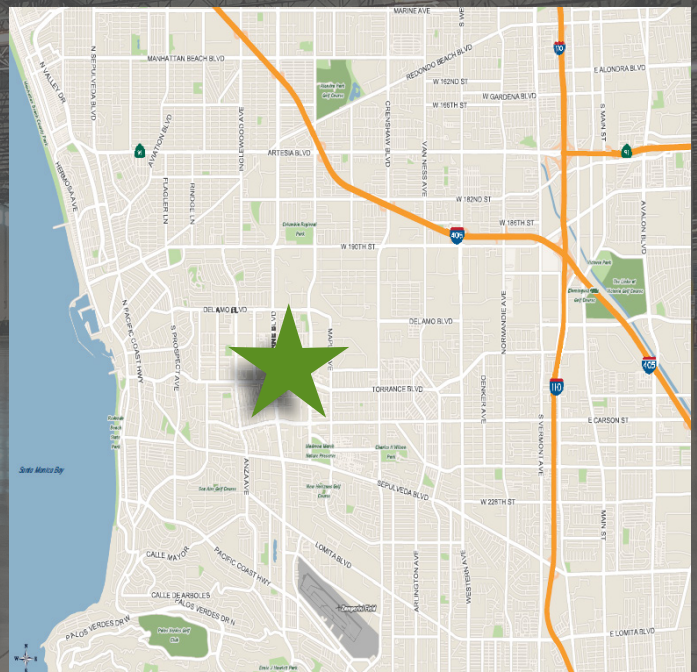

2610, Unit B & 2660 Columbia Street Torrance, CA 90503



All information furnished regarding the property for sale, rental or financing is obtained from sources deemed reliable. No representation is made to the accuracy thereof and is submitted subject to errors, omissions, change of price rental or other conditions, prior sale, lease, or financing, or withdrawal without notice. First Industrial Realty Trust, Inc. represents the Seller in this transaction and as such owes all duties and obligations thereto.

2610, Unit B & 2660 Columbia Street Torrance, CA 90503

Site Plans

2610 Columbia St, Unit B

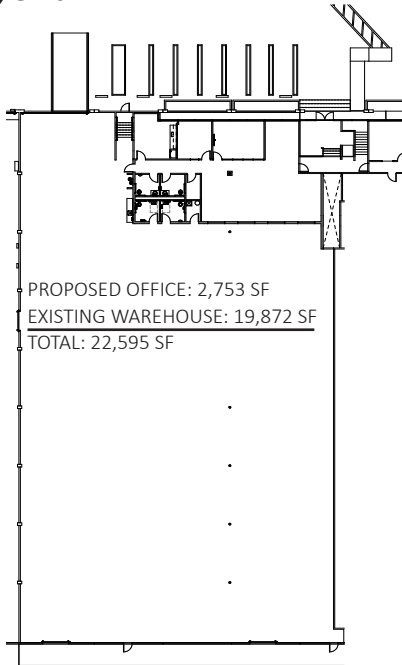

2660 Columbia St

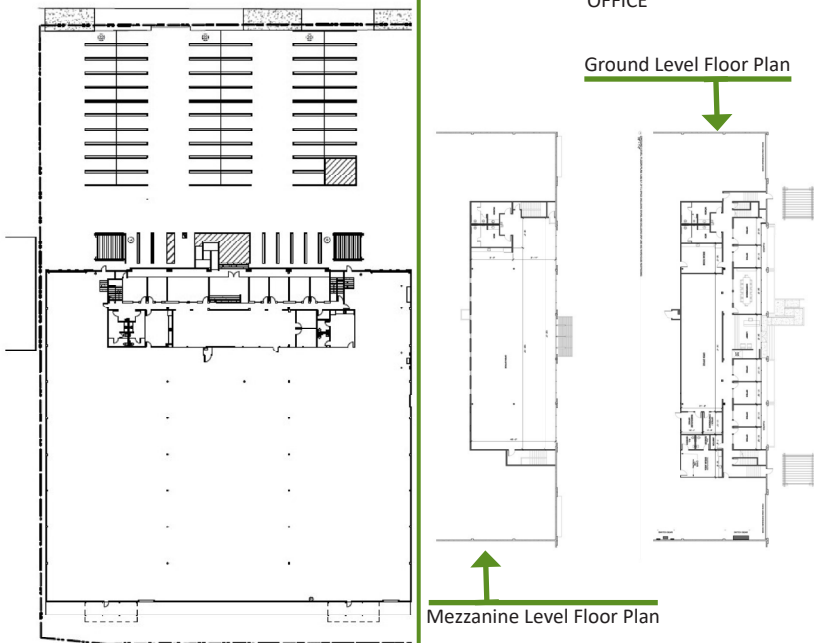

Broker Contact:

JEFF SMART

Senior Executive Vice President

License No. 00918873

+1 310 321 1812

jeffrey.smart@colliers.com

ELIZABETH CAPATI

Senior Associate

License No. 02109628

+1 310 321 1855

elizabeth.capati@colliers.com

2121 Rosecrans Avenue
Suite 1120
El Segundo, CA 90245
www.colliers.com



Owner Contact:

JERRY DEVON

Marketing & Leasing Director

898 N. Pacific Coast Highway | Suite 175

El Segundo, CA 90245

Direct: +1 (424) 220-9212

gdevon@firt.com



www.firstindustrial.com