

FOR LEASE

±659 - ±1,147 SF
OF OFFICE SPACE
AVAILABLE



PROPERTY FEATURES

- Multi - Tenant Office Property in the Highly Desirable Scripps Ranch Submarket
- Building Size: ±17,966 SF
- Built in 1980
- Two (2) Floors
- Great Access to I-15 Freeway
- Janitorial Included



Josh West, SIOR
Sr. Vice President - Partner
direct (858) 458-3358
Jwest@voitco.com
Lic. 01923375

Brian Mulvaney, SIOR, CCIM
Sr. Vice President - Partner
direct (858)458.3372
Bmulvaney@voitco.com
Lic. 00938944

Voit

REAL ESTATE SERVICES

MULVANEY SIOR
COMMERCIAL ALLIANCE 

FOR LEASE

±659 SF

OF OFFICE SPACE

AVAILABLE

SUITE: 202

SIZE: ±659 SF

RATE: \$2.00 + E

NOTES: AVAILABLE 2/1/2025

FLOOR PLAN

PENDING

FOR LEASE

±1,147 SF
OF OFFICE SPACE
AVAILABLE

SUITE: 203

SIZE: ±1,147 SF

RATE: \$2.00 PSF + E

AVAILABLE: NOW

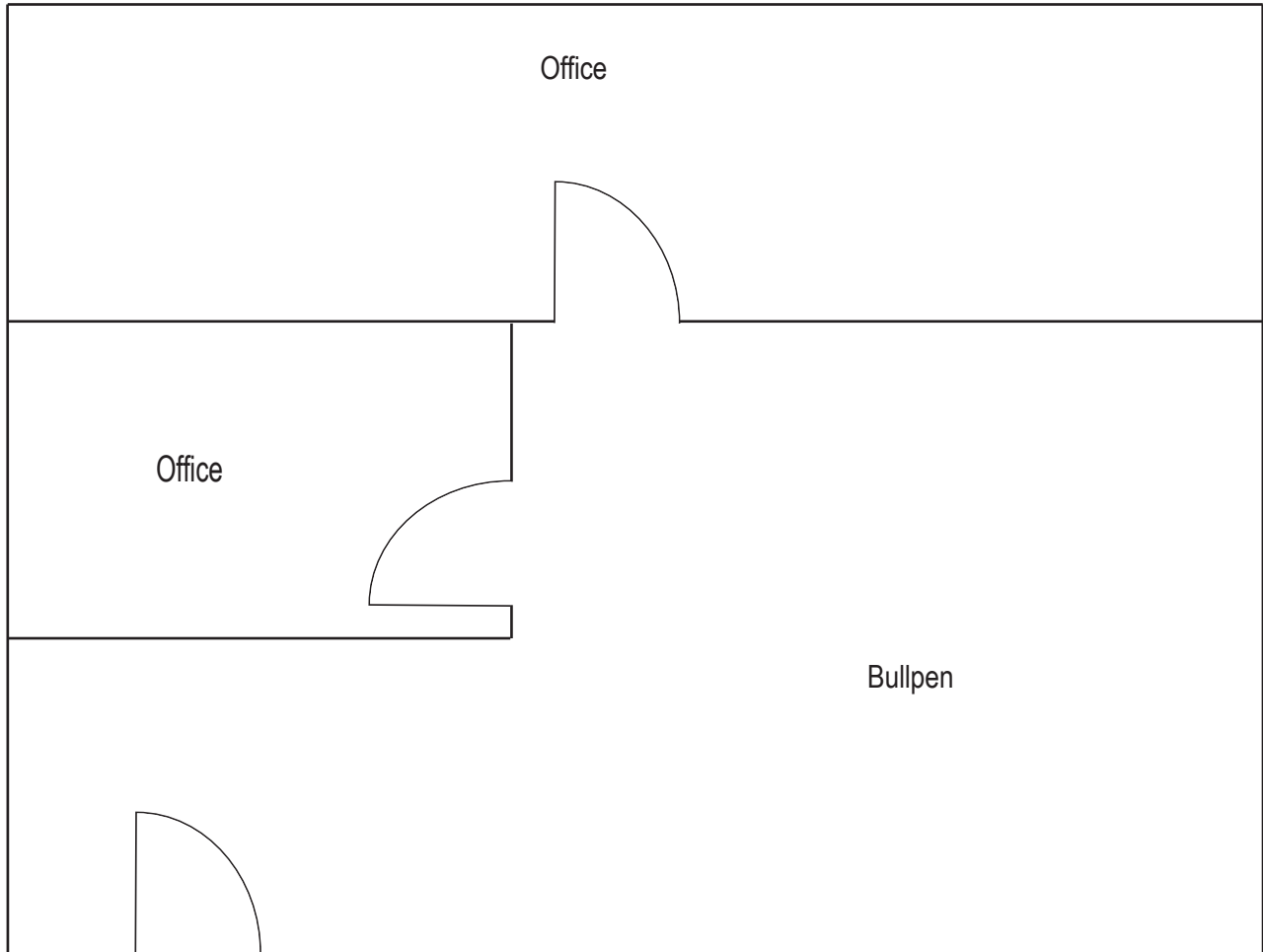

Josh West, SIOR
Sr. Vice President - Partner
direct (858) 458-3358
Jwest@voitco.com
Lic. 01923375

Brian Mulvaney, SIOR, CCIM
Sr. Vice President - Partner
direct (858)458.3372
Bmulvaney@voitco.com
Lic. 00938944

Voit

REAL ESTATE SERVICES

MULVANEY SIOR
COMMERCIAL
ALLIANCE 