

# FOR SALE

## INDUSTRIAL PROPERTY

SHOWROOM | WAREHOUSE | OFFICES



2710 W PAWNEE STREET  
**WICHITA, KS 67213**



LANDMARK  
COMMERCIAL  
REAL ESTATE

# Property Details



2710 W. PAWNEE ST., WICHITA, KS 67213

## PROPERTY SUMMARY + HIGHLIGHTS

**PLEASE DO NOT  
DISTURB CURRENT  
TENANT**

<b>Sale Price</b>	Please Contact Agent
<b>Building SF</b>	Warehouse: 20,648 SF Showroom / Offices: 7,000 SF Total = 27,648 SF
<b>Land Size</b>	1.85 acres
<b>Zoning</b>	Light Industrial Former aerospace mfg and electrical supply-house facility
<b>Occupancy</b>	Currently Occupied - Tenant's Lease Expires 04/30/2025
<b>Location</b>	Located on Pawnee west of Meridian in the extensive Southwest Industrial District
<b>Nearby Tenants</b>	Capps Mfg, LKQ, Textron, Smithfield, QuickTrip, Omni Aerospace, and many more
<b>Parking</b>	3.07 / 1,000 SF
<b>Loading</b>	Two 14'x14' overhead doors; one dock
<b>Ceiling Height</b>	14' to 24'
<b>Electric Power</b>	800 amp, 480 v, 3 phase

DEMOGRAPHICS	1 Mile	3 Miles	5 Miles
<b>Population</b>	9,901	65,991	171,227
<b>Households</b>	3,759	27,023	71,188
<b>Avg HH Income</b>	\$67,450	\$61,082	\$65,052

2710 W. Pawnee St., Wichita, KS 67213



2710 W. Pawnee St., Wichita, KS 67213



2710 W. Pawnee St., Wichita, KS 67213



# Floor Plan

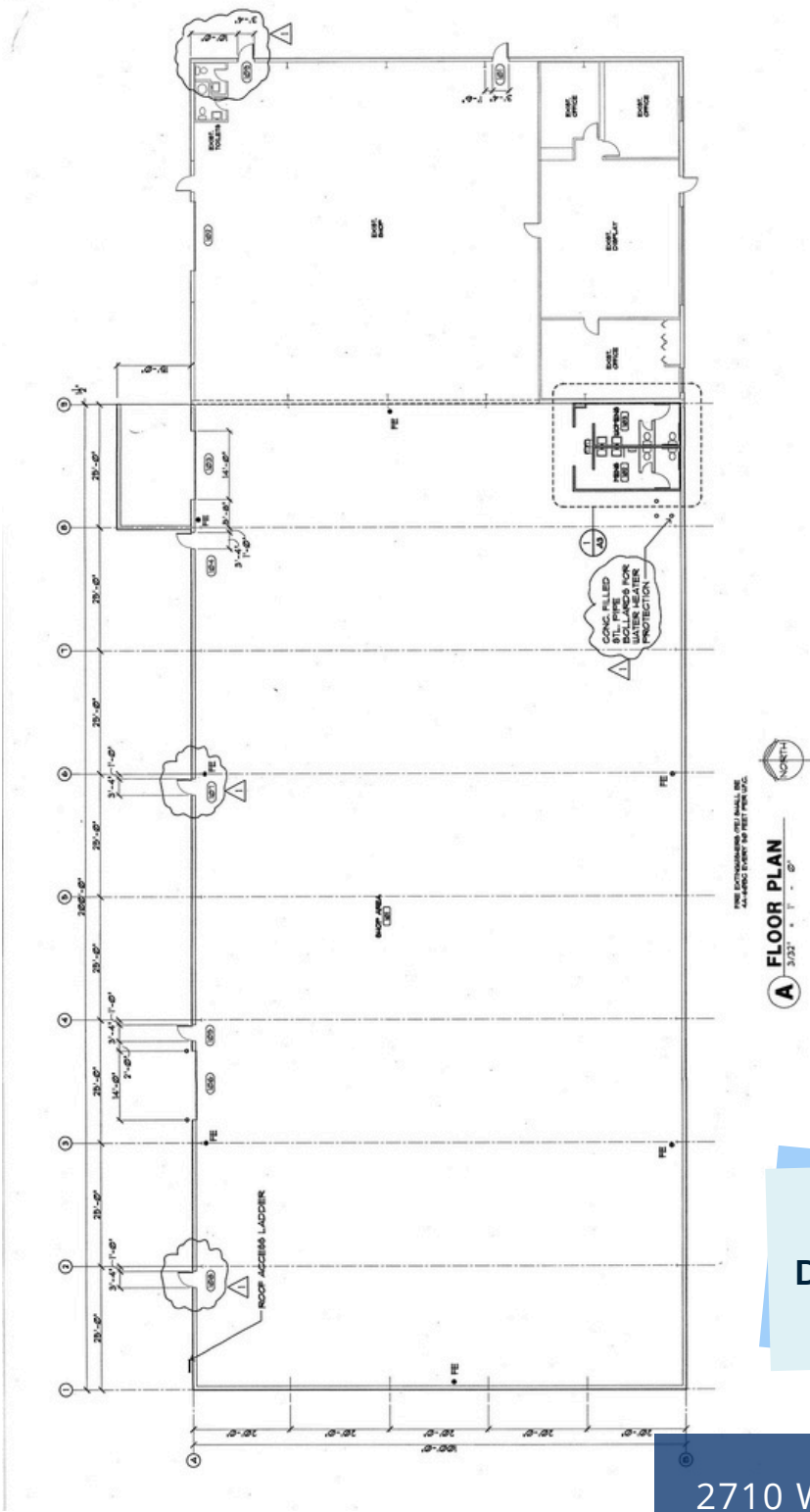

**PLEASE DO NOT  
DISTURB CURRENT  
TENANT**

2710 W. Pawnee St.  
**Wichita, KS 67213**  
Sedgwick County

# Site Aerial



2710 W. Pawnee St.  
**Wichita, KS 67213**  
Sedgwick County

50 0 50 100ft

2815

280

# Area Map



2710 W. Pawnee St.  
Wichita, KS 67213  
Sedgwick County





**Alex Bathie**

[alexb@prostarcre.com](mailto:alexb@prostarcre.com)

214.459.0859

**Rob Wolfle**

[rob@prostarcre.com](mailto:rob@prostarcre.com)

214.459.0853

**Ted Branson, SIOR**

[tbranson@landmarkrealestate.net](mailto:tbranson@landmarkrealestate.net)

316.262.2442



**LANDMARK  
COMMERCIAL  
REAL ESTATE**