



BROKERAGE DONE DIFFERENTLY

live
work
& play

IN TAMPA BAY!

813.935.9600

TINA MARIE ELOIAN, CCIM

TINA@FLORIDACOMMERCIALGROUP.COM

FLORIDA COMMERCIAL GROUP

401 EAST PALM AVENUE, TAMPA, FL 33602

FLORIDACOMMERCIALGROUP.COM

**3408 N. 15TH STREET
TAMPA, FL 33605**

OPPORTUNITY ZONE | SELLER FINANCING | ZONED COMMERCIAL INTENSIVE (CI)

EAST TAMPA :: 0.17 ACRE SITE

FOR SALE \$295,000 /



This information is from sources deemed to be reliable. We are not responsible for misstatements of facts, errors or omissions, prior sale, change of price and/or terms or withdrawal from the market without notice. Buyer shall verify all information with their own representatives as well as state and local agencies.

LISTING DETAILS

FINANCIAL & TERMS

Status: Active
 Offering Price: \$295,000/
 Price per SF: \$253,218.88/
 Purchase Options: Cash, Hard Money, Conventional, SBA
 Financing Available: TBD, Contact Broker
 Expenses: Available Upon Request
 (Property Taxes, Insurance, Utilities, Alarm, Lawn/ Maintenance, Pest Control, etc...)

LOCATION

Street Number: 3408
 Street Name: N. 15th Street
 Street City: Tampa
 County: Hillsborough
 Traffic Count/ Cross Streets:
 4,500 VTD (N. 15th Street and Lake Avenue) AADT, 2021
 Market: Tampa/ St. Petersburg/ Clearwater
 Sub-Market: Ybor Area North

THE PROPERTY

Folio Numbers: 173301-0000
 Zoning: CI (commercial intensive)
 Current Use: Hotel/ Motel (rooming house)
 Site Improvements: 1,165 SF Home
 AYB: 1928
 Lot Size: 7,590 SF
 Lot Dimensions: 69'x 110'
 Front Footage: 69' (approx.)
 Total Acreage: .17 AC

THE LISTING

Driving Directions:

From Downtown Tampa: Head north on Nebraska Avenue to E. 21st Street, turn right. Head east. At N. 15th Street turn left. Head north 3/10ths of a mile. Property will be on the left.

THE COMMUNITY

Community/Subdivision Name: BENJAMINS 3RD SUB
 Flood Zone Area: X
 Flood Zone Panel: 12057C0352J

UTILITIES

Electricity: **TECO**
 Water: **City of Tampa**
 Waste: **City of Tampa**
 Communications: **Spectrum/ Frontier/ Verizon**

TAXES

Tax Year: **2022**
 Taxes: **\$1,621.29**



BROKERAGE DONE DIFFERENTLY

LISTING AGENT: TINA MARIE ELOIAN, CCIM | 813.935.9600 | TINA@FLORIDACOMMERCIALGROUP.COM

401 EAST PALM AVENUE, TAMPA, FL 33602 FLORIDACOMMERCIALGROUP.COM



AERIAL MAP



BROKERAGE DONE DIFFERENTLY

LISTING AGENT: TINA MARIE ELOIAN, CCIM | 813.935.9600 | TINA@FLORIDACOMMERCIALGROUP.COM

401 EAST PALM AVENUE, TAMPA, FL 33602 FLORIDACOMMERCIALGROUP.COM



DIRECTIONAL MAP

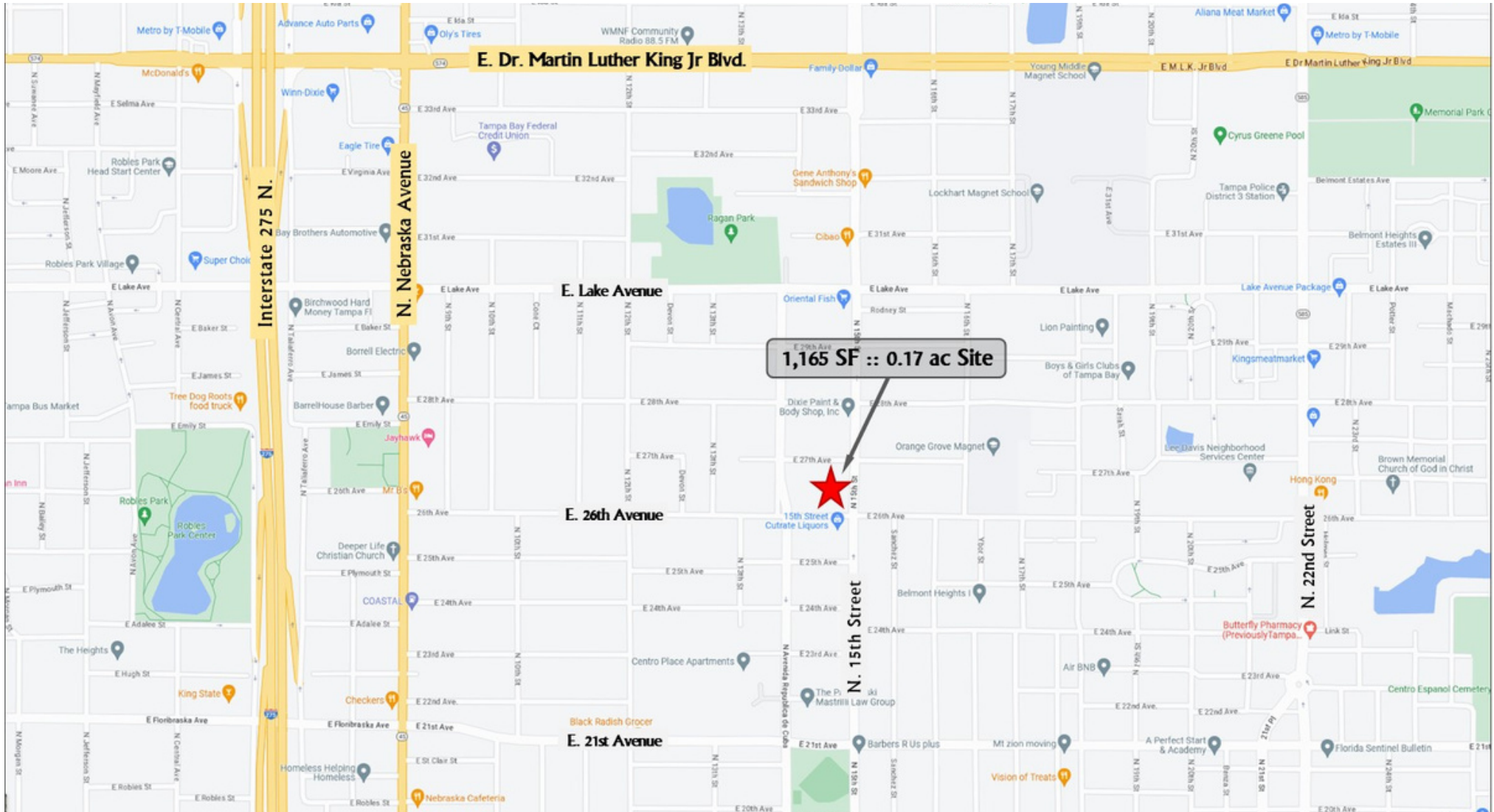

BROKERAGE DONE DIFFERENTLY

LISTING AGENT: TINA MARIE ELOIAN, CCIM | 813.935.9600 | TINA@FLORIDACOMMERCIALGROUP.COM

401 EAST PALM AVENUE, TAMPA, FL 33602 FLORIDACOMMERCIALGROUP.COM



INVESTMENT HIGHLIGHTS & DEMOGRAPHICS

- Redevelopment opportunity
- Excellent site for NEW east Tampa development
- 1,165 SF bldg. onsite for office use
- .17 acres :: 7,590 SF lot
- 69' of direct N. 15th Street frontage
- Suitable for a multitude of commercial end users
- Currently used as residential
- Zoned CI (commercial intensive) allows for a wide variety of commercial uses to include: ALF, vehicle service and repair, storage, light manufacturing, brewery, distillery, daycare, office and various other uses (see Commercial Intensive Allowable Uses)
- Situated along a densely packed, high growth corridor for retailers, multi- family and other commercial or industrial commerce
- HUBZone/Opportunity Zone property (This area qualifies for business and tax incentives)
- Average Daily Traffic count of 5,000+ cars a day
- Within a 3-mile radius of this site resides approximately 53,034 people with an average age of 35.5 and a HHI of over \$62,200
- Located between E. 21st Avenue & E. Lake Avenue and N. Nebraska Avenue and N. 22nd Street
- Minutes from Interstate 275, Dr. Martin Luther King Blvd., Interstate 4, N. Nebraska Avenue, N. 22nd Street, Ybor City, Seminole Heights and Downtown Tampa
- 1 mile to Ybor City/ 3 minutes :: 2 miles to DTT/ 7 minutes :: 14 miles to TIA/ 20 minutes :: 1 miles to I-275/ 4 minutes

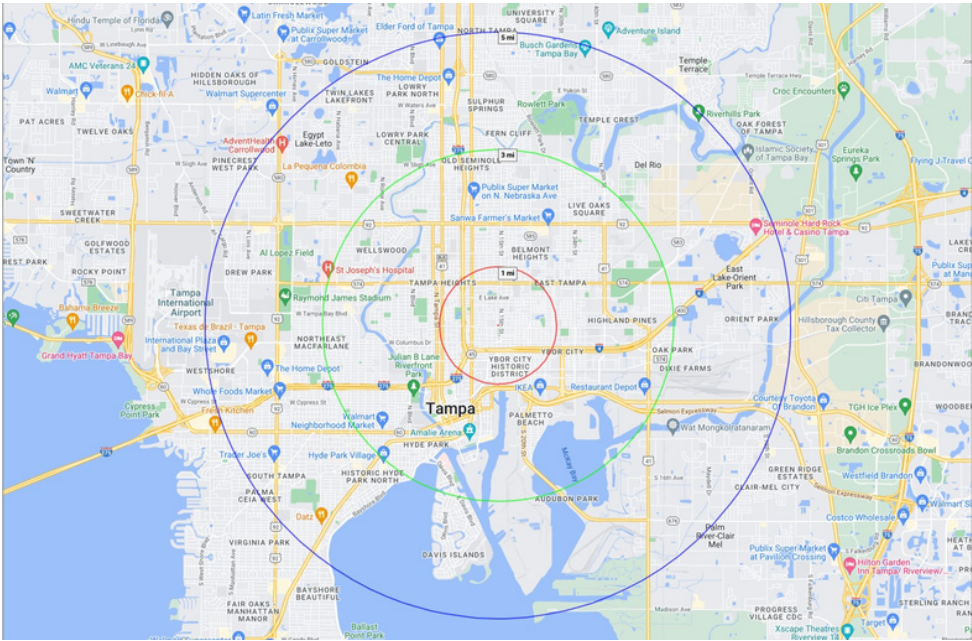

POPULATION	1 Mile	3 Miles	5 Miles
Total population	17,450	114,514	273,636
Median age	34.5	35.5	36.8
Median age (Male)	34.4	34.9	35.7
Median age (Female)	34.5	36.9	38.2
HOUSEHOLDS & INCOME	1 Mile	3 Miles	5 Miles
Total households	8,516	53,034	121,660
# of persons per HH	2	2.2	2.2
Average HH income	\$37,250	\$62,191	\$66,448
Average house value	\$133,596	\$213,956	\$238,861

CALL TODAY FOR ADDITIONAL PROPERTY DETAILS! 813.935.9600

BROKERAGE DONE DIFFERENTLY

LISTING AGENT: TINA MARIE ELOIAN, CCIM | 813.935.9600 | TINA@FLORIDACOMMERCIALGROUP.COM

401 EAST PALM AVENUE, TAMPA, FL 33602 FLORIDACOMMERCIALGROUP.COM



Your Tampa Bay and Beyond Commercial Real Estate Experts

SALES • INVESTMENTS • LEASING • PROPERTY MANAGEMENT

When you're looking to engage in any commercial real estate transaction – including buying, selling, leasing, financing, or even developing real estate – using a CCIM for your transaction is the best investment you'll make. Backed by **knowledge, stability, and resources**, Florida Commercial Group is uniquely equipped to assist you in all your real estate needs.

Our boutique brokerage is recognized in the Tampa Bay area as an **authority on all types of properties** with a **commitment to excellence and exceptional service**. With over 20 years of experience in residential and commercial real estate brokerage, leasing, property management, development, and investment services our team of specialists offers you a full suite of comprehensive services.

How Can We Help?

- BUYER & SELLER REPRESENTATION
- TENANT & LANDLORD REPRESENTATION
- PROPERTY MANAGEMENT FOR OWNERS & FINANCIAL INSTITUTIONS
- VALUATION & ADVISORY SERVICES
- COMMERCIAL & RESIDENTIAL

This information is from sources deemed to be reliable. We are not responsible for misstatements of facts, errors or omissions, prior sale, change of price and/or terms or withdrawal from the market without notice. Buyer shall verify all information with their own representatives as well as state and local agencies.



BROKERAGE DONE DIFFERENTLY
401 EAST PALM AVENUE, TAMPA, FL 33602
FLORIDACOMMERCIALGROUP.COM
OFFICE: 813.935.9600

CALL OUR TEAM TODAY!
813.935.9600



THE MOST ADVANCED COMMERCIAL REAL ESTATE INVESTMENT SPECIALISTS ANYWHERE!
CERTIFIED COMMERCIAL INVESTMENT MEMBER 2021



TINA MARIE ELOIAN
CCIM & BROKER

MOBILE: 813.997.4321

TINA@FLORIDACOMMERCIALGROUP.COM

