



# 237 PUTNAM AVENUE

CAMBRIDGE, MA

± 14,090 SF

PLUG-AND-PLAY LABORATORY FOR SUBLEASE

FLEXIBLE TERM THROUGH 8/31/2028

**NEWMARK**



# THIRD FLOOR

## Office Breakdown

- 4 Private Offices
- 1 Large Conference Room
- 1 Medium Conference Room
- 3 Huddle Rooms
- Lobby/Reception Area
- 1 Large Kitchen
- 1 Coffee Room
- 1 Open Office Area with 38 Desks and Collaboration Areas

## Lab Breakdown

- 2 Open Lab Areas with 26 Lab Benches
- 3 Lab Support Rooms
- 1 Freezer Farm
- IT room

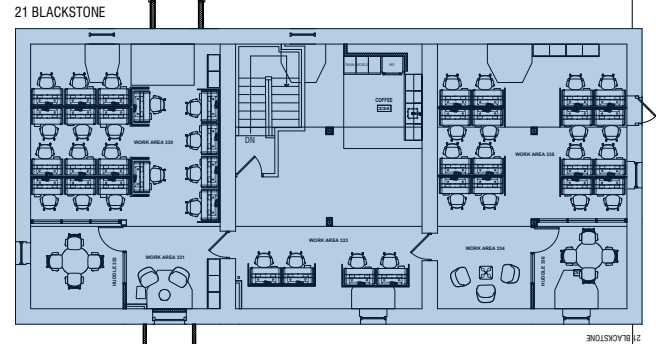

Lab space  
 Office space





# TRANSPORTATION ACCESS



15 min walk to  
**MBTA Red Line at  
Central Square**



7 minutes  
to **Route 2**



# 237 PUTNAM AVENUE

CAMBRIDGE, MA

**NEWMARK**

## FOR MORE INFORMATION:

**MARK WINTERS**

Vice Chairman

617-905-6750

[Mark.Winters@nmrk.com](mailto:Mark.Winters@nmrk.com)

**CATIE DUFFY**

Director

617-863-8130

[Catie.Duffy@nmrk.com](mailto:Catie.Duffy@nmrk.com)

The information contained herein has been obtained from sources deemed reliable but has not been verified and no guarantee, warranty or representation, either express or implied, is made with respect to such information. Terms of sale or lease and availability are subject to change or withdrawal without notice.