

1140 E Butler

1140 East Butler Road, Greenville, SC 29607

FOR LEASE

Executive Summary

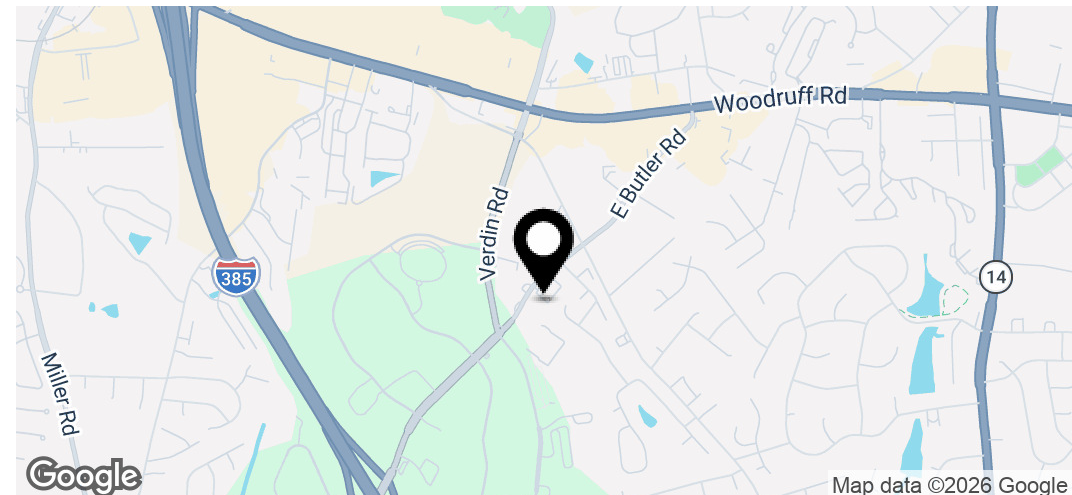

Offering Summary

Lease Rate	\$30 SF/yr
Lease Type	NNN
Parking Spaces / Ratio	null / null
RSF Available	1,440 - 1,537 SF
Year Built	2024

Property Overview

Discover a prime leasing opportunity at 1140 East Butler Road, Greenville, SC, 29607. This exceptional property boasts easy access to I-385 and Woodruff Rd, offering unparalleled convenience for tenants and clients. Ample on-site parking ensures parking will never be a concern. The property features modern amenities, spacious office layouts, and professional common areas designed to elevate the work environment. Experience the perfect blend of comfort and functionality, with versatile spaces ideal for a wide range of business needs. Join a thriving business community and take advantage of this premier leasing opportunity in a prime location.

Property Highlights

- New Construction
- Ample On-site Parking
- Modern Amenities

Bryon Culbertson

Broker
864 233 7724
bculbertson@joynercommercial.com

Berkshire Hathaway HomeServices

C. Dan Joyner, REALTORS

230 Buist Avenue
Greenville, SC 29609
864.233.7724

[View Website](#)

**BERKSHIRE
HATHAWAY**
HOMESERVICES

C. DAN JOYNER,
REALTORS®

1140 E Butler

1140 East Butler Road, Greenville, SC 29607

FOR LEASE

Property Summary



Property Description

Discover a prime leasing opportunity at 1140 East Butler Road, Greenville, SC, 29607. This exceptional property boasts easy access to I-385 and Woodruff Rd, offering unparalleled convenience for tenants and clients. Ample on-site parking ensures parking will never be a concern. The property features modern amenities, spacious office layouts, and professional common areas designed to elevate the work environment. Experience the perfect blend of comfort and functionality, with versatile spaces ideal for a wide range of business needs. Join a thriving business community and take advantage of this premier leasing opportunity in a prime location.

Property Highlights

- New Construction
- Ample On-site Parking

Offering Summary

Lease Rate:	\$30 SF/yr (NNN)
Available SF:	1,440 - 1,537 SF
Building Size:	18,088 SF

Demographics	0.3 Miles	0.5 Miles	1 Mile
Total Households	124	364	3,321
Total Population	320	926	7,696
Average HH Income	\$112,292	\$111,733	\$116,069

Bryon Culbertson
Broker
864 233 7724
bculbertson@joynercommercial.com

Berkshire Hathaway HomeServices
C. Dan Joyner, REALTORS
230 Buist Avenue
Greenville, SC 29609
864.233.7724
[View Website](#)

BERKSHIRE
HATHAWAY
HOMESERVICES

C. DAN JOYNER,
REALTORS®

1140 E Butler

1140 East Butler Road, Greenville, SC 29607

FOR LEASE

Location Map

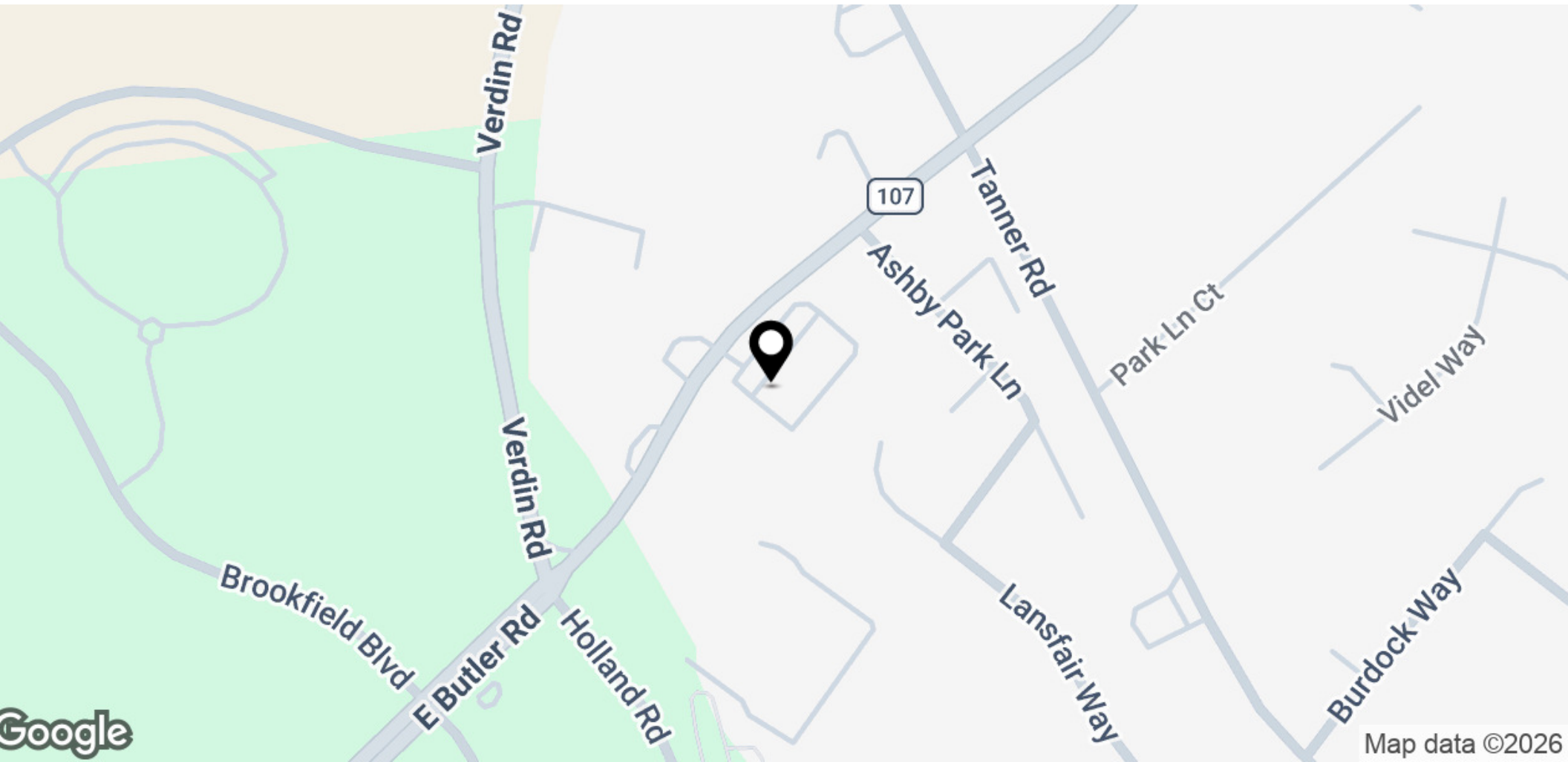

Bryon Culbertson
Broker
864.233.7724
bculbertson@joynercommercial.com

Berkshire Hathaway HomeServices
C. Dan Joyner, REALTORS
230 Buist Avenue
Greenville, SC 29609
864.233.7724
[View Website](#)

**BERKSHIRE
HATHAWAY**
HOMESERVICES

C. DAN JOYNER,
REALTORS®

1140 E Butler

1140 East Butler Road, Greenville, SC 29607

FOR LEASE

Additional Photos

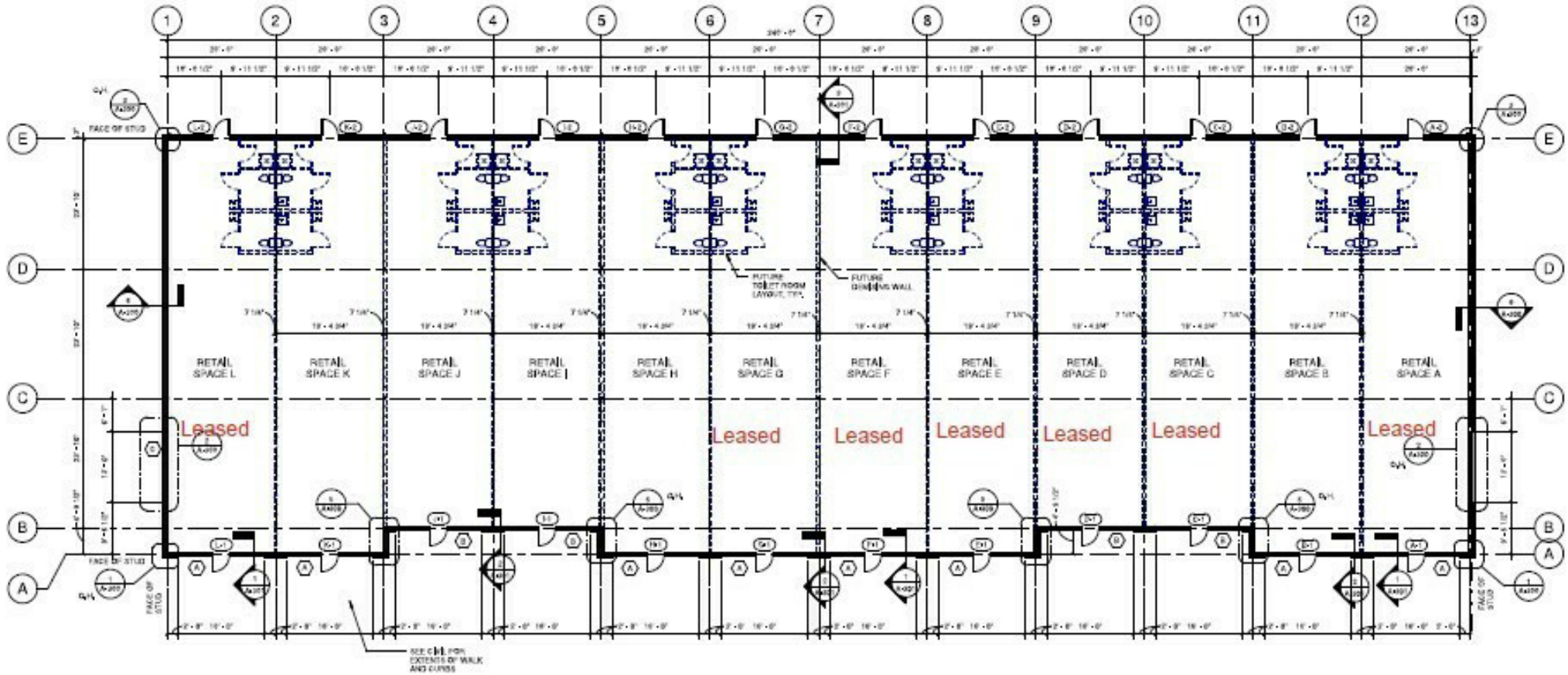

Bryon Culbertson
Broker
864 233 7724
bculbertson@joynercommercial.com

Berkshire Hathaway HomeServices
C. Dan Joyner, REALTORS
230 Buist Avenue
Greenville, SC 29609
864.233.7724
[View Website](#)

**BERKSHIRE
HATHAWAY**
HOMESERVICES

C. DAN JOYNER,
REALTORS®

1140 E Butler

1140 East Butler Road, Greenville, SC 29607

FOR LEASE

Available Suites

Lease Information

Lease Type:	NNN	Lease Term:	Negotiable
Total Space:	1,440 - 1,537 SF	Lease Rate:	\$30 SF/yr

Available Spaces

Suite	Tenant	Size (SF)	Lease Type	Lease Rate	Description
1140 E Butler	Available	1,537 SF	NNN	\$30.00 SF/yr	-
1140 E Butler	Available	1,536 SF	NNN	\$30.00 SF/yr	-
1140 E Butler	Available	1,440 SF	NNN	\$30.00 SF/yr	-
1140 E Butler	Available	1,440 SF	NNN	\$30.00 SF/yr	-
1140 E Butler	Available	1,537 SF	NNN	\$30.00 SF/yr	-

Bryon Culbertson
Broker
864.233.7724
bculbertson@joynercommercial.com

Berkshire Hathaway HomeServices
C. Dan Joyner, REALTORS
230 Buist Avenue
Greenville, SC 29609
864.233.7724
[View Website](#)

**BERKSHIRE
HATHAWAY**
HOMESERVICES

**C. DAN JOYNER,
REALTORS®**

1140 E Butler

1140 East Butler Road, Greenville, SC 29607

FOR LEASE

Aerial Map

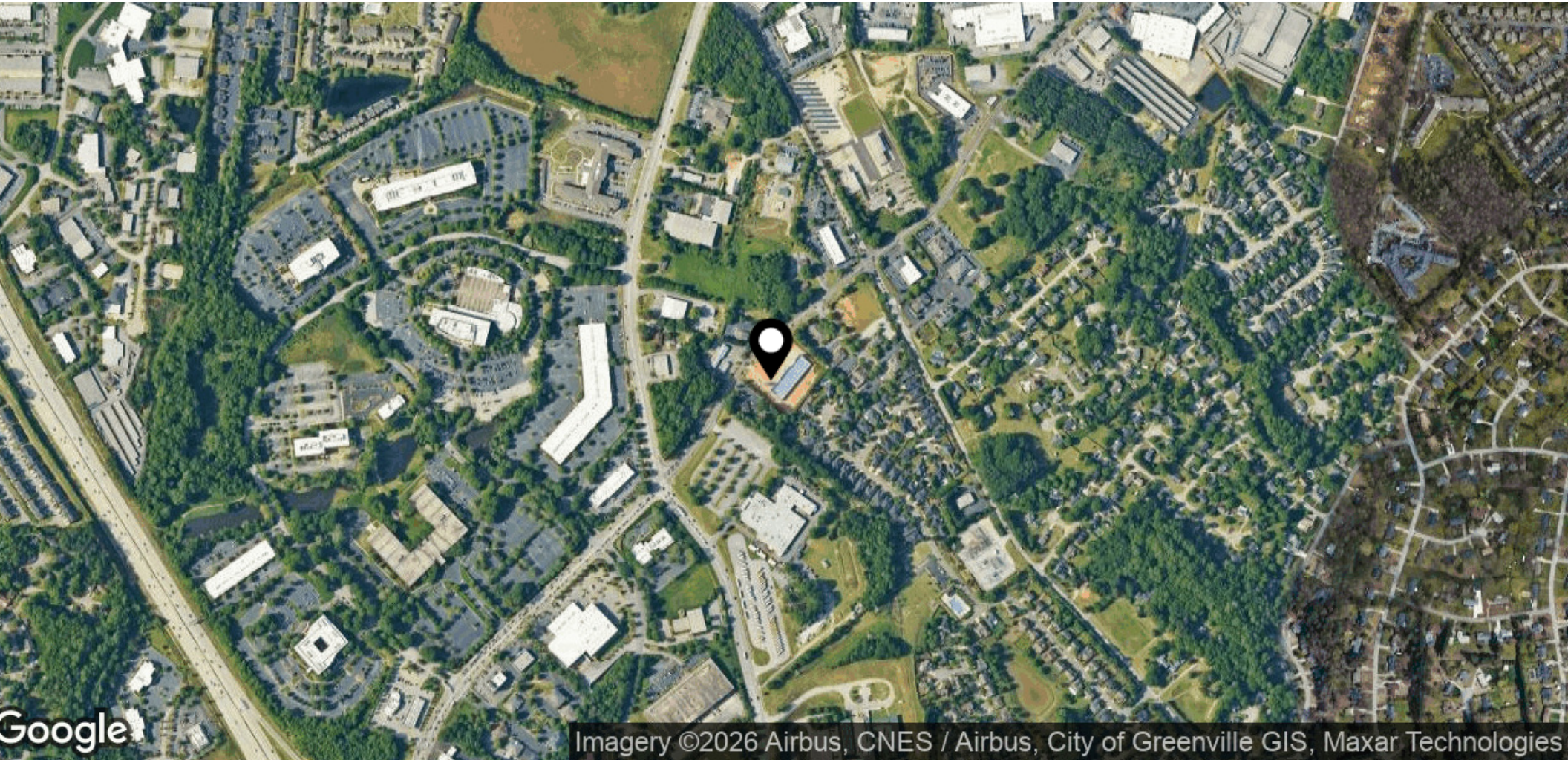

Imagery ©2026 Airbus, CNES / Airbus, City of Greenville GIS, Maxar Technologies

Bryon Culbertson
Broker
864 233 7724
bculbertson@joynercommercial.com

Berkshire Hathaway HomeServices
C. Dan Joyner, REALTORS
230 Buiist Avenue
Greenville, SC 29609
864.233.7724
[View Website](#)

**BERKSHIRE
HATHAWAY**
HOMESERVICES

C. DAN JOYNER,
REALTORS®