



**335,905 SF SITE AVAILABLE FOR LEASE**

**58,225 SF BUILDING ON ±7.7 ACRES**

**PREMIER TRANSLOAD WAREHOUSE DISTRIBUTION FACILITY**

14434 - 14527 San Pedro Street, Unincorporated Los Angeles County





### **WAREHOUSE DISTRIBUTION FACILITY**

- Building Size: 58,225 SF Cross Dock Configuration
- Land Size: ±7.7 Acres (335,905 SF)
- 2,715 SF Office
- 21 Dock High Positions (4 with Pit Levelers)
- 3 Grade Level Doors (1 Ramped)
- 28' Minimum Warehouse Clearance
- ESFR K-25 Fire Sprinkler System
- LED Lighting
- 3000 Amps, 277/480V
- Concrete Parking and Loading Areas at 14527
- Complete Redevelopment
- Two Secured Fenced Yards
- Designed to Achieve LEED Gold Certification
- Premier Location Central to All of Los Angeles, Ports of Los Angeles and Long Beach, and LAX
- 659 Million Square Feet of Industrial Product Within 20 Miles (Per CBRE Research Dept.)
- 2.6 Million Households Within 20 Miles



San Pedro St



**BUILDING**  
58,225 SF

**LAND**  
335,905 SF

**PARCEL 1**  
231,918 SF

**PARCEL 2**  
103,987 SF

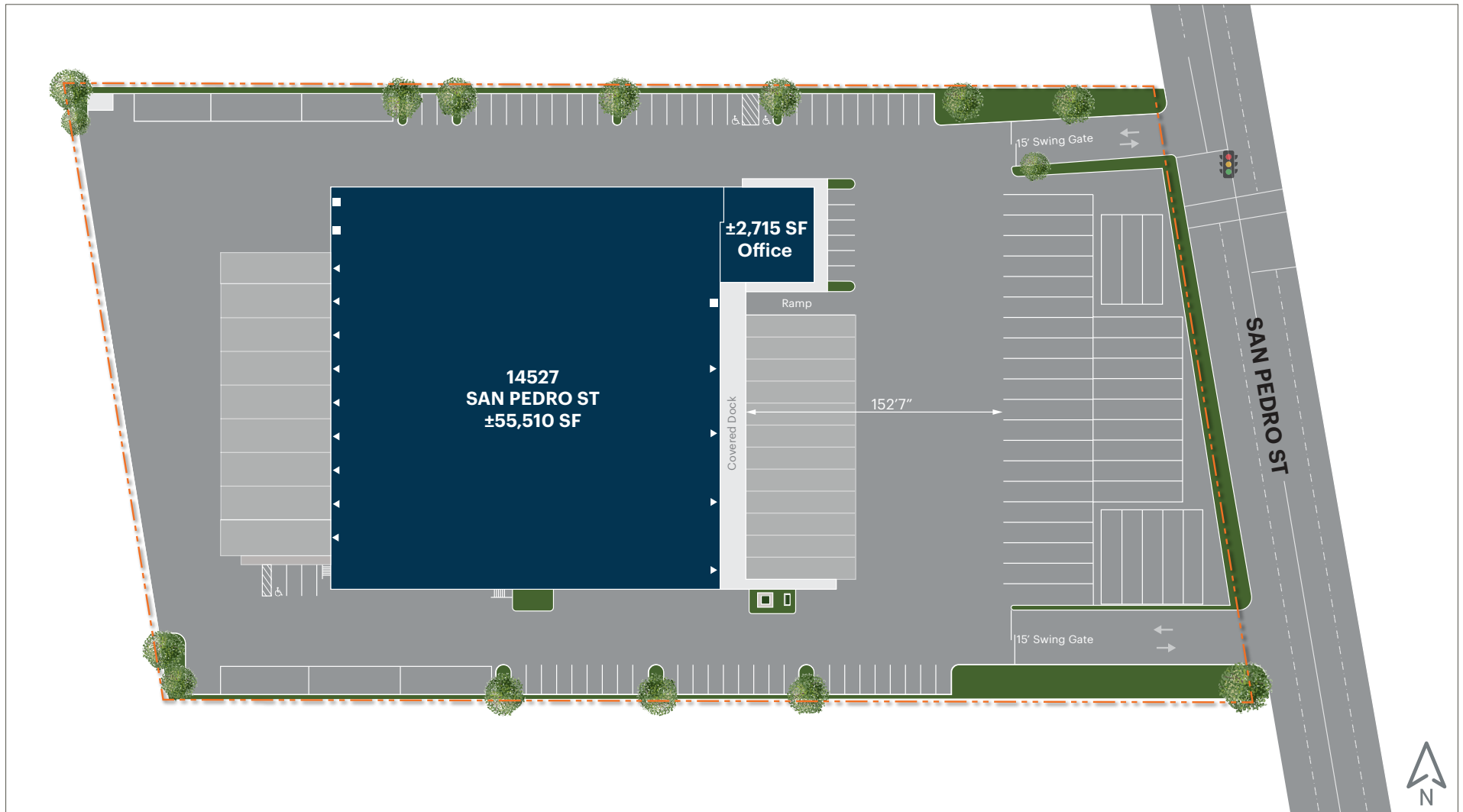

**WAREHOUSE**  
58,225 SF

**LAND**  
231,918 SF

▲ Dock High  
■ Ground Level

PLAN LAYOUT SUBJECT TO FIELD CONDITIONS AND MAY DIFFER FROM PLAN AS SHOWN. ALL INFORMATION PRESENTED ON THIS DRAWING IS PRESUMED TO BE ACCURATE, HOWEVER TENANT SHOULD VERIFY PERTINENT INFORMATION PRIOR TO COMMITTING TO A LEASE. ANY FURNITURE OR APPLIANCES SHOWN ON PLAN ARE FOR CONCEPT ONLY AND WILL BE TENANT PROVIDED.



**LAND**  
103,987 SF

**PARKING**  
272 Stalls

PLAN LAYOUT SUBJECT TO FIELD CONDITIONS AND MAY DIFFER FROM PLAN AS SHOWN. ALL INFORMATION PRESENTED ON THIS DRAWING IS PRESUMED TO BE ACCURATE, HOWEVER TENANT SHOULD VERIFY PERTINENT INFORMATION PRIOR TO COMMITTING TO A LEASE. ANY FURNITURE OR APPLIANCES SHOWN ON PLAN ARE FOR CONCEPT ONLY AND WILL BE TENANT PROVIDED.

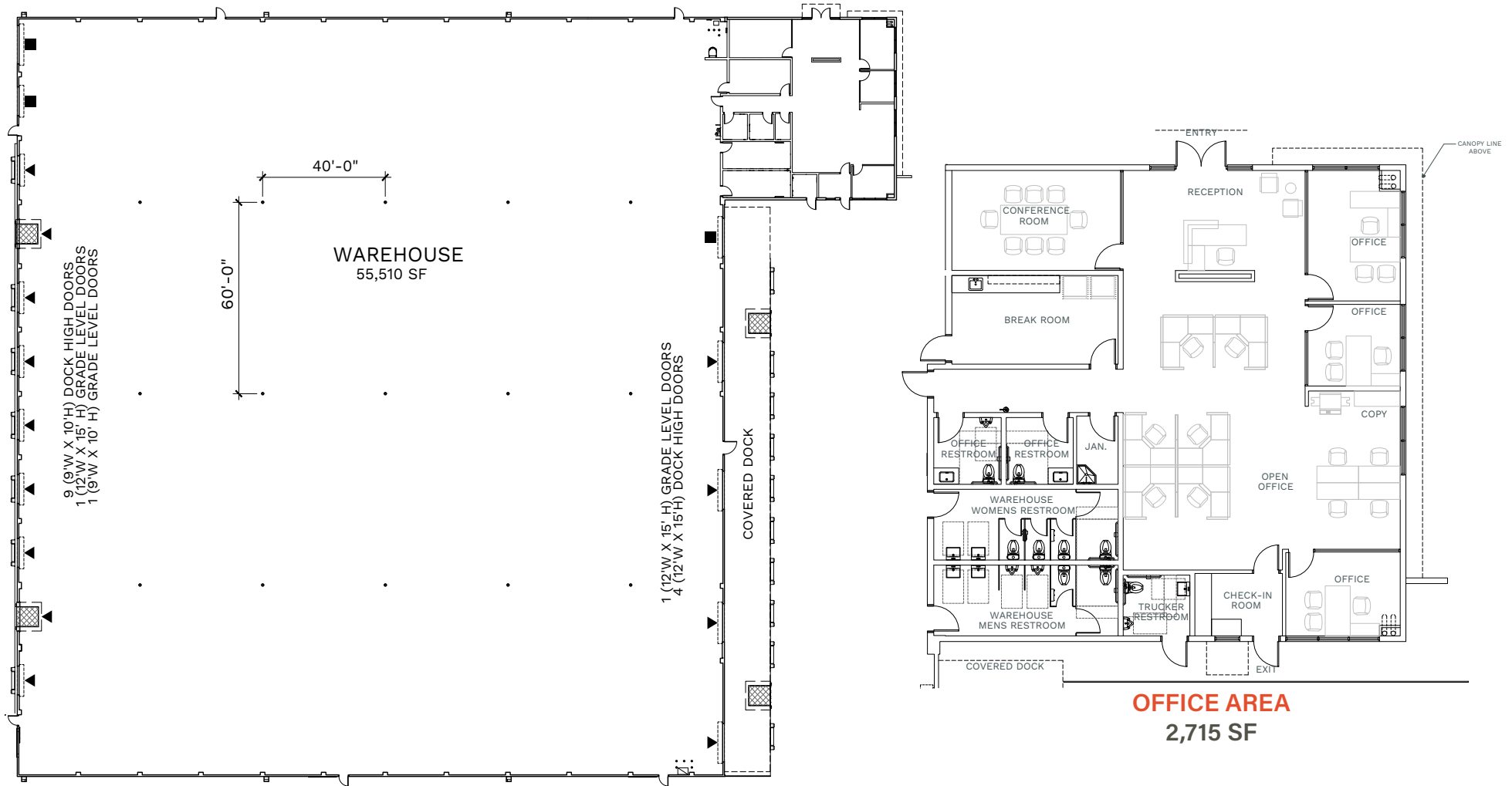

**WAREHOUSE**  
55,510 SF

**OFFICE**  
2,715 SF

**TOTAL**  
58,225 SF

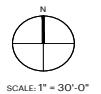

PLAN LAYOUT SUBJECT TO FIELD CONDITIONS AND MAY DIFFER FROM PLAN AS SHOWN. ALL INFORMATION PRESENTED ON THIS DRAWING IS PRESUMED TO BE ACCURATE, HOWEVER TENANT SHOULD VERIFY PERTINENT INFORMATION PRIOR TO COMMITTING TO A LEASE. ANY FURNITURE OR APPLIANCES SHOWN ON PLAN ARE FOR CONCEPT ONLY AND WILL BE TENANT PROVIDED.

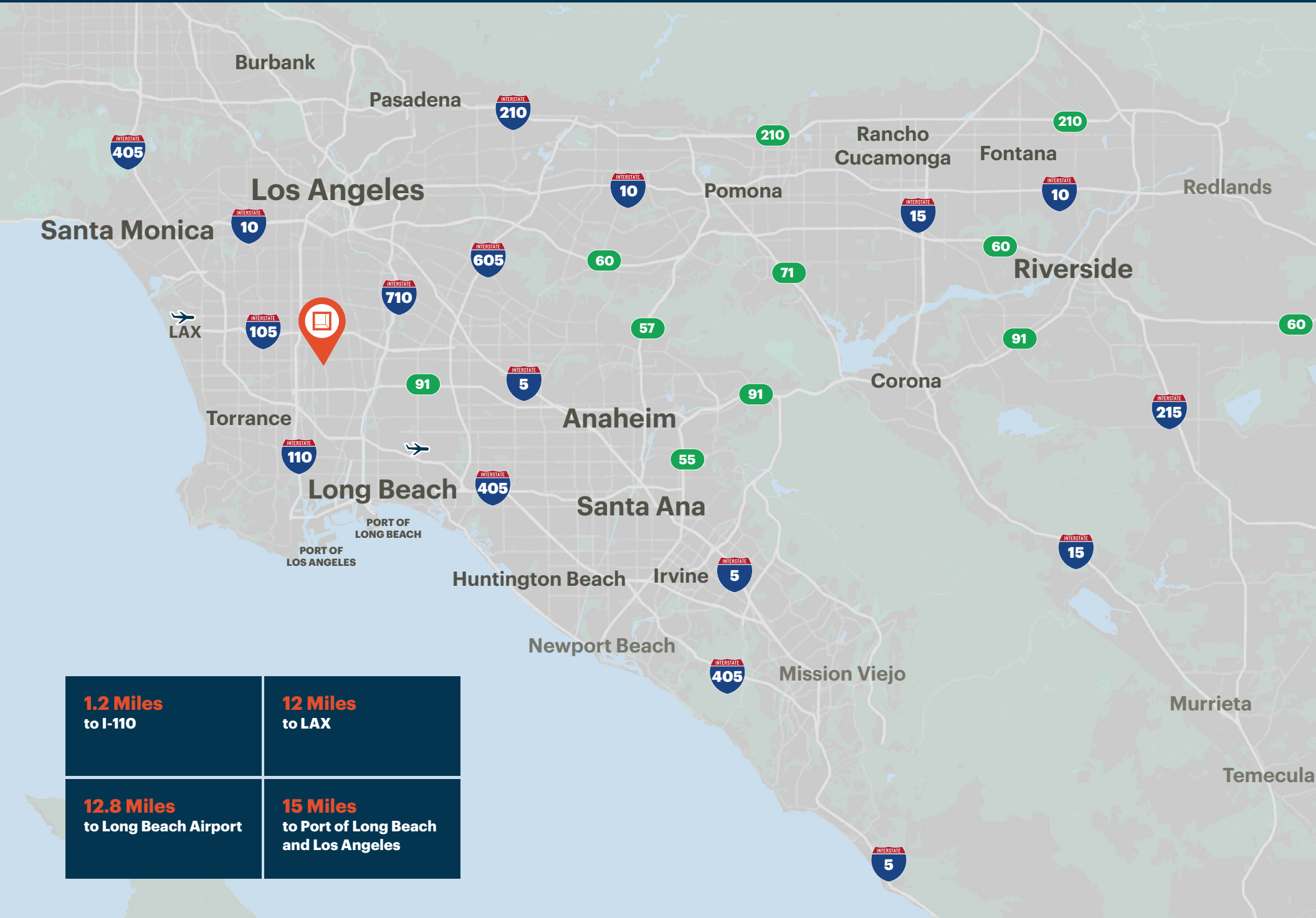

<b>1.2 Miles</b> to I-110	<b>12 Miles</b> to LAX
<b>12.8 Miles</b> to Long Beach Airport	<b>15 Miles</b> to Port of Long Beach and Los Angeles



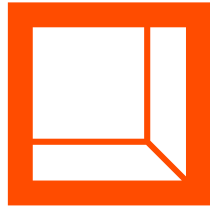

**Rexford  
Industrial**

## Leasing Contacts

**GREG DYER**  
Executive Vice President  
310.363.4953  
greg.dyer@cbre.com  
LIC # 01199659

**TRES REID**  
Vice Chairman  
310.363.4948  
tres.reid@cbre.com  
LIC # 00975748

**JOSHUA GERSON**  
Executive Vice President  
818.439.1157  
jgerson@spectrumcre.com  
LIC # 01214941

**CBRE**

**SPECTRUM**  
COMMERCIAL REAL ESTATE, INC.

### **CBRE**

2221 Rosecrans Avenue, Suite 100  
El Segundo, CA 90245

310.363.4900  
www.cbre.com

© 2024 CBRE, Inc. All rights reserved. This information has been obtained from sources believed reliable but has not been verified for accuracy or completeness. CBRE, Inc. makes no guarantee, representation or warranty and accepts no responsibility or liability as to the accuracy, completeness, or reliability of the information contained herein. You should conduct a careful, independent investigation of the property and verify all information. Any reliance on this information is solely at your own risk. CBRE and the CBRE logo are service marks of CBRE, Inc. All other marks displayed on this document are the property of their respective owners, and the use of such marks does not imply any affiliation with or endorsement of CBRE. Photos herein are the property of their respective owners. Use of these images without the express written consent of the owner is prohibited.