



FOR LEASE

# Rainier Corporate Park East

2400 70TH AVE E, FIFE, WA



## Class A Warehouse Available February 1, 2024

**BUILDING B** suite B119

**33,660 SF** warehouse, 491 SF office

**24'** concrete tilt-up construction

**14 DOCK**-high doors

**2 GRADE**-level doors

**3** phase power

**EXCELLENT ACCESS TO**  
I-5/Fife-Milton 1.1 miles  
Port of Tacoma 1 mile  
SR 167/SR 512 3 miles

**NO LOCAL** B&O Tax

**TY CLARKE**

253.722.1419

[ty.clarke@kidder.com](mailto:ty.clarke@kidder.com)

**TODD CLARKE**

253.722.1422

[todd.clarke@kidder.com](mailto:todd.clarke@kidder.com)

**HUNTER CLARKE**

253.722.1454

[hunter.clarke@kidder.com](mailto:hunter.clarke@kidder.com)

**KIDDER.COM**

This information supplied herein is from sources we deem reliable. It is provided without any representation, warranty, or guarantee, expressed or implied as to its accuracy. Prospective Buyer or Tenant should conduct an independent investigation and verification of all matters deemed to be material, including, but not limited to, statements of income and expenses. Consult your attorney, accountant, or other professional advisor.

**Kidder  
Mathews**

**FOR LEASE**

# Rainier Corporate Park East

2400 70TH AVE E, FIFE, WA

**B119**

**SUITE AVAILABLE**

**33,660**

**WAREHOUSE SQUARE FEET**

**491**

**OFFICE SQUARE FEET**

**AVAILABLE**

**FEBRUARY 1, 2024**

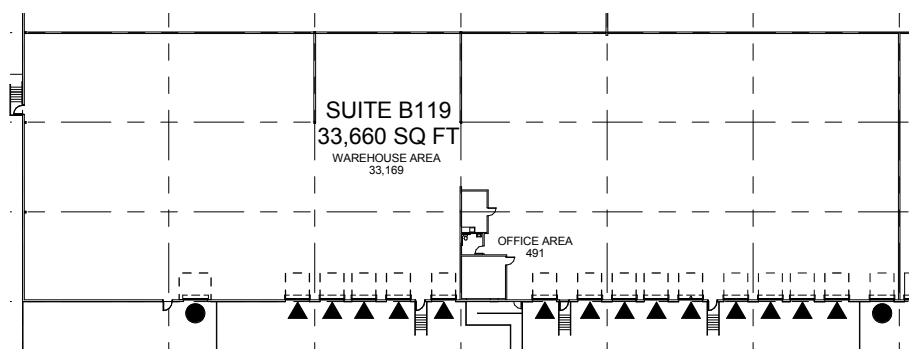
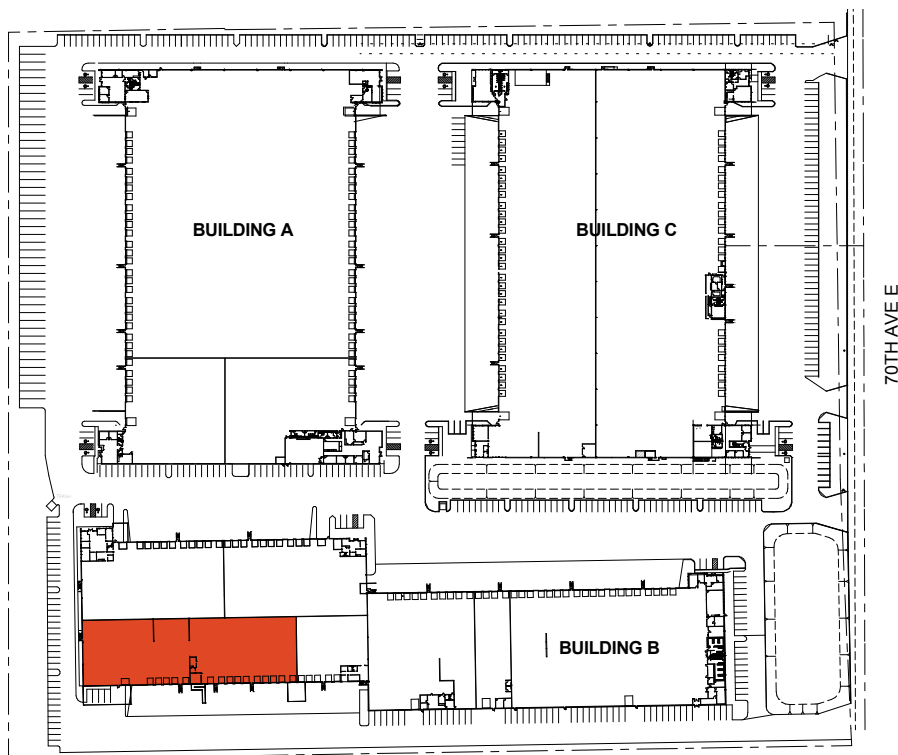

**TY CLARKE**

253.722.1419

ty.clarke@kidder.com

**TODD CLARKE**

253.722.1422

todd.clarke@kidder.com

**HUNTER CLARKE**

253.722.1454

hunter.clarke@kidder.com

**KIDDER.COM**



This information supplied herein is from sources we deem reliable. It is provided without any representation, warranty, or guarantee, expressed or implied as to its accuracy. Prospective Buyer or Tenant should conduct an independent investigation and verification of all matters deemed to be material, including, but not limited to, statements of income and expenses. Consult your attorney, accountant, or other professional advisor.