

19276 EUREKA ROAD  
SOUTHGATE, MICHIGAN



**SIGNATURE  
ASSOCIATES**  
KNOW SIGNATURE | KNOW RESULTS

LAND FOR SALE  
0.93 Acres Available



## PROPERTY FEATURES

- 0.93 acres available
- Assemblage up to 2.12 acres
- Almost 1 acre of land for sale on Eureka Road near I-75, Menards, Southfield Mall and many other national retailers
- Ideal for drive-thru, fast food, and coffee concepts
- Zoned C-2
- Sale price: \$350,000 (\$376,344.09/acre)



For more information, please contact:

**JUSTIN GAFFREY**

(248) 799 3143

[jgaffrey@signatureassociates.com](mailto:jgaffrey@signatureassociates.com)

**SIGNATURE ASSOCIATES**  
One Towne Square, Suite 1200  
Southfield, MI 48076  
[www.signatureassociates.com](http://www.signatureassociates.com)

# 19276 Eureka Road – Southgate, Michigan

Land For Sale

0.93  
Acres  
AVAILABLE

## Site Plan

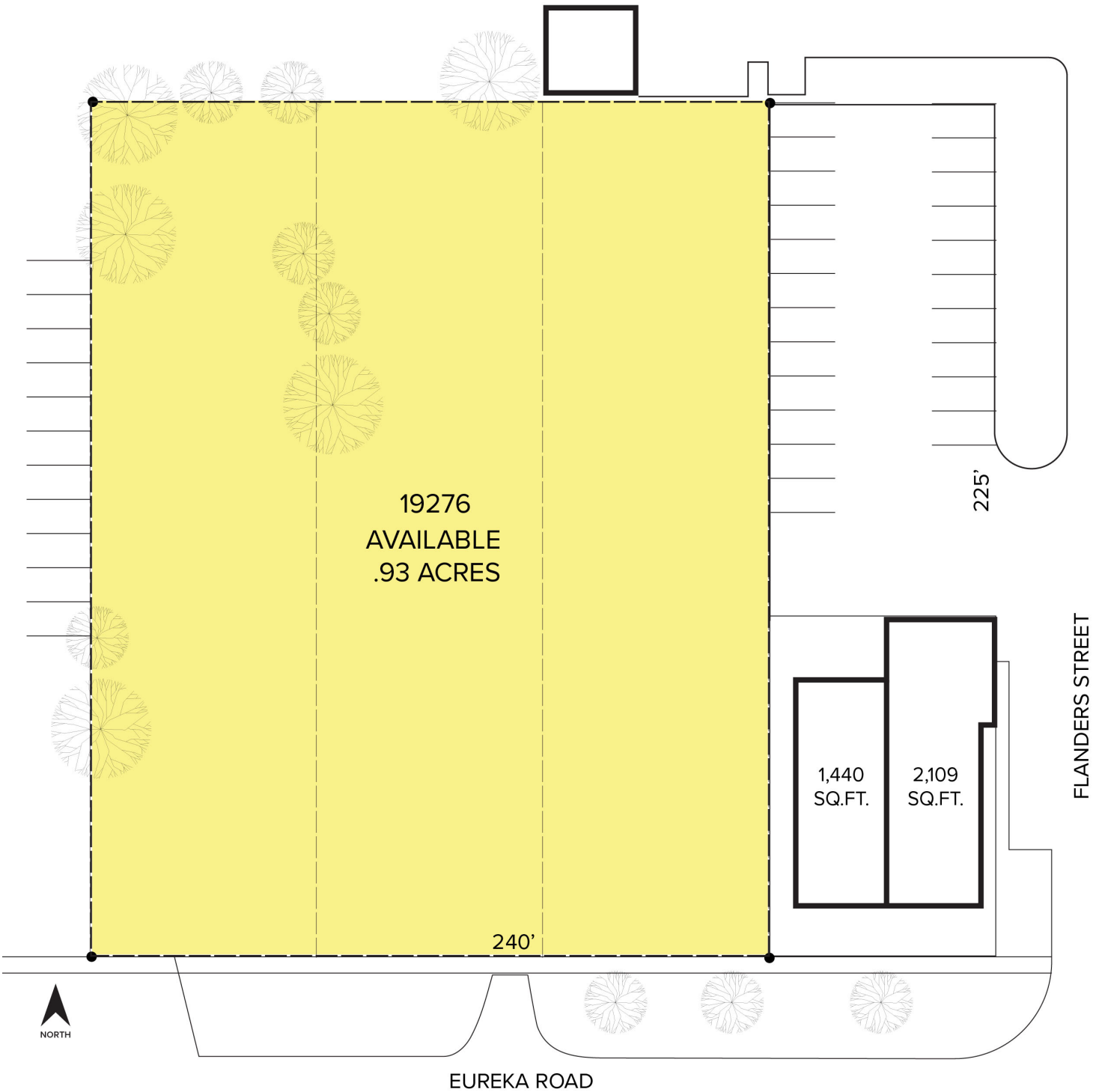

For more information, please contact:  
**JUSTIN GAFFREY**  
(248) 799 3143  
jgaffrey@signatureassociates.com

**SIGNATURE ASSOCIATES**  
One Towne Square, Suite 1200  
Southfield, MI 48076  
www.signatureassociates.com

Information is subject to verification and no liability for errors or omissions is assumed. Price is subject to change and listing withdrawal.

# 19276 Eureka Road – Southgate, Michigan

## Land For Sale

0.93  
Acres  
AVAILABLE

DEMOGRAPHICS		
	POPULATION	MED. HH INCOME
1 MILE	6,308	\$71,402
3 MILE	81,719	\$69,875
5 MILE	220,796	\$70,443

TRAFFIC COUNTS (TWO-WAY)	
32,562	Eureka Rd. E of Allen Rd.
23,765	Eureka Rd. W of Allen Rd.
22,003	Allen Rd. N of Eureka Rd.
19,692	Allen Rd. S of Eureka Rd.



For more information, please contact:  
**JUSTIN GAFFREY**  
 (248) 799 3143  
 jgaffrey@signatureassociates.com

**SIGNATURE ASSOCIATES**  
 One Towne Square, Suite 1200  
 Southfield, MI 48076  
 www.signatureassociates.com