

EAST VILLAGE DOWNTOWN SAN DIEGO

# FORM 15

1450 MARKET ST, SAN DIEGO, CA 92101

**For Lease**

± 2,000 SF + Patio | Former Distillery  
± 1,1162 SF | Retail Suite



**SPIRE**

William Clemeno | Advisor  
858.717.0172 | CA DRE #02060538  
william.clemeno@spireassets.com

Frank Clark, Principal Broker  
619.994.7136 | CA DRE #01919345  
frank.clark@spireassets.com

# PROPERTY HIGHLIGHT



- **Prime East Village Retail Location**, situated on the ground floor of a 241-unit residential project constructed in 2014
- **Expansive glass-lined suite** allowing for abundant natural lighting.
- Available space includes a **highly visible retail opportunity** with 18-foot ceilings
- **Positioned in the heart of** numerous completed, underway and planned East Village development projects

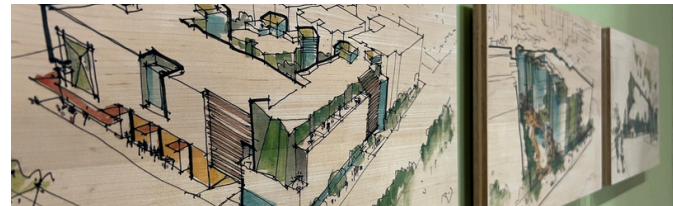

## EAST VILLAGE GREEN



**4.1 Acre Public Amenity Site**–  
Directly Across the Street from  
FORM 15

This urban park will include cafés, plazas, multi-functional lawns, a children's park, unique off-leash dog areas, a community center, pavilions, and below-grade parking creating an environment that will transform this neighborhood.



# AVAILABILITY

For Lease:

1495 G St.  
Approx. 2,000 SF + Patio  
Retail/Restaurant/Bar/Distillery

- Ground floor retail suite cornering G St and 15th Ave
- Second Gen Distillery comprising an open area, bar space, a restroom, and a back kitchen with infrastructure such as a large water heater, wash sinks, grease trap, and ample power supply.
- Street visible signage
- Directly adjacent to East Village Green
- Liquor License available for sale



CONTACT BROKER FOR MORE INFORMATION



# AVAILABILITY

For Lease:

1450 Market St Suite A2

Approx. 1,162 SF

Retail Suite

- Ground floor retail suite
- Shell condition creating a black canvas for a new tenant to design their space.
- Expansive window line and tall ceilings
- Tenant improvement allowance available

CONTACT BROKER FOR  
MORE INFORMATION



EAST VILLAGE DOWNTOWN SAN DIEGO

# FORM 15

1450 MARKET ST, SAN DIEGO, CA 92101



## CONTACT INFORMATION

**William Clemeno | Advisor**

858.717.0172 | CA DRE #02060538

[william.clemeno@spireassets.com](mailto:william.clemeno@spireassets.com)

**Frank Clark | Principal Broker**

619.994.7136 | CA DRE #01919345

[frank.clark@spireassets.com](mailto:frank.clark@spireassets.com)

The information presented here is deemed to be accurate, but it has not been independently verified. We make no guarantee, warranty, or representation. It is your own responsibility to independently confirm accuracy and completeness. All SPIRE businesses are independently owned and operated. It is your own responsibility to independently confirm accuracy and completeness. All SPIRE businesses are independently owned and operated.

**SPIRE**  
[www.spireassets.com](http://www.spireassets.com)