



SOUTHTREE  
COMMERCIAL

REAL ESTATE

# FOR LEASE

2201 NEWNAN CROSSING BLVD, NEWNAN, GA 30265

## NEWNAN PROFESSIONAL CENTER (NPC) III



## Property Details

- 40K SF Medical Office Building
- Lead Tenant is OrthoAtlanta
- 1,991 – 4,165 RSF Available
- 1st Gen Space In Shell Condition
- Across from Piedmont Newnan Hospital
- Lease Rate: Please Inquire

THIS INFORMATION HAS BEEN SECURED FROM SOURCES WE DEEM RELIABLE, BUT WE MAKE NO REPRESENTATIONS OR WARRANTIES, EXPRESSED OR IMPLIED AS TO THE ACCURACY OF THE INFORMATION.

**BARRY GARNER**  
VICE PRESIDENT  
770-294-4027  
BGARNER@STCOM.US

**SEAN RAWSON**  
VICE PRESIDENT  
678-920-1222  
SRAWSON@STCOM.US



STCOM.US



770-631-0499



201 PROSPECT PARK, SUITE A,  
PEACHTREE CITY, GA 30269



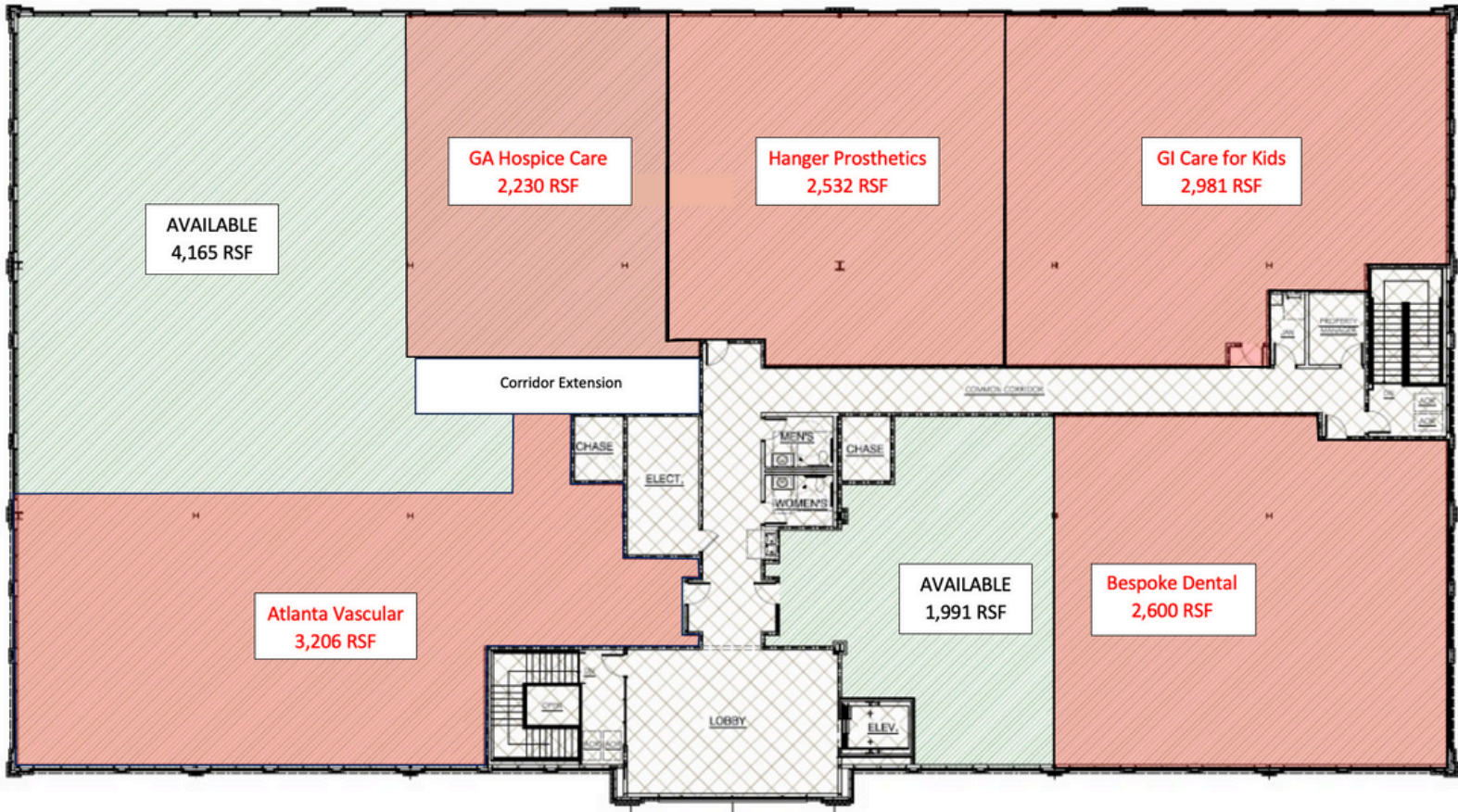

Southtree Commercial has developed seven other medical office buildings in this area totaling over 150,000 +/- square feet with tenants that include:

**NPC I** – Piedmont Internal Medicine, Piedmont Wound Care and Hyperbaric Center, Pain Care

**NPC II** – Resurgens Orthopaedics, DaVita Poplar Dialysis, Piedmont OB/GYN, Piedmont Pulmonary and Sleep Medicine, Caduceus USA

**NPC III**– Piedmont Orthopaedics | OrthoAtlanta Newnan

**NCBPC** – Summit Urgent Care, Advanced Aesthetics, Burson ENT, Heindel ENT, Hazelton Pharmacy

Stillwood Corners – Hopebridge Autism Therapy Center, Dream Pediatric Dentistry & Orthodontics





## Area Information

- Site is located across the street from the Piedmont Newnan Hospital (PNH) campus on Poplar Road in Coweta County. PNH is a 136-bed hospital on 105 acres.
- Encompass Health Rehabilitation Hospital of Newnan opened in Late 2014. This 50-bed inpatient rehabilitation hospital is adjacent to the site.
- Cancer Treatment Centers of America (CTCA) has a 50-bed hospital on approximately 100 acres located 2 miles from the site.