

FOR LEASE

6,390 SF AVAILABLE



10735 METRIC DR | DALLAS, TX 75243

LISTING HIGHLIGHTS

BUILDING SF	33,900 SF
AVAILABLE SF	6,390 SF
OFFICE SF	242 SF
YEAR BUILT	1979
CLEAR HEIGHT	15' - 16'
LOADING	2 Dock high doors
COMMENTS	<ul style="list-style-type: none">• Available 5/1/2023• Front load• New exterior paint• New recessed floodlights• New LED lights• New vinyl flooring tiles• New fenced outside storage area

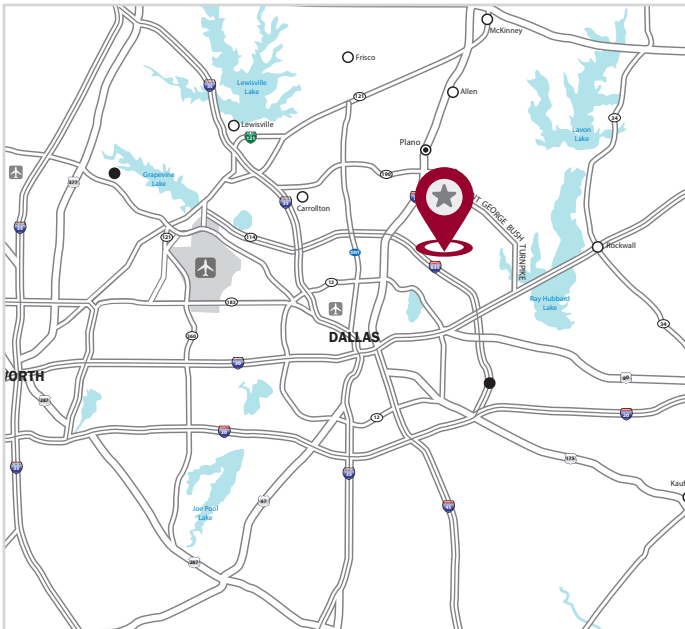

FOR LEASING INFORMATION:

Taylor Stell

tstell@lee-associates.com
214.558.1969

Brett Lewis, CCIM

blewis@lee-associates.com
972.934.4018

LEASED BY:

LEE & ASSOCIATES
COMMERCIAL REAL ESTATE SERVICES

6,390 SF

FOR LEASE

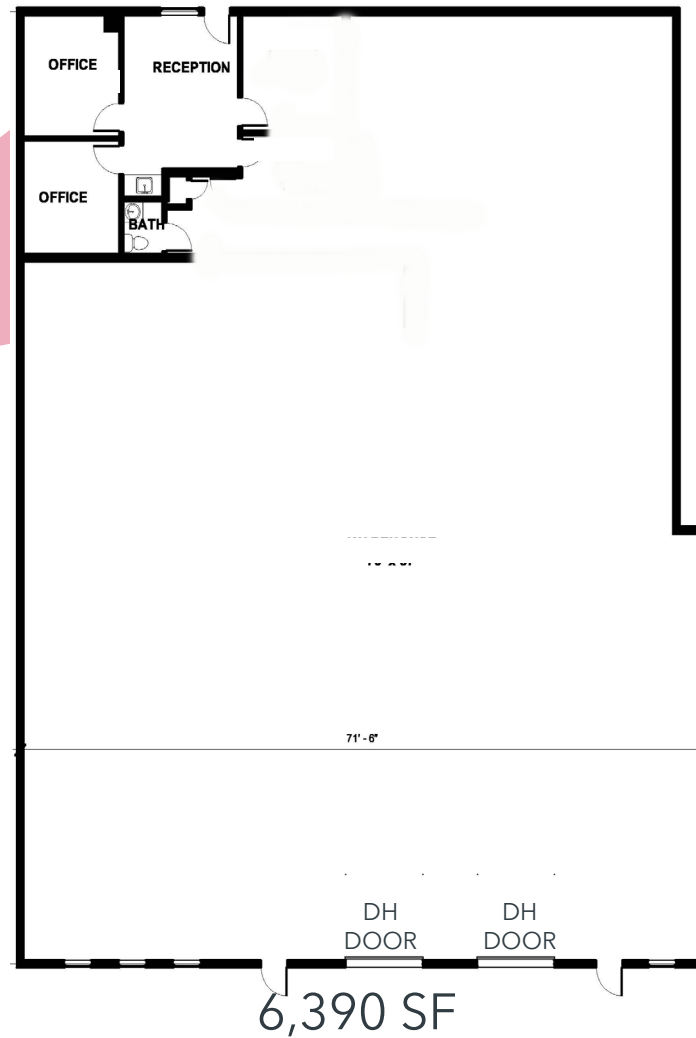
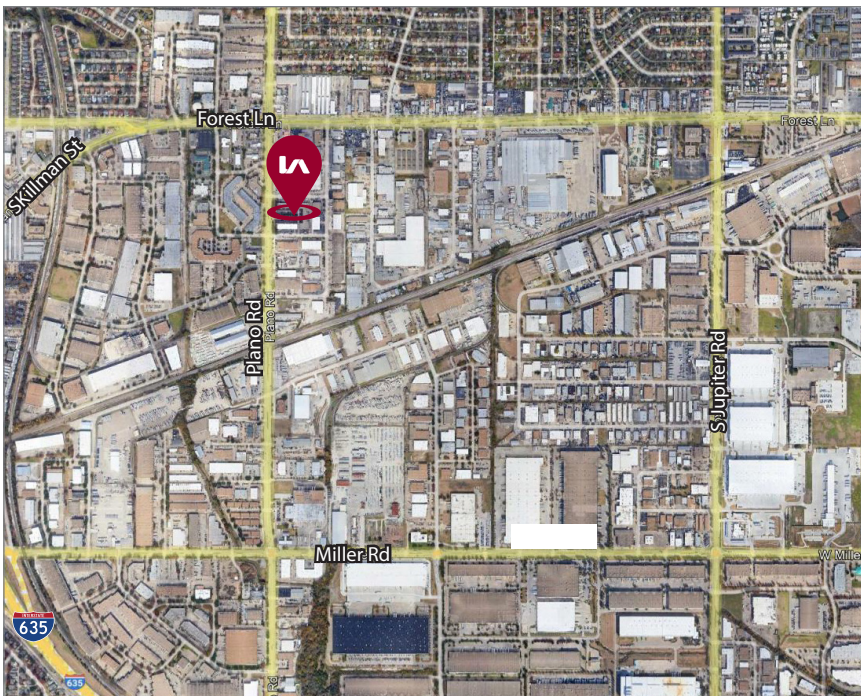
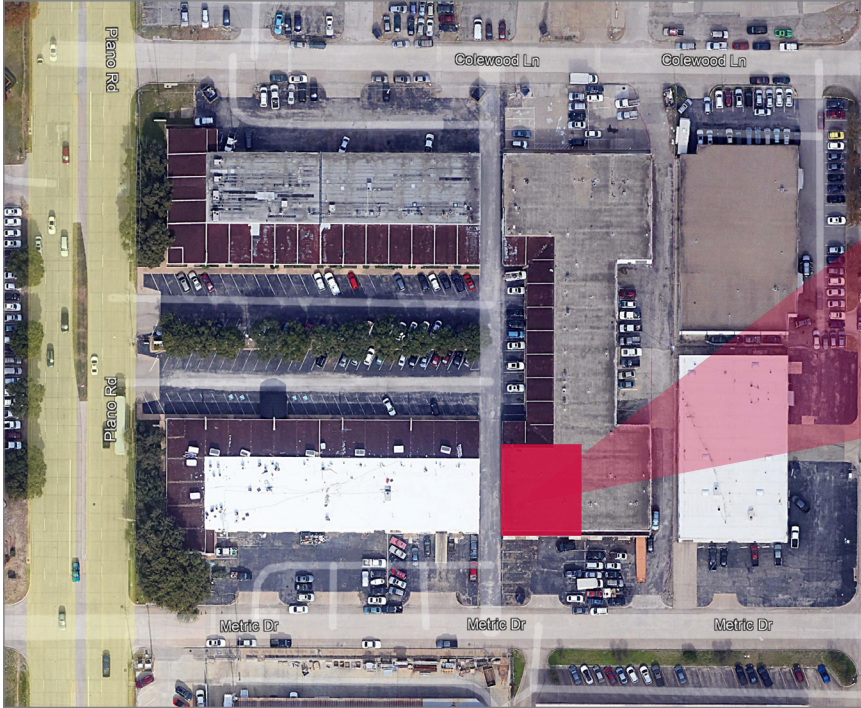

All information furnished regarding property for sale, rental or financing is from sources deemed reliable, but no warranty or representation is made to the accuracy thereof and same is submitted to errors, omissions, change of price, rental or other conditions prior to sale, lease or financing or withdrawal without notice. No liability of any kind is to be

FOR LEASING INFORMATION:

Taylor Stell
tstell@lee-associates.com
214.558.1969

Brett Lewis, CCIM
blewis@lee-associates.com
972.934.4018

LEASED BY:

LEE & ASSOCIATES
COMMERCIAL REAL ESTATE SERVICES