

GENERAL EROSION CONTROL NOTES

1. EROSION CONTROL MEASURES SHALL BE INSTALLED AND MAINTAINED THROUGHOUT THE CONSTRUCTION PERIOD TO PREVENT EROSION, SILTATION, AND POLLUTION OF ADJACENT AREAS AND WATERWAYS.
2. EROSION CONTROL MEASURES SHALL BE INSTALLED AND MAINTAINED THROUGHOUT THE CONSTRUCTION PERIOD TO PREVENT EROSION, SILTATION, AND POLLUTION OF ADJACENT AREAS AND WATERWAYS.
3. EROSION CONTROL MEASURES SHALL BE INSTALLED AND MAINTAINED THROUGHOUT THE CONSTRUCTION PERIOD TO PREVENT EROSION, SILTATION, AND POLLUTION OF ADJACENT AREAS AND WATERWAYS.
4. EROSION CONTROL MEASURES SHALL BE INSTALLED AND MAINTAINED THROUGHOUT THE CONSTRUCTION PERIOD TO PREVENT EROSION, SILTATION, AND POLLUTION OF ADJACENT AREAS AND WATERWAYS.
5. EROSION CONTROL MEASURES SHALL BE INSTALLED AND MAINTAINED THROUGHOUT THE CONSTRUCTION PERIOD TO PREVENT EROSION, SILTATION, AND POLLUTION OF ADJACENT AREAS AND WATERWAYS.
6. EROSION CONTROL MEASURES SHALL BE INSTALLED AND MAINTAINED THROUGHOUT THE CONSTRUCTION PERIOD TO PREVENT EROSION, SILTATION, AND POLLUTION OF ADJACENT AREAS AND WATERWAYS.
7. EROSION CONTROL MEASURES SHALL BE INSTALLED AND MAINTAINED THROUGHOUT THE CONSTRUCTION PERIOD TO PREVENT EROSION, SILTATION, AND POLLUTION OF ADJACENT AREAS AND WATERWAYS.
8. EROSION CONTROL MEASURES SHALL BE INSTALLED AND MAINTAINED THROUGHOUT THE CONSTRUCTION PERIOD TO PREVENT EROSION, SILTATION, AND POLLUTION OF ADJACENT AREAS AND WATERWAYS.
9. EROSION CONTROL MEASURES SHALL BE INSTALLED AND MAINTAINED THROUGHOUT THE CONSTRUCTION PERIOD TO PREVENT EROSION, SILTATION, AND POLLUTION OF ADJACENT AREAS AND WATERWAYS.
10. EROSION CONTROL MEASURES SHALL BE INSTALLED AND MAINTAINED THROUGHOUT THE CONSTRUCTION PERIOD TO PREVENT EROSION, SILTATION, AND POLLUTION OF ADJACENT AREAS AND WATERWAYS.
11. EROSION CONTROL MEASURES SHALL BE INSTALLED AND MAINTAINED THROUGHOUT THE CONSTRUCTION PERIOD TO PREVENT EROSION, SILTATION, AND POLLUTION OF ADJACENT AREAS AND WATERWAYS.
12. EROSION CONTROL MEASURES SHALL BE INSTALLED AND MAINTAINED THROUGHOUT THE CONSTRUCTION PERIOD TO PREVENT EROSION, SILTATION, AND POLLUTION OF ADJACENT AREAS AND WATERWAYS.
13. EROSION CONTROL MEASURES SHALL BE INSTALLED AND MAINTAINED THROUGHOUT THE CONSTRUCTION PERIOD TO PREVENT EROSION, SILTATION, AND POLLUTION OF ADJACENT AREAS AND WATERWAYS.
14. EROSION CONTROL MEASURES SHALL BE INSTALLED AND MAINTAINED THROUGHOUT THE CONSTRUCTION PERIOD TO PREVENT EROSION, SILTATION, AND POLLUTION OF ADJACENT AREAS AND WATERWAYS.
15. EROSION CONTROL MEASURES SHALL BE INSTALLED AND MAINTAINED THROUGHOUT THE CONSTRUCTION PERIOD TO PREVENT EROSION, SILTATION, AND POLLUTION OF ADJACENT AREAS AND WATERWAYS.

BMP MAINTENANCE

1. THE CONSTRUCTION SHALL MAINTAIN THE CONSTRUCTION EROSION CONTROL MEASURES IN A WORKING CONDITION THROUGHOUT THE CONSTRUCTION PERIOD.
2. THE CONSTRUCTION SHALL MAINTAIN THE CONSTRUCTION EROSION CONTROL MEASURES IN A WORKING CONDITION THROUGHOUT THE CONSTRUCTION PERIOD.
3. THE CONSTRUCTION SHALL MAINTAIN THE CONSTRUCTION EROSION CONTROL MEASURES IN A WORKING CONDITION THROUGHOUT THE CONSTRUCTION PERIOD.
4. THE CONSTRUCTION SHALL MAINTAIN THE CONSTRUCTION EROSION CONTROL MEASURES IN A WORKING CONDITION THROUGHOUT THE CONSTRUCTION PERIOD.
5. THE CONSTRUCTION SHALL MAINTAIN THE CONSTRUCTION EROSION CONTROL MEASURES IN A WORKING CONDITION THROUGHOUT THE CONSTRUCTION PERIOD.
6. THE CONSTRUCTION SHALL MAINTAIN THE CONSTRUCTION EROSION CONTROL MEASURES IN A WORKING CONDITION THROUGHOUT THE CONSTRUCTION PERIOD.
7. THE CONSTRUCTION SHALL MAINTAIN THE CONSTRUCTION EROSION CONTROL MEASURES IN A WORKING CONDITION THROUGHOUT THE CONSTRUCTION PERIOD.
8. THE CONSTRUCTION SHALL MAINTAIN THE CONSTRUCTION EROSION CONTROL MEASURES IN A WORKING CONDITION THROUGHOUT THE CONSTRUCTION PERIOD.
9. THE CONSTRUCTION SHALL MAINTAIN THE CONSTRUCTION EROSION CONTROL MEASURES IN A WORKING CONDITION THROUGHOUT THE CONSTRUCTION PERIOD.
10. THE CONSTRUCTION SHALL MAINTAIN THE CONSTRUCTION EROSION CONTROL MEASURES IN A WORKING CONDITION THROUGHOUT THE CONSTRUCTION PERIOD.
11. THE CONSTRUCTION SHALL MAINTAIN THE CONSTRUCTION EROSION CONTROL MEASURES IN A WORKING CONDITION THROUGHOUT THE CONSTRUCTION PERIOD.
12. THE CONSTRUCTION SHALL MAINTAIN THE CONSTRUCTION EROSION CONTROL MEASURES IN A WORKING CONDITION THROUGHOUT THE CONSTRUCTION PERIOD.
13. THE CONSTRUCTION SHALL MAINTAIN THE CONSTRUCTION EROSION CONTROL MEASURES IN A WORKING CONDITION THROUGHOUT THE CONSTRUCTION PERIOD.
14. THE CONSTRUCTION SHALL MAINTAIN THE CONSTRUCTION EROSION CONTROL MEASURES IN A WORKING CONDITION THROUGHOUT THE CONSTRUCTION PERIOD.
15. THE CONSTRUCTION SHALL MAINTAIN THE CONSTRUCTION EROSION CONTROL MEASURES IN A WORKING CONDITION THROUGHOUT THE CONSTRUCTION PERIOD.

SEQUENCE OF CONSTRUCTION

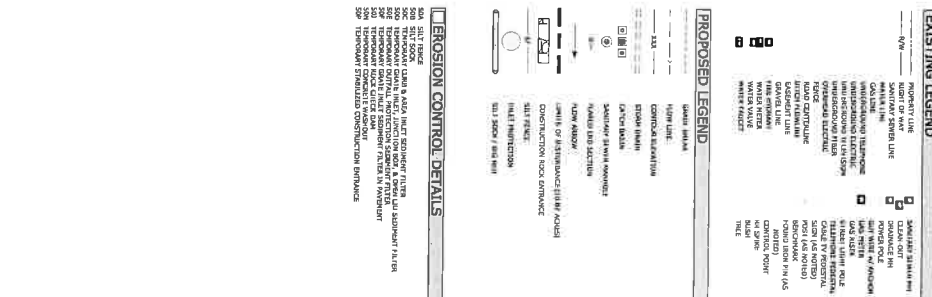

EXISTING LEGEND

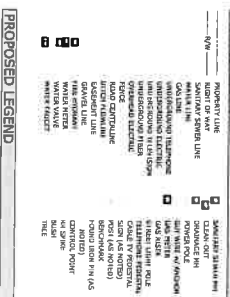

EROSION CONTROL DETAILS



<p>811 Call before you dig!</p>	<p>REVISIONS</p> <table border="1"> <thead> <tr> <th>REV</th> <th>DATE</th> <th>DESCRIPTION</th> </tr> </thead> <tbody> <tr> <td> </td> <td> </td> <td> </td> </tr> <tr> <td> </td> <td> </td> <td> </td> </tr> <tr> <td> </td> <td> </td> <td> </td> </tr> </tbody> </table>	REV	DATE	DESCRIPTION										<p>MARINE SALES AND SERVICE</p> <p>701 WEST HUDSON ROAD ROGERS, ARKANSAS</p>	<p>MCE McCLELLAND CONSULTING ENGINEERS, INC.</p> <p>1580 E STEARNS ST FAYETTEVILLE, ARKANSAS 72703 (479) 443-2377 HTTP://WWW.MCE.US.COM</p>
	REV	DATE	DESCRIPTION												
<p>EROSION CONTROL PH II PLAN - SHEET 1</p> <p>DATE: 21-2101 DRAWN BY: D. BROWN CHECKED BY: M. WOODS</p>	<p>C5.0</p>	<p>PROJECT NO. 21-2101</p>	<p>DATE: 21-2101</p>												

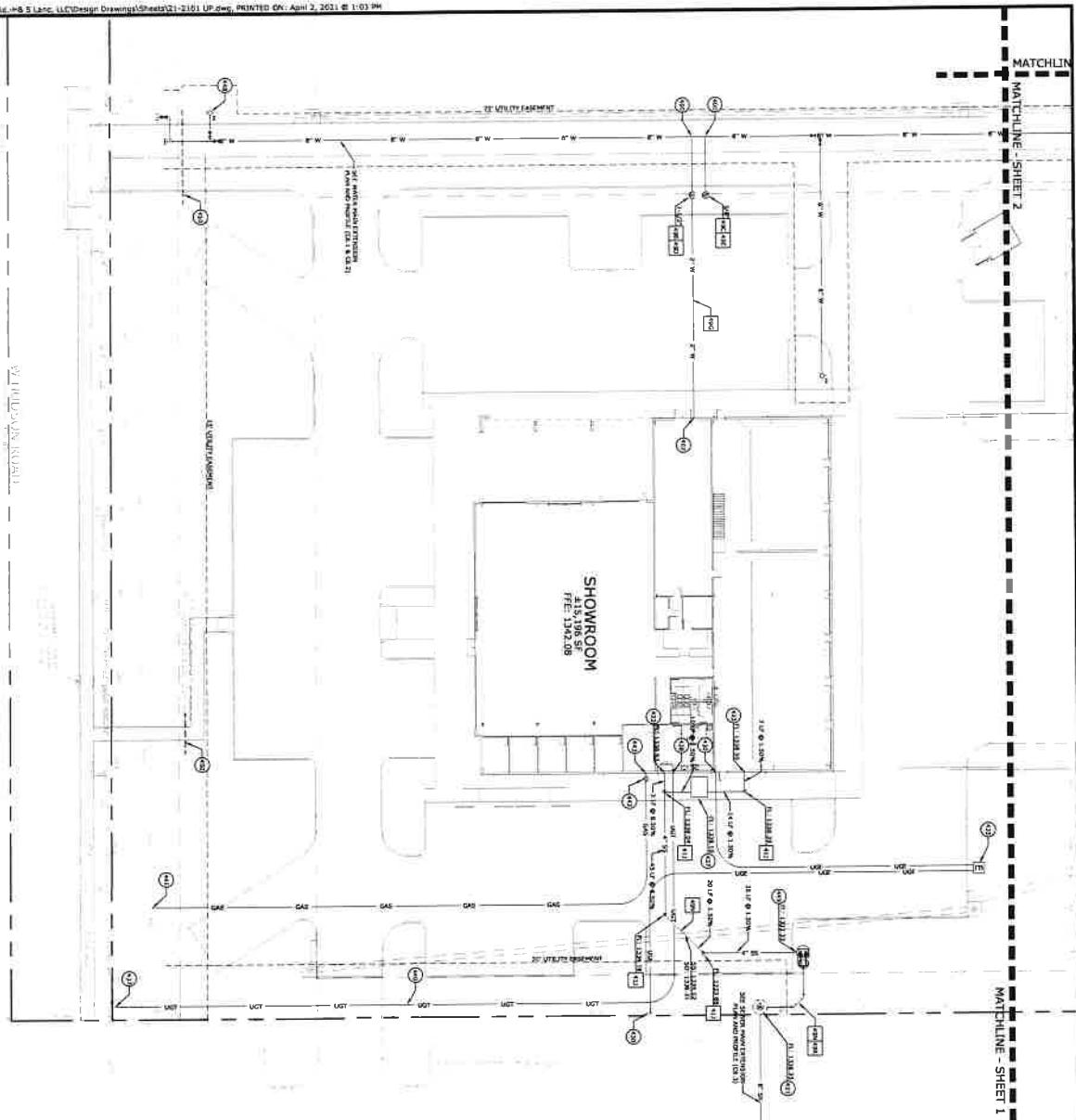

MATCHLINE - SHEET 2

MATCHLINE - SHEET 1

GENERAL UTILITY NOTES

1. ALL WATER MAINS SHALL BE LOCATED AT LEAST 30' FROM DRIVEWAYS, PARKING AREAS, SIDEWALKS, AND OTHER OBSTRUCTIONS. ALL OTHER UTILITY MAINS SHALL BE LOCATED AS SHOWN ON THIS PLAN AND TO MAINTAIN A MINIMUM 30' CLEARANCE FROM DRIVEWAYS, SIDEWALKS, AND OTHER OBSTRUCTIONS.
2. ALL UTILITY MAINS SHALL BE INSTALLED IN ACCORDANCE WITH THE CITY OF FAYETTEVILLE, ARKANSAS, UTILITY CODES AND THE ARKANSAS PUBLIC SERVICE COMMISSION REGULATIONS.
3. ALL UTILITY MAINS SHALL BE INSTALLED IN ACCORDANCE WITH THE CITY OF FAYETTEVILLE, ARKANSAS, UTILITY CODES AND THE ARKANSAS PUBLIC SERVICE COMMISSION REGULATIONS.
4. ALL UTILITY MAINS SHALL BE INSTALLED IN ACCORDANCE WITH THE CITY OF FAYETTEVILLE, ARKANSAS, UTILITY CODES AND THE ARKANSAS PUBLIC SERVICE COMMISSION REGULATIONS.
5. ALL UTILITY MAINS SHALL BE INSTALLED IN ACCORDANCE WITH THE CITY OF FAYETTEVILLE, ARKANSAS, UTILITY CODES AND THE ARKANSAS PUBLIC SERVICE COMMISSION REGULATIONS.
6. ALL UTILITY MAINS SHALL BE INSTALLED IN ACCORDANCE WITH THE CITY OF FAYETTEVILLE, ARKANSAS, UTILITY CODES AND THE ARKANSAS PUBLIC SERVICE COMMISSION REGULATIONS.
7. ALL UTILITY MAINS SHALL BE INSTALLED IN ACCORDANCE WITH THE CITY OF FAYETTEVILLE, ARKANSAS, UTILITY CODES AND THE ARKANSAS PUBLIC SERVICE COMMISSION REGULATIONS.
8. ALL UTILITY MAINS SHALL BE INSTALLED IN ACCORDANCE WITH THE CITY OF FAYETTEVILLE, ARKANSAS, UTILITY CODES AND THE ARKANSAS PUBLIC SERVICE COMMISSION REGULATIONS.
9. ALL UTILITY MAINS SHALL BE INSTALLED IN ACCORDANCE WITH THE CITY OF FAYETTEVILLE, ARKANSAS, UTILITY CODES AND THE ARKANSAS PUBLIC SERVICE COMMISSION REGULATIONS.
10. ALL UTILITY MAINS SHALL BE INSTALLED IN ACCORDANCE WITH THE CITY OF FAYETTEVILLE, ARKANSAS, UTILITY CODES AND THE ARKANSAS PUBLIC SERVICE COMMISSION REGULATIONS.
11. ALL UTILITY MAINS SHALL BE INSTALLED IN ACCORDANCE WITH THE CITY OF FAYETTEVILLE, ARKANSAS, UTILITY CODES AND THE ARKANSAS PUBLIC SERVICE COMMISSION REGULATIONS.
12. ALL UTILITY MAINS SHALL BE INSTALLED IN ACCORDANCE WITH THE CITY OF FAYETTEVILLE, ARKANSAS, UTILITY CODES AND THE ARKANSAS PUBLIC SERVICE COMMISSION REGULATIONS.
13. ALL UTILITY MAINS SHALL BE INSTALLED IN ACCORDANCE WITH THE CITY OF FAYETTEVILLE, ARKANSAS, UTILITY CODES AND THE ARKANSAS PUBLIC SERVICE COMMISSION REGULATIONS.
14. ALL UTILITY MAINS SHALL BE INSTALLED IN ACCORDANCE WITH THE CITY OF FAYETTEVILLE, ARKANSAS, UTILITY CODES AND THE ARKANSAS PUBLIC SERVICE COMMISSION REGULATIONS.
15. ALL UTILITY MAINS SHALL BE INSTALLED IN ACCORDANCE WITH THE CITY OF FAYETTEVILLE, ARKANSAS, UTILITY CODES AND THE ARKANSAS PUBLIC SERVICE COMMISSION REGULATIONS.
16. ALL UTILITY MAINS SHALL BE INSTALLED IN ACCORDANCE WITH THE CITY OF FAYETTEVILLE, ARKANSAS, UTILITY CODES AND THE ARKANSAS PUBLIC SERVICE COMMISSION REGULATIONS.
17. ALL UTILITY MAINS SHALL BE INSTALLED IN ACCORDANCE WITH THE CITY OF FAYETTEVILLE, ARKANSAS, UTILITY CODES AND THE ARKANSAS PUBLIC SERVICE COMMISSION REGULATIONS.
18. ALL UTILITY MAINS SHALL BE INSTALLED IN ACCORDANCE WITH THE CITY OF FAYETTEVILLE, ARKANSAS, UTILITY CODES AND THE ARKANSAS PUBLIC SERVICE COMMISSION REGULATIONS.
19. ALL UTILITY MAINS SHALL BE INSTALLED IN ACCORDANCE WITH THE CITY OF FAYETTEVILLE, ARKANSAS, UTILITY CODES AND THE ARKANSAS PUBLIC SERVICE COMMISSION REGULATIONS.
20. ALL UTILITY MAINS SHALL BE INSTALLED IN ACCORDANCE WITH THE CITY OF FAYETTEVILLE, ARKANSAS, UTILITY CODES AND THE ARKANSAS PUBLIC SERVICE COMMISSION REGULATIONS.
21. ALL UTILITY MAINS SHALL BE INSTALLED IN ACCORDANCE WITH THE CITY OF FAYETTEVILLE, ARKANSAS, UTILITY CODES AND THE ARKANSAS PUBLIC SERVICE COMMISSION REGULATIONS.
22. ALL UTILITY MAINS SHALL BE INSTALLED IN ACCORDANCE WITH THE CITY OF FAYETTEVILLE, ARKANSAS, UTILITY CODES AND THE ARKANSAS PUBLIC SERVICE COMMISSION REGULATIONS.
23. ALL UTILITY MAINS SHALL BE INSTALLED IN ACCORDANCE WITH THE CITY OF FAYETTEVILLE, ARKANSAS, UTILITY CODES AND THE ARKANSAS PUBLIC SERVICE COMMISSION REGULATIONS.
24. ALL UTILITY MAINS SHALL BE INSTALLED IN ACCORDANCE WITH THE CITY OF FAYETTEVILLE, ARKANSAS, UTILITY CODES AND THE ARKANSAS PUBLIC SERVICE COMMISSION REGULATIONS.
25. ALL UTILITY MAINS SHALL BE INSTALLED IN ACCORDANCE WITH THE CITY OF FAYETTEVILLE, ARKANSAS, UTILITY CODES AND THE ARKANSAS PUBLIC SERVICE COMMISSION REGULATIONS.
26. ALL UTILITY MAINS SHALL BE INSTALLED IN ACCORDANCE WITH THE CITY OF FAYETTEVILLE, ARKANSAS, UTILITY CODES AND THE ARKANSAS PUBLIC SERVICE COMMISSION REGULATIONS.
27. ALL UTILITY MAINS SHALL BE INSTALLED IN ACCORDANCE WITH THE CITY OF FAYETTEVILLE, ARKANSAS, UTILITY CODES AND THE ARKANSAS PUBLIC SERVICE COMMISSION REGULATIONS.
28. ALL UTILITY MAINS SHALL BE INSTALLED IN ACCORDANCE WITH THE CITY OF FAYETTEVILLE, ARKANSAS, UTILITY CODES AND THE ARKANSAS PUBLIC SERVICE COMMISSION REGULATIONS.



PLAN SCALE
1" = 10'

EXISTING LEGEND

- 2. CONSTRUCTION OF WATER MAINS SHALL BE IN ACCORDANCE WITH THE CITY OF FAYETTEVILLE, ARKANSAS, UTILITY CODES AND THE ARKANSAS PUBLIC SERVICE COMMISSION REGULATIONS.
- 3. CONSTRUCTION OF SEWER MAINS SHALL BE IN ACCORDANCE WITH THE CITY OF FAYETTEVILLE, ARKANSAS, UTILITY CODES AND THE ARKANSAS PUBLIC SERVICE COMMISSION REGULATIONS.
- 4. CONSTRUCTION OF GAS MAINS SHALL BE IN ACCORDANCE WITH THE CITY OF FAYETTEVILLE, ARKANSAS, UTILITY CODES AND THE ARKANSAS PUBLIC SERVICE COMMISSION REGULATIONS.
- 5. CONSTRUCTION OF ELECTRIC MAINS SHALL BE IN ACCORDANCE WITH THE CITY OF FAYETTEVILLE, ARKANSAS, UTILITY CODES AND THE ARKANSAS PUBLIC SERVICE COMMISSION REGULATIONS.
- 6. CONSTRUCTION OF TELEPHONE MAINS SHALL BE IN ACCORDANCE WITH THE CITY OF FAYETTEVILLE, ARKANSAS, UTILITY CODES AND THE ARKANSAS PUBLIC SERVICE COMMISSION REGULATIONS.
- 7. CONSTRUCTION OF CABLE MAINS SHALL BE IN ACCORDANCE WITH THE CITY OF FAYETTEVILLE, ARKANSAS, UTILITY CODES AND THE ARKANSAS PUBLIC SERVICE COMMISSION REGULATIONS.
- 8. CONSTRUCTION OF FIBER OPTIC MAINS SHALL BE IN ACCORDANCE WITH THE CITY OF FAYETTEVILLE, ARKANSAS, UTILITY CODES AND THE ARKANSAS PUBLIC SERVICE COMMISSION REGULATIONS.
- 9. CONSTRUCTION OF RAINWATER MAINS SHALL BE IN ACCORDANCE WITH THE CITY OF FAYETTEVILLE, ARKANSAS, UTILITY CODES AND THE ARKANSAS PUBLIC SERVICE COMMISSION REGULATIONS.
- 10. CONSTRUCTION OF SWELLAGE MAINS SHALL BE IN ACCORDANCE WITH THE CITY OF FAYETTEVILLE, ARKANSAS, UTILITY CODES AND THE ARKANSAS PUBLIC SERVICE COMMISSION REGULATIONS.
- 11. CONSTRUCTION OF AIR MAINS SHALL BE IN ACCORDANCE WITH THE CITY OF FAYETTEVILLE, ARKANSAS, UTILITY CODES AND THE ARKANSAS PUBLIC SERVICE COMMISSION REGULATIONS.
- 12. CONSTRUCTION OF VENT MAINS SHALL BE IN ACCORDANCE WITH THE CITY OF FAYETTEVILLE, ARKANSAS, UTILITY CODES AND THE ARKANSAS PUBLIC SERVICE COMMISSION REGULATIONS.
- 13. CONSTRUCTION OF EXHAUST MAINS SHALL BE IN ACCORDANCE WITH THE CITY OF FAYETTEVILLE, ARKANSAS, UTILITY CODES AND THE ARKANSAS PUBLIC SERVICE COMMISSION REGULATIONS.
- 14. CONSTRUCTION OF CONDENSATE MAINS SHALL BE IN ACCORDANCE WITH THE CITY OF FAYETTEVILLE, ARKANSAS, UTILITY CODES AND THE ARKANSAS PUBLIC SERVICE COMMISSION REGULATIONS.
- 15. CONSTRUCTION OF CHILLED WATER MAINS SHALL BE IN ACCORDANCE WITH THE CITY OF FAYETTEVILLE, ARKANSAS, UTILITY CODES AND THE ARKANSAS PUBLIC SERVICE COMMISSION REGULATIONS.
- 16. CONSTRUCTION OF HEATING WATER MAINS SHALL BE IN ACCORDANCE WITH THE CITY OF FAYETTEVILLE, ARKANSAS, UTILITY CODES AND THE ARKANSAS PUBLIC SERVICE COMMISSION REGULATIONS.
- 17. CONSTRUCTION OF STEAM MAINS SHALL BE IN ACCORDANCE WITH THE CITY OF FAYETTEVILLE, ARKANSAS, UTILITY CODES AND THE ARKANSAS PUBLIC SERVICE COMMISSION REGULATIONS.
- 18. CONSTRUCTION OF AIR CONDITIONING MAINS SHALL BE IN ACCORDANCE WITH THE CITY OF FAYETTEVILLE, ARKANSAS, UTILITY CODES AND THE ARKANSAS PUBLIC SERVICE COMMISSION REGULATIONS.
- 19. CONSTRUCTION OF INDUSTRIAL MAINS SHALL BE IN ACCORDANCE WITH THE CITY OF FAYETTEVILLE, ARKANSAS, UTILITY CODES AND THE ARKANSAS PUBLIC SERVICE COMMISSION REGULATIONS.
- 20. CONSTRUCTION OF SPECIAL MAINS SHALL BE IN ACCORDANCE WITH THE CITY OF FAYETTEVILLE, ARKANSAS, UTILITY CODES AND THE ARKANSAS PUBLIC SERVICE COMMISSION REGULATIONS.

PROPOSED LEGEND

- 1. WATER MAIN
- 2. SEWER MAIN
- 3. GAS MAIN
- 4. ELECTRIC MAIN
- 5. TELEPHONE MAIN
- 6. CABLE MAIN
- 7. FIBER OPTIC MAIN
- 8. RAINWATER MAIN
- 9. SWELLAGE MAIN
- 10. AIR MAIN
- 11. VENT MAIN
- 12. EXHAUST MAIN
- 13. CONDENSATE MAIN
- 14. CHILLED WATER MAIN
- 15. HEATING WATER MAIN
- 16. STEAM MAIN
- 17. AIR CONDITIONING MAIN
- 18. INDUSTRIAL MAIN
- 19. SPECIAL MAIN

UTILITY REMOVALS

- 1. REMOVE ALL EXISTING UTILITY MAINS SHOWN ON THE PREVIOUS SHEET.
- 2. REMOVE ALL EXISTING UTILITY MAINS SHOWN ON THE PREVIOUS SHEET.
- 3. REMOVE ALL EXISTING UTILITY MAINS SHOWN ON THE PREVIOUS SHEET.
- 4. REMOVE ALL EXISTING UTILITY MAINS SHOWN ON THE PREVIOUS SHEET.
- 5. REMOVE ALL EXISTING UTILITY MAINS SHOWN ON THE PREVIOUS SHEET.
- 6. REMOVE ALL EXISTING UTILITY MAINS SHOWN ON THE PREVIOUS SHEET.
- 7. REMOVE ALL EXISTING UTILITY MAINS SHOWN ON THE PREVIOUS SHEET.
- 8. REMOVE ALL EXISTING UTILITY MAINS SHOWN ON THE PREVIOUS SHEET.
- 9. REMOVE ALL EXISTING UTILITY MAINS SHOWN ON THE PREVIOUS SHEET.
- 10. REMOVE ALL EXISTING UTILITY MAINS SHOWN ON THE PREVIOUS SHEET.
- 11. REMOVE ALL EXISTING UTILITY MAINS SHOWN ON THE PREVIOUS SHEET.
- 12. REMOVE ALL EXISTING UTILITY MAINS SHOWN ON THE PREVIOUS SHEET.
- 13. REMOVE ALL EXISTING UTILITY MAINS SHOWN ON THE PREVIOUS SHEET.
- 14. REMOVE ALL EXISTING UTILITY MAINS SHOWN ON THE PREVIOUS SHEET.
- 15. REMOVE ALL EXISTING UTILITY MAINS SHOWN ON THE PREVIOUS SHEET.
- 16. REMOVE ALL EXISTING UTILITY MAINS SHOWN ON THE PREVIOUS SHEET.
- 17. REMOVE ALL EXISTING UTILITY MAINS SHOWN ON THE PREVIOUS SHEET.
- 18. REMOVE ALL EXISTING UTILITY MAINS SHOWN ON THE PREVIOUS SHEET.
- 19. REMOVE ALL EXISTING UTILITY MAINS SHOWN ON THE PREVIOUS SHEET.
- 20. REMOVE ALL EXISTING UTILITY MAINS SHOWN ON THE PREVIOUS SHEET.

UTILITY DETAILS

- 1. SEE SHEET 21-1161 FOR UTILITY MAINS DETAIL.
- 2. SEE SHEET 21-1161 FOR UTILITY MAINS DETAIL.
- 3. SEE SHEET 21-1161 FOR UTILITY MAINS DETAIL.
- 4. SEE SHEET 21-1161 FOR UTILITY MAINS DETAIL.
- 5. SEE SHEET 21-1161 FOR UTILITY MAINS DETAIL.
- 6. SEE SHEET 21-1161 FOR UTILITY MAINS DETAIL.
- 7. SEE SHEET 21-1161 FOR UTILITY MAINS DETAIL.
- 8. SEE SHEET 21-1161 FOR UTILITY MAINS DETAIL.
- 9. SEE SHEET 21-1161 FOR UTILITY MAINS DETAIL.
- 10. SEE SHEET 21-1161 FOR UTILITY MAINS DETAIL.
- 11. SEE SHEET 21-1161 FOR UTILITY MAINS DETAIL.
- 12. SEE SHEET 21-1161 FOR UTILITY MAINS DETAIL.
- 13. SEE SHEET 21-1161 FOR UTILITY MAINS DETAIL.
- 14. SEE SHEET 21-1161 FOR UTILITY MAINS DETAIL.
- 15. SEE SHEET 21-1161 FOR UTILITY MAINS DETAIL.
- 16. SEE SHEET 21-1161 FOR UTILITY MAINS DETAIL.
- 17. SEE SHEET 21-1161 FOR UTILITY MAINS DETAIL.
- 18. SEE SHEET 21-1161 FOR UTILITY MAINS DETAIL.
- 19. SEE SHEET 21-1161 FOR UTILITY MAINS DETAIL.
- 20. SEE SHEET 21-1161 FOR UTILITY MAINS DETAIL.

MARINE SALES AND SERVICE

701 WEST HUDSON ROAD
ROGERS, ARKANSAS

MCE McCLELLAND CONSULTING ENGINEERS, INC.

1580 E STEARNS ST
FAYETTEVILLE, ARKANSAS 72703
(479) 443-2377
HTTP://WWW.MCE-US.COM

DESIGN: [Name]

DRAWN: [Name]

CHECKED: [Name]

DATE: 11/2/2011

SCALE: AS SHOWN

C6.0

REVISIONS

REV	DATE	DESCRIPTION

UTILITY PLAN

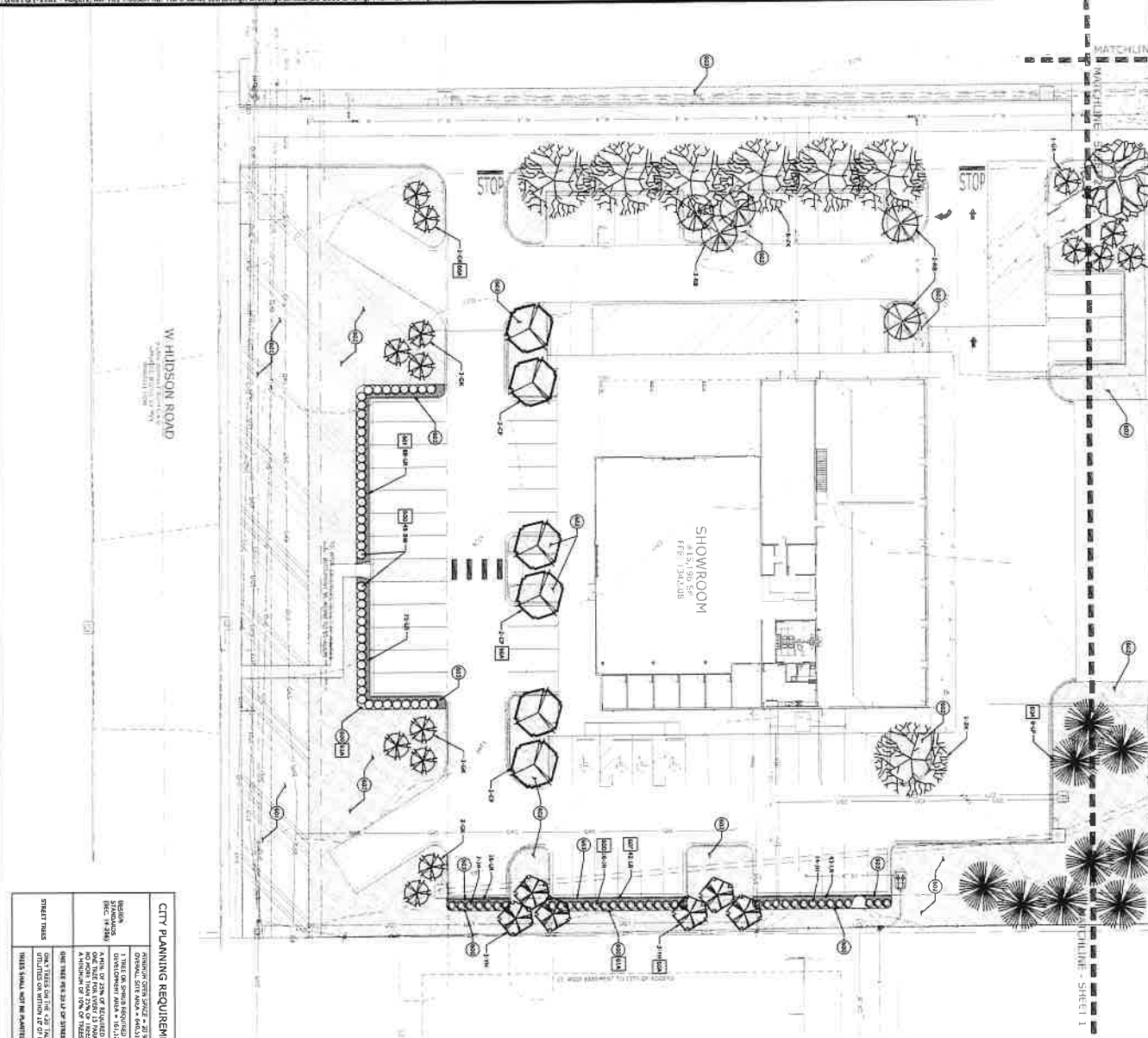

CTTY PLANNING REQUIREMENTS

REQUIREMENT	REQUIRED	PROVIDED
1. TREE CANOPY REQUIRED FOR ALL PAVED SURFACES EXCEPT DRIVEWAYS AND DRIVEWAYS SHALL BE 25%.	70% - 110% IN 5' - 10' OPEN SPACES	70% - 110% IN 5' - 10' OPEN SPACES
2. TREE CANOPY REQUIRED FOR ALL PAVED SURFACES EXCEPT DRIVEWAYS AND DRIVEWAYS SHALL BE 25%.	ALL TREES TO BE SHEDDING	ALL TREES TO BE SHEDDING
3. TREE CANOPY REQUIRED FOR ALL PAVED SURFACES EXCEPT DRIVEWAYS AND DRIVEWAYS SHALL BE 25%.	1.5" x 1.5" x 4" TREES	1.5" x 1.5" x 4" TREES
4. TREE CANOPY REQUIRED FOR ALL PAVED SURFACES EXCEPT DRIVEWAYS AND DRIVEWAYS SHALL BE 25%.	6" x 6" x 6" TREES	6" x 6" x 6" TREES
5. TREE CANOPY REQUIRED FOR ALL PAVED SURFACES EXCEPT DRIVEWAYS AND DRIVEWAYS SHALL BE 25%.	4" x 4" x 4" TREES	4" x 4" x 4" TREES
6. TREE CANOPY REQUIRED FOR ALL PAVED SURFACES EXCEPT DRIVEWAYS AND DRIVEWAYS SHALL BE 25%.	18 TREES	18 TREES
7. TREE CANOPY REQUIRED FOR ALL PAVED SURFACES EXCEPT DRIVEWAYS AND DRIVEWAYS SHALL BE 25%.	18 TREES	18 TREES

LANDSCAPE NOTES

1. PLANTING IN AREAS OF HIGHWAY REQUIREMENTS MAY NOT BE SUBJECT TO CITY PLANNING DEPARTMENT APPROVAL.
2. ALL PLANTING SHALL BE SUBJECT TO CITY PLANNING DEPARTMENT APPROVAL.
3. ALL PLANTING SHALL BE SUBJECT TO CITY PLANNING DEPARTMENT APPROVAL.
4. ALL PLANTING SHALL BE SUBJECT TO CITY PLANNING DEPARTMENT APPROVAL.
5. ALL PLANTING SHALL BE SUBJECT TO CITY PLANNING DEPARTMENT APPROVAL.
6. ALL PLANTING SHALL BE SUBJECT TO CITY PLANNING DEPARTMENT APPROVAL.
7. ALL PLANTING SHALL BE SUBJECT TO CITY PLANNING DEPARTMENT APPROVAL.
8. ALL PLANTING SHALL BE SUBJECT TO CITY PLANNING DEPARTMENT APPROVAL.
9. ALL PLANTING SHALL BE SUBJECT TO CITY PLANNING DEPARTMENT APPROVAL.
10. ALL PLANTING SHALL BE SUBJECT TO CITY PLANNING DEPARTMENT APPROVAL.

PLANT LIST

NO.	QTY.	COMMON NAME	SYMBOL	SIZE / COMMENTS
1	1	ORANGE PRINCE	[Symbol]	3" F. Caliper
2	1	ORANGE PRINCE	[Symbol]	3" F. Caliper
3	1	ORANGE PRINCE	[Symbol]	3" F. Caliper
4	1	ORANGE PRINCE	[Symbol]	3" F. Caliper
5	1	ORANGE PRINCE	[Symbol]	3" F. Caliper
6	1	ORANGE PRINCE	[Symbol]	3" F. Caliper
7	1	ORANGE PRINCE	[Symbol]	3" F. Caliper
8	1	ORANGE PRINCE	[Symbol]	3" F. Caliper
9	1	ORANGE PRINCE	[Symbol]	3" F. Caliper
10	1	ORANGE PRINCE	[Symbol]	3" F. Caliper

PROPOSED LEGEND

- 1. STOP SIGN
- 2. STOP SIGN
- 3. STOP SIGN
- 4. STOP SIGN
- 5. STOP SIGN
- 6. STOP SIGN
- 7. STOP SIGN
- 8. STOP SIGN
- 9. STOP SIGN
- 10. STOP SIGN

EXISTING LEGEND

- 1. EXISTING TREE
- 2. EXISTING TREE
- 3. EXISTING TREE
- 4. EXISTING TREE
- 5. EXISTING TREE
- 6. EXISTING TREE
- 7. EXISTING TREE
- 8. EXISTING TREE
- 9. EXISTING TREE
- 10. EXISTING TREE

LANDSCAPE NOTES

1. ALL PLANTING SHALL BE SUBJECT TO CITY PLANNING DEPARTMENT APPROVAL.
2. ALL PLANTING SHALL BE SUBJECT TO CITY PLANNING DEPARTMENT APPROVAL.
3. ALL PLANTING SHALL BE SUBJECT TO CITY PLANNING DEPARTMENT APPROVAL.
4. ALL PLANTING SHALL BE SUBJECT TO CITY PLANNING DEPARTMENT APPROVAL.
5. ALL PLANTING SHALL BE SUBJECT TO CITY PLANNING DEPARTMENT APPROVAL.
6. ALL PLANTING SHALL BE SUBJECT TO CITY PLANNING DEPARTMENT APPROVAL.
7. ALL PLANTING SHALL BE SUBJECT TO CITY PLANNING DEPARTMENT APPROVAL.
8. ALL PLANTING SHALL BE SUBJECT TO CITY PLANNING DEPARTMENT APPROVAL.
9. ALL PLANTING SHALL BE SUBJECT TO CITY PLANNING DEPARTMENT APPROVAL.
10. ALL PLANTING SHALL BE SUBJECT TO CITY PLANNING DEPARTMENT APPROVAL.

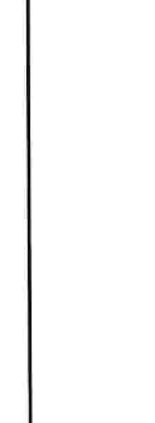

REVISIONS

NO.	DATE	DESCRIPTION
1		
2		
3		
4		
5		

LANDSCAPE PLAN - SHEET 1

811

MARINE SALES AND SERVICE
701 WEST HUDSON ROAD
ROGERS, ARKANSAS

McCLELLAND CONSULTING ENGINEERS, INC.
1580 E STEARNS ST
FAYETTEVILLE, ARKANSAS 72703
(479) 443-2377
HTTP://WWW.MCCLELLAND.US.COM

7.0

1. JOINTS SHALL BE FULLY SEAM FINISHED WITH ONE COAT OF CONCRETE PAINT.
2. JOINTS SHALL BE FULLY SEAM FINISHED WITH ONE COAT OF CONCRETE PAINT.
3. JOINTS SHALL BE FULLY SEAM FINISHED WITH ONE COAT OF CONCRETE PAINT.
4. JOINTS SHALL BE FULLY SEAM FINISHED WITH ONE COAT OF CONCRETE PAINT.
5. JOINTS SHALL BE FULLY SEAM FINISHED WITH ONE COAT OF CONCRETE PAINT.
6. JOINTS SHALL BE FULLY SEAM FINISHED WITH ONE COAT OF CONCRETE PAINT.
7. JOINTS SHALL BE FULLY SEAM FINISHED WITH ONE COAT OF CONCRETE PAINT.
8. JOINTS SHALL BE FULLY SEAM FINISHED WITH ONE COAT OF CONCRETE PAINT.
9. JOINTS SHALL BE FULLY SEAM FINISHED WITH ONE COAT OF CONCRETE PAINT.
10. JOINTS SHALL BE FULLY SEAM FINISHED WITH ONE COAT OF CONCRETE PAINT.
11. JOINTS SHALL BE FULLY SEAM FINISHED WITH ONE COAT OF CONCRETE PAINT.
12. JOINTS SHALL BE FULLY SEAM FINISHED WITH ONE COAT OF CONCRETE PAINT.
13. JOINTS SHALL BE FULLY SEAM FINISHED WITH ONE COAT OF CONCRETE PAINT.
14. JOINTS SHALL BE FULLY SEAM FINISHED WITH ONE COAT OF CONCRETE PAINT.
15. JOINTS SHALL BE FULLY SEAM FINISHED WITH ONE COAT OF CONCRETE PAINT.
16. JOINTS SHALL BE FULLY SEAM FINISHED WITH ONE COAT OF CONCRETE PAINT.

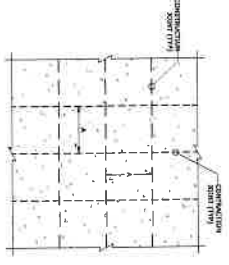

JOINT SCHEDULING SCHEDULE

JOINT TYPE	JOINT SPACING
TRANSVERSE	10'
LONGITUDINAL	10'
EXPANDED	10'
CONCRETE	10'

DOWEL SIZE SCHEDULE

DOWEL SIZE	DOWEL LENGTH
3/4"	12"
1/2"	12"
3/8"	12"
1/4"	12"

*NORMAL TO BE SHOWN IN DRAWING IN BOLD LETTERS

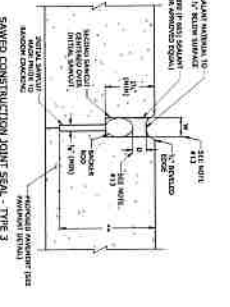
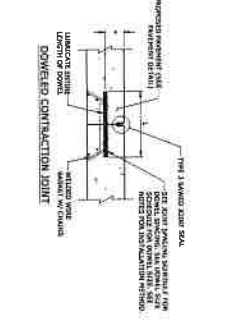
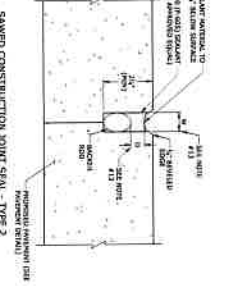
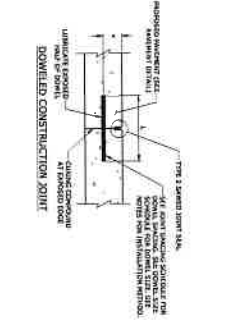

21H CONCRETE PAVEMENT DOWEL & JOINTING

* 3/4" W/ 10' SPACING
* 1/2" W/ 10' SPACING

23A 90° PARKING / ADA ACCESSIBLE PARKING SPACE STRIPING

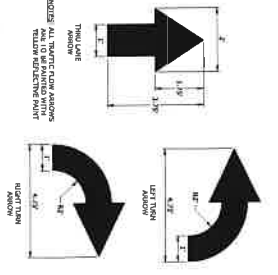
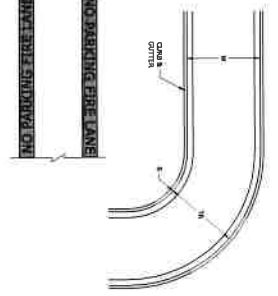
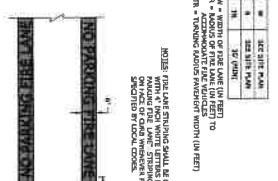
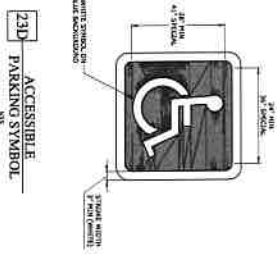

DETAIL SHEET II

REV	DATE	DESCRIPTION

811 Call Before You Dig

C8.1

MARINE SALES AND SERVICE
701 WEST HUDSON ROAD
ROGERS, ARKANSAS

MCE McCLELLAND CONSULTING ENGINEERS, INC.
1580 E STEARNS ST
FAYETTEVILLE, ARKANSAS 72703
(479) 443-2377
HTTP://WWW.MCE.US.COM

811 Call Before You Dig

MCE McCLELLAND CONSULTING ENGINEERS, INC.
1580 E STEARNS ST
FAYETTEVILLE, ARKANSAS 72703
(479) 443-2377
HTTP://WWW.MCE.US.COM

MCE McCLELLAND CONSULTING ENGINEERS, INC.
1580 E STEARNS ST
FAYETTEVILLE, ARKANSAS 72703
(479) 443-2377
HTTP://WWW.MCE.US.COM

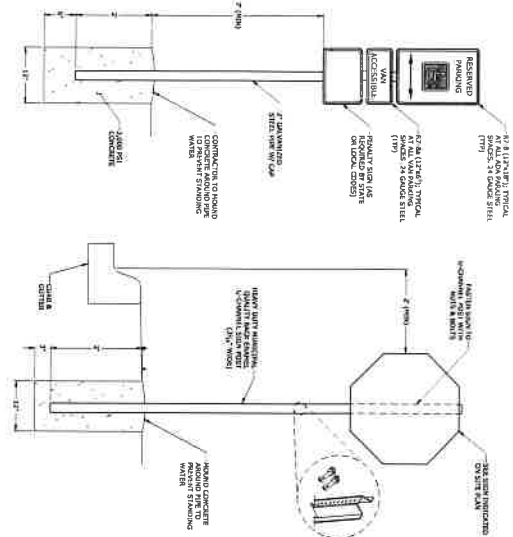

24A ACCESSIBLE PARKING SIGN

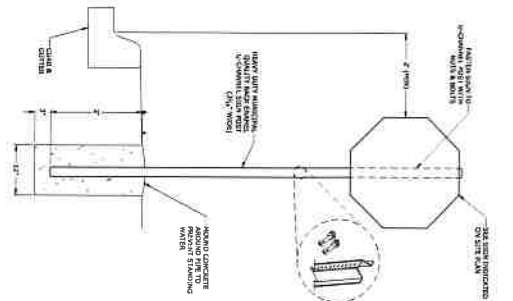

24B SIGN POST

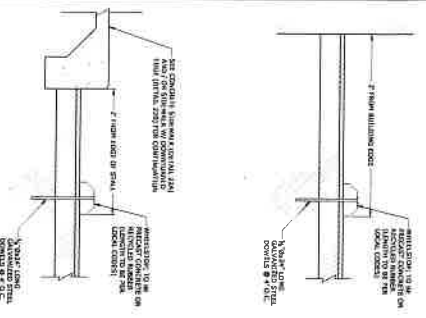

24C WHEEL STOP



24D STOP SIGN

- NOTES:
1. SEE LINK DRAWING FOR DIMENSIONS AND FINISHES.
 2. ALL DIMENSIONS UNLESS OTHERWISE NOTED.
 3. MATERIALS SHALL BE AS SHOWN UNLESS OTHERWISE NOTED.
 4. DIMENSIONS SHALL BE TO FACE UNLESS OTHERWISE NOTED.

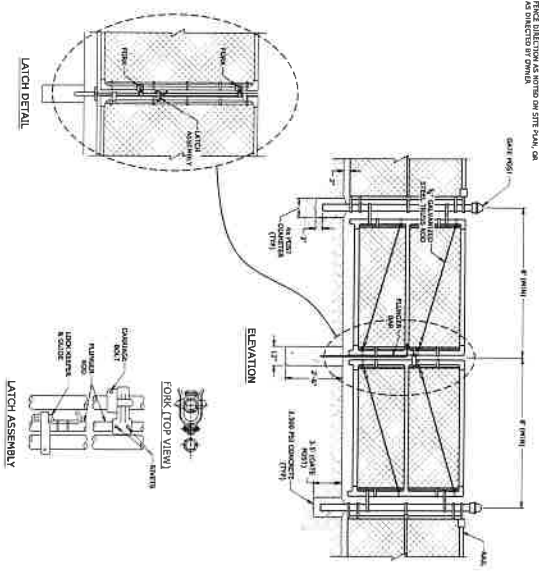

26K COMMERCIAL CHAIN LINK GATE

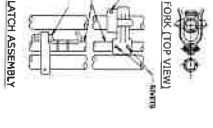

26L GATE END / LINE POST CONNECTION

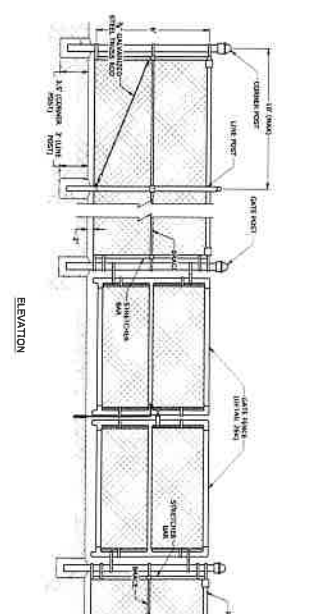

26M COMMERCIAL CHAIN LINK FENCE

- NOTES:
1. CHAIN LINK SHALL BE GALVANIZED AND OF 11 GAUGE UNLESS OTHERWISE NOTED.
 2. ALL DIMENSIONS UNLESS OTHERWISE NOTED.
 3. MATERIALS SHALL BE AS SHOWN UNLESS OTHERWISE NOTED.
 4. DIMENSIONS SHALL BE TO FACE UNLESS OTHERWISE NOTED.

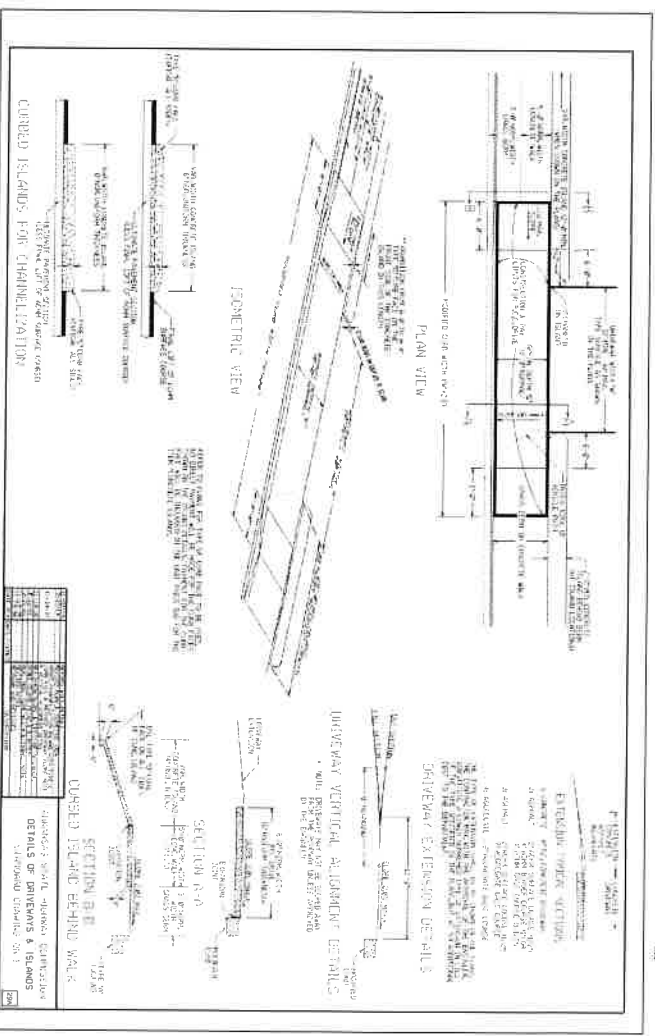

26N COVERED ISLANDS FOR CHANNELIZATION

REV	DATE	DESCRIPTION

MARINE SALES AND SERVICE
 701 WEST HUDSON ROAD
 ROGERS, ARKANSAS

MCE McCLELLAN CONSULTING ENGINEERS, INC.
 1580 E STEARNS ST
 FAYETTEVILLE, ARKANSAS 72703
 (479) 443-2377
 HTTP://WWW.MCE.US.COM

811
 Call before you dig

DETAIL SHEET III

C8.2

NOTES:
 1. ALL 1/2" DIA. SINKS TO BE INSTALLED FROM 18" IN DIAMETER TO 24" IN DIAMETER.
 2. ALL SINKS SHALL BE INSTALLED ON A 1/2" DIA. SINK BASE.
 3. ALL SINKS SHALL BE INSTALLED ON A 1/2" DIA. SINK BASE.
 4. ALL SINKS SHALL BE INSTALLED ON A 1/2" DIA. SINK BASE.
 5. ALL SINKS SHALL BE INSTALLED ON A 1/2" DIA. SINK BASE.
 6. ALL SINKS SHALL BE INSTALLED ON A 1/2" DIA. SINK BASE.
 7. ALL SINKS SHALL BE INSTALLED ON A 1/2" DIA. SINK BASE.
 8. ALL SINKS SHALL BE INSTALLED ON A 1/2" DIA. SINK BASE.
 9. ALL SINKS SHALL BE INSTALLED ON A 1/2" DIA. SINK BASE.
 10. ALL SINKS SHALL BE INSTALLED ON A 1/2" DIA. SINK BASE.
 11. ALL SINKS SHALL BE INSTALLED ON A 1/2" DIA. SINK BASE.
 12. ALL SINKS SHALL BE INSTALLED ON A 1/2" DIA. SINK BASE.
 13. ALL SINKS SHALL BE INSTALLED ON A 1/2" DIA. SINK BASE.
 14. ALL SINKS SHALL BE INSTALLED ON A 1/2" DIA. SINK BASE.

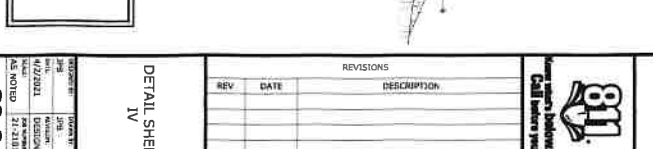
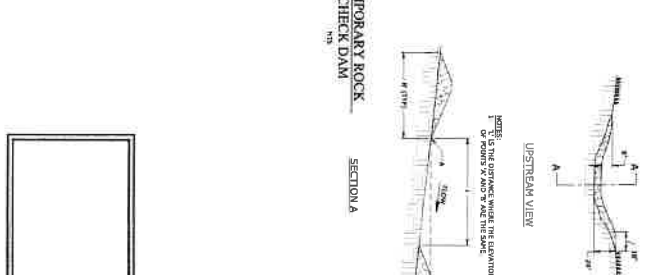
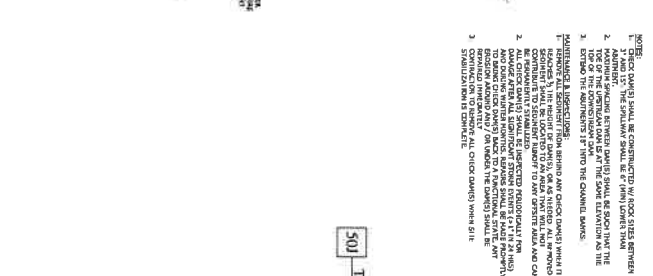
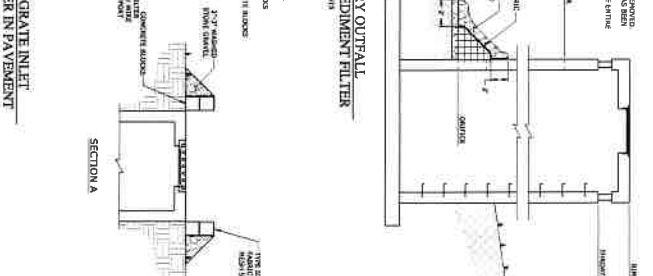
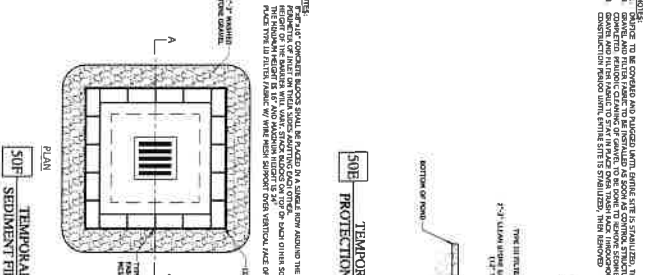
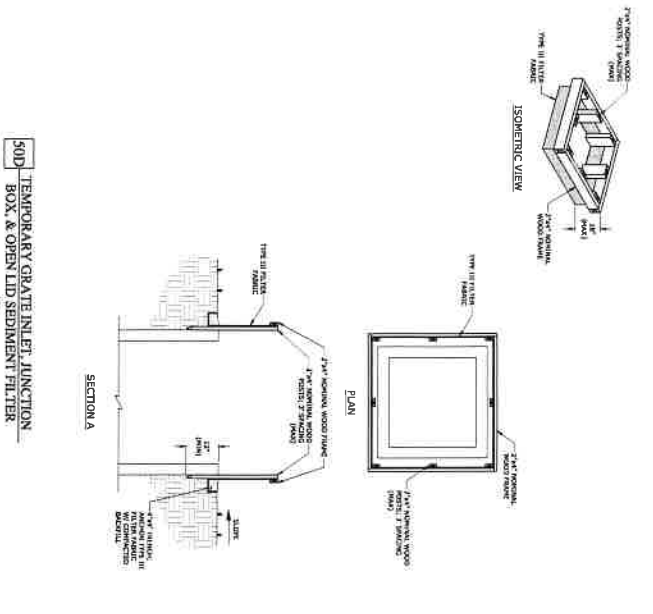
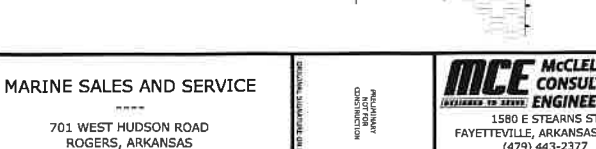
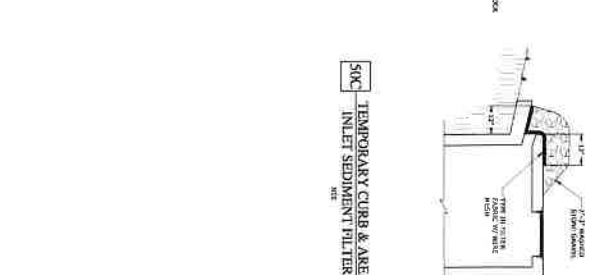
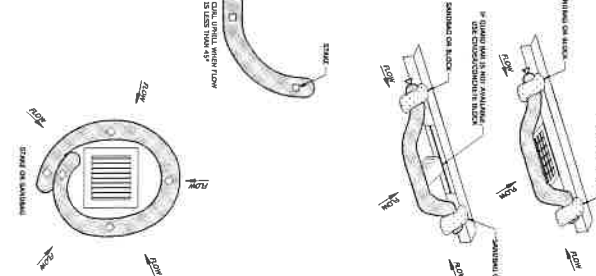
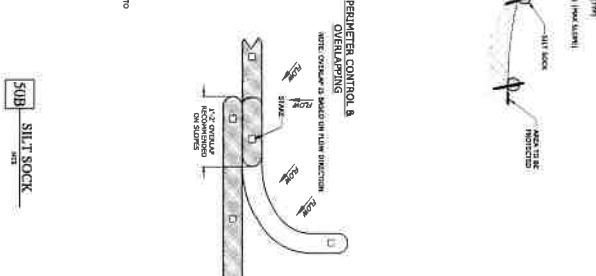
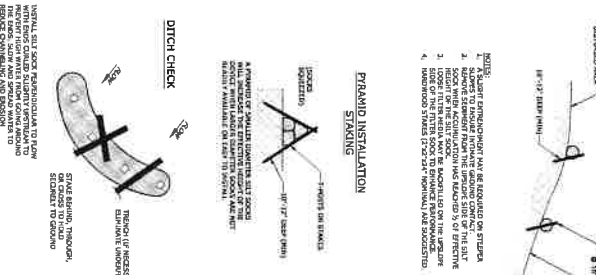
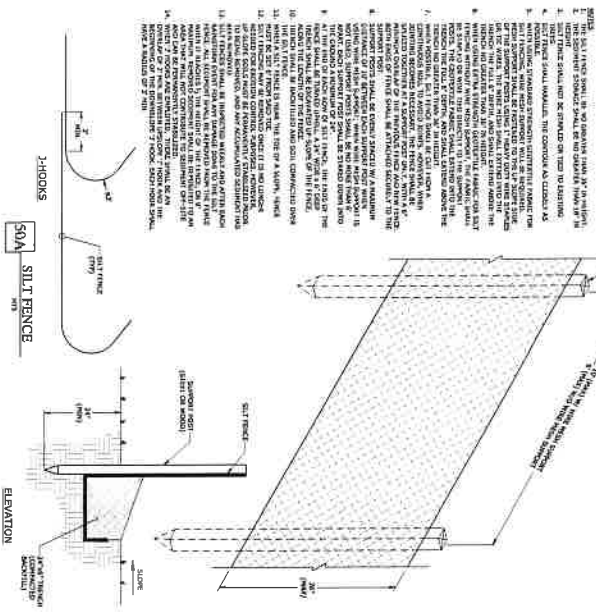

NO.	DATE	DESCRIPTION

MARINE SALES AND SERVICE
 701 WEST HUDSON ROAD
 ROGERS, ARKANSAS

MCE McCLELLAND CONSULTING ENGINEERS, INC.
 1580 E STEARNS ST
 FAYETTEVILLE, ARKANSAS 72703
 (479) 443-2377
 WWW.WWW.MCE.US.COM

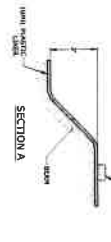
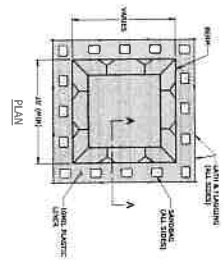

- NOTE: THE WASHOUT OF CONCRETE TRUCKS OR WASHING OF PAVED SURFACES SHALL BE LIMITED TO A MAXIMUM OF 100 GALLONS OF WATER PER TRUCK OR WASHING OPERATION. EXCESS WATER SHALL BE COLLECTED AND REUSED OR DISPOSED OF APPROPRIATELY. THE FOLLOWING ARE THE REQUIREMENTS FOR THE WASHOUT:
1. THE WASHOUT SHALL BE PERFORMED AT THE END OF EACH SHIFT OR AT THE END OF EACH DAY OF CONSTRUCTION.
 2. THE WASHOUT SHALL BE PERFORMED IN A DESIGNATED WASHOUT AREA.
 3. THE WASHOUT SHALL BE PERFORMED IN A MANNER THAT PREVENTS THE SPILLAGE OF CONCRETE OR OTHER MATERIALS ONTO THE ADJACENT PROPERTY.
 4. THE WASHOUT SHALL BE PERFORMED IN A MANNER THAT PREVENTS THE SPILLAGE OF CONCRETE OR OTHER MATERIALS ONTO THE ADJACENT PROPERTY.
 5. THE WASHOUT SHALL BE PERFORMED IN A MANNER THAT PREVENTS THE SPILLAGE OF CONCRETE OR OTHER MATERIALS ONTO THE ADJACENT PROPERTY.
 6. THE WASHOUT SHALL BE PERFORMED IN A MANNER THAT PREVENTS THE SPILLAGE OF CONCRETE OR OTHER MATERIALS ONTO THE ADJACENT PROPERTY.
 7. THE WASHOUT SHALL BE PERFORMED IN A MANNER THAT PREVENTS THE SPILLAGE OF CONCRETE OR OTHER MATERIALS ONTO THE ADJACENT PROPERTY.
 8. THE WASHOUT SHALL BE PERFORMED IN A MANNER THAT PREVENTS THE SPILLAGE OF CONCRETE OR OTHER MATERIALS ONTO THE ADJACENT PROPERTY.

50N TEMPORARY CONCRETE WASHOUT

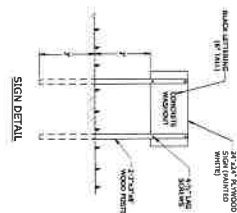

50P TEMPORARY STABILIZED CONSTRUCTION ENTRANCE

- NOTE: THE WASHOUT OF CONCRETE TRUCKS OR WASHING OF PAVED SURFACES SHALL BE LIMITED TO A MAXIMUM OF 100 GALLONS OF WATER PER TRUCK OR WASHING OPERATION. EXCESS WATER SHALL BE COLLECTED AND REUSED OR DISPOSED OF APPROPRIATELY. THE FOLLOWING ARE THE REQUIREMENTS FOR THE WASHOUT:
1. THE WASHOUT SHALL BE PERFORMED AT THE END OF EACH SHIFT OR AT THE END OF EACH DAY OF CONSTRUCTION.
 2. THE WASHOUT SHALL BE PERFORMED IN A DESIGNATED WASHOUT AREA.
 3. THE WASHOUT SHALL BE PERFORMED IN A MANNER THAT PREVENTS THE SPILLAGE OF CONCRETE OR OTHER MATERIALS ONTO THE ADJACENT PROPERTY.
 4. THE WASHOUT SHALL BE PERFORMED IN A MANNER THAT PREVENTS THE SPILLAGE OF CONCRETE OR OTHER MATERIALS ONTO THE ADJACENT PROPERTY.
 5. THE WASHOUT SHALL BE PERFORMED IN A MANNER THAT PREVENTS THE SPILLAGE OF CONCRETE OR OTHER MATERIALS ONTO THE ADJACENT PROPERTY.
 6. THE WASHOUT SHALL BE PERFORMED IN A MANNER THAT PREVENTS THE SPILLAGE OF CONCRETE OR OTHER MATERIALS ONTO THE ADJACENT PROPERTY.
 7. THE WASHOUT SHALL BE PERFORMED IN A MANNER THAT PREVENTS THE SPILLAGE OF CONCRETE OR OTHER MATERIALS ONTO THE ADJACENT PROPERTY.
 8. THE WASHOUT SHALL BE PERFORMED IN A MANNER THAT PREVENTS THE SPILLAGE OF CONCRETE OR OTHER MATERIALS ONTO THE ADJACENT PROPERTY.

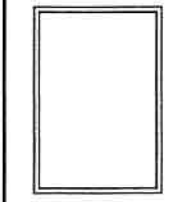
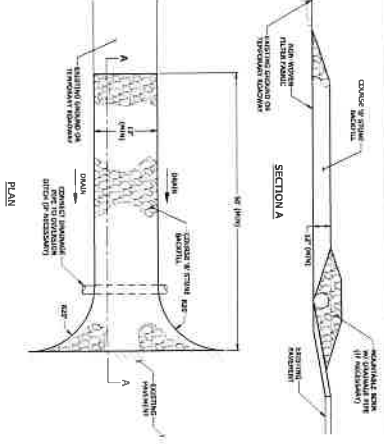

<p>DATE: 4/7/2021</p> <p>DESIGNER: [Name]</p> <p>CHECKED: [Name]</p> <p>SCALE: AS SHOWN</p> <p>PROJECT NO: 21-2181</p> <p>C8.4</p>	<p>REVISIONS</p> <table border="1"> <thead> <tr> <th>REV</th> <th>DATE</th> <th>DESCRIPTION</th> </tr> </thead> <tbody> <tr> <td> </td> <td> </td> <td> </td> </tr> <tr> <td> </td> <td> </td> <td> </td> </tr> <tr> <td> </td> <td> </td> <td> </td> </tr> </tbody> </table>	REV	DATE	DESCRIPTION										<p>MCE McCLELLAND CONSULTING ENGINEERS, INC.</p> <p>1580 E STEARNS ST FAYETTEVILLE, ARKANSAS 72703 (479) 443-2377 HTTP://WWW.MCE.US.COM</p>	<p>MARINE SALES AND SERVICE</p> <p>701 WEST HUDSON ROAD ROGERS, ARKANSAS</p>	<p>DESIGNED BY: [Name]</p> <p>DRAWN BY: [Name]</p> <p>CHECKED BY: [Name]</p> <p>DATE: 4/7/2021</p>
	REV	DATE	DESCRIPTION													
<p>DETAIL SHEET</p> <p>V</p>	<p>811</p> <p>Call before you dig</p>	<p>PRELIMINARY</p> <p>NOT FOR CONSTRUCTION</p>	<p>DATE: 4/7/2021</p>													

NO.	DATE	DESCRIPTION
1	10/21/2011	ISSUED FOR PERMITS
2	10/21/2011	ISSUED FOR PERMITS
3	10/21/2011	ISSUED FOR PERMITS
4	10/21/2011	ISSUED FOR PERMITS
5	10/21/2011	ISSUED FOR PERMITS
6	10/21/2011	ISSUED FOR PERMITS
7	10/21/2011	ISSUED FOR PERMITS
8	10/21/2011	ISSUED FOR PERMITS
9	10/21/2011	ISSUED FOR PERMITS
10	10/21/2011	ISSUED FOR PERMITS

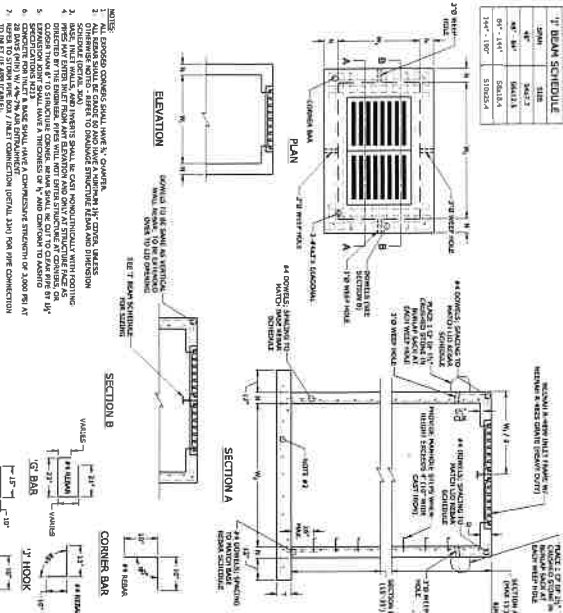

SECTION	WALL REBAR SCHEDULE	REBAR SCHEDULE
SECTION A	4# 4\"/>	
SECTION B	4# 4\"/>	
CORNER BAR	4# 4\"/>	

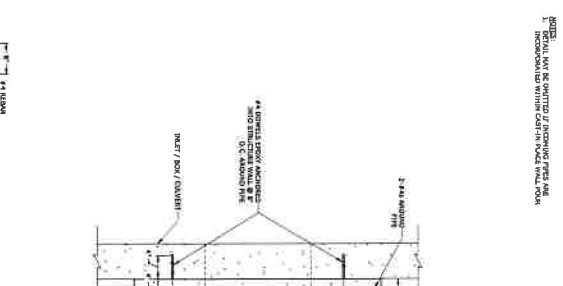

SECTION	WALL REBAR SCHEDULE	REBAR SCHEDULE
SECTION A	4# 4\"/>	
SECTION B	4# 4\"/>	
CORNER BAR	4# 4\"/>	



SECTION	WALL REBAR SCHEDULE	REBAR SCHEDULE
SECTION A	4# 4\"/>	
SECTION B	4# 4\"/>	
CORNER BAR	4# 4\"/>	

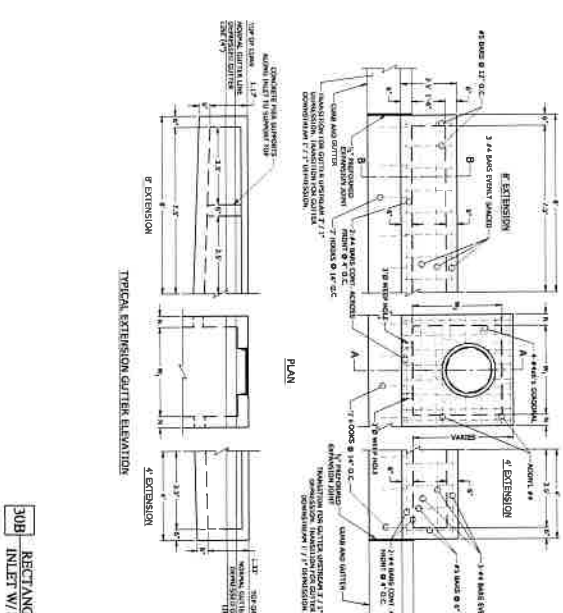

SECTION	WALL REBAR SCHEDULE	REBAR SCHEDULE
SECTION A	4# 4\"/>	
SECTION B	4# 4\"/>	
CORNER BAR	4# 4\"/>	

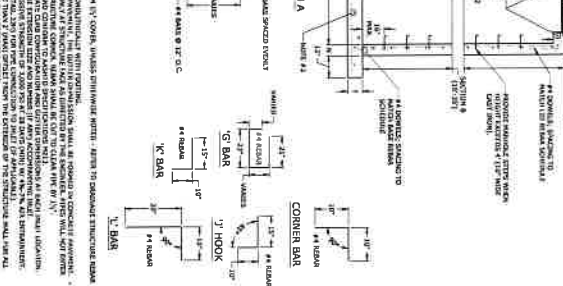

SECTION	WALL REBAR SCHEDULE	REBAR SCHEDULE
SECTION A	4# 4\"/>	
SECTION B	4# 4\"/>	
CORNER BAR	4# 4\"/>	

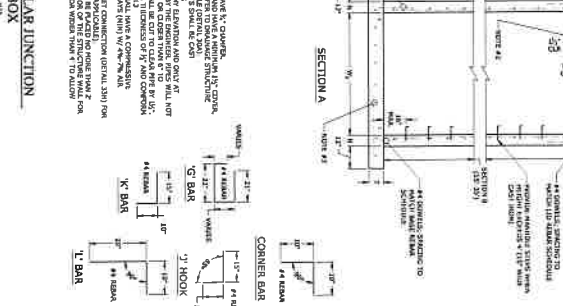

SECTION	WALL REBAR SCHEDULE	REBAR SCHEDULE
SECTION A	4# 4\"/>	
SECTION B	4# 4\"/>	
CORNER BAR	4# 4\"/>	

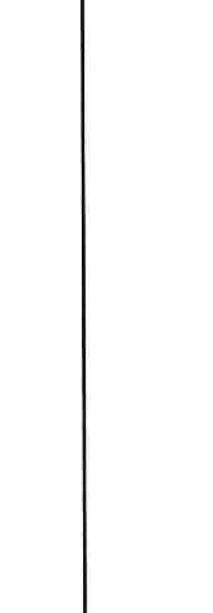

SECTION	WALL REBAR SCHEDULE	REBAR SCHEDULE
SECTION A	4# 4\"/>	
SECTION B	4# 4\"/>	
CORNER BAR	4# 4\"/>	



SECTION	WALL REBAR SCHEDULE	REBAR SCHEDULE
SECTION A	4# 4\"/>	
SECTION B	4# 4\"/>	
CORNER BAR	4# 4\"/>	

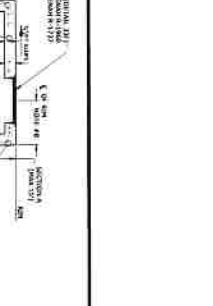

SECTION	WALL REBAR SCHEDULE	REBAR SCHEDULE
SECTION A	4# 4\"/>	
SECTION B	4# 4\"/>	
CORNER BAR	4# 4\"/>	

DETAIL SHEET VI

NO.	DATE	DESCRIPTION
1	10/21/2011	ISSUED FOR PERMITS
2	10/21/2011	ISSUED FOR PERMITS
3	10/21/2011	ISSUED FOR PERMITS
4	10/21/2011	ISSUED FOR PERMITS
5	10/21/2011	ISSUED FOR PERMITS
6	10/21/2011	ISSUED FOR PERMITS
7	10/21/2011	ISSUED FOR PERMITS
8	10/21/2011	ISSUED FOR PERMITS
9	10/21/2011	ISSUED FOR PERMITS
10	10/21/2011	ISSUED FOR PERMITS

MARINE SALES AND SERVICE
 701 WEST HUDSON ROAD
 ROGERS, ARKANSAS

MCE McCLELLAND CONSULTING ENGINEERS, INC.
 1580 E STEARNS ST
 FAYETTEVILLE, ARKANSAS 72703
 (479) 443-2377
 HTTP://WWW.MCE.US.COM

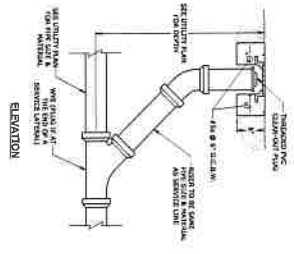
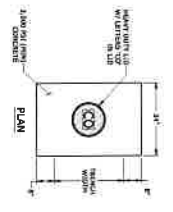
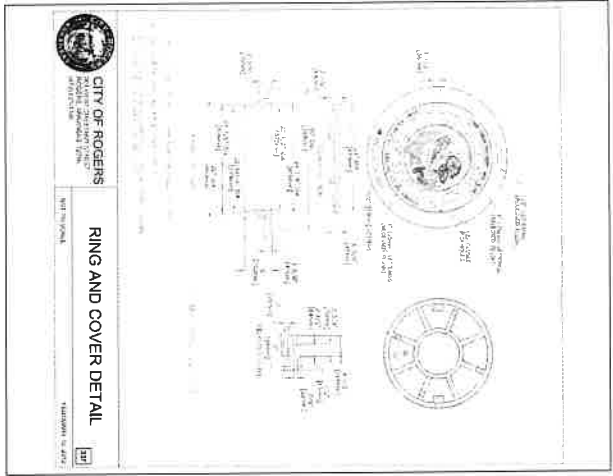

41J SANITARY SEWER CLEAN-OUT



CE 8.6

DETAIL SHEET VII

REVISIONS		
REV	DATE	DESCRIPTION



MARINE SALES AND SERVICE
 701 WEST HUDSON ROAD
 ROGERS, ARKANSAS

INSURANCE
 CONTRACT NO.
 CANCELATION FEE

MCE McCLELLAND CONSULTING ENGINEERS, INC.
 1580 E STEARNS ST
 FAYETTEVILLE, ARKANSAS 72703
 (479) 443-2377
 HTTP://WWW.MCE.US.COM

SEE MATERIAL SPECIFICATIONS FOR APPROVED MANUFACTURERS

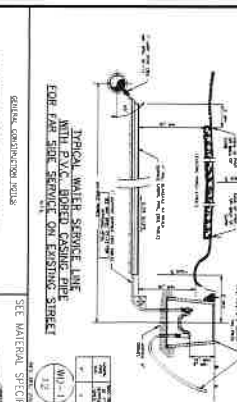
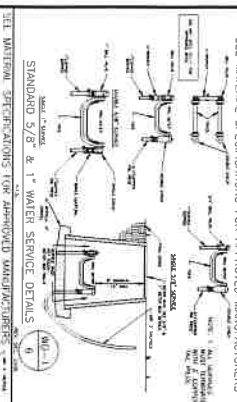
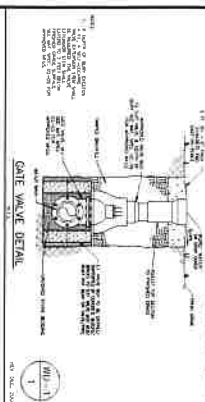
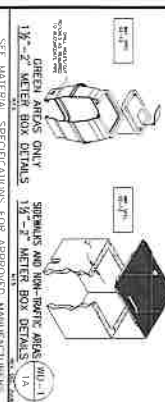

SEE MATERIAL SPECIFICATIONS FOR APPROVED MANUFACTURERS

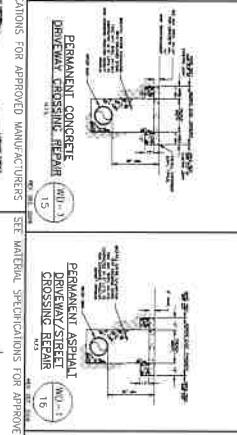
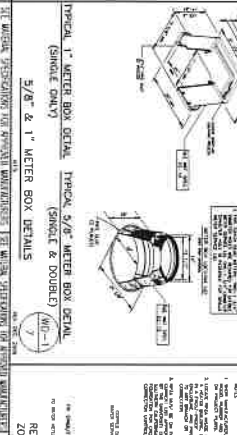
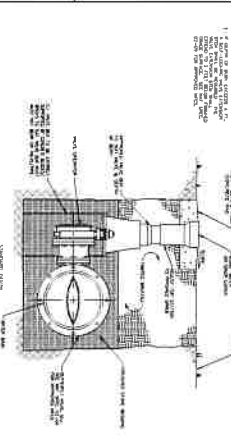

SEE MATERIAL SPECIFICATIONS FOR APPROVED MANUFACTURERS

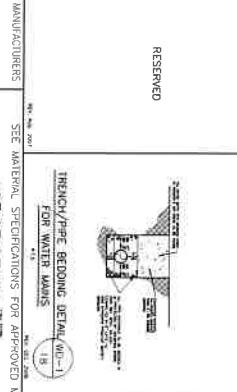
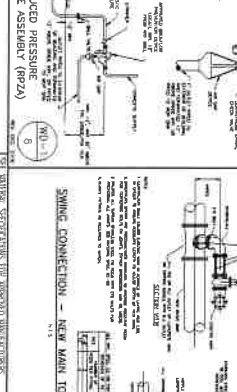
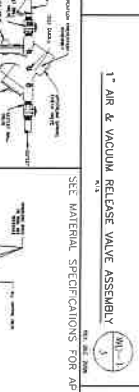
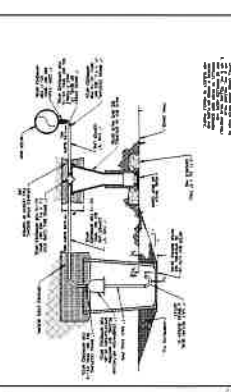

SEE MATERIAL SPECIFICATIONS FOR APPROVED MANUFACTURERS

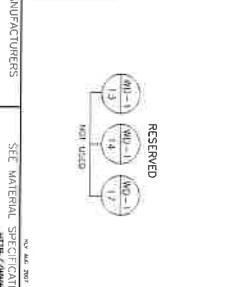
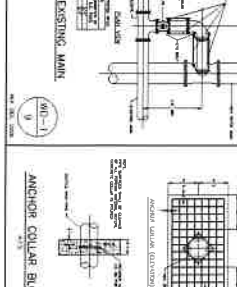
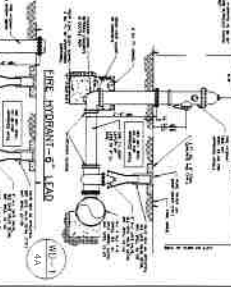

SEE MATERIAL SPECIFICATIONS FOR APPROVED MANUFACTURERS

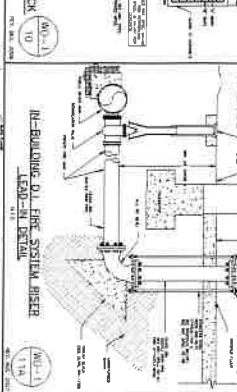
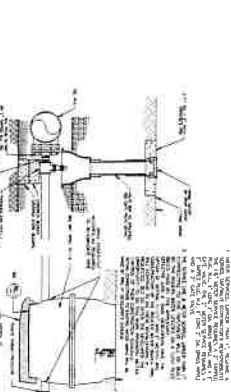

GENERAL CONSTRUCTION NOTES: 1. All work shall be in accordance with the approved plans and specifications. 2. All materials shall be of the highest quality and shall be approved by the Engineer. 3. All work shall be done in accordance with the approved plans and specifications. 4. All work shall be done in accordance with the approved plans and specifications. 5. All work shall be done in accordance with the approved plans and specifications. 6. All work shall be done in accordance with the approved plans and specifications. 7. All work shall be done in accordance with the approved plans and specifications. 8. All work shall be done in accordance with the approved plans and specifications. 9. All work shall be done in accordance with the approved plans and specifications. 10. All work shall be done in accordance with the approved plans and specifications.

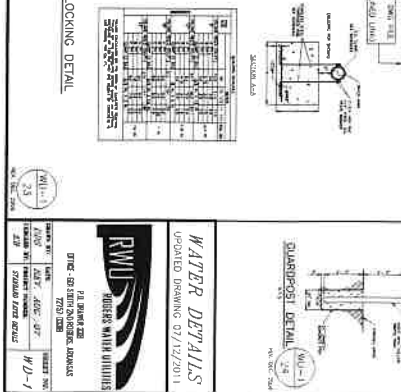
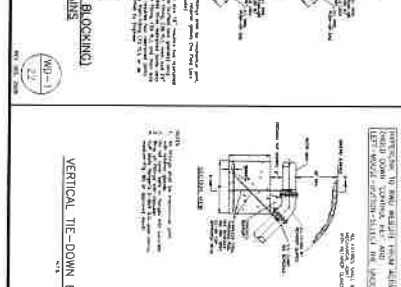
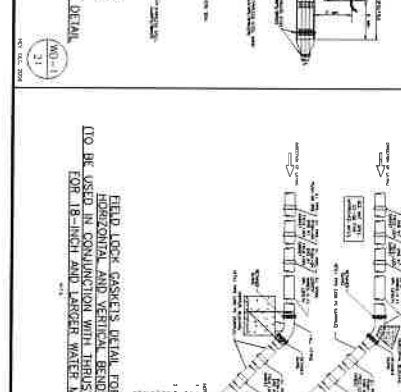
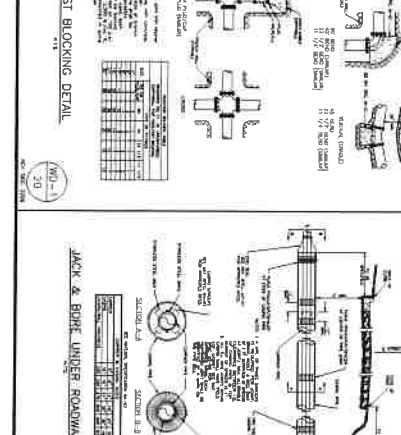

RESERVED



SEE MATERIAL SPECIFICATIONS FOR APPROVED MANUFACTURERS

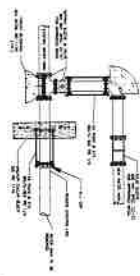

CUT AND CAP DETAIL #1



RESERVED



SEE MATERIAL SPECIFICATIONS FOR APPROVED MANUFACTURERS

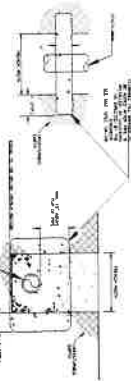

ANTI-SEEPAGE BARRIER COLUMN



SEE MATERIAL SPECIFICATIONS FOR APPROVED MANUFACTURERS

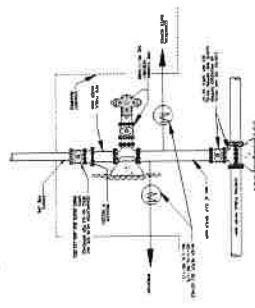

COMMERCIAL, APPROVAL AND FIRE LINE CONNECTION DETAIL



SEE MATERIAL SPECIFICATIONS FOR APPROVED MANUFACTURERS

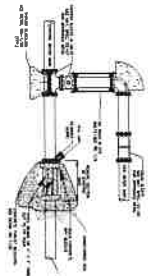

CUT AND CAP DETAIL #2
SHO-BLOCK



SEE MATERIAL SPECIFICATIONS FOR APPROVED MANUFACTURERS

RESERVED



SEE MATERIAL SPECIFICATIONS FOR APPROVED MANUFACTURERS

RESERVED



SEE MATERIAL SPECIFICATIONS FOR APPROVED MANUFACTURERS

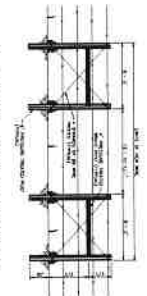

CROSSING REPAIR DETAIL



SEE MATERIAL SPECIFICATIONS FOR APPROVED MANUFACTURERS



END-OF-LINE/PHASE LINE
FIRE HYDRANT DETAIL
12" & 12" MAINS



SEE MATERIAL SPECIFICATIONS FOR APPROVED MANUFACTURERS

RESERVED



SEE MATERIAL SPECIFICATIONS FOR APPROVED MANUFACTURERS

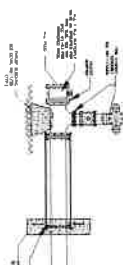

END-OF-LINE/PHASE LINE
FIRE HYDRANT DETAIL
MANS LARGER THAN 12"



SEE MATERIAL SPECIFICATIONS FOR APPROVED MANUFACTURERS

RESERVED



SEE MATERIAL SPECIFICATIONS FOR APPROVED MANUFACTURERS



SEE MATERIAL SPECIFICATIONS FOR APPROVED MANUFACTURERS



SEE MATERIAL SPECIFICATIONS FOR APPROVED MANUFACTURERS



SEE MATERIAL SPECIFICATIONS FOR APPROVED MANUFACTURERS

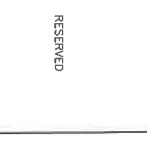

RESERVED



METER SIZE	TYPE/STROKE	CONNECTION TO MAIN	INSTALLATION APPROX. SIZE	SOURCE
5/8" (400 GPM)	1" COMP. STOP COUPLER	1" COMP. STOP	1" COMP. STOP	SEE STANDARD SPEC. Q2.10
1" (600 GPM)	1" COMP. STOP	1" COMP. STOP	1" COMP. STOP	SEE STANDARD SPEC. Q2.10
1 1/2" (1000 GPM)	2" TAPPING SHOULDER AND VALVE	2" TAPPING SHOULDER AND VALVE	2" TAPPING SHOULDER AND VALVE	SEE STANDARD SPEC. Q2.10
2" (1600 GPM)	2" TAPPING SHOULDER AND VALVE	2" TAPPING SHOULDER AND VALVE	2" TAPPING SHOULDER AND VALVE	SEE STANDARD SPEC. Q2.10
3" (2500 GPM)	3" TAPPING SHOULDER AND VALVE	3" TAPPING SHOULDER AND VALVE	3" TAPPING SHOULDER AND VALVE	SEE STANDARD SPEC. Q2.10
4" (3500 GPM)	4" TAPPING SHOULDER AND VALVE	4" TAPPING SHOULDER AND VALVE	4" TAPPING SHOULDER AND VALVE	SEE STANDARD SPEC. Q2.10
6" (5500 GPM)	6" TAPPING SHOULDER AND VALVE	6" TAPPING SHOULDER AND VALVE	6" TAPPING SHOULDER AND VALVE	SEE STANDARD SPEC. Q2.10
8" (7500 GPM)	8" TAPPING SHOULDER AND VALVE	8" TAPPING SHOULDER AND VALVE	8" TAPPING SHOULDER AND VALVE	SEE STANDARD SPEC. Q2.10

NOTE: CONNECTIONS TO MAIN SHALL BE MADE BY THE CONTRACTOR. CONNECTIONS TO THE EXISTING MAINS ARE TO BE MADE BY THE CONTRACTOR. SEE STANDARD SPEC. Q2.10 FOR DETAILS.



RWLS
RIVERSIDE WATER UTILITIES

210 BROADWAY
SUITE 200
RIVERSIDE, CA 92501
TEL: 951-514-1000
WWW.RWLS.COM

DATE: 07/17/2011
DRAWN BY: J. L. JONES
CHECKED BY: J. L. JONES
PROJECT NO: 07/17/2011