

RETAIL/FLEX FOR SALE OR LEASE

PLEASANT VIEW PARK

385 West 2700 North • Pleasant View, Utah 84414

Property Highlights

- Retail/Flex Spaces Available (see page 2)
- 1,538 SF Drive-Thru Available Immediately
-Call For Pricing
- Flex/Retail Condos Available for Purchase on
Pads B, D, and E - Pricing \$375 PSF
- Visibility/Access From 2700 North
- Delivery Date: 8 Months Following PSA Execution



TANNER OLSON

801.930.6752

tolson@legendcommercial.com

JOE MILLS

801.930.6755

jmills@legendcommercial.com

CHLOE CYPERS

801.644.6299

ccypers@legendcommercial.com

801.930.6750
www.legendcommercial.com

2180 S 1300 E, Suite 240 | Salt Lake City, UT 84106

PARTNER **XTEAM**
RETAIL ADVISORS



LEGEND
COMMERCIAL

PLEASANT VIEW PARK

385 West 2700 North • Pleasant View, Utah 84414

SPACE	AVAILABLE SIZE	PRICING
BUILDING B	1,538 SF w/Drive-Thru	Call Agent
BUILDING D	Up to 6,200 SF	Call Agent
BUILDING E	Up to 9,600 SF	Call Agent
FUTURE BUILDING	40,517 SF (Completion TBD)	Call Agent
NNNs		\$4.75 PSF

DEMOGRAPHICS

	1 MILE	3 MILE	5 MILE
2025 POPULATION	8,258	57,639	96,342
2030 PROJECTED POPULATION	8,513	59,551	99,711
2025 HOUSEHOLDS	2,844	19,153	32,889
2025 AVG HH INCOME	\$124,788	\$127,120	\$115,649
2025 BUSINESSES	155	1,198	2,173
2025 DAYTIME POPULATION	843	11,257	23,376

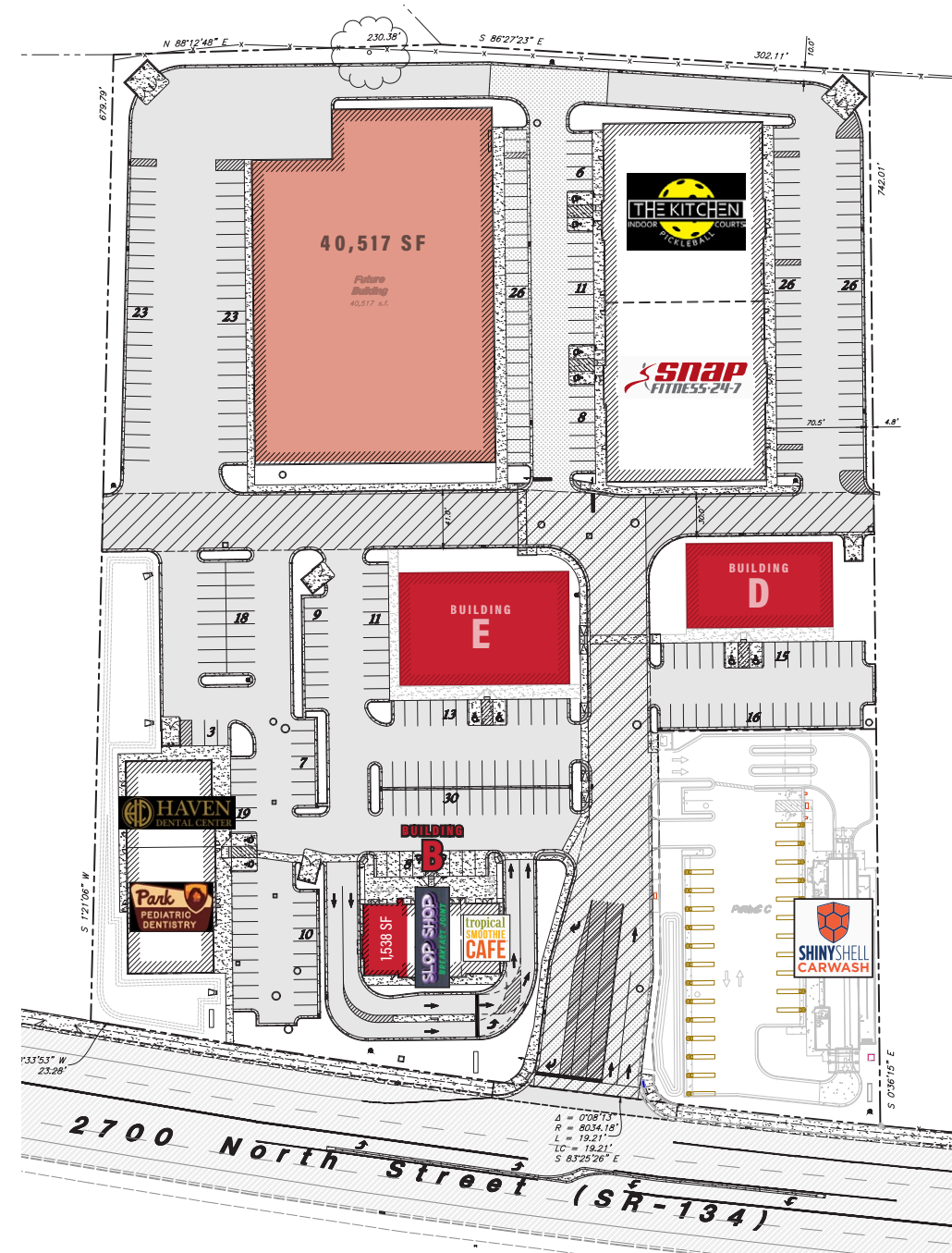

TANNER OLSON
801.930.6752
 tolson@legendcommercial.com

JOE MILLS
801.930.6755
 jmills@legendcommercial.com

CHLOE CYPERS
801.644.6299
 ccypers@legendcommercial.com

801.930.6750
www.legendcommercial.com
 2180 S 1300 E, Suite 240 | Salt Lake City, UT 84106

PARTNER XTEAM
 RETAIL ADVISORS

LEGEND
 COMMERCIAL

PLEASANT VIEW PARK

385 West 2700 North • Pleasant View, Utah 84414



TANNER OLSON
801.930.6752
tolson@legendcommercial.com

JOE MILLS
801.930.6755
jmills@legendcommercial.com

CHLOE CYPERS
801.644.6299
ccypers@legendcommercial.com

801.930.6750
www.legendcommercial.com
2180 S 1300 E, Suite 240 | Salt Lake City, UT 84106

PARTNER XTEAM
RETAIL ADVISORS



[illegible]

page-4