

AVAILABLE FOR LEASE

44235

NOBEL DRIVE

FREMONT, CA

Rare ±**34,543 SF**

Industrial End Cap

w/ ±**2.25 Acre** Yard/Parking Area



**New Market Ready
Work Underway!**

YOUR NAME HERE

NEWMARK

Owned and Operated by:



Sagard

510.300.0212 // mike.spiro@nmrk.com

CA RE Lic #01433395

MIKE SPIRO

PROJECT HIGHLIGHTS

-  ±34,543 SF Industrial End Cap
-  ±2.25 Acres Secure Rear Yard / Parking Area
-  Five (5) Dock Doors
-  One (1) Grade Level Door
-  28' Clear Height
-  ±3,610 SF of Brand New Offices
-  Potential for up to 2,000 Amps @ 277/480 Volt Power (Tenant to Confirm)

-  High Impact Lobby Area
-  3.85/1,000 SF Parking Ratio
-  AT&T High-Speed Fiber Connectivity
-  Prime Auto Mall location within walking distance of Pacific Commons retail, restaurants, & shopping
-  Available Now
-  **Lease Rate: \$1.85/SF NNN**



MARKET-READY FLOOR PLAN



- GRADE LEVEL DOOR
- ▲ DOCK HIGH DOOR

NEW MARK

NOBEL DRIVE

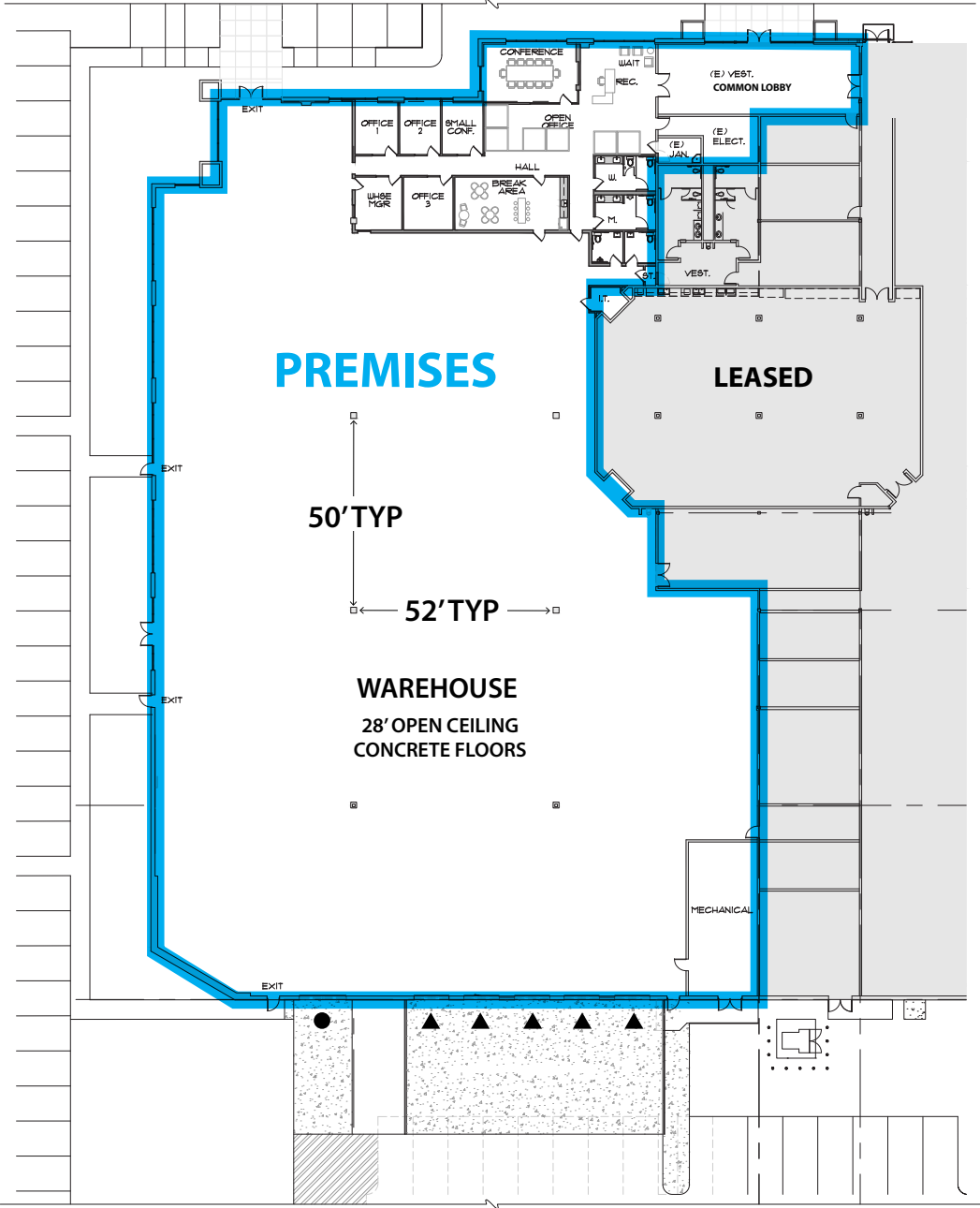

4 4 2 3 5 NOBEL DRIVE \ \ FREMONT

Rare ±2.25 Acre Secure Rear Yard / Parking Area



EXISTING GATE

GRADE DOOR

DOCK DOORS

PREMISES

EXISTING GATE

LOCATION MAP

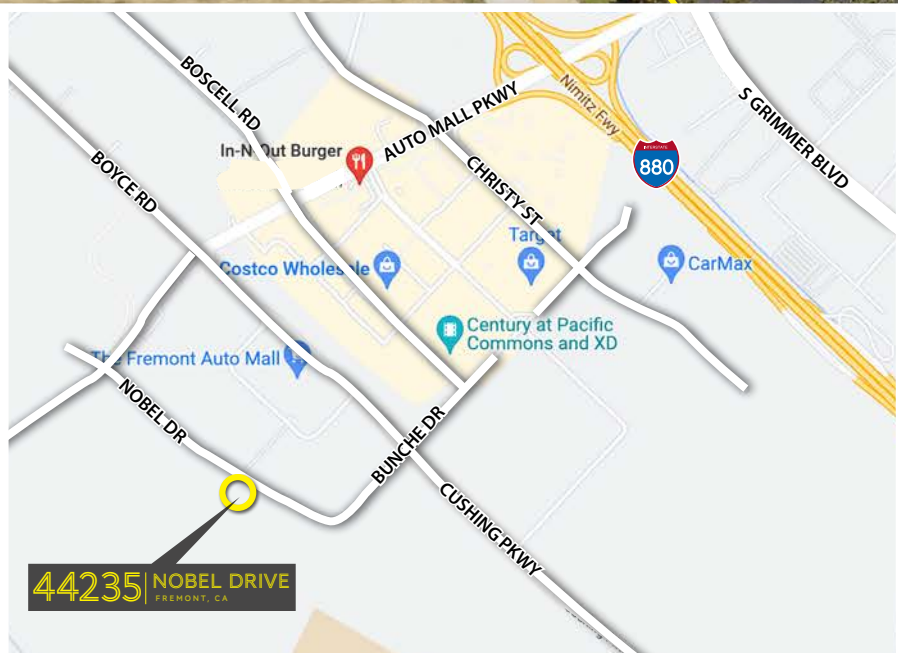

44235 NOBEL DRIVE
FREMONT, CA

44235 NOBEL DRIVE \ \ FREMONT

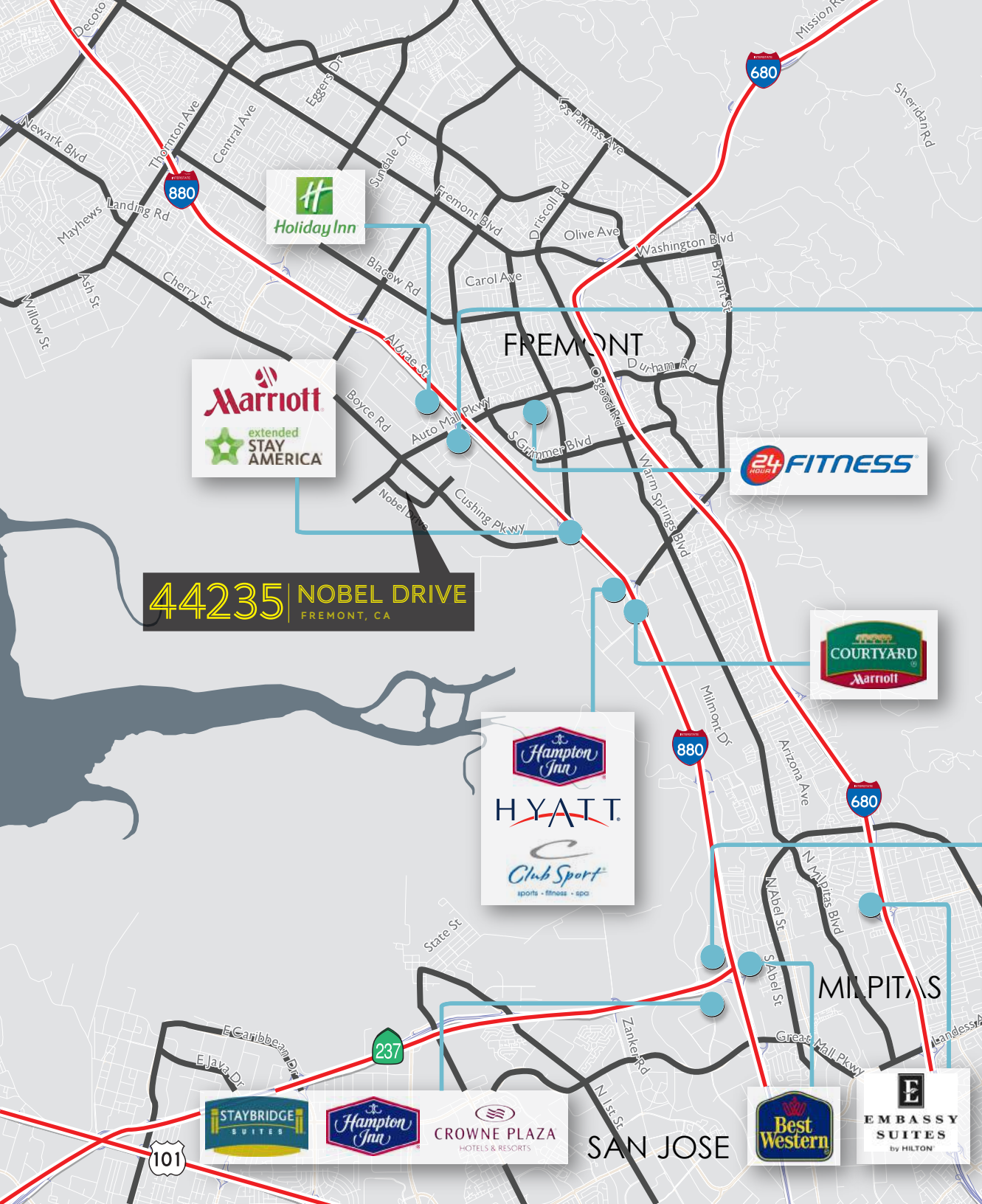

44235 NOBEL DRIVE
FREMONT, CA

4 4 2 3 5 NOBEL DRIVE \ \ FREMONT

AVAILABLE FOR LEASE



44235
NOBEL DRIVE
FREMONT, CA

NEWMARK

Owned and Operated by:  **Sagard**

MIKE SPIRO
510.300.0212 // mike.spiro@nrmk.com
CA RE Lic #01433395

The distributor of this communication is performing acts for which a real estate license is required. The information contained herein has been obtained from sources deemed reliable but has not been verified and no guarantee, warranty or representation, either express or implied, is made with respect to such information. Terms of sale or lease and availability are subject to change or withdrawal without notice. 22-0485.08/01