



BERKSHIRE HATHAWAY
HomeServices
Georgia Properties

COMMERCIAL DIVISION

FOR LEASE

**13,000+ s.f office / warehouse /
distribution
Central mid-town location**

REDUCED



520 C Maple St., Gainesville GA

Marketed By:

Brent Hoffman

Berkshire Hathaway Home Services GA Properties
500 Jesse Jewell Pkwy., SE Suite 300
Gainesville, GA 30501
Direct- 770-533-6721
Office – 770-536-3007
Brent@BrentHoffman
www.BrentHoffman.com





BERKSHIRE HATHAWAY
HomeServices
Georgia Properties

COMMERCIAL DIVISION

Property Information

JUST REDUCED

\$8,287 per month

\$7.67 psf



- ◆ **Highest & best use is warehouse**
- ◆ 13,000+ s.f. divided as 2,000 s.f. office & 11,000 s.f. warehouse
- ◆ **NOT retail space-limited parking**
4-5 spaces at loading dock and street parking available
- ◆ 3 offices, large open work area & storage w/ garage door
- ◆ Warehouse is air-conditioned
- ◆ Bathroom w/shower
- ◆ Tall ceilings-up to 20' 9"
- ◆ 3-phase 220 amp electric
- ◆ Massive covered loading docks w/ (2) 7'10 x 8' doors
- ◆ Zoned light industrial
- ◆ Newer roof & lights
- ◆ Landlord pays property taxes & insurance / Tenant all utilities
- [Federal Opportunity Zone](#) — Click for info
- Personal Guarantee Required

[520-C Maple Street \(brenthoffman.com\)](https://www.brenthoffman.com)



All materials furnished is from sources deemed reliable, but information has not been verified and is subject to errors or omissions



All materials furnished is from sources deemed reliable, but information has not been verified and is subject to errors or omissions

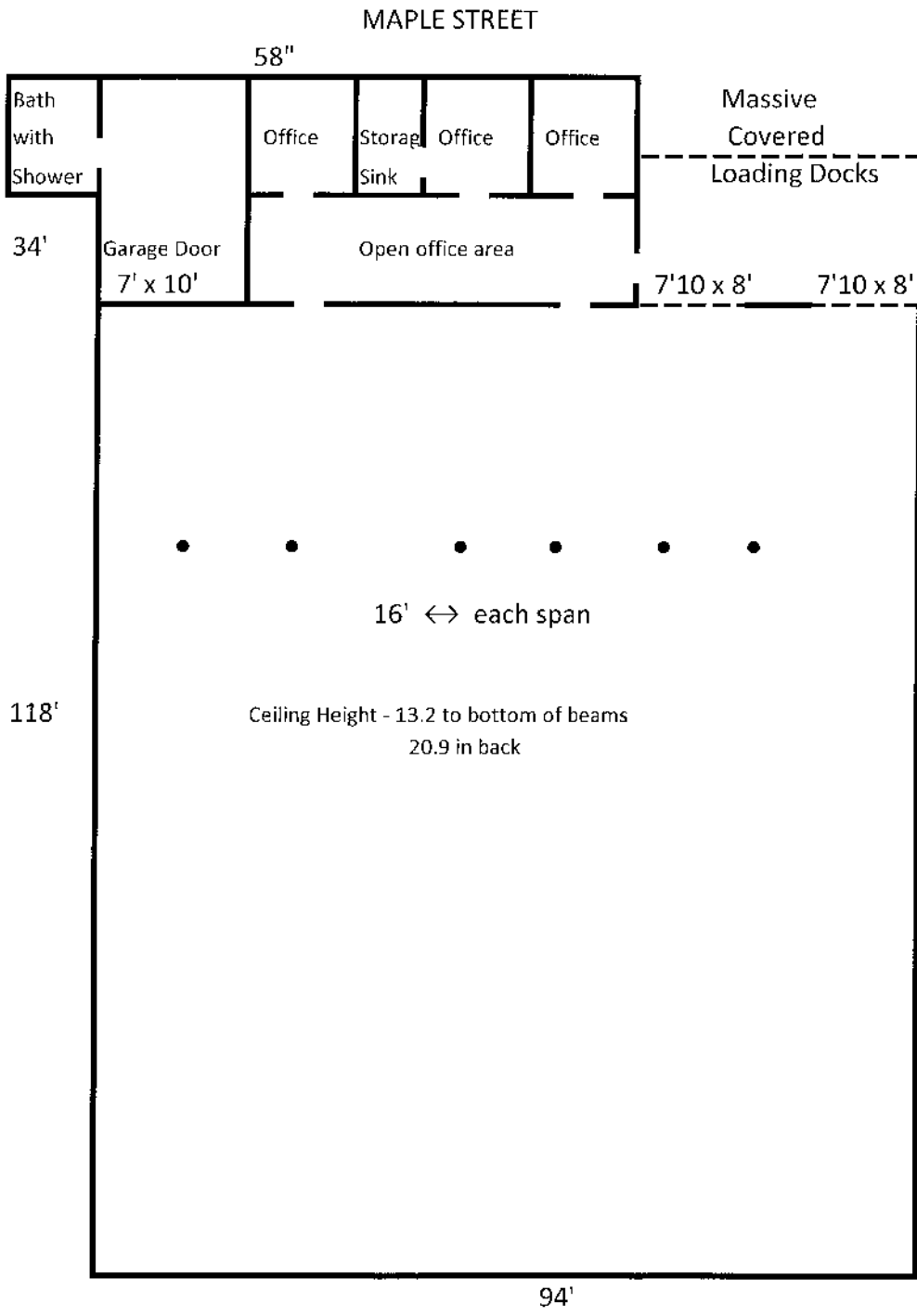

520 C Maple Street
13,000+ s.f. office/warehouse/Mix Use



BERKSHIRE HATHAWAY
HomeServices
Georgia Properties

COMMERCIAL DIVISION

Location Map



Take I-985 North to exit 20 Queen City Pkwy/ Hwy 60 towards Gainesville, approx. 2 miles. Right onto Jesse Jewell Pkwy at light. Right on Maple St. property on right.

Easy drive N from Atlanta
Convenient to Gainesville,
Lake Lanier, GA

