

COMMERCIAL STORAGE YARD FOR LEASE

Zoned Light Industrial



24 hour electric gate

4028 Santa Rosa Avenue, Santa Rosa, CA 95407

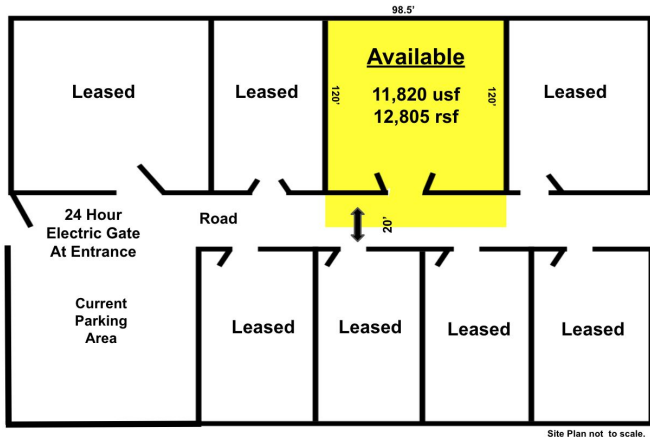

- 11,820 usable sf (.27 +/- acres)
- 12,805 rentable sf (.29 +/- acres)
- Gated, fenced, compacted gravel
- Power and water available
- Great freeway access north and south
- Directly across from Friedman's Home Improvement Center
- Storage only; perfect for equipment, vehicles, and materials

Rate:

16 cents per rentable sf p/month
\$2048.80 per month

JOE PHEFFER, CCIM
 Broker | Owner
 CA DRE Licence No. 00763172

SOLID PROPERTIES
 4795 B Old Redwood Hwy Santa Rosa, CA. 95403
 Office: 707-526-7277 Cell: 707-481-1488
solidproperties@comcast.net solidpropertiesonline.com

