

NORTHWEST COMMERCE CENTER

3747 & 3749 SILVER STAR RD
ORLANDO, FL 32808



HANOVER
Capital Partners, LLC
Real Estate Development/Investments

FOUNDRY
COMMERCIAL



PROPERTY FEATURES

- 2,000–4,000 SF bays
- Grade-level rear loading
- Dual-entry truck court allows convenient one-way flow in and out
- Excellent frontage and signage opportunity along high-traffic Silver Star Road
- New LED warehouse lighting
- Newly renovated office flooring
- 3-phase, 200-amp power per bay
- 14–16 ft clear heights
- Flexible lease terms
- 3/1,000 SF parking ratio
- Six access points to the park



FOR MORE INFORMATION, PLEASE CONTACT:

JOHN PIETKIEWICZ | 407.619.7342
Partner
john.pietkiewicz@foundrycommercial.com
Licensed Real Estate Broker

TRAVIS HAMMOND | 407.401.1707
Vice President
travis.hammond@foundrycommercial.com
Licensed Real Estate Broker

FOUNDRY
COMMERCIAL

foundrycommercial.com

Although the information contained herein was provided by sources believed to be reliable, Foundry Commercial makes no representation, expressed or implied, as to its accuracy and said information is subject to errors, omissions or changes.

LOCATION



FOR MORE INFORMATION, PLEASE CONTACT:

JOHN PIETKIEWICZ | 407.619.7342
Partner
john.pietkiewicz@foundrycommercial.com
Licensed Real Estate Broker

TRAVIS HAMMOND | 407.401.1707
Vice President
travis.hammond@foundrycommercial.com
Licensed Real Estate Broker

FOUNDRY
COMMERCIAL

foundrycommercial.com

Although the information contained herein was provided by sources believed to be reliable, Foundry Commercial makes no representation, expressed or implied, as to its accuracy and said information is subject to errors, omissions or changes.

FLOOR PLAN

3747 Silver Star Rd

4,000 SF Available

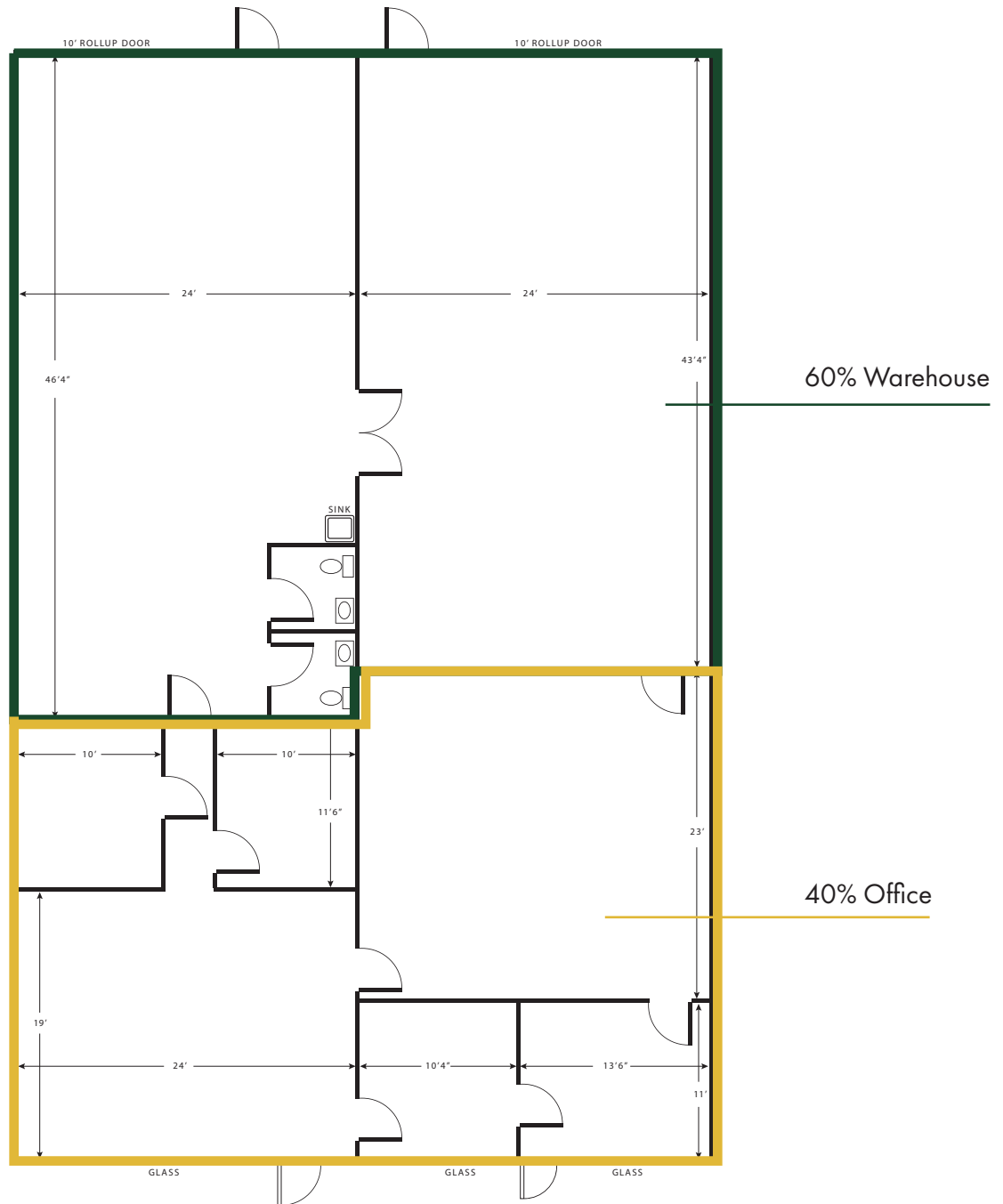

FOR MORE INFORMATION, PLEASE CONTACT:

JOHN PIETKIEWICZ | 407.619.7342
Partner
john.pietkiewicz@foundrycommercial.com
Licensed Real Estate Broker

TRAVIS HAMMOND | 407.401.1707
Vice President
travis.hammond@foundrycommercial.com
Licensed Real Estate Broker

FOUNDRY
COMMERCIAL

foundrycommercial.com

Although the information contained herein was provided by sources believed to be reliable, Foundry Commercial makes no representation, expressed or implied, as to its accuracy and said information is subject to errors, omissions or changes.

FLOOR PLAN

3749 Silver Star Rd

4,000 SF Available

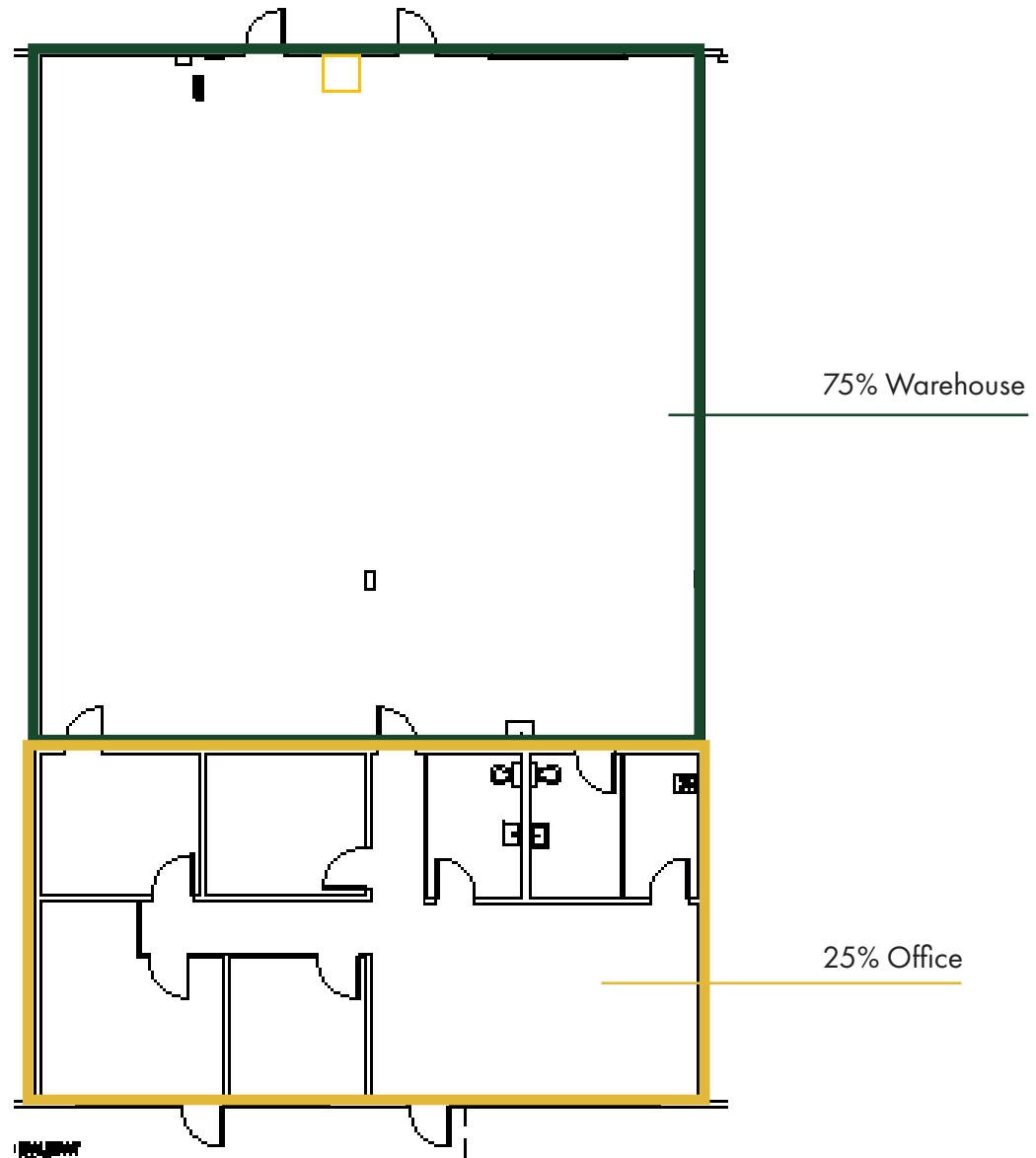

FOR MORE INFORMATION, PLEASE CONTACT:

JOHN PIETKIEWICZ | 407.619.7342
Partner
john.pietkiewicz@foundrycommercial.com
Licensed Real Estate Broker

TRAVIS HAMMOND | 407.401.1707
Vice President
travis.hammond@foundrycommercial.com
Licensed Real Estate Broker

FOUNDRY
COMMERCIAL

foundrycommercial.com

Although the information contained herein was provided by sources believed to be reliable, Foundry Commercial makes no representation, expressed or implied, as to its accuracy and said information is subject to errors, omissions or changes.

FLOOR PLAN

3747 & 3749 Silver Star Rd

Can be combined to be 8,000 SF Available

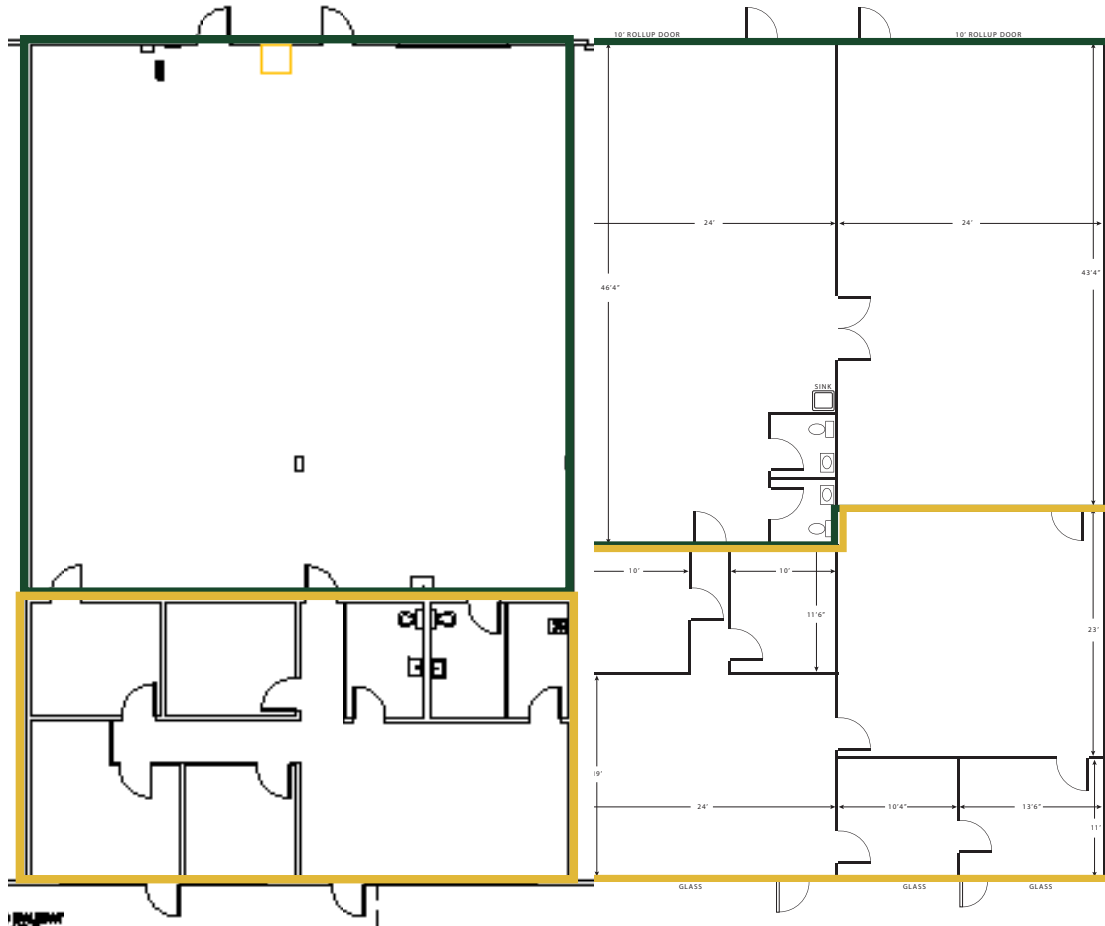

FOR MORE INFORMATION, PLEASE CONTACT:

JOHN PIETKIEWICZ | 407.619.7342
 Partner
john.pietkiewicz@foundrycommercial.com
 Licensed Real Estate Broker

TRAVIS HAMMOND | 407.401.1707
 Vice President
travis.hammond@foundrycommercial.com
 Licensed Real Estate Broker

FOUNDRY
 COMMERCIAL

foundrycommercial.com

Although the information contained herein was provided by sources believed to be reliable, Foundry Commercial makes no representation, expressed or implied, as to its accuracy and said information is subject to errors, omissions or changes.

PHOTOS



FOR MORE INFORMATION, PLEASE CONTACT:

JOHN PIETKIEWICZ | 407.619.7342
Partner
john.pietkiewicz@foundrycommercial.com
Licensed Real Estate Broker

TRAVIS HAMMOND | 407.401.1707
Vice President
travis.hammond@foundrycommercial.com
Licensed Real Estate Broker

FOUNDRY
COMMERCIAL

foundrycommercial.com

Although the information contained herein was provided by sources believed to be reliable, Foundry Commercial makes no representation, expressed or implied, as to its accuracy and said information is subject to errors, omissions or changes.