

138-10 Hillside Avenue

Jamaica, Queens

Ground Lease Sublease

Southeast Corner of Hillside Avenue and 138th Street



Jamaica - Van Wyck
E

- 1, 010,728 annual ridership
- 3,260 daily riders (weekday)
- 3,375 daily riders (weekend)

Sutphin Boulevard
F

- 882,617 annual ridership
- 2,834 daily riders (weekday)
- 2,977 daily riders (weekend)

Comments:

- Direct access to the Van Wyck Expressway, the major north / south highway dissecting Queens with approximately 160,000 VPD
- In close proximity to the Jamaica Long Island Railroad Station, Sutphin Boulevard Station servicing the F train, and Jamaica-Van Wyck Station servicing the E train

Lot Size:

15,922 sf

Frontage:

151' ft on Hillside Avenue
131' ft on 138th Street

Lease Expiration Date:

May 31, 2038

Asking Rent:

Upon Request

Neighboring Retailers:

- Dunkin'
- KFC
- Wendy's
- Starbucks
- Planet Fitness
- Honda
- Jamaica Hospital
- Toyota

Erin Grace

+1 212 812 5882

erin.grace@jll.com

Corey Zolcinski

+1 212 812 5707

corey.zolcinski@jll.com

Site Map

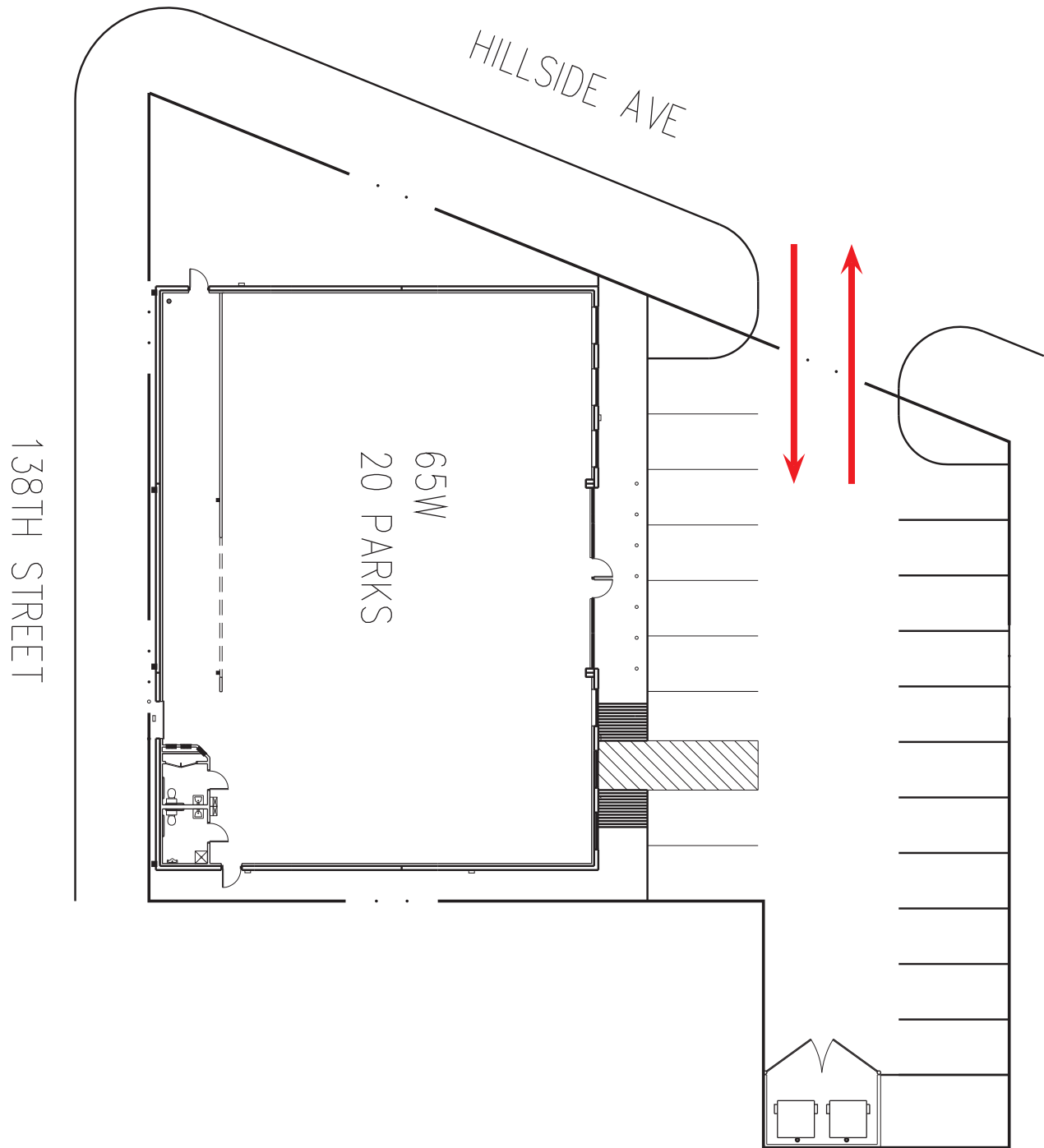

Jones Lang LaSalle Brokerage, Inc.
330 Madison Avenue New York, NY 10017

DISCLAIMER

Although information has been obtained from sources deemed reliable, neither Owner nor JLL makes any guarantees, warranties or representations, express or implied, as to the completeness or accuracy as to the information contained herein. Any projections, opinions, assumptions or estimates used are for example only. There may be differences between projected and actual results, and those differences may be material. The Property may be withdrawn without notice. Neither Owner nor JLL accepts any liability for any loss or damage suffered by any party resulting from reliance on this information. If the recipient of this information has signed a confidentiality agreement regarding this matter, this information is subject to the terms of that agreement. © 2026 Jones Lang LaSalle IP, Inc. All rights reserved.