

10346 COURTHOUSE ROAD

SPOTSYLVANIA, VA 22553

FOR SUBLEASE

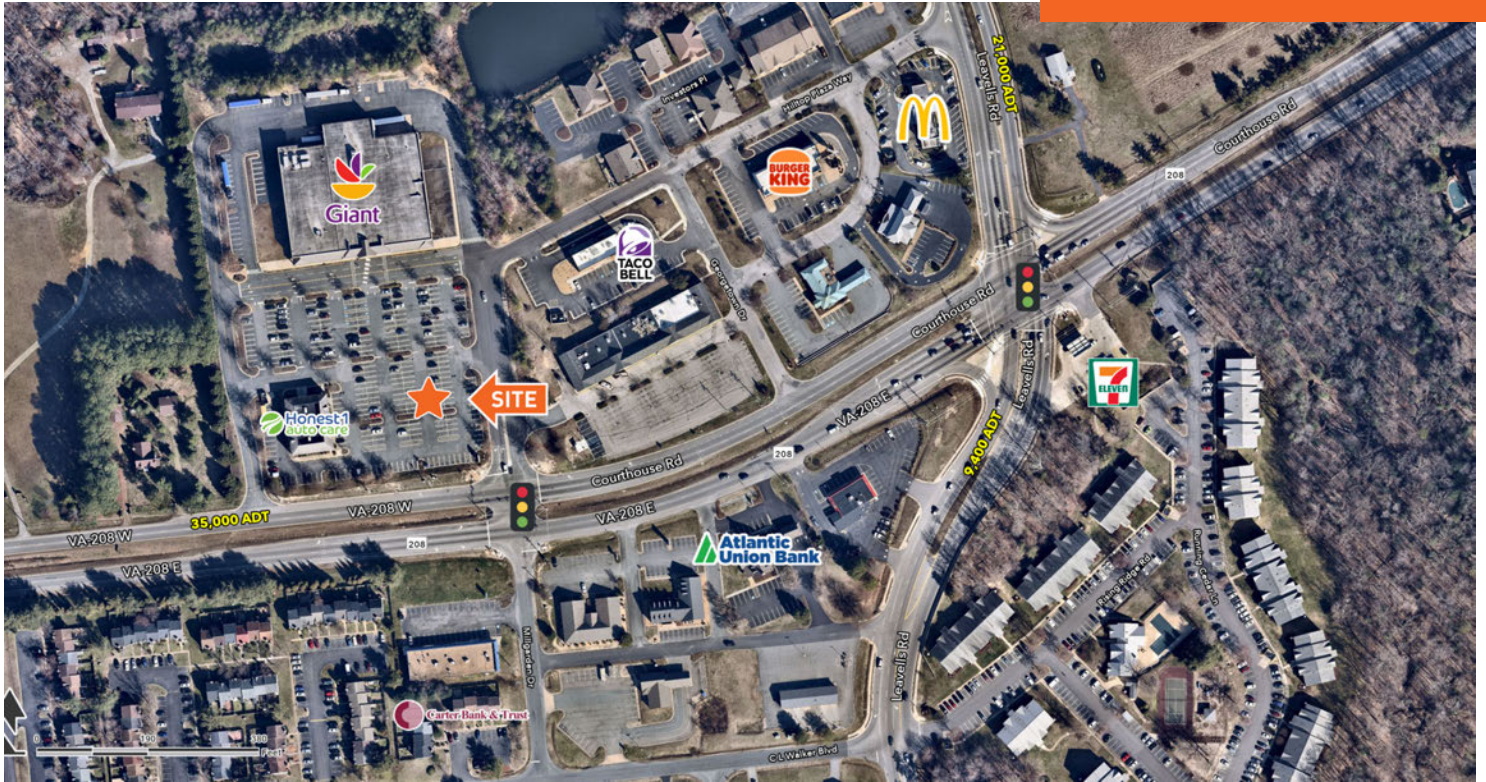

LOCATION DESCRIPTION

Located at Courthouse Road and Milgarden Drive in Spotsylvania, VA

PROPERTY HIGHLIGHTS

- +/- 2.1 Acre site
- Outparcel to successful Giant grocery store
- Full access at signalized intersection of Courthouse Road and Milgarden Drive
- Excellent visibility



 DEMOGRAPHICS	1 MILE	3 MILES	5 MILES
Total Households	3,288	21,516	40,150
Total Populatioin	8,721	59,465	111,353
Average HH Income	\$104,601	\$118,983	\$118,585

TSCG

DAVID ANDREWS, CCIM
david.andrews@tscg.com
804.673.1100

CHRISTINA MAYHUGH
christina.mayhugh@tscg.com
804.673.1100

10346 COURTHOUSE ROAD

SPOTSYLVANIA, VA 22553

FOR SUBLEASE

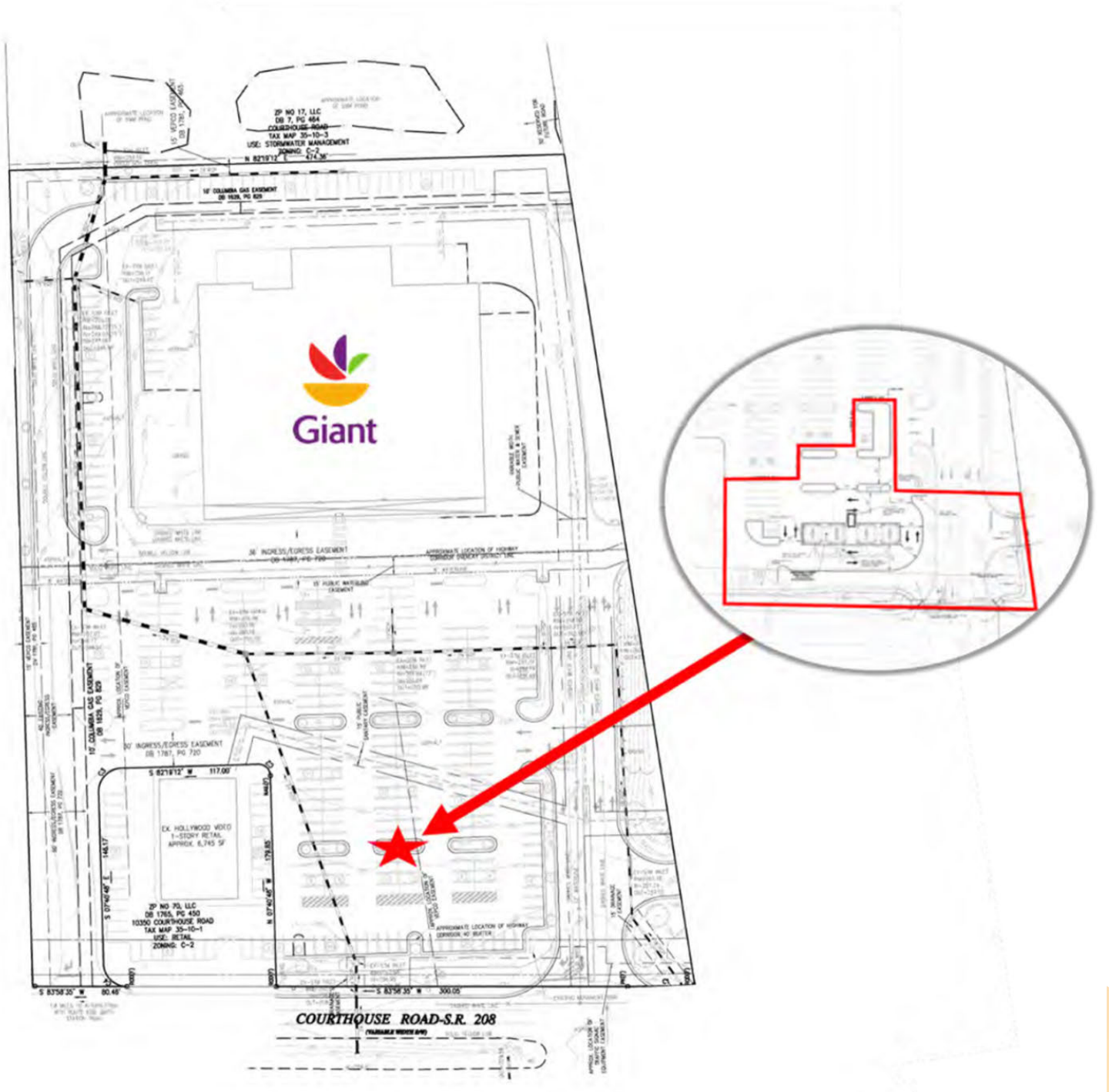

DAVID ANDREWS, CCIM
david.andrews@tscg.com
804.673.1100

CHRISTINA MAYHUGH
christina.mayhugh@tscg.com
804.673.1100