



BIG RIVER
REAL ESTATE

8,142 & 9,999 SF | FOR LEASE



OFFICE/WAREHOUSE SPACE

11501-11595 K-TEL DRIVE
MINNETONKA, MN 55343

Available Space

Suites 11503 & 11515

2,725 SF - Office
5,417 - Warehouse
8,142 SF - Total
One (1) Dock Door
Available Now

Suite 11535

1,323 SF - Office
8,676 - Warehouse
9,999 SF - Total
One (1) Dock Door
Available Now

Lease Rates

Market Rate - Office
Market Rate - Warehouse

Est. CAM/Tax

\$4.18 PSF

Property Highlights

- Central Minnetonka location with access to I-494, MN-7, and US-169
- 12' Clear Height
- 127,354 total building square feet



For information, please contact:

DAN FRIEDNER
Senior Managing Director
t 612-430-9991
dan.friedner@nrmk.com

JAY CHMIELESKI
Senior Managing Director
t 612-430-9982
jay.chmielecki@nrmk.com

PATRICK CULLEN
Associate Director
t 612-430-9995
patrick.cullen@nrmk.com

100 South Fifth St, Suite 2100
Minneapolis, MN 55402

nrmk.com

NEWMARK

The information contained herein has been obtained from sources deemed reliable but has not been verified and no guarantee, warranty or representation, either express or implied, is made with respect to such information. Terms of sale or lease and availability are subject to change or withdrawal without notice.



Floor Plan

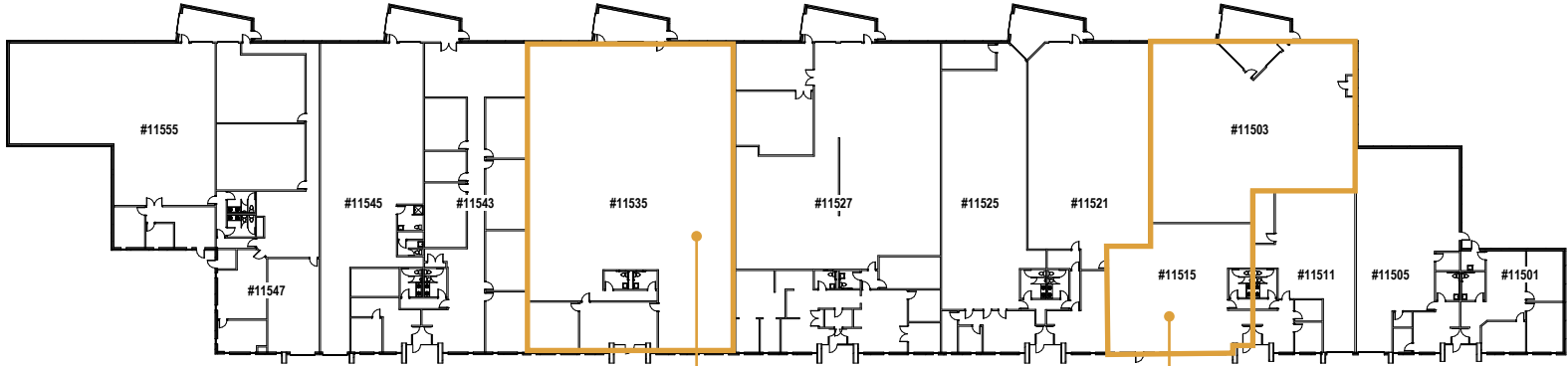

Suite 11535

1,323 SF - Office
8,676 - Warehouse
9,999 SF - Total
One (1) Dock Door

Suites 11503 & 11515

2,725 SF - Office
5,417 - Warehouse
8,142 SF - Total
One (1) Dock Door



For information, please contact:

DAN FRIEDNER
Senior Managing Director
t 612-430-9991
dan.friedner@nmrk.com

JAY CHMIELESKI
Senior Managing Director
t 612-430-9982
jay.chmielecki@nmrk.com

PATRICK CULLEN
Associate Director
t 612-430-9995
patrick.cullen@nmrk.com

100 South Fifth St, Suite 2100
Minneapolis, MN 55402

nmrk.com