

# Retail/Restaurant Space Available With Drive-Thru

**\$3,000.00 per month plus sales tax**  
(rent includes utilities, landscaping & property taxes)

**Property #37673 - 110 E. Bearss Avenue  
Tampa, Hillsborough County, Florida**

## Property Highlights

- Former Dunkin Donuts
- Unit Size – Approx. 1,000 sq. ft.
- Located inside a convenience store
- Unit shares utilities (including trash, water, electrical, HVAC), landscaping and restrooms (including cleaning and supplies) and property taxes with convenience store
- Year Built - 2006
- Located at a signalized intersection of North Florida Ave. & E. Bearss Ave.
- Good Access & Visibility
- Signage may include street, building, and directional signage

**Landlord will not allow the sale of donuts, pizza or chicken. Other restrictions may apply**



**Contact:**  
**Kimberly Shiver**  
352.415.4499 Ext. 2  
kim@intrepidcre.com

365 Citrus Tower Blvd., Suite 102, Clermont, FL 34711 - [www.intrepidcre.com](http://www.intrepidcre.com)

The information contained herein has been given to us by the owner of the property or other sources we deem reliable. We have no reason to doubt its accuracy, but do not guarantee it. All information should be verified before entering into an agreement.

# Current Layout of Space

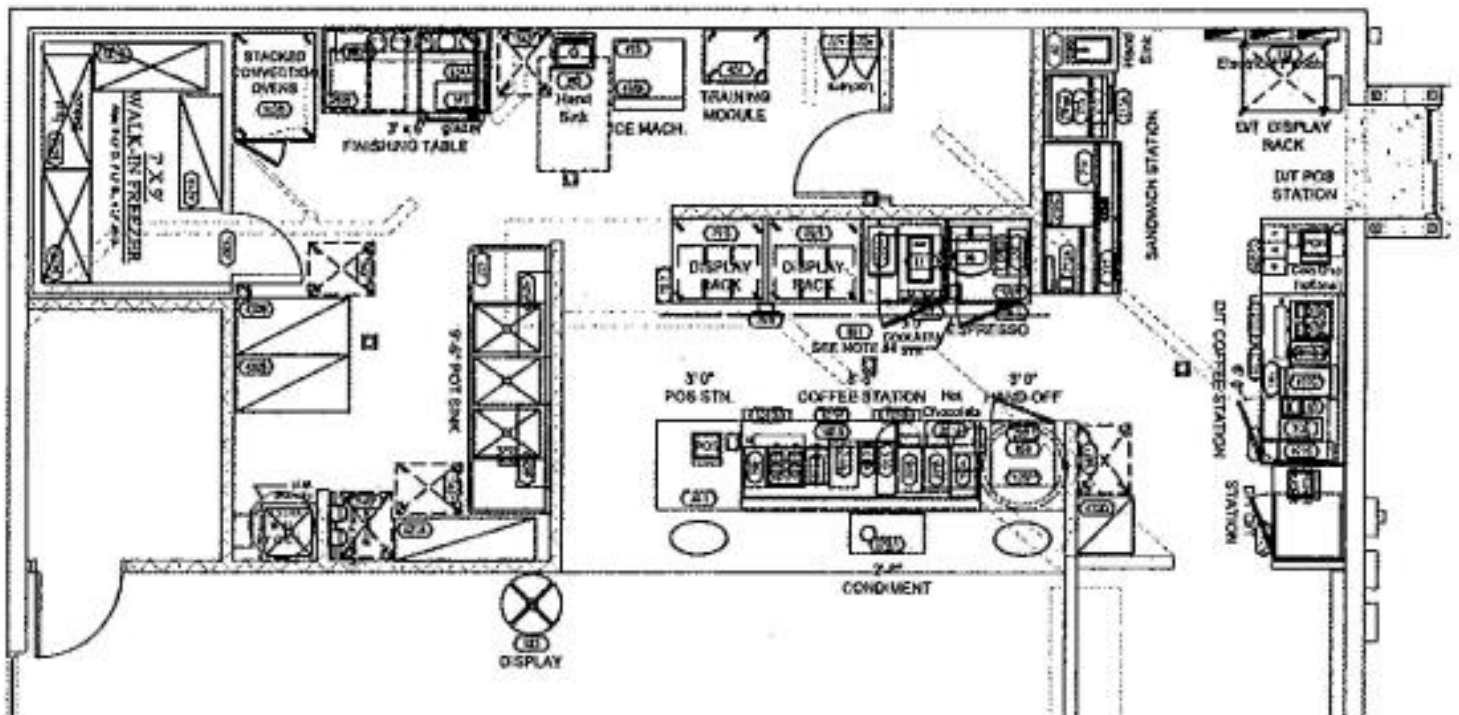

Contact:  
**Kimberly Shiver**  
352.415.4499 Ext. 2  
kim@intrepidcre.com

365 Citrus Tower Blvd., Suite 102, Clermont, FL 34711 - [www.intrepidcre.com](http://www.intrepidcre.com)

The information contained herein has been given to us by the owner of the property or other sources we deem reliable. We have no reason to doubt its accuracy, but do not guarantee it. All information should be verified before entering into an agreement.

# Interior & Exterior Photos



Contact:  
**Kimberly Shiver**  
352.415.4499 Ext. 2  
kim@intrepidcre.com

365 Citrus Tower Blvd., Suite 102, Clermont, FL 34711 - [www.intrepidcre.com](http://www.intrepidcre.com)

The information contained herein has been given to us by the owner of the property or other sources we deem reliable. We have no reason to doubt its accuracy, but do not guarantee it. All information should be verified before entering into an agreement.

# Overhead Aerial



Contact:  
**Kimberly Shiver**  
352.415.4499 Ext. 2  
kim@intrepidcre.com

365 Citrus Tower Blvd., Suite 102, Clermont, FL 34711 - [www.intrepidcre.com](http://www.intrepidcre.com)

The information contained herein has been given to us by the owner of the property or other sources we deem reliable. We have no reason to doubt its accuracy, but do not guarantee it. All information should be verified before entering into an agreement.

# Area Map

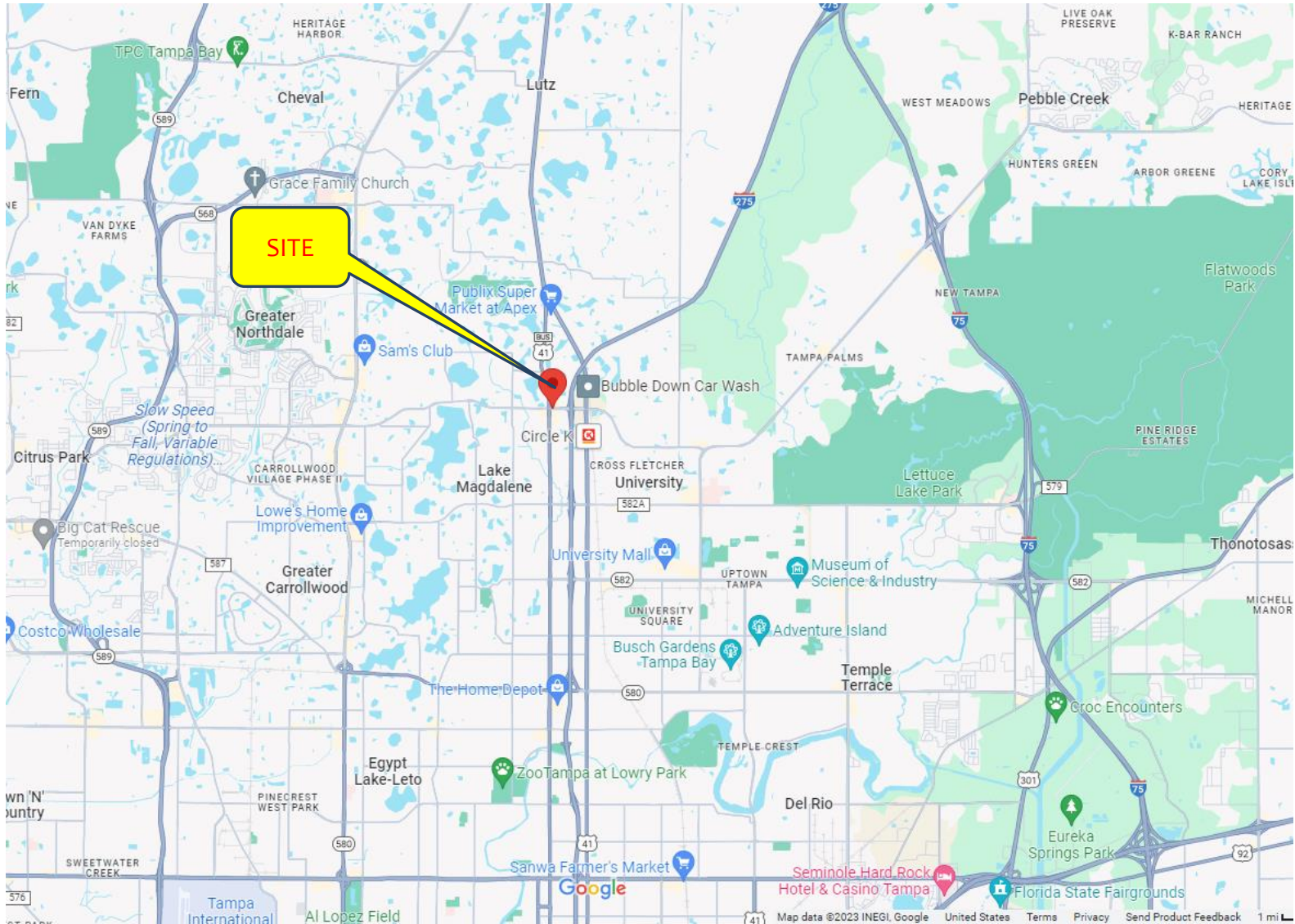

Contact:  
**Kimberly Shiver**  
352.415.4499 Ext. 2  
kim@intrepidcre.com

365 Citrus Tower Blvd., Suite 102, Clermont, FL 34711 - [www.intrepidcre.com](http://www.intrepidcre.com)

The information contained herein has been given to us by the owner of the property or other sources we deem reliable. We have no reason to doubt its accuracy, but do not guarantee it. All information should be verified before entering into an agreement.