

CIRCLE PLAZA |

7220 E. BROADWAY BLVD | TUCSON, AZ 85710



JUNIOR ANCHOR AND RETAIL/FLEX SHOP SPACE AVAILABLE FOR LEASE



6298 E. Grant Rd., Suite #100
Tucson, AZ 85712
P: 520.296.0200 / F: 520.296.1571
www.larsenbaker.com
Owner/Agent

Isaac Figueroa, CCIM, SIOR
Principal, Director of
Leasing and Sales
520.296.0200 x218
isaac@larsenbaker.com

Elaina Elliott
Leasing Associate
520.296.0200 x21
elaina@larsenbaker.com

Information contained herein has been obtained from the owner of the property or from other sources that we deem reliable. We have no reason to doubt its accuracy, but we do not guarantee it. George C. Larsen - Designated Broker - Owner/Agent.

AVAILABILITY

Junior Anchor: ±15,655 (former Grocery Store)

Lease Rate: \$16 PSF + NNN*

*NNN - \$4.50/sf

PROPERTY FEATURES

Parking: 5.00/1,000 SF

Zoning: C-2

PROPERTY HIGHLIGHTS

- This center is anchored by Natural Grocers. Other tenants include, Michael's, Burlington, Ross, Starbucks, Hooters, HomeGoods, Outlet, Lane Bryant, Freddy's Steakburgers, and Sketchers
- Abundant parking
- Great signage
- Located at one of the highest volume intersections in Tucson
- Located at a signalized intersection with great visibility & access
- Easy ingress & egress
- Premises located in front of the main drive aisle

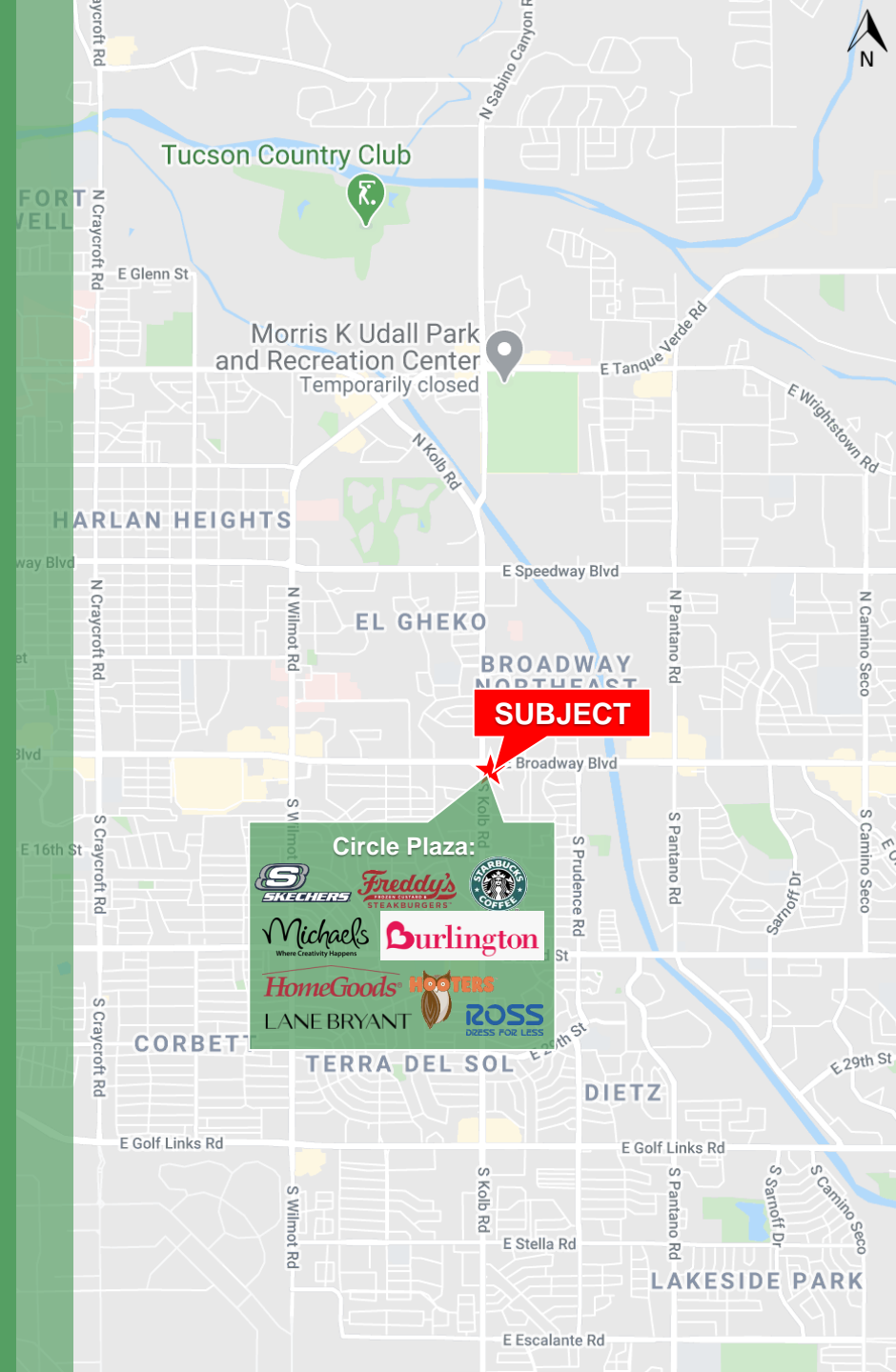

DEMOGRAPHICS (2020)

	1 Mile	3 Mile	5 Mile
Population	12,548	128,739	239,143
Average Family income	\$58,748	\$59,890	\$66,592
Employees	8,651	54,312	89,095
Total Retail Expenditures	\$405 Million	\$2.4 Billion	\$4.1 Billion

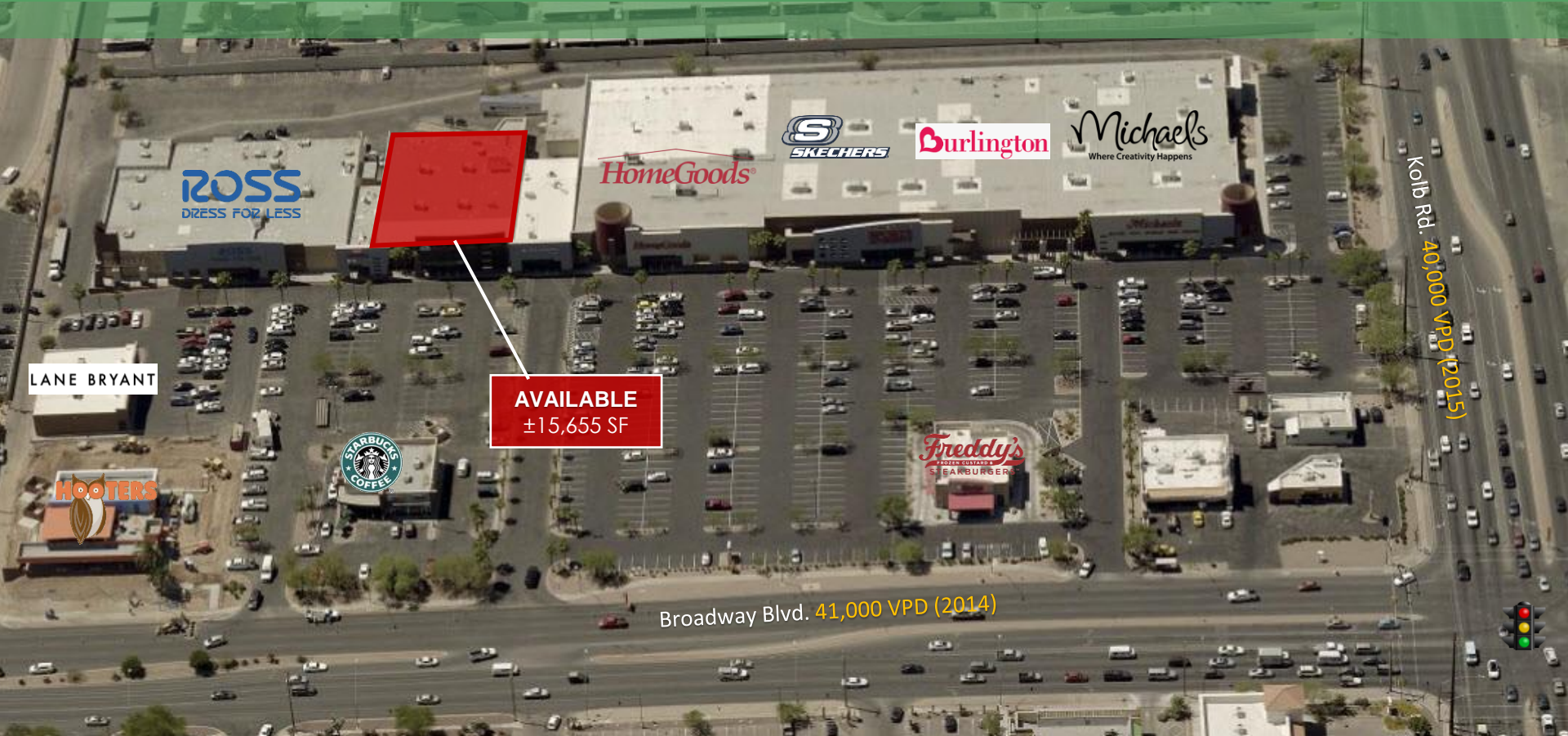

SITE PLAN

Tenant	Suite #	Size (SF)
Freddy's Steakburgers	7120	3,309
Brick by Brick Training	7140	1,811
Michaels	7150	31,416
Burlington	7160	21,580
Sketchers	7170	17,929
Home Goods	7170	29,000
National Vision	7204	5,091
AVAILABLE	7220	15,655
VIP Nails	7230	1,620
Ross Dress for Less	7250	27,750
Lane Bryant	7250	4,724
Starbucks	7200 #150	1,549
Liberty Tax	7250 #130	1,000
Oasis Health Hub	7200 #100	1,000
Hooters	PAD	5,200

