

**RETAIL**  
FOR LEASE

# **FLUSHING COMMONS**

38-08 UNION ST, FLUSHING, NY 11354



**PROJECT  
QUEENS**

# 1 SUMMARY



Located in Downtown Flushing, Flushing Commons is the neighborhood's newly built Flagship Development. It consists of 53,000 square feet of prime retail space, 164,000 square feet of prime medical and professional offices, a proposed 598 units of premium residences, 1,600 parking spaces and a 1.5 acre open air public plaza with outdoor cafes, restaurants and shops - A central gathering place, perfect for families and friends to meet and enjoy the community.

Flushing is a bustling multi-cultural neighborhood with a large Asian presence. It is a major commercial and retail area centered around the intersection of Main Street and Roosevelt Avenue which is the third-busiest intersection in New York City, behind Times Square and Herald Square. The Flushing Main St. 7 train subway station ranks among the top 10 most frequented subway stops in the entire New York City.

## BUILDING HIGHLIGHTS



TRANSPORTATION HUB



DENSE FOOT TRAFFIC



PREMIERE DEVELOPMENT

SOPHISTICATION IN DEAL MAKING.



**TRANSPORTATION**  
**MTA TRAIN & BUS LINES**

- ## LANDMARK LOCATIONS

- ## SOPHISTICATION IN DEAL MAKING.

### 3 SPACE



UNIT	NET SF	FLOOR	PRICE	FRONTAGE
B	3,266	Ground	Inquire	Corner 54' & 29'
E	1,852	Ground	Inquire	Corner 68' & 15'

#### ADDITIONAL INFORMATION

Delivery Condition: Grey box

Possession: Immediate

Parking: 1,600 space garage

Loading: 3,854 sf dock

SOPHISTICATION IN DEAL MAKING.



# 4 FLOOR PLAN

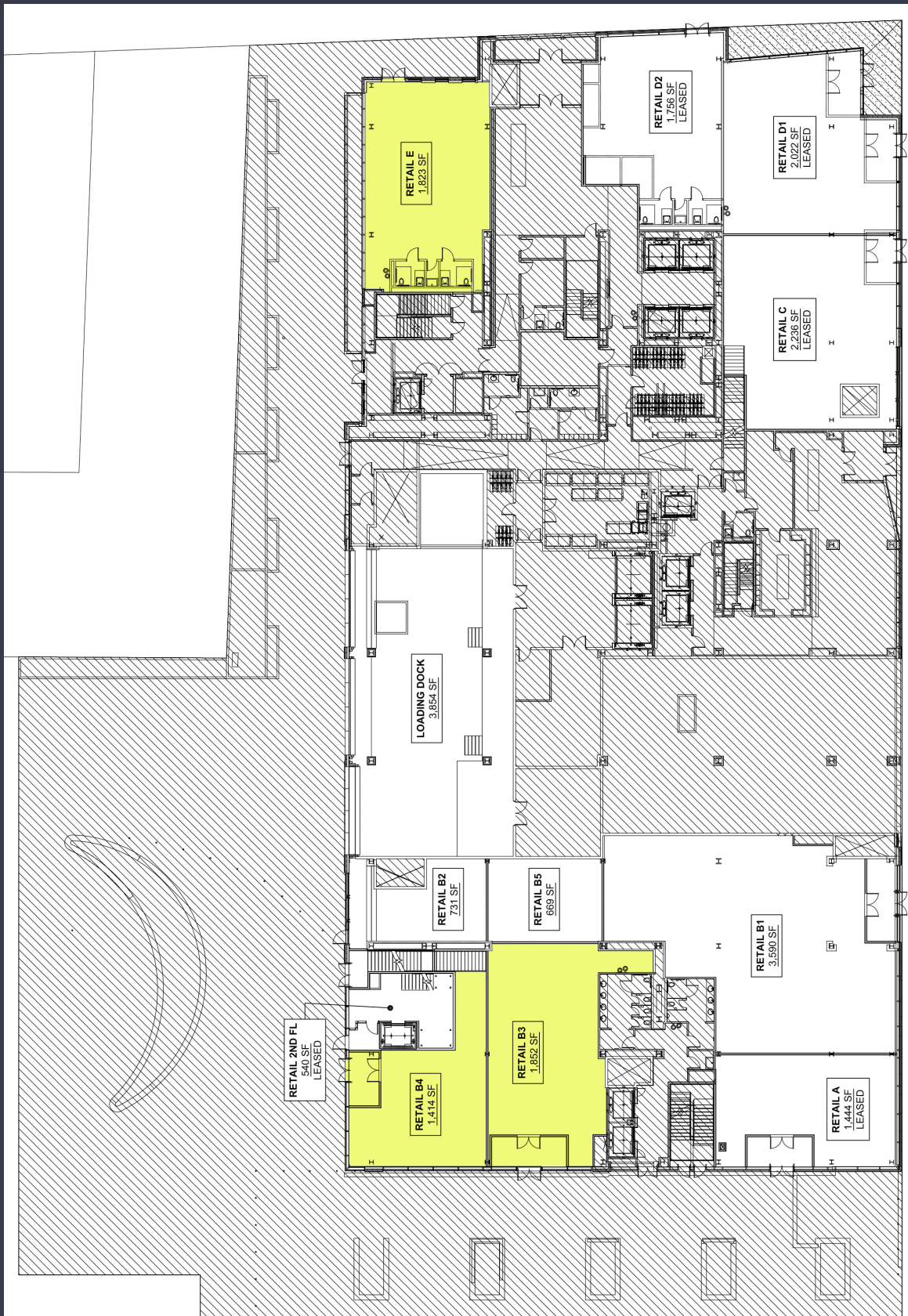



**PROJECT  
QUEENS**

[www.projectqueens.com](http://www.projectqueens.com)

136-18 39th Avenue, 704,

Flushing, NY 11354

(347) 506-0084

## FOR MORE INFORMATION CONTACT

### **MICHAEL WANG**

*CEO*

[michael@projectqueens.com](mailto:michael@projectqueens.com)

(212) 287-5686

### **JIAYI SHI**

*Chief Sales Officer*

[jiayi@projectqueens.com](mailto:jiayi@projectqueens.com)

### **ALLEN WANG**

*Executive Managing Director*

[allen@projectqueens.com](mailto:allen@projectqueens.com)

### **HONGMEI TENG**

*Chief Operating Officer*

[hongmei@projectqueens.com](mailto:hongmei@projectqueens.com)

