

MY International 

Exceptional Real Estate

PARK PLACE

±901 SF Office or Retail for Lease
3516 S 47th St | Tacoma, WA



WELCOME TO PARK PLACE #103A

A Neighborhood Opportunity

The final available suite at Park Place is now offered for lease. This well-maintained, move-in ready space features an open layout with a defined foyer/reception area and a private restroom—ideal for office, retail, or professional service use.

Located in a high-traffic corridor near Tacoma Mall with easy access to I-5 and Highway 16, the property offers excellent visibility and convenience, surrounded by established residential communities.

17,920 SF

BUILDING SIZE

901 SF

AVAILABLE SPACE

\$1,126

BASE RENT

\$631

NNN

\$1,757

GROSS RENT

1

IN-SUITE RESTROOM

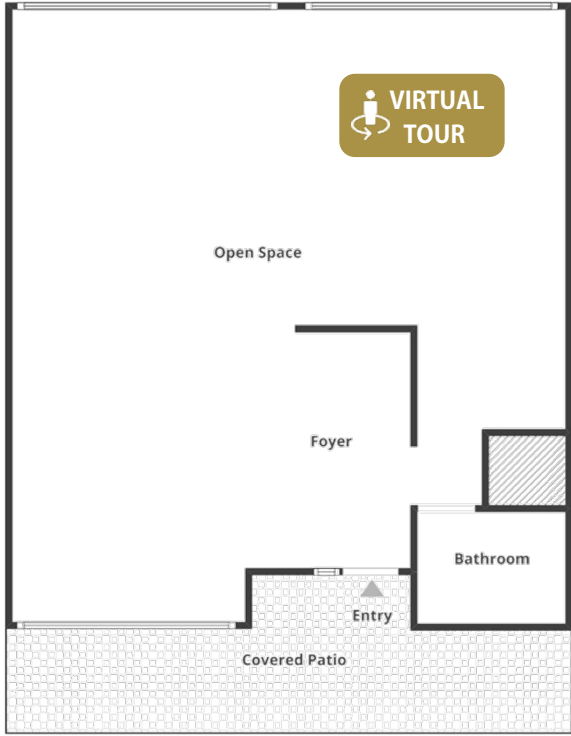

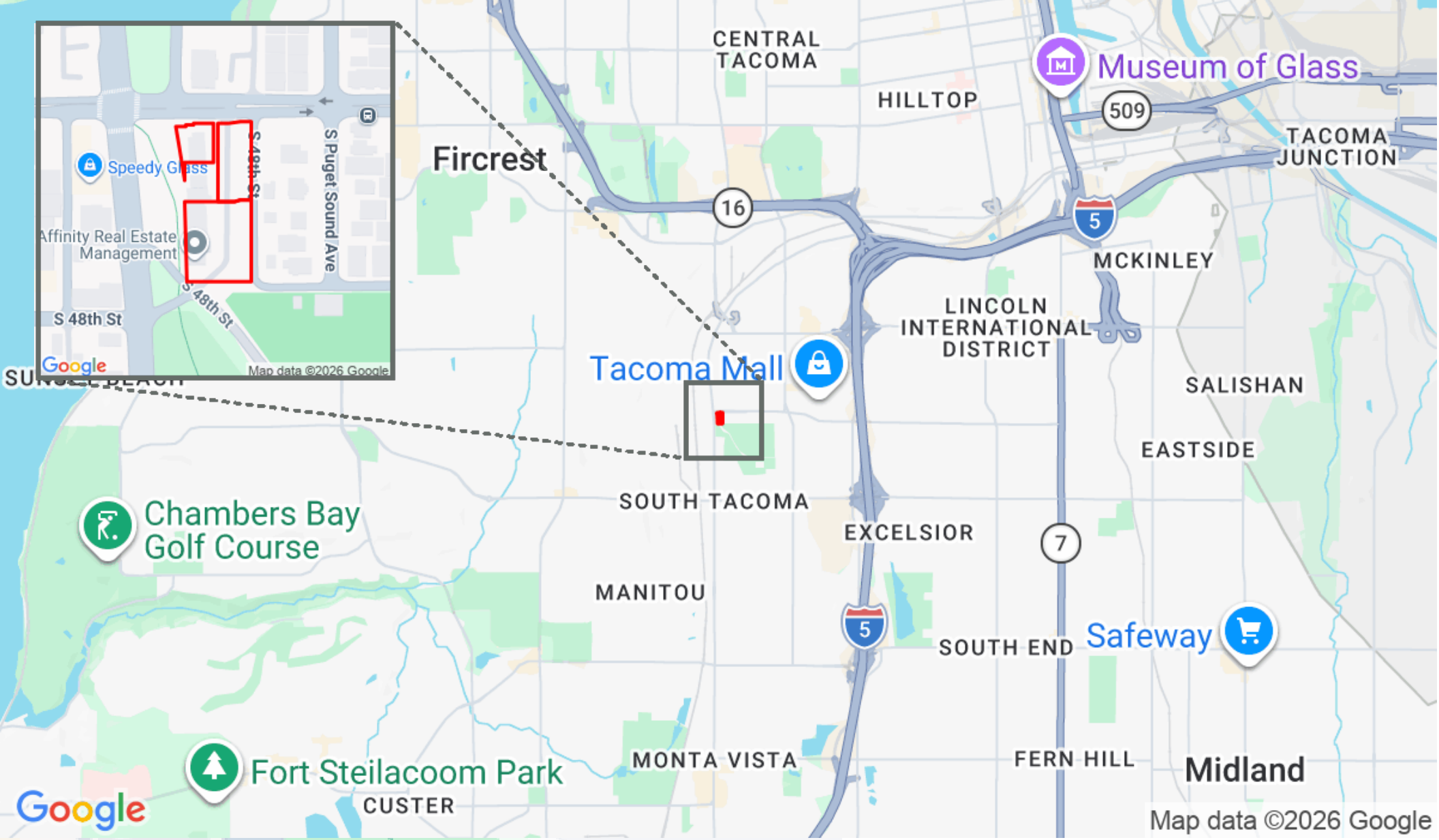

Exclusively Listed by

MY International 

Exceptional Real Estate

JOY ZHANG

Office Manager/Broker

206.660.6125

joy@myirealestate.com

This information supplied herein is from sources we deem reliable. It is provided without any representation, warranty, or guarantee, expressed or implied as to its accuracy. Prospective Buyer or Tenant should conduct an independent investigation and verification of all matters deemed to be material, including, but not limited to, statements of income and expenses. Consult your attorney, accountant, or other professional advisor. All Kidder Mathews designs are the sole property of Kidder Mathews. Branded materials and layouts are not authorized for use by any other firm or person.