

14555 ROTUNDA DRIVE
DEARBORN, MICHIGAN

HI-TECH FOR SALE
60,765 Square Feet Available



**SIGNATURE
ASSOCIATES**
KNOW SIGNATURE | KNOW RESULTS

SCHAEFER COURT II



PROPERTY FEATURES

- 60,765 square feet available
- Office to suit
- Schaefer Court II is a single-story business park comprised of flexible use office & R&D buildings
- 11'-16' clear height
- (2) 12'x14' grade level doors
- Ability to convert to warehouse/assembly
- Windows on four sides, high-bay, garage space and office parking ratio, surrounded by well-maintained landscaping
- Easy access to I-94 and M-39 expressways
- Sale Price: \$2,750,000

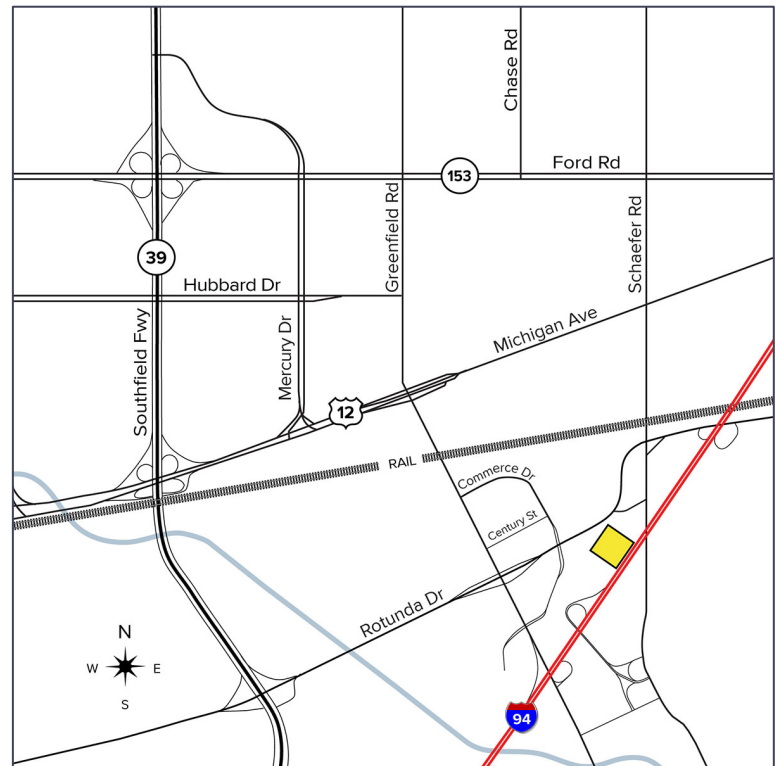

For more information, please contact:

JOHN BOYD
(248) 948 0102
jboyd@signatureassociates.com

GRANT BRUCE
(248) 948 4188
gbruce@signatureassociates.com

SIGNATURE ASSOCIATES
One Towne Square, Suite 1200
Southfield, MI 48076
www.signatureassociates.com

14555 Rotunda Drive – Dearborn, Michigan

Hi-Tech For Sale

60,765
Square Feet
AVAILABLE

Site Plan

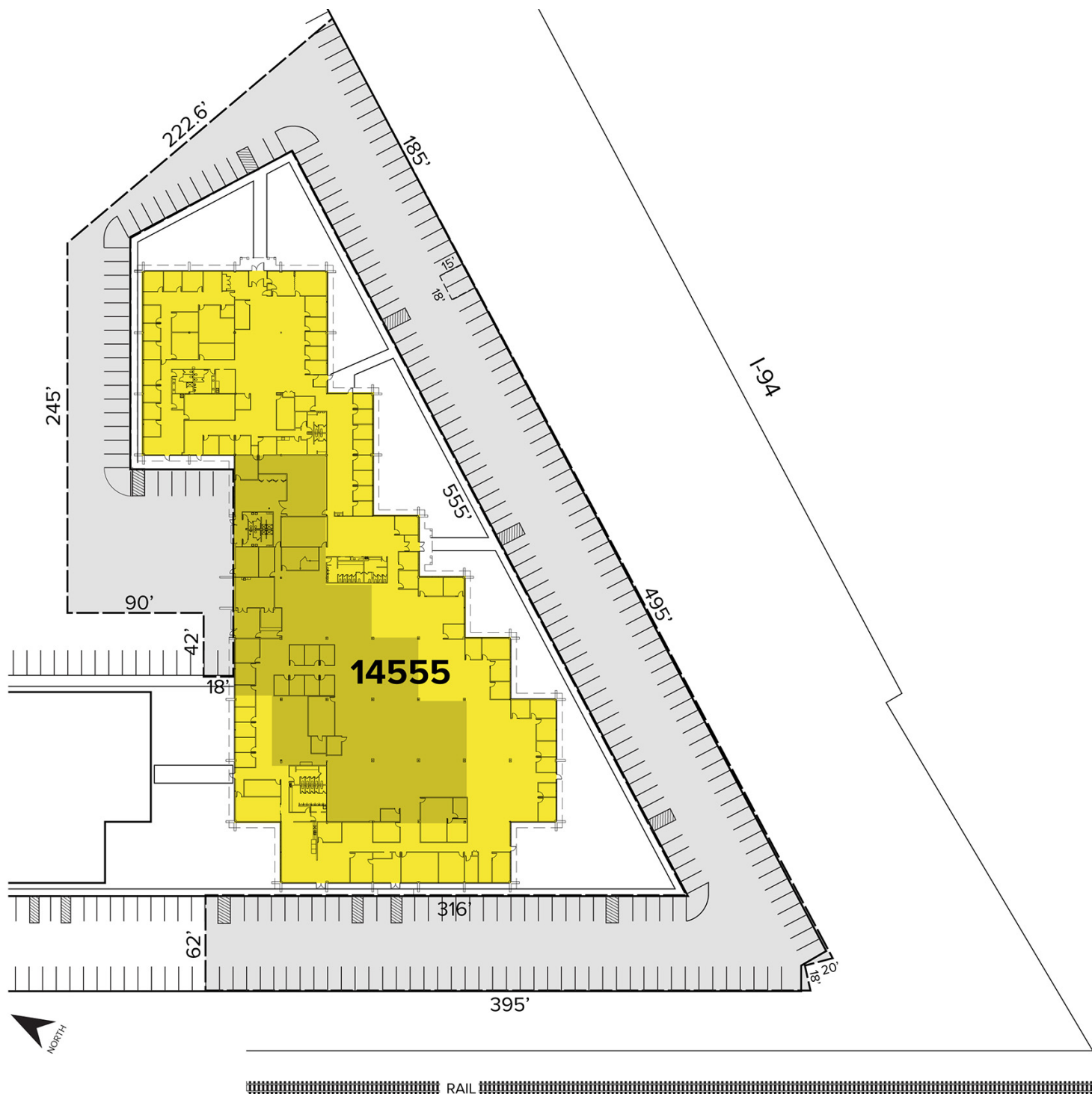

For more information, please contact:

JOHN BOYD
(248) 948 0102
jboyd@signatureassociates.com

GRANT BRUCE
(248) 948 4188
gbruce@signatureassociates.com

SIGNATURE ASSOCIATES
One Towne Square, Suite 1200
Southfield, MI 48076
www.signatureassociates.com

14555 Rotunda Drive – Dearborn, Michigan

Hi-Tech For Sale

60,765
Square Feet
AVAILABLE

Floor Plan



For more information, please contact:

JOHN BOYD
(248) 948 0102
jboyd@signatureassociates.com

GRANT BRUCE
(248) 948 4188
gbruce@signatureassociates.com

SIGNATURE ASSOCIATES
One Towne Square, Suite 1200
Southfield, MI 48076
www.signatureassociates.com

14555 Rotunda Drive – Dearborn, Michigan

Hi-Tech For Sale

60,765
Square Feet
AVAILABLE

Additional Photos



For more information, please contact:

JOHN BOYD
(248) 948 0102
jboyd@signatureassociates.com

GRANT BRUCE
(248) 948 4188
gbruce@signatureassociates.com

SIGNATURE ASSOCIATES
One Towne Square, Suite 1200
Southfield, MI 48076
www.signatureassociates.com

14555 Rotunda Drive – Dearborn, Michigan

Hi-Tech For Sale

60,765
Square Feet
AVAILABLE

Aerial

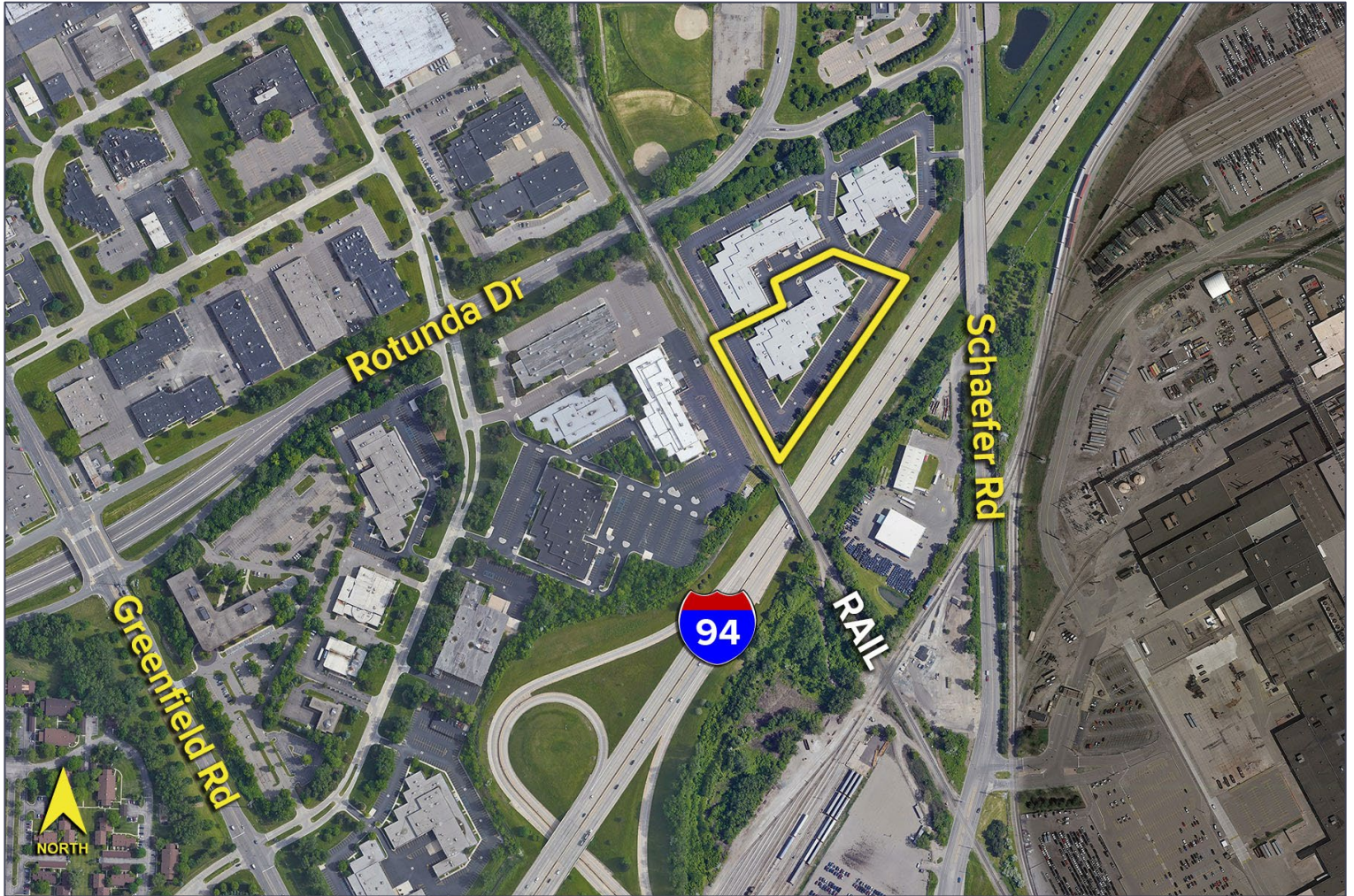

For more information, please contact:

JOHN BOYD
(248) 948 0102
jboyd@signatureassociates.com

GRANT BRUCE
(248) 948 4188
gbruce@signatureassociates.com

SIGNATURE ASSOCIATES
One Towne Square, Suite 1200
Southfield, MI 48076
www.signatureassociates.com